

Thank you for purchasing a Sealey product. Manufactured to a high standard this product will, if used according to these instructions and properly maintained, give you years of trouble free performance.

IMPORTANT: PLEASE READ THESE INSTRUCTIONS CAREFULLY. NOTE THE SAFE OPERATIONAL REQUIREMENTS, WARNINGS AND CAUTIONS. USE THE PRODUCT CORRECTLY AND WITH CARE FOR THE PURPOSE INTENDED. FAILURE TO DO SO MAY CAUSE DAMAGE AND/OR PERSONAL INJURY AND WILL INVALIDATE THE WARRANTY. PLEASE KEEP INSTRUCTIONS SAFE FOR FUTURE USE.

1. SAFETY INSTRUCTIONS

- ✓ Only use on firm, level, unobstructed surfaces which are capable of supporting the stand and body panels.
- ✗ Do not overload.
- ✓ Always load evenly with the centre of gravity of the load as near the centre as possible.
- ✓ Always apply the brakes before commencing work.
- ✗ Do not stand/ride on the panel stand, or allow others to do so.
- ✓ Replace or repair damaged parts. Use only recommended parts. Unauthorised parts may be dangerous and will invalidate the warranty.
- ☐ Warning! Failure to comply with these instructions may result in loss of load, damage to stand or other property and/or personal injury.
- ☐ **WARNING: The warnings, cautions and instructions discussed in this instruction manual cannot cover all possible conditions and situations that may occur. It must be understood that common sense and caution are factors which cannot be built into this product, but must be applied by the operator.**

2. INTRODUCTION & SPECIFICATION

Ideal for doors, bonnets, bumpers, wings and spoilers. Eight adjustable bars and 360° rotation make this stand suitable for almost any panel types. Portable for easy manoeuvring of application from preparation to spray booth. Built-in tool tray/storage for easy and convenient selection.

| | |
|-----------------------|--------|
| Overall Arm Length: | 1420mm |
| Short Adjustable Bar: | 410mm |
| Long Adjustable Bar: | 760mm |
| Height (Stand): | 1070mm |
| Maximum Capacity: | 90kg |

3. ASSEMBLY

- 3.1 Attach fixed pole (10) and tray (16) to the front brace (9), and rear brace (11) using bolts (9A), washers (9C) and nuts (9B).
 - 3.2 Attach the two wheel poles (12) to the rear brace (11) using bolts (11A), washers (9C) and nuts (9B).
 - 3.3 Check that the frame is square and fully tighten all fixings.
 - 3.4 Attach wheels (13) to the wheel poles and secure with large washer (15) and cotter pin (14).
 - 3.5 Lay the frame carefully on its side and slide the front bar (9G) through the lower bracket on the front brace (9), position the spring (9H) above the bracket and slide the front bar through the spring and through the top bracket.
 - 3.6 Attach the foot pedal to the front brace and to the base of the front bar using bolts (9D) and nuts (9E).
 - 3.7 Upright the frame, the spring will rest on the lower bracket, lift the pedal up until the bolt hole in the front bar is clear of the spring and insert the spring retaining bolt (9J) and secure with nut (9K). Press the pedal down and lock the bar down with safety pin (9I).
 - 3.8 Slide the buckles onto pole (6) alternate each one as shown in the assembly drawing (fig.1). Insert extension pole (7) through the rear brace and into pole (6), secure using bolt (7A), insert the adjustable gear wheel (5) through the front brace into the other end of pole (6), and secure using screw (6A), washers (6B), spacers (6C) and nuts (6D).
- Note:** Some buckles may require positioning onto the extension pole (7) before securing.
- 3.9 Press on the foot pedal and remove the safety pin, release the pedal to lock the assembly into position.
 - 3.10 Slide Handle (8) onto the end of the extension pole (7) and secure with knob (4).
 - 3.11 Insert the short arms (2) and long arms (1) into the buckles and lock into the required position with knobs (4).

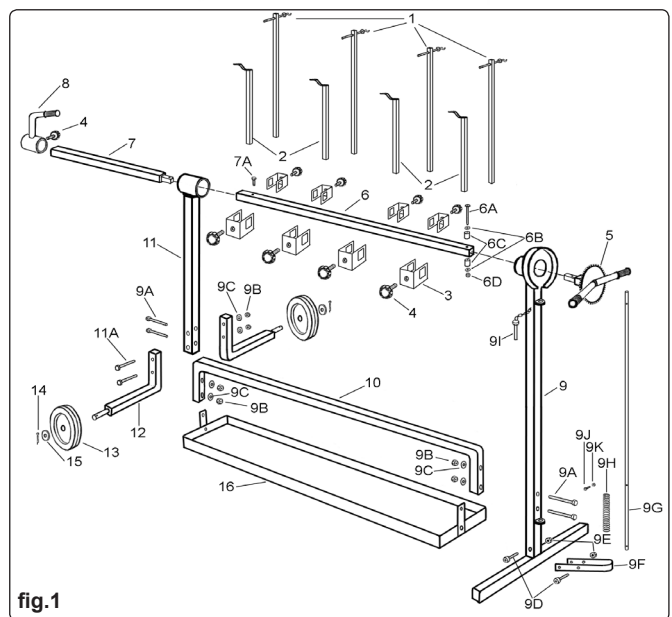

fig.1

NOTE: It is our policy to continually improve products and as such we reserve the right to alter data, specifications and component parts without prior notice.

IMPORTANT: No liability is accepted for incorrect use of product.

WARRANTY: Guarantee is 12 months from purchase date, proof of which will be required for any claim.

INFORMATION: For a copy of our latest catalogue and promotions call us on 01284 757525 and leave your full name and address, including your postcode.