

SEALEY

TYRE INFLATOR/MINI AIR COMPRESSOR WITH WORKLIGHT 12V

MODEL NO: **MAC01**

Thank you for purchasing a Sealey product. Manufactured to a high standard, this product will, if used according to these instructions, and properly maintained, give you years of trouble free performance.

IMPORTANT: PLEASE READ THESE INSTRUCTIONS CAREFULLY. NOTE THE SAFE OPERATIONAL REQUIREMENTS, WARNINGS & CAUTIONS. USE THE PRODUCT CORRECTLY AND WITH CARE FOR THE PURPOSE FOR WHICH IT IS INTENDED. FAILURE TO DO SO MAY CAUSE DAMAGE AND/OR PERSONAL INJURY AND WILL INVALIDATE THE WARRANTY. KEEP THESE INSTRUCTIONS SAFE FOR FUTURE USE.



Refer to
instruction
manual



Keep away
from rain

1. SAFETY

- ✓ Keep the compressor clean and in good condition.
- ✓ Replace or repair damaged parts. *Use recommended parts only. Unauthorised parts may be dangerous and will invalidate the warranty.*
- ✓ Keep children and non-essential persons away from the work area.
- ❑ **WARNING!** This compressor is capable of producing a high pressure. **DO NOT** inflate any item beyond it's maximum specified pressure.
- ✓ The 12volt cigarette lighter plug must not be replaced with any other type of plug or electrical supply.
- ✗ **DO NOT** use near flammable solids, liquids or gases.
- ✗ **DO NOT** direct inflation hose connector head at yourself, others or animals.
- ✗ **DO NOT** leave the compressor operating unattended. Always monitor it and the inflation pressure.
- ✗ **DO NOT** carry by the hose, or yank the hose from an inflation valve.
- ✗ **DO NOT** pull the plug from the cigarette lighter socket using the lead.
- ✗ **DO NOT** get the compressor wet or use in the rain.
- ✗ **DO NOT** use the compressor for a task that it is not designed for.
- ✗ **DO NOT** operate the compressor when you are tired or under the influence of alcohol, drugs or intoxicating medication.
- ✗ **DO NOT** operate the compressor if any parts are missing or the compressor is damaged, as this may cause failure and/or personal injury.
- ✗ **DO NOT** open the unit.

2. INTRODUCTION

12V Mini air compressor with delivery of 25lt/min. Integral storage for supply lead and air output hose. features work light for use in low light areas. Light can also be set to flash for emergency use. Pressure gauge reads up to 8bar/120psi. Suitable for inflating tyres on cars, vans and 4x4s.

3. SPECIFICATION

Model no	MAC01
Hose length.....	600mm
Power cord length	3.3m
Max. current.....	8.5A @ 40psi
Operating voltage.....	12V
Weight.....	1.05kg
Typical inflation time.....	0-30psi in 178sec (175/70/R13)



fig.1



fig.2

4. OPERATION

- ❑ **WARNING!** Ensure you have read and understood the safety instructions.
- 4.1. Position compressor on a firm, flat surface and so that the air hose reaches the tyre valve.
- 4.2. Check that the compressor On/Off switch is in the OFF position and plug the 12V plug into the vehicle's cigarette lighter socket.
- 4.3. Remove the valve dust cap and lift the connector locking lever into the upright position (fig.1).
- 4.4. Push connector fully onto the valve and lock in place by pressing down the locking lever (fig.2).
IMPORTANT: Inflation will only be effective if the connector is fully fitted and locked onto the valve.
- 4.5. Press the compressor On/Off switch to the ON position and the compressor will begin to operate.
- 4.6. Inflate the tyre to the desired pressure and turn off the compressor by pressing the switch to the OFF position.
NOTE: The gauge may be subject to fluctuation whilst pumping.
- 4.7. Remove the air hose from the tyre valve by releasing the locking lever and gently twisting and pulling the connector from the tyre valve, taking care not to lose any air in the process. Replace the dust cap.
- 4.8. Disconnect the 12V plug from the vehicle's cigarette lighter socket.
- ❑ **WARNING!** The compressor must be switched off for fifteen minutes after each sixty minute period of continuous operation to prevent excessive heat build-up.

4.9. The LED lights have two selectable functions - white LEDs for illumination or red flashing LEDs for emergency warning. The light switch cycles through: OFF - White LED - Red flashing LED - OFF.

4.10. **GENERAL INFORMATION:**

- a) When inflating a totally flat tyre still fitted on a vehicle, there should not be any weight on it. The vehicle must, therefore, be jacked up to take the weight off the tyre.
- b) The time taken to inflate a tyre will depend upon the volume of air and pressure required.
- c) If the compressor does not work when it is plugged in, check the operation of the lighter socket, it may require the ignition switch to be in the 'ON' position for it to work.

NOTE: The compressor may also be used on items such as inflatable dinghies, sports balls, air beds etc. using one of the two adaptors supplied.

NOTE: The pressure gauge is not a calibrated instrument. It is recommended to use a calibrated tyre pressure gauge for an accurate final reading.

CAUTION: Some items may not indicate the pressure required or the safe maximum pressure. Be very careful not to over-inflate.

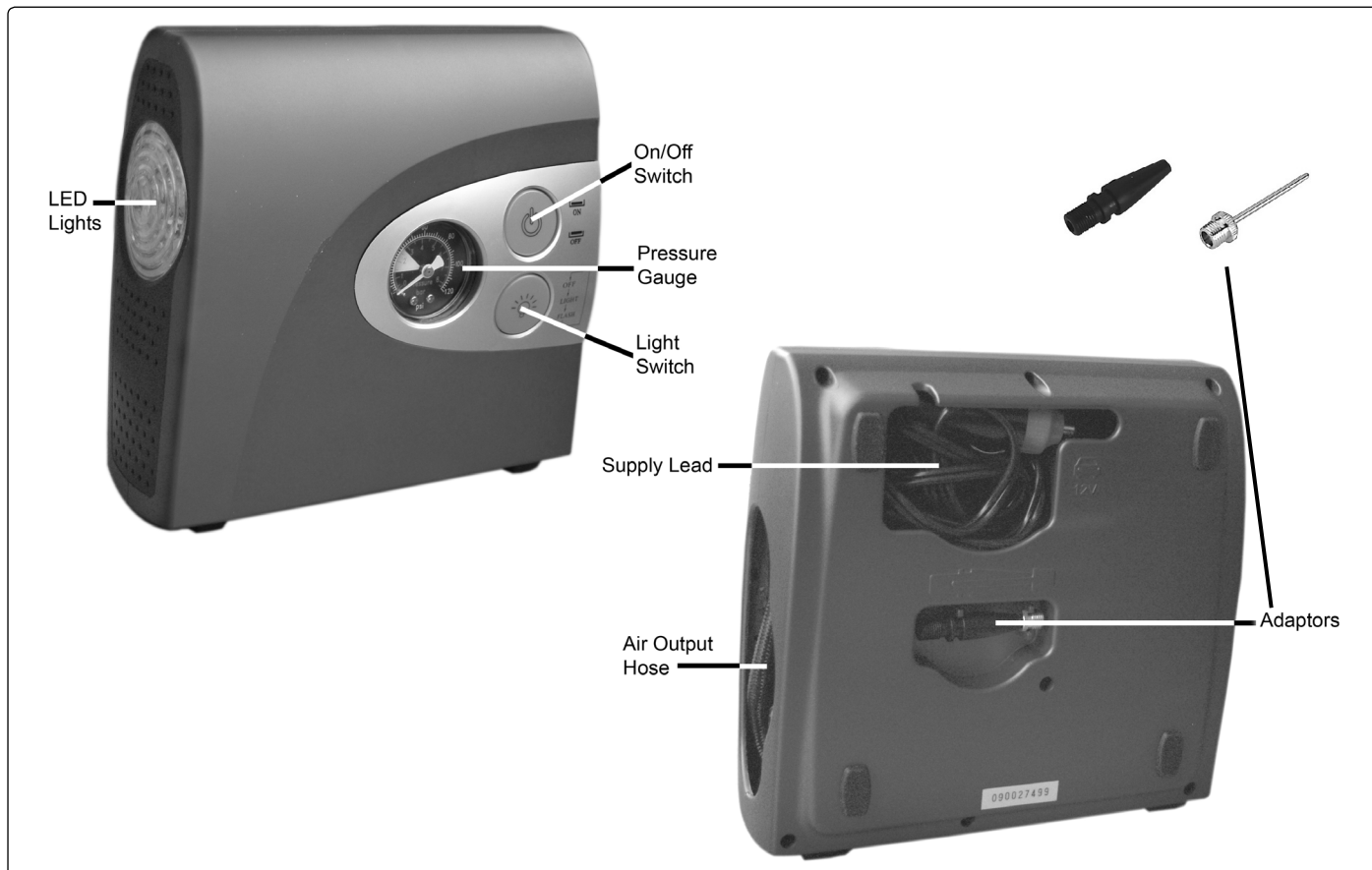

WEEE REGULATIONS

Dispose of this product at the end of its working life in compliance with the EU Directive on Waste Electrical and Electronic Equipment (WEEE). When the product is no longer required, it must be disposed of in an environmentally protective way. Contact your local solid waste authority for recycling information.



ENVIRONMENT PROTECTION

Recycle unwanted materials instead of disposing of them as waste. All tools, accessories and packaging should be sorted, taken to a recycling centre and disposed of in a manner which is compatible with the environment. When the product becomes completely unserviceable and requires disposal, drain any fluids (if applicable) into approved containers and dispose of the product and fluids according to local regulations.

Note: It is our policy to continually improve products and as such we reserve the right to alter data, specifications and component parts without prior notice.

Important: No Liability is accepted for incorrect use of this product.

Warranty: Guarantee is 12 months from purchase date, proof of which is required for any claim.

Sealey Group, Kempson Way, Suffolk Business Park, Bury St Edmunds, Suffolk. IP32 7AR



01284 757500



01284 703534



sales@sealey.co.uk



www.sealey.co.uk