



HEAVY-DUTY SAW HORSE WITH CHAINSAW HOLDER

MODEL NO: LSH150HD

Thank you for purchasing a Sealey product. Manufactured to a high standard, this product will, if used according to these instructions, and properly maintained, give you years of trouble free performance.

IMPORTANT: PLEASE READ THESE INSTRUCTIONS CAREFULLY. NOTE THE SAFE OPERATIONAL REQUIREMENTS, WARNINGS & CAUTIONS. USE THE PRODUCT CORRECTLY AND WITH CARE FOR THE PURPOSE FOR WHICH IT IS INTENDED. FAILURE TO DO SO MAY CAUSE DAMAGE AND/OR PERSONAL INJURY AND WILL INVALIDATE THE WARRANTY. KEEP THESE INSTRUCTIONS SAFE FOR FUTURE USE.



Refer to instructions



Wear eye protection



Wear protective gloves



Wear head protection



Wear ear protection



Wear protective clothing



Wear safety footwear



Wear face mask



Beware of Kickback

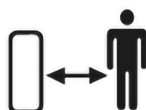

Keep bystanders away



Use both hands



Appropriate Protection Foot-leg, Hand-Arm



Avoid touching tip to avoid kickback



Avoid rain and wet conditions

1. SAFETY

- ☐ **WARNING!** Read this manual carefully before using this product.
- ✓ This product is only to be used by those trained in its use especially when it is used with a chainsaw.
- ✓ This product can cause serious injury if used incorrectly. Never allow those unfamiliar with it to use it. Follow all safety protocols concerning the use of a chainsaw.
- ✓ Follow regulations in force concerning who can use of chainsaws.
- ✗ **DO NOT** use when tired, under the influence of drugs, alcohol or medication.
- ✗ **DO NOT** exceed the rated capacity. Evenly distribute the weight of any logs along the table.
- ✓ Keep bystanders away and risk assess the work area for hazards. **DO NOT** allow the work area to become overloaded with cut logs. If anyone enters the work area stop using immediately. **DO NOT** store anything in the work area.
- ✓ Only use on ground solid enough to withstand weight of product and its load.
- ✓ Only use in good light and good weather conditions.
- ✗ **DO NOT** reach in and do not put any part of the body near to rotating/moving parts.
- ✓ Carefully inspect the product before use. Check security of fixings. Replace damaged parts before use. Perform a 'dry run' of the cutting arc of the chainsaw, before use.
- ✓ Use PPE appropriate to the use of a chainsaw. Contain long hair.
- ✗ **DO NOT** overreach as this could cause the product to topple over.
- ✗ **DO NOT** force the tool. If the product is not working as expected turn off the chainsaw and assess what is going wrong.

2. INTRODUCTION

Heavy-duty log saw horse with 150kg capacity. Secure saw bed with chainsaw holster keeps log and chainsaw steady during cutting. Adjustable bar holds timber up to 1.8m and Measuring rod for consistent sizing. 200mm log diameter capacity. Mount fits most chainsaws up to 45cm with included spanner for quick adjustments. Folds flat for compact storage after use.

3. SPECIFICATION

Model No: LSH150HD
Capacity: 150kg
Maximum Log Diameter: 200mm
Weight: 10.6kg
Overall Size Folded: 900 x 290 x 970mm
Overall Size Open: 710 x 880 x 860mm

4. CONTENTS (SEE NEXT PAGE)



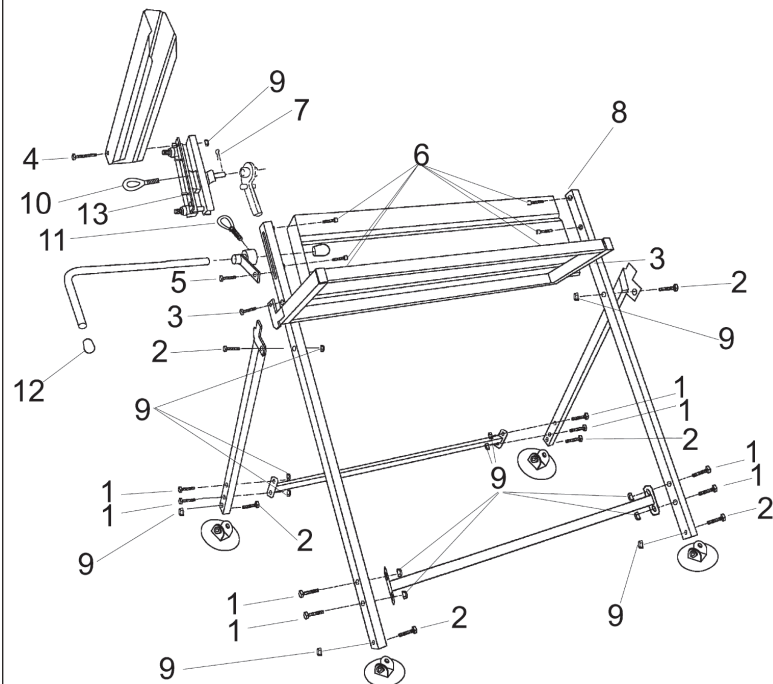

Fixings

1		8x30mm	8x
2		8x35mm	6x
3		8x45mm	2x
4		8x70mm	1x
5		10x20mm	1x
6		8x12mm	6x
7		3mm	1x
8			1x
9		m8	17x
10		12x30mm	1x
11		10x20mm	1x
12		φ 16mm	2x
13		5x10mm	2x

5. ASSEMBLY

5.1. Assemble according to diagram above as far as fitting the chainsaw pivot clamp and measuring rod.

5.2. PIVOT CLAMP SUPPORT AND MEASURING ROD

Insert the pivot clamp support (adjustable vertically) into the saw horse table with the measuring rod holder (adjustable horizontally) using the bolt and washer supplied.

The vertical adjustment for the pivot clamp support is to accommodate different sized chain bars - the larger and longer the bar, the higher the pivot clamp should be placed. Adjust so that the tip of the chain bar extends beyond the table, so that it is cutting completely through the log. Remember to perform a dry run to check this before cutting logs.

5.3. Fig.1. The measuring rod can be adjusted to allow each log to be cut to the desired length.

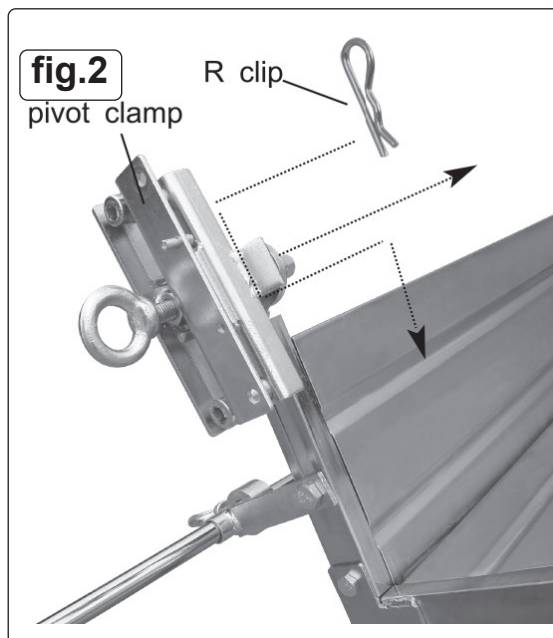
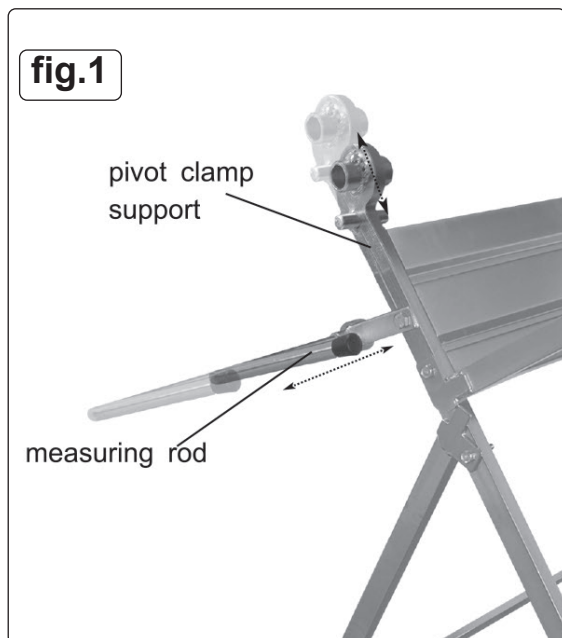

5.4. Fig 2. Pivot Clamp - Insert the male rod on the pivot clamp into the female cylinder on the pivot support clamp and secure with the R clip.

5.5. CHAIN SAW REST

If the measuring rod is not being used, replace it with the short rod. This acts as a chain saw rest.

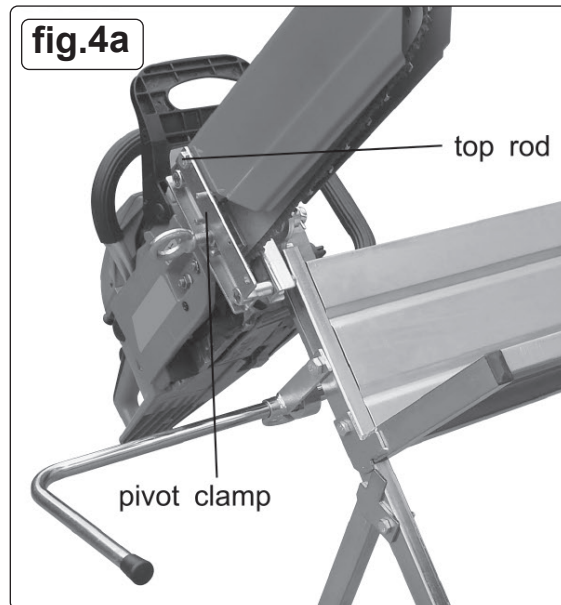
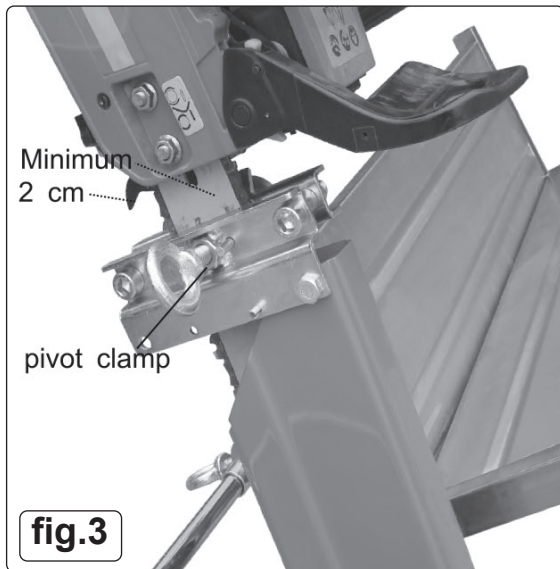

- 5.11. Fig 3. Carefully lower the chainsaw bar into position between the two solid blocks in the pivot clamp and ensure a 2 cm gap between the body of the chainsaw and the clamp. Make sure that the bar is approximately 90 degrees to the clamp and well clear of the chain before tightening the bolt.
- 5.12. Once tightened, test the arc of travel to make sure that the chain bar does not touch any part of the saw bench.
- 5.13. Fig 4a. Fit the chainsaw bar guard onto the top of the pivot clamp.
- 5.14. Securely tighten the bar guard with bolt and nut provided.
- 5.15. Lift the guard up and down as necessary to a position in which the guard is well clear of the chain. Tighten the bolt. Re-check for clearance.
- 5.16. The saw horse is now ready for use.

6. OPERATION

- 6.1. Place the wood on the log table push the log to the end of the measuring rod. Hold the wood down firmly with your left hand, keeping your hand well clear of the cutting edge of the chainsaw, and arc the chainsaw down to cut.
- 6.2. The log table on the saw horse is designed for taking lengths to a maximum of 1.80 meters and a maximum diameter of 20 cm.
- 6.3. The maximum permissible load on the saw horse is 150 kg.
- 6.4. The saw horse's chain guard is designed for chainsaws with a cutting bar not longer than 45 cm. A chainsaw with a cutting bar longer than 45 cm (which protrudes beyond the chain guard) is not recommended.
- 6.5. The pivot clamp and guard must be detached when using the chainsaw separately from the saw horse.
- 6.6. The pivot clamp and support must be kept well lubricated.
- 6.7. The saw horse must be used on flat surfaces only.
- 6.8. Ensure the nuts and bolts on the pivot clamp and guard are kept tight at all times.
- 6.9. When using a chainsaw with the saw horse it is essential that all safety codes and practices of the chainsaw manufacturer and Health and Safety Executive are fully followed.



ENVIRONMENT PROTECTION

Recycle unwanted materials instead of disposing of them as waste. All tools, accessories and packaging should be sorted, taken to a recycling centre and disposed of in a manner which is compatible with the environment. When the product becomes completely unserviceable and requires disposal, drain any fluids (if applicable) into approved containers and dispose of the product and fluids according to local regulations.

Note: It is our policy to continually improve products and as such we reserve the right to alter data, specifications and component parts without prior notice.

Important: No Liability is accepted for incorrect use of this product.

Warranty: Guarantee is 12 months from purchase date, proof of which is required for any claim.



Jack Sealey Ltd t/a Sealey Group, Kempson Way, Suffolk Business Park, Bury St Edmunds, Suffolk, IP32 7AR UK
Jack Sealey (EU) Ltd t/a Sealey Group, Farney Street, Carrickmacross, Co. Monaghan, A81 PK68 Ireland
Tel: 01284 757500 • **Email:** sales@sealey.co.uk • **Web:** www.sealey.co.uk