

Thank you for purchasing a Sealey product. Manufactured to a high standard this product will, if used according to these instructions and properly maintained, give you years of trouble free performance.

⚠ IMPORTANT: PLEASE READ THESE INSTRUCTIONS CAREFULLY. NOTE THE SAFE OPERATIONAL REQUIREMENTS, WARNINGS & CAUTIONS. USE THE PRODUCT CORRECTLY AND WITH CARE FOR THE PURPOSE FOR WHICH IT IS INTENDED. FAILURE TO DO SO MAY CAUSE DAMAGE AND/OR PERSONAL INJURY AND WILL INVALIDATE THE WARRANTY. PLEASE KEEP INSTRUCTIONS SAFE FOR FUTURE USE.

1. SAFETY INSTRUCTIONS

1.1. ELECTRICAL SAFETY

⚠ WARNING! It is the responsibility of the owner and the operator to read, understand and comply with the following:

You must check all electrical products, before use, to ensure that they are safe. You must inspect power cables, plugs, sockets and any other connectors for wear or damage. You must ensure that the risk of electric shock is minimised by the installation of appropriate safety devices. A Residual Current Circuit Breaker (RCCB) should be incorporated in the main distribution board. We also recommend that a Residual Current Device (RCD) is used. It is particularly important to use an RCD with portable products that are plugged into a supply which is not protected by an RCCB. If in any doubt consult a qualified electrician. You may obtain a Residual Current Device by contacting your Sealey dealer.

You must also read and understand the following instructions concerning electrical safety.

1.1.1. The **Electricity at Work Act 1989** requires all portable electrical appliances, if used on business premises, to be tested by a qualified electrician, using a Portable Appliance Tester (PAT), at least once a year.

1.1.2. The **Health & Safety at Work Act 1974** makes owners of electrical appliances responsible for the safe condition of those appliances and the safety of the appliance operators. **If in any doubt about electrical safety, contact a qualified electrician.**

1.1.3. Ensure that the insulation on all cables and on the appliance is safe before connecting it to the power supply. See 1.1.1. and 1.1.2. and use a Portable Appliance Tester.

1.1.4. Ensure that cables are always protected against short circuit and overload.

1.1.5. Regularly inspect power supply cables and plugs for wear or damage and check all connections to ensure that none is loose.

1.1.6. **Important:** Ensure that the voltage marked on the appliance matches the power supply to be used and that the plug is fitted with the correct fuse - see fuse rating at right.

1.1.7. **DO NOT** pull or carry the appliance by the power cable.

1.1.8. **DO NOT** pull the plug from the socket by the cable.

1.1.9. **DO NOT** use worn or damaged cables, plugs or connectors. Immediately have any faulty item repaired or replaced by a qualified electrician. When an ASTA/BS approved UK 3 pin plug is damaged, cut the cable just above the plug and **dispose of the plug safely.** Fit a new plug according to the following instructions (UK only).

a) **Connect the GREEN/YELLOW earth wire to the earth terminal 'E'.**

b) **Connect the BROWN live wire to the live terminal 'L'.**

c) **Connect the BLUE neutral wire to the neutral terminal 'N'.**

d) **After wiring, check that there are no bare wires, that all wires have been correctly connected, that the cable outer insulation extends beyond the cable restraint and that the restraint is tight.**

Double insulated products, which are always marked with this symbol , are fitted with live (brown) and neutral (blue) wires only. To rewire, connect the wires as indicated above - **DO NOT** connect either wire to the earth terminal.

1.1.10. This product is supplied without a plug fitted. To fit a plug, follow the instructions detailed in paragraph 1.1.9.

1.1.11. If an extension reel is used it should be fully unwound before connection. A reel with an RCD fitted is preferred since any appliance plugged into it will be protected. The cable core section is important and to be absolutely sure that the capacity of the reel is suitable for this product and for others which may be used in the other output sockets, we recommend the use of 2.5mm² section cable. If extension reel is to be used outdoors, ensure it is marked for outdoor use.

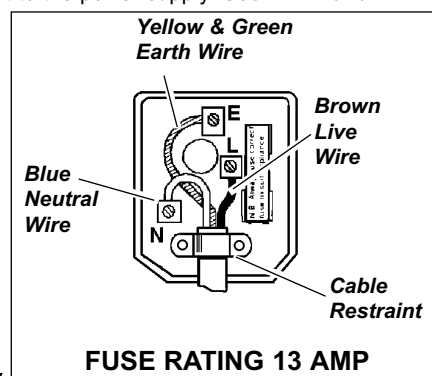

1.2. GENERAL SAFETY INSTRUCTIONS

- ✓ Familiarise yourself with the application and limitations of the heater.
- ✓ Ensure the heater is in good order and condition before use. If in any doubt do not use the unit and contact an electrician.
- ✓ Only use recommended attachments and parts. To use non-recommended items may be dangerous and will invalidate your warranty.
- ✓ Use the heater either wall mounted or with the optional support stand.
- ✓ Check that element guards are in place, undamaged and firmly attached.
- ✓ Keep tools and other items away from the heater when it is in use.
- ✓ Keep the work area clean and clear of unnecessary items.
- ✓ Keep children and unauthorised persons away from the heater, as it gets **very hot**.
- ✓ Disconnect from mains before moving or attempting any cleaning or maintenance.
- x **DO NOT** get the heater wet or use in damp or wet locations or areas where there is condensation.
- x **DO NOT** locate the heater below the power outlet.
- x **DO NOT** move the heater whilst in operation or even when still warm.
- x **DO NOT** touch the heater elements, even when cold.
- x **DO NOT** dis-assemble the heater for any reason. The heater must be checked by qualified personnel only.
- x **DO NOT** use this product to perform a task for which it has not been designed.
- ⚠ **WARNING! If a fuse blows, ensure it is replaced with an identical fuse type and rating.**
- ✓ When not in use, store the heater carefully in a safe, dry, child proof location.

2. INTRODUCTION

2.1. The LP1500 Infrared Quartz Heater is fitted with a long life 1500W Red Satin Halogen lamp.

Wall mounted, or with an optional support stand, this heater produces a strong directional heat flow afforded by the parabolic reflector.

The heater is supplied without cable which allows the operator to position at any distance from the power source. (See section 3.1 "POWER CABLE CONNECTION")

3. ASSEMBLY

3.1 POWER CABLE CONNECTION (Fig 1) (Only to be carried out by a qualified electrician).

- 3.1.1 Disconnect the heater body from its rear support by undoing screws (1)
- 3.1.2 Disconnect the lamp connectors on terminal board (2)
- 3.1.3 Insert mains cable through cable clamp (3)

IMPORTANT: USE A H05RR-F FLEXIBLE 3-CORE CABLE WITH 1mm² MINIMUM CROSS SECTIONAL AREA AND CONNECT TO A JUNCTION BOX OR PROPERLY GROUNDED OUTLET.

- 3.1.4 Connect live (brown), neutral (blue) and earth (green/yellow or green) cables to terminals respectively marked with L, N and earth symbol.
- 3.1.5 Tighten the cable clamp plastic nut to fix the cable firmly.
- 3.1.6 Connect the lamp connectors on terminal board and screw back heater body.

3.2 LAMP MOUNTING AND REPLACEMENT (Fig 2)

- 3.2.1 Undo screws (1) and disassemble the two front panels (2) and guard (3).
- 3.2.2 Extract the lamp from its carton, taking care not to touch the lamp glass.
- 3.2.3 Gently insert the lamp (4) into the ceramic supports (5).
- 3.2.4 Reassemble the front panels (2) and guard (3).

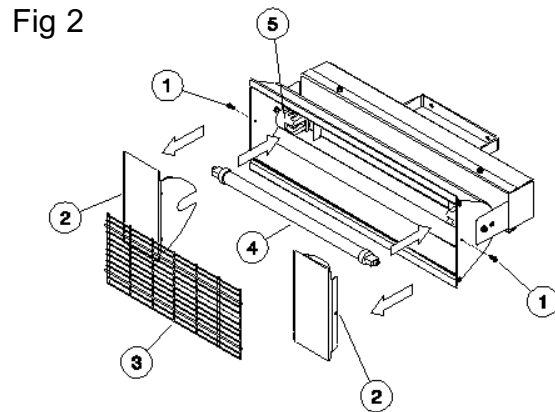
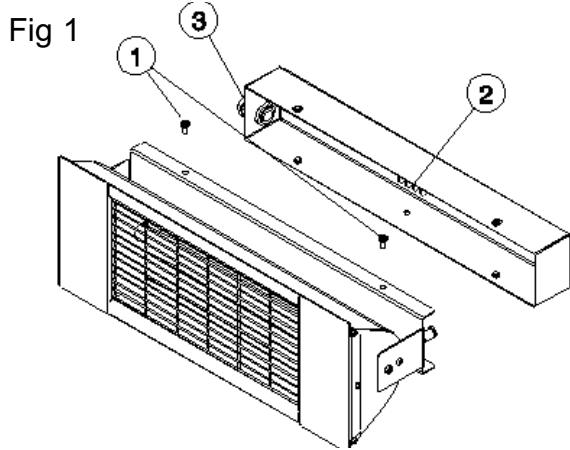

3.3 WALL FIXING (Fig 3)

- Minimum mounting height: 1.80m
- Minimum distance from ceiling: 0.25m
- Minimum distance from corners: 1.00m

WARNING! If mounting height is less than 1.80m, European Regulations require that the heater be fitted with a protection guard to prevent any contact with hot lamp.

- 3.3.1 Fix the metal bracket (1) to a wall by means of appropriate fixing materials. (Not supplied)
- 3.3.2 Connect heater body to metal bracket using the screws (2).
- 3.3.3 Adjust angle of heater to direct heat beam where required.

3.4 FITTING OPTIONAL STAND (Fig 4)

WARNING! Isolate heater from mains before any assembling and/or maintenance operations are carried out.

- 3.4.1 Fix lower rod (2) to base (1) using M8 screw and washer.
- 3.4.2 Assemble and connect the clamping lever (3) on top of lower rod (2).
- 3.4.3 Slide upper rod (4) into lower rod (2).
- 3.4.4 Fix upper rod at required height using lever (3).
- 3.4.5 Fix heating unit rear panel (5) to upper rod (4) using M6 screws and washers. To do this, the front reflector must be disconnected from the rear panel.

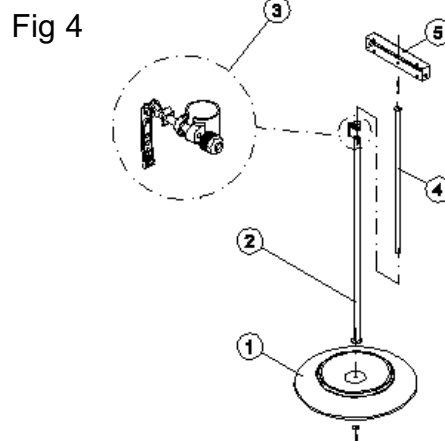
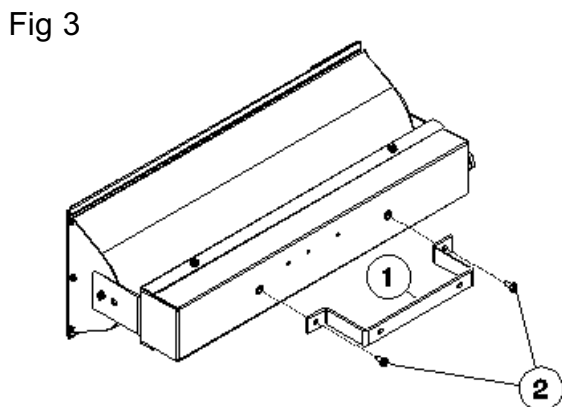

4. OPERATION

Note: The IR lamp is fragile and therefore it is important that the LP1500 is not subjected to any unnecessary shocks or vibration and is not moved when the lamps are on.

☐ **WARNING! Ensure you have read, understood and applied the safety instructions in Section 1 before using the heater.**

4.1. Position the heater at least 1m from any object.

Note: There is no power switch present on the lamp itself, it is turned on and off at the socket / power supply. Therefore, ensure setup is complete and that the heater is suitably positioned BEFORE plugging in.

4.2. Plug in the heater and switch on.

4.3. When the heater is no longer required, switch off at socket and/or unplug.

4.4. Allow heater to cool after use before attempting any maintenance or relocation.

☐ **WARNING! DO NOT touch the heater when in use as it becomes hot.**

Declaration of Conformity We, the sole UK importer, declare that the product listed below is in conformity with the following standards and directives.

The construction file for this product is held by the Manufacturer and may be inspected by a national authority upon request to Jack Sealey Ltd.

INFRARED QUARTZ HEATER
Model: LP1500
73/23/EEC LV Directive
89/336/EEC EMC Directive
93/68/EEC CE Marking Directive



Signed by Mark Sweetman

21st May 2003

For Jack Sealey Ltd. Sole UK importer of Sealey Power Products.

NOTE: It is our policy to continually improve products and as such we reserve the right to alter data, specifications and component parts without prior notice.

IMPORTANT: No liability is accepted for incorrect use of this equipment

WARRANTY: Guarantee is 12 months from purchase date, proof of which will be required for any claim.

INFORMATION: For a copy of our latest catalogue call us on 01284 757525 and leave your full name and address, including postcode.



Sole UK Distributor
Sealey Group,
Bury St. Edmunds, Suffolk.

01284 757500

01284 703534

sales@sealey.co.uk

www.sealey.co.uk