

Thank you for purchasing a Sealey product. Manufactured to a high standard this product will, if used according to these instructions and properly maintained, give you years of trouble free performance.



IMPORTANT: PLEASE READ THESE INSTRUCTIONS CAREFULLY. NOTE THE SAFE OPERATIONAL REQUIREMENTS, WARNINGS & CAUTIONS. USE THE PRODUCT CORRECTLY AND WITH CARE FOR THE PURPOSE FOR WHICH IT IS INTENDED. FAILURE TO DO SO MAY CAUSE DAMAGE AND/OR PERSONAL INJURY AND WILL INVALIDATE THE WARRANTY. PLEASE KEEP INSTRUCTIONS SAFE FOR FUTURE USE.

1. SAFETY INSTRUCTIONS

1.1. GENERAL SAFETY

- ▲ **IMPORTANT:** The LP13 is a mobile, propane-fired, unvented, infra-red space heater for **commercial** applications only. **DO NOT use domestically.**
- **WARNING! Use only in well ventilated spaces of more than 15m³ to prevent an accumulation of dangerous combustion gases.**
- x **DO NOT** operate heater in basements or otherwise below ground level.
- **WARNING! Heater will become very hot during use.**
- ✓ **WARNING! Ensure Health & Safety, local authority, and general workshop practice regulations are adhered to when using this equipment.**
- ✓ Familiarise yourself with the application and limitations of the heater, as well as the potential hazards.
- **WARNING!** Disconnect the heater from the gas supply before performing any maintenance.
- ✓ Maintain the heater in good condition (use an authorised service agent).
- ✓ Replace or repair damaged parts. *Use genuine parts only. Non-authorised parts may be dangerous and will invalidate the warranty.*
- **WARNING!** Keep all guards and holding screws in place, tight and in good working order. Check regularly for damaged parts. A guard or any other part that is damaged must be repaired or replaced before the heater is next used.
- ✓ Keep the heater clean for best and safest performance.
- ✓ Ensure the propane bottle is in a stable upright position before igniting the heater. **DO NOT** use with the bottle in any position other than upright.
- x **DO NOT** use any fuel other than propane.
- ✓ Ensure there are no flammable or combustible materials within 2 metres of the heater and that nothing, including walls, is less than 500mm from any surface of the heater.
- x **DO NOT** use the heater where there are flammable liquids, solids or gases such as paint solvents, etc.
- ✓ Keep gas hose away from heat, oil and sharp edges. Regularly check hose for wear and ensure that all connections are secure.
- x **DO NOT** move the heater when it is operating.
- x **DO NOT** use the heater for any purpose other than that for which it is designed.
- x **DO NOT** operate the heater if any parts are damaged or missing as this may cause failure and/or personal injury.
- x **DO NOT** adjust, or tamper with, the regulator.
- x **DO NOT** allow untrained persons to operate the heater.
- x **DO NOT** operate the heater when you are tired, under the influence of alcohol, drugs or intoxicating medication.
- ✓ When not in use disconnect from the gas supply and store in a safe, dry, childproof area.
- ✓ If the propane bottle is kept in a cabinet ensure that the shroud cut-out faces the door.
- ✓ In the event of a gas leak immediately close the bottle valve, extinguish any flame and then place equipment in a well ventilated area, preferably outdoors, and away from any heat sources (including strong sunlight). Rectify cause of leakage.
- ✓ If a persistent leakage occurs notify a qualified service engineer.
- ▲ **DANGER!** If the burner remains alight after the bottle valve has been closed **DO NOT** attempt to remove burner and/or regulator from the bottle. Contact your gas supplier immediately.

2. INTRODUCTION & SPECIFICATION

The LP13 Infra-red Heater is designed to mount directly onto a propane bottle and provide adjustable levels of heating for commercial premises. Due to its low pressure requirement it can burn the gas remaining in bottles which are, for other heaters, 'empty'.

Specification:

Heat output . . . 2.4kW min./4.0kW max. (8400/13700Btu/h)	Injector size . . . 0.96
Gas/Pressure . . . Propane/37mbar	Consumption . . . 0.18kg/h min./0.29kg/h max.



3. CONTENT & ASSEMBLY

3.1. Content

- 3.1.1. Check content against the list below and, in the event of shortages or damage, contact your supplier.

Contents:

- Heater Assembly
- Regulator
- Bracket, Heater Support
- Hose
- Hose Clip x 2
- Wing Nut and Serrated Washer
- Wing Screw x 3

3.2. Assembly

Note: Numbers in brackets refer to the items as shown in the parts diagram, Section 5.

- 3.2.1. Fit the support bracket (1) to the studded lug on the heater assembly using the wing nut (4) and serrated washer (3). In order that the heater angle can be adjusted, install bracket so that the channel side with the single threaded hole faces forward.
- 3.2.2. Fit the channel section of the support bracket over the shroud of the propane bottle and clamp in place using the three wing screws (6). Be sure to fit the channel with the **two** screws on the outside of the shroud and **one**, on the inside, as shown.
- 3.2.3. Fit regulator to bottle by screwing POL nut (7) anticlockwise into port (9) of bottle gas valve (12). Tighten nut with spanner.
- 3.2.4. Join heater valve inlet (A) to regulator outlet (B) with the hose (10) and hose clamps (11). Ensure hose is routed so that it does not touch any part of the heater, which will become hot during operation.
- 3.2.5. Open the bottle valve (12) and, using soapy water, check all joints for leaks.

4. OPERATION

☐ **WARNING! Ensure that you read, understand and apply the safety instructions in Section 1.**

4.1. Lighting heater

- 4.1.1 Open the bottle valve (12).
- 4.1.2 Turn the heater control knob (5) clockwise until it is fully open (Max).
- 4.1.3 Press and hold down the control knob (5) and after a few seconds bring a flame up to the bottom edge of the burner.
- 4.1.4 After the gas ignites continue to hold the control knob down for a further 20 seconds.
- 4.1.5 Turn the control knob anticlockwise to reduce the heat output to the required level.

4.2. Turning off heater

- 4.2.1 Turn heater off by closing the bottle valve (12).

4.3. Changing propane bottle

- 4.3.1 Ensure the bottle valve (12) is closed and then unscrew POL Nut (7) and remove regulator (8).
- 4.3.2 Loosen the three wing screws (6) at the base of the heater support bracket and remove heater from bottle.
- 4.3.3 Fit heater to new propane bottle as in 3.2.2. and 3.2.3. Check for gas leaks as in 3.2.5.

Note: To ensure safe and reliable operation the regulator should not be exposed to rain and the vent (C) in the upper casing must not be allowed to become blocked.

5. PARTS

Issue: 2
Date issued: 190503

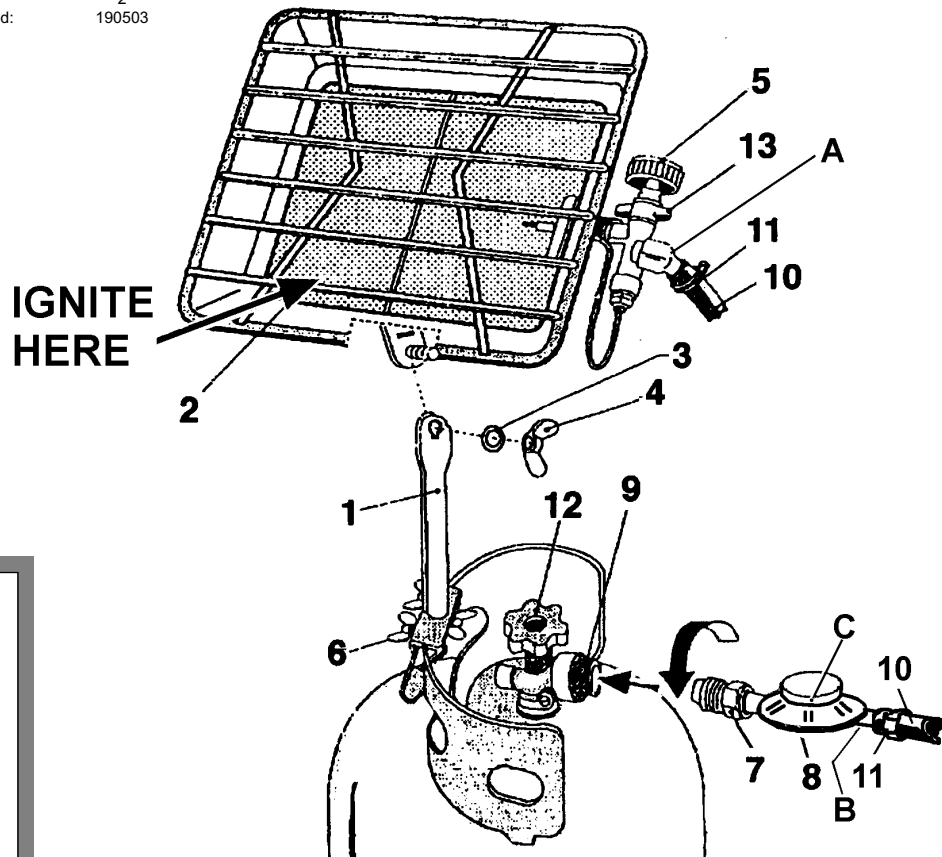

Item	Part No.	Description
1	IN5042040004	Support Bracket
2	IN3003100056	Burner
3	IN5029040001	Washer, Lock
4	IN5029050002	Wing Nut
5	IN5032010008	Knob, Plastic
6	-	Wing Screw
7	-	POL Nut
8	IN5021050008	Regulator, Pressure
9	-	Outlet, Bottle Valve
10	IN5031310010	Hose, Gas
11	IN5042110004	Clamp, Hose
12	-	Valve, Bottle
13	IN5028010014	Gas Valve

INFRA-RED GAS HEATER

Model: LP13

90/396/EEC Gas Appliance Directive
93/68/EEC CE Marking Directive

Declaration of Conformity We, the sole importer into the UK, declare that the product listed here is in conformity with the following standards and directives.



Signed by Mark Sweetman

Date 20th May 2003

The construction file for this product is held by the Manufacturer and may be inspected, by a national authority, upon request to Jack Sealey Ltd.

For Jack Sealey Ltd. Sole importer into the UK of Sealey Power Products.

NOTE: It is our policy to continually improve products and as such we reserve the right to alter data, specifications and component parts without prior notice.

IMPORTANT: No liability is accepted for incorrect use of this equipment.

WARRANTY: Guarantee is 12 months from purchase date, proof of which will be required for any claim.

INFORMATION: For a copy of our latest catalogue and promotions call us on 01284 757525 and leave your full name and address, including postcode.



Sole UK Distributor,
Sealey Group,
Bury St. Edmunds, Suffolk.



01284 757500



01284 703534



sales@sealey.co.uk



www.sealey.co.uk