



INSTRUCTIONS FOR
**RECHARGEABLE INSPECTION LAMP USB 4 SMD
 + 1 SMD LED LITHIUM-ION**

MODEL NO: **LED37**

Thank you for purchasing a Sealey product. Manufactured to a high standard, this product will, if used according to these instructions, and properly maintained, give you years of trouble free performance.

IMPORTANT: PLEASE READ THESE INSTRUCTIONS CAREFULLY. NOTE THE SAFE OPERATIONAL REQUIREMENTS, WARNINGS & CAUTIONS. USE THE PRODUCT CORRECTLY AND WITH CARE FOR THE PURPOSE FOR WHICH IT IS INTENDED. FAILURE TO DO SO MAY CAUSE DAMAGE AND/OR PERSONAL INJURY AND WILL INVALIDATE THE WARRANTY. KEEP THESE INSTRUCTIONS SAFE FOR FUTURE USE.



Refer to
 Instruction
 Manual

1. SAFETY

1.1. GENERAL

- ✓ Ensure the lamp is fully charged before initial use.
- ✗ **DO NOT** turn the lamp on when it is being charged.
- ✗ **DO NOT** shine directly into your, another person's or an animal's eyes.
- ✗ **DO NOT** allow children to use the lamp.
- ✗ **DO NOT** handle or move the lamp whilst it is being charged.
- ✗ **DO NOT** use the lamp if you suspect that the battery or the lamp casing is damaged.
- ✗ **DO NOT** leave battery in a discharged state, recharge battery immediately. Before storage, fully recharge the battery, subsequently recharge the battery at least once every six months of non-use.

1.2. BATTERY SAFETY

- ☐ **WARNING!** To reduce the risk of burns or fire:
- ✗ **DO NOT** attempt to open, disassemble, modify or service the battery pack.
- ✗ **DO NOT** crush, puncture, short external contacts or dispose of in fire or water.
- ✗ **DO NOT** expose to temperatures above 60°C (140°).
- ✓ Replace only with the battery pack designated for this product.
- ✓ Recycle or dispose of used battery as stipulated by local regulation.
- ✓ If the electrolyte in the cells gets on your skin, thoroughly wash with soap and water. If it gets in your eyes, rinse thoroughly with cool water and seek immediate medical attention.

2. INTRODUCTION

Compact design ideal for keeping in tool box, features 4 bright SMD's for use as inspection lamp and 1 SMD for use as a directional torch. Integral hanging hook and a magnetic base which can rotate through 180° to obtain the best angle in hands-free applications. Push on/off button on front of casing. Supplied with USB charging lead.

3. SPECIFICATION

Model no: LED37
 LED quantity: 4 SMD + 1 SMD
 Lumen output side/top:..... 140/70 lm
 Battery:3.7V 650mAh Li-ion
 Operating time side/top:2.5/3hr
 Charging time:.....2hr
 IP rating:.....IP20
 Length:185mm

▲ IMPORTANT WARRANTY INFORMATION

The battery fitted to this lamp is considered to be a consumable item and its ability to accept a charge will reduce over time. We will provide warranty against mechanical and electrical defect for a period of one year - this does not cover fair wear and tear. If the battery is not properly charged before first use, or regularly conditioned, its capacity will diminish. Under these circumstances we will not replace the battery regardless of whether it is less than one year old.

4. OPERATION

Refer to fig.1

- 4.1. Connect the USB lead to the socket on the side of the lamp. Plug USB lead into a power supply and turn on. The charging LED on the lamp will light RED to show that charging has commenced.
- 4.2. When the battery has fully charged the LED will turn GREEN.
- 4.3. Direct the lens away from your eyes before switching on.
- 4.4. Toggle the lamp between the end light and side light using the ON/OFF switch.
- 4.5. The lamp may be suspended by the hook or attached to any ferrous surface by using the magnet.

fig.1

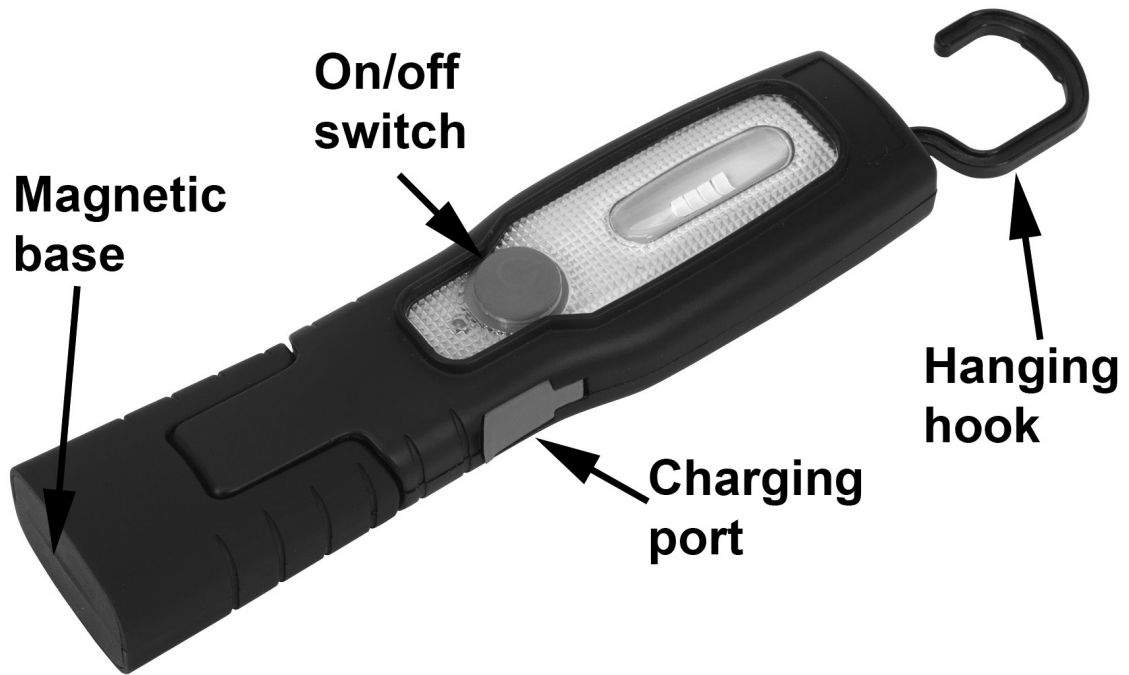

Battery Removal

Remove the 6 screws on the back of the lamp. Remove the back casing and disconnect the wiring from the circuit board. Remove the battery. Dispose of according to local government guidelines.

Under the Waste Batteries and Accumulators Regulations 2009, Jack Sealey Ltd are required to inform potential purchasers of products containing batteries (as defined within these regulations), that they are registered with Valpak's registered compliance scheme. Jack Sealey Ltd's Batteries Producer Registration Number (BPRN) is BPRN00705.



Environmental Protection

Recycle unwanted materials instead of disposing of them as waste. All tools, accessories and packaging should be sorted, taken to a recycling centre and disposed of in a manner which is compatible with the environment. When the product becomes completely unserviceable and requires disposal dispose according to local regulations.



WEEE Regulations

Dispose of this product at the end of its working life in compliance with the EU Directive on Waste Electrical and Electronic Equipment (WEEE). When the product is no longer required, it must be disposed of in an environmentally protective way. Contact your local solid waste authority for recycling information.

NOTE: It is our policy to continually improve products and as such we reserve the right to alter data, specifications and component parts without prior notice.

IMPORTANT: No liability is accepted for incorrect use of this product.

WARRANTY: Guarantee is 12 months from purchase date, proof of which will be required for any claim.



Sole UK Distributor, Sealey Group.
Kempson Way, Suffolk Business Park,
Bury St. Edmunds, Suffolk.
IP32 7AR



01284 757500



01284 703534



www.sealey.co.uk



sales@sealey.co.uk