

Thank you for purchasing a Sealey product. Manufactured to a high standard this product will, if used according to these instructions and properly maintained, give you years of trouble free performance.



IMPORTANT: PLEASE READ THESE INSTRUCTIONS CAREFULLY. NOTE THE SAFE OPERATIONAL REQUIREMENTS, WARNINGS & CAUTIONS. USE THE PRODUCT CORRECTLY AND WITH CARE FOR THE PURPOSE FOR WHICH IT IS INTENDED. FAILURE TO DO SO MAY CAUSE DAMAGE AND/OR PERSONAL INJURY AND WILL INVALIDATE THE WARRANTY. PLEASE KEEP INSTRUCTIONS SAFE FOR FUTURE USE.

1. SAFETY

1.1. GENERAL

- ✓ Ensure the lamp is correctly charged before initial use.
- X **DO NOT** turn the lamp on when it is being re-charged.
- X **DO NOT** shine directly into your, other person's or animal's eyes.
- X **DO NOT** allow children to use the lamp.
- X **DO NOT** handle or move the lamp whilst it is being charged.
- X **DO NOT** use the lamp if you suspect that the battery or the lamp casing is damaged.
- X **DO NOT** leave battery in a discharged state, recharge battery immediately. If the lamp is not in use, recharge the battery every month.

1.2. ELECTRICAL SAFETY FOR USE OF CHARGER.

USE ONLY THE SUPPLIED CHARGER PLUG FOR CONNECTING TORCH TO THE POWER SUPPLY.

WARNING! It is the user's responsibility to read, understand and comply with the following electrical instructions: You must ensure the risk of electric shock is minimised by the installation of appropriate safety devices. An RCCB (Residual Current Circuit Breaker) should be incorporated in the main distribution board. We also recommend that an RCD (Residual Current Device) is used with all electrical products, particularly portable equipment which is plugged into an electrical supply not protected by an RCCB. **You must** also read and understand the following instructions concerning electrical safety.

- 1.2.1. **The Electricity At Work Act 1989** requires all portable electrical appliances, if used on business premises, to be tested by a qualified electrician, using a Portable Appliance Tester (PAT), at least once a year.
- 1.2.2. **The Health & Safety at Work Act 1974** makes owners of electrical appliances responsible for the safe condition of the appliance and the safety of the appliance operator. **If in any doubt about electrical safety, contact a qualified electrician.**
- 1.2.3. **You must ensure that you:**
 - ✓ Inspect the charger plug, cable and connector for wear and damage to ensure items are safe before connecting to the mains power supply. If worn or damaged **DO NOT** use.
 - ✓ Important: Check that the voltage marked on the charger plug is the same as the power supply to be used.
 - ✓ Uncoil the cable between charger and the lamp.

- X **DO NOT** pull the charger plug from the mains socket by the lead.
- X **DO NOT** use any other type of charger with this product.
- X **DO NOT** try to take the charger plug apart.
- X **DO NOT** use the charger plug to charge or power any other electrical item.
- X **DO NOT** get the charger wet, or use in wet, damp conditions (for indoor use only).
- WARNING! NEVER** substitute a standard 13amp 3 pin plug, or any other type of plug, for the charger plug.

2. INTRODUCTION

Robust inspection lamp with lightweight Lithium-ion battery suitable for the professional user. Incorporates 30 super bright LEDs ideal for use in engine bays and under-body inspection. Features 360° swivel hanging hook for hands-free applications. Soft rubber housing for added comfort. Supplied with mains charger.

3. CHARGING

- 3.1 When the lamp is turned on, one of the 3 LEDs next to the handle will briefly light to show the state of charge. See fig.1A. When fully charged the top LED will light green. When half charged the middle LED will light orange. If the bottom LED lights red the lamp is in a state of low charge. If the red LED flashes the lamp must be charged immediately.
 - 3.1.1 Make sure the lamp is switched OFF before charging.
 - 3.1.2 Plug the charger lead into the charging socket at the base of the lamp. See fig.1C.
 - 3.1.3 Plug the transformer plug into the mains supply.
 - 3.1.4 During charging the red LED will remain illuminated. Charging will take approximately 5 hours.
 - 3.1.5 To check the charge level, unplug the charging lead, switch the lamp on and observe which coloured LED briefly illuminates. Switch the lamp off again and reconnect the charger.
 - 3.1.6 When fully charged unplug the charger from the mains supply and remove the charger lead from the lamp.

NOTE: To maintain battery, charge monthly if lamp is not in use.

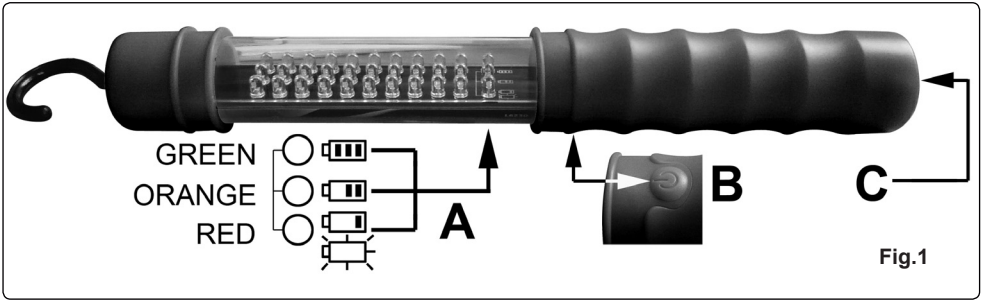

Fig.1

4. OPERATION

- 4.1 Switch the lamp ON & OFF using the push switch (Fig.1B) on the underside of the handle. Direct the lens away from your eyes before switching on.
- 4.2 The lamp can be either hand held or suspended by its hanging hook. When the light is hanging from its hook it can be rotated through 360° for more precise positioning.

NOTE: LED arrays are designed to allow individual LEDs to cease functioning without causing the entire array to fail. This could be as a result of shock or impact. Shock or impact will invalidate warranty.



Environmental Protection.

Recycle unwanted materials instead of disposing of them as waste. All tools, accessories and packaging should be sorted, taken to a recycle centre and disposed of in a manner which is compatible with the environment. When the product is no longer required, it must be disposed of in an environmentally protective way.



Battery Removal

When the lamp has reached the end of its useful life the battery must be removed and disposed of according to local government guidelines. Using a sharp knife slit down the length of each rubber cover and remove them both from the clear tube. Remove the two small screws that hold the circuit board in place and push the circuit board down towards the battery. Ease the black plug which holds the battery in place out of the end of the tube until the connecting wires are accessible. Cut the wires and remove the battery.

5. PARTS

ITEM	PART NUMBER	DESCRIPTION
1	LED3007.V2-01	TOP HOOK
2	LED3007.V2-02	FRONT COVER
3	LED3007.V2-03	HOOK HOLDER
4	LED3007.V2-04	SCREW (2.5*9)
5	LED3007.V2-05	PC TUBE
10	LED3007.V2-10	BATTERY HOLDER
12	LED3007.V2-12	HANDLE COVER
13	LED3007.V2-C	MAINS CHARGER

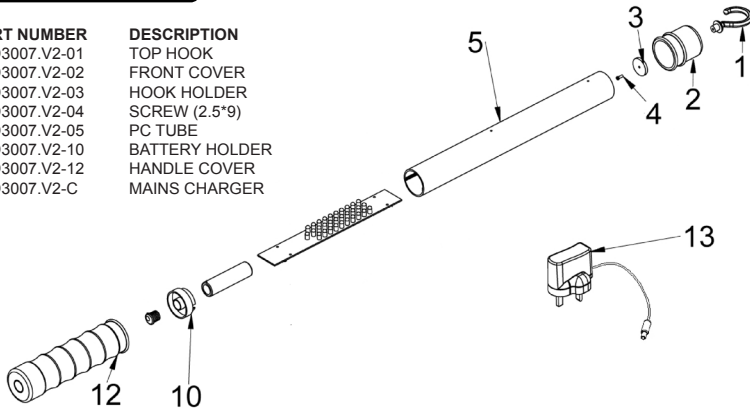

NOTE: It is our policy to continually improve products and as such we reserve the right to alter data, specifications and component parts without prior notice.

IMPORTANT: No liability is accepted for incorrect use of this product.

WARRANTY: Guarantee is 12 months from purchase date, proof of which will be required for any claim.

INFORMATION: For a copy of our latest catalogue and promotions call us on 01284 757525 and leave your full name and address, including postcode.



Sole UK Distributor, Sealey Group,
Kempson Way, Suffolk Business Park,
Bury St. Edmunds, Suffolk,
IP32 7AR

01284 757500

www.sealey.co.uk

01284 703534

sales@sealey.co.uk