



INSTRUCTIONS FOR:

INSPECTION LAMP SLIMLINE 12 SMD 12V

MODEL NO: **LED042**

Thank you for purchasing a Sealey product. Manufactured to a high standard this product will, if used according to these instructions and properly maintained, give you years of trouble free performance.



IMPORTANT: PLEASE READ THESE INSTRUCTIONS CAREFULLY. NOTE THE SAFE OPERATIONAL REQUIREMENTS, WARNINGS & CAUTIONS. USE THE PRODUCT CORRECTLY AND WITH CARE FOR THE PURPOSE FOR WHICH IT IS INTENDED. FAILURE TO DO SO MAY CAUSE DAMAGE AND/OR PERSONAL INJURY AND WILL INVALIDATE THE WARRANTY. PLEASE KEEP INSTRUCTIONS SAFE FOR FUTURE USE.

1. SAFETY

1.1. GENERAL

- WARNING!** Disconnect lamp from power before performing any maintenance.
- DO NOT** shine lamp directly into your, other person's or animal's eyes.
- DO NOT** allow children to use the lamp.
- Maintain the lamp in good condition.
- DO NOT** use the lamp if the lamp is damaged.
- When not in use store the light in a safe, dry, childproof location.
- WARNING!** Ensure Health and Safety, local authority and general workshop practice regulations are adhered to when using this light.
- Wear approved eye protection. A full range of safety equipment is available from your Sealey dealer.
- Wear suitable clothing to avoid snagging.
- DO NOT** wear jewellery and tie back long hair.
- Account for all tools being used and **DO NOT** leave them in or near the engine.

- WARNING:** *The warnings, cautions and instructions discussed in this instruction manual cannot cover all possible conditions and situations that may occur. It must be understood that common sense and caution are factors which must be applied by the operator.*

2. INTRODUCTION

Featuring 12 SMD LEDs mounted in a slimline body allowing use in the tightest of spaces. Resistant to oil, chemicals and water. Suitable for use in industrial and automotive environments. Supplied with both 12V DC vehicle cigarette lighter socket connector and direct battery connector.

3. SPECIFICATION

Model No: **LED042**
SMD Quantity: 12
Lumen Output: 200lm
Dimensions: 300 x 24 x 6mm

4. OPERATION

4.1. CONNECTING TO BATTERY TERMINALS

NOTE: Check the battery is 12V DC. DO NOT use a 6V or 24V battery.

- 4.1.1 Ensure the battery terminals are clean, if necessary clean away any dirt or corrosion.
- 4.1.2 Check to make sure no flammable fumes are present.
- 4.1.3 Clip the red (+) battery clip to the positive terminal and the black (-) clip to the negative terminal on the battery.
- 4.1.4 Check all connections are secure.
- 4.1.5 Turn lamp on by sliding switch to 'On' position, see fig.1.

5. MAINTENANCE

5.1 **WARNING! Be sure to disconnect the lamp from the power supply before carrying out any maintenance.**

- 5.1.1. Keep lamp clean and check for damage before every use. If damage is observed, remove from use until unit is repaired by a qualified electrician.

fig.1

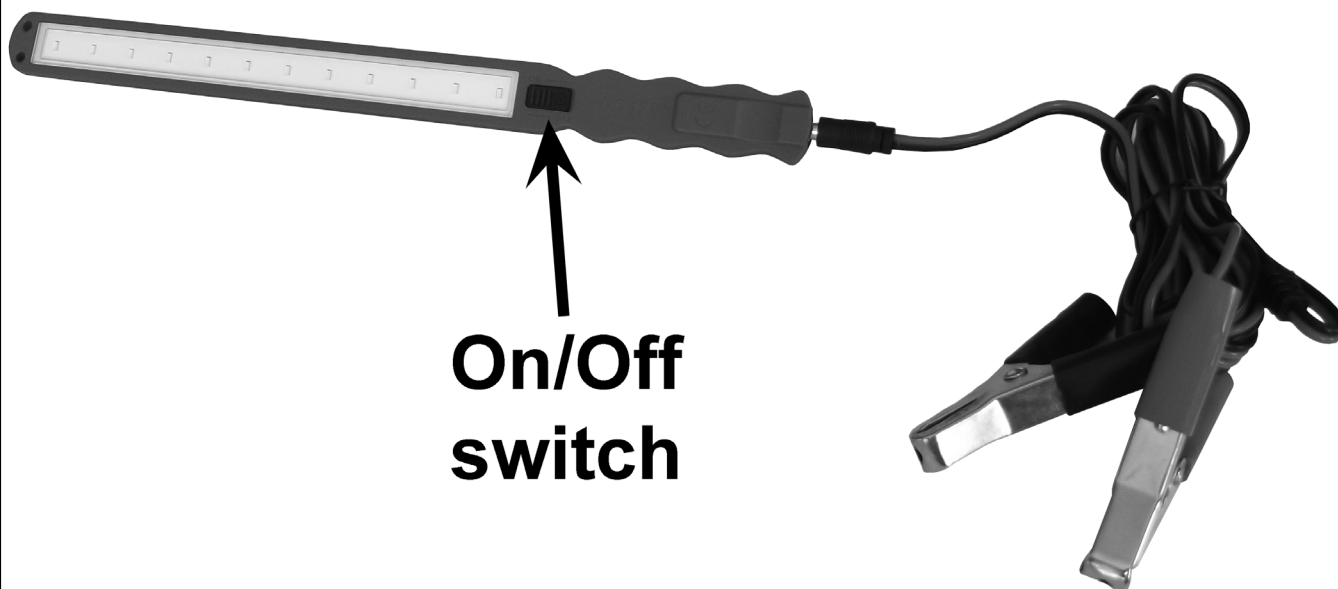

On/Off
switch



Environmental Protection
Recycle unwanted materials instead of disposing of them as waste. All tools, accessories and packaging should be sorted, taken to a recycling centre and disposed of in a manner which is compatible with the environment. When the product becomes completely unserviceable and requires disposal, drain off any fluids (if applicable) into approved containers and dispose of the product and the fluids according to local regulations.



WEEE Regulations
Dispose of this product at the end of its working life in compliance with the EU Directive on Waste Electrical and Electronic Equipment (WEEE). When the product is no longer required, it must be disposed of in an environmentally protective way. Contact your local solid waste authority for recycling information.

Parts support is available for this product. To obtain a listing and/or diagram, please log on to: www.sealey.co.uk,
email: sales@sealey.co.uk or phone: 01284 757500

NOTE: It is our policy to continually improve products and as such we reserve the right to alter data, specifications and component parts without prior notice.

IMPORTANT: No liability is accepted for incorrect use of this product.

WARRANTY: Guarantee is 12 months from purchase date, proof of which will be required for any claim.

INFORMATION: For a copy of our latest catalogue and promotions call us on 01284 757525 and leave your full name and address, including postcode.



Sole UK Distributor, Sealey Group,
Kempson Way, Suffolk Business Park,
Bury St. Edmunds, Suffolk,
IP32 7AR



01284 757500

01284 703534



www.sealey.co.uk

sales@sealey.co.uk