



INSTRUCTIONS FOR: AIR RATCHET WRENCHES

Model No's: **GSA20, GSA20KIT,
GSA21, GSA21KIT.**

Thank you for purchasing a Sealey Product. Manufactured to a high standard this product will, if used according to these instructions and properly maintained, give you years of trouble free performance.



IMPORTANT: PLEASE READ THESE INSTRUCTIONS CAREFULLY. NOTE THE SAFE OPERATIONAL REQUIREMENTS, WARNINGS AND CAUTIONS. USE THIS PRODUCT CORRECTLY AND WITH CARE FOR THE PURPOSE FOR WHICH IT IS INTENDED. FAILURE TO DO SO MAY CAUSE DAMAGE OR PERSONAL INJURY AND WILL INVALIDATE THE WARRANTY. PLEASE KEEP INSTRUCTIONS SAFE FOR FUTURE USE.

1. SAFETY INSTRUCTIONS

- ✓ Follow all workshop safety rules, regulations, and conditions when using wrench.
- ❑ **WARNING!** Disconnect from air supply before changing accessories or servicing.
- ✓ Maintain the wrench in good condition and replace any damaged or worn parts. *Use genuine parts only. Non-authorized parts may be dangerous and will invalidate the warranty.*
- ❑ **WARNING!** Check correct air pressure is maintained and not exceeded. We recommend 90psi.
- ✓ Keep air hose away from heat, oil and sharp edges. Check air hose for wear before each use and ensure that all connections are secure.
- ✓ Only use impact sockets which are specifically designed for use with a ratchet wrench.
- ✓ Wear approved safety eye/face shield, ear defenders, and hand protection.
- ✓ Maintain correct balance and footing. Ensure the floor is not slippery and wear non-slip shoes.
- ✓ Keep children and non essential persons away from the working area.
- x **DO NOT** use the wrench for a task it is not designed to perform.
- ❑ **WARNING! DO NOT** use wrench if damaged or thought to be faulty. (Contact Service Agent).
- x **DO NOT** use wrench unless you have been instructed in its use by a qualified person.
- x **DO NOT** expose the comfort grip to excessive heat.
- x **DO NOT** carry the wrench by the air hose, or yank the hose from the air supply.
- x **DO NOT** operate wrench if you are tired, under the influence of alcohol, drugs or intoxicating medication.
- x **DO NOT** carry wrench with your hand on the power trigger in order to avoid unintentional starting.
- x **DO NOT** direct air from the air hose at yourself or others.
- ✓ When not in use disconnect from air supply and store in a safe, dry, childproof location.

2. INTRODUCTION & SPECIFICATIONS

Feature packed, Third Generation twin pawl air ratchet wrenches with contoured handles which insulate user from chill and vibration. Finger operated trigger and textured grip allows added control even with greasy hands. Low noise exhaust adjusts 360° - keeping air flow away from operator. A four position air regulator, integrated into air inlet, allows adjustment of torque output. The GSA20KIT and GSA21KIT include a selection of impact sockets, extension bars and driver bits.

MODEL No: **GSA20** **GSA21**
Drive size: 3/8" Sq 1/2" Sq
Max torque: . . . 60lb/ft/81Nm 60lb/ft/81Nm
Air consumption: 4cfm 4cfm
Operating pressure: . . . 90psi 90psi
Air inlet size: 1/4" BSP 1/4" BSP
Weight: 1.2kg 1.2kg
Noise Power: 102.89dB . . . 102.89dB
Noise Pressure: 91.81dB 91.81dB
Vibration: 13.88m/s² . . . 13.88m/s²

MODEL No: **GSA20KIT, GSA21KIT**
Impact Sockets: . . . 9,10,11,13,14,17,19mm
DuoMetric coverage: 7/16", 3/4"
Extension Bar: 75mm
Bit Extension Bar: 75mm
Driver Bits: . . Slotted, 5.5mm, Phillips #2, #3

3. PREPARING WRENCH FOR USE

- 3.1. Air Supply.** (Recommended hook-up procedure is shown in fig 1.)
- 3.1.1. Ensure wrench air valve (or trigger) is in the "off" position before connecting to the air supply.
 - 3.1.2. You will require an air pressure of 90psi, and an air flow according to specification.
 - 3.1.3. **WARNING!** Ensure the air supply is clean and does not exceed 90 psi while operating the wrench. Too high an air pressure and unclean air will shorten the product life due to excessive wear, and may be dangerous causing damage and/or personal injury.
 - 3.1.4. Drain the air tank daily. Water in the air line will damage the wrench.
 - 3.1.5. Clean air inlet filter weekly. Recommended hook-up procedure is shown in fig 1.
 - 3.1.6. Line pressure should be increased to compensate for unusually long air hoses (over 8 metres). The minimum hose diameter should be 1/4" I.D. and fittings must have the same inside dimensions.
 - 3.1.7. Keep hose away from heat, oil and sharp edges. Check hose for wear, and make certain that all connections are secure.
- 3.2. Couplings.**

Vibration may cause failure if a quick change coupling is connected directly to the wrench. To overcome this, connect a leader hose to the wrench. A quick change coupling may then be used to connect the leader hose to the air line recoil hose. See figs.1 & 2.

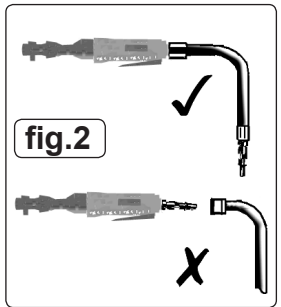
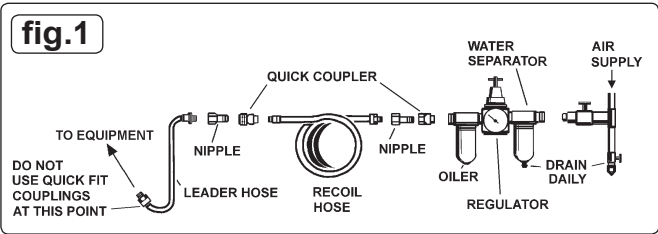

4. OPERATING INSTRUCTIONS

- WARNING!** Ensure you read, understand and apply safety instructions before use.
- 4.1. Only use impact sockets which are specifically designed for use with a ratchet wrench.
 - 4.2. Connect the wrench to the air hose as indicated in section 3.
 - 4.3. Set the integral air regulator to one of the four positions indicated (see fig.3).
 - 4.4. Place the socket over the subject nut and depress the trigger to operate the wrench.
 - 4.5. To change wrench direction turn the switch on the head of the wrench (see fig.3).
DO NOT use any additional force upon the wrench in order to remove a nut.
DO NOT allow wrench to free run for an extended period of time as this will shorten its life.
 - 4.6. The direction of the air flow from the exhaust holes in the central sleeve can be altered by rotating the whole sleeve to a suitable position. The sleeve can be rotated continuously through 360° (see fig.3).

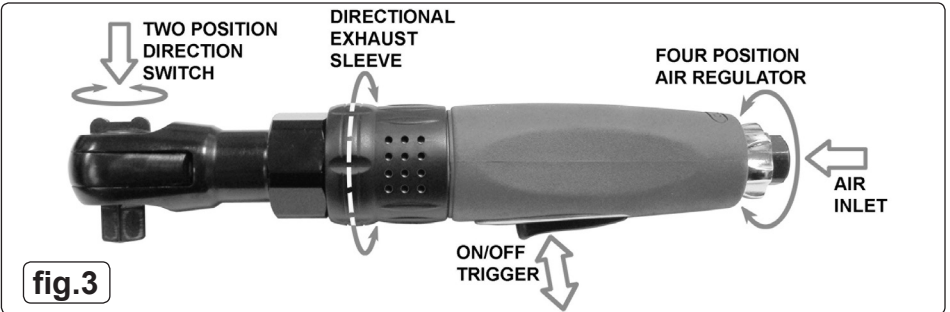

5. MAINTENANCE

- **WARNING!** Disconnect wrench from air supply before changing accessories, servicing or performing maintenance. Replace or repair damaged parts. *Use genuine parts only. Non-authorized parts may be dangerous and will invalidate the warranty.*
- 5.1. If the air system does not have an oiler lubricate the air wrench daily with a few drops of Sealey air tool oil dripped into the air inlet to prolong its life.
- 5.2. Clean the wrench after use. **DO NOT** use worn, or damaged sockets.
- 5.3. Loss of power or erratic action may be due to the following:
 - a) Excessive drain on the air line. Moisture or restriction in the air pipe. Incorrect size or type of hose connectors. To remedy check the air supply and follow instructions in chapter 3.
 - b) Grit or gum deposits in the wrench may also reduce performance. If your model has an air strainer (located in the area of the air inlet), remove the strainer and clean it. Flush the wrench out with gum solvent oil or an equal mixture of SAE No 10 oil and paraffin. Allow to dry before use.
- 5.4. For a full service, contact your local Sealey service agent.
- 5.5. When not in use, disconnect from air supply, clean wrench and store in a safe, dry, childproof location.
- 5.6. Periodically lubricate ratchet yoke drive shaft using grease nipple on side of the ratchet head. This will reduce friction and increase the power and longevity of the tool.

GSA20



GSA21



GSA20 Kit



GSA21 Kit



WARNING! – Risk of Hand Arm Vibration Injury.

This tool is subject to the vibration testing section of the Machinery Directive 2006/42/EC. When operated in accordance with these instructions and tested in accordance with the standard below, results in the following vibration emission declared in accordance with EN 12096:1997

Tested in accordance with: BS EN ISO 28927-2:2009

Measured vibration emission value (a): . . . 13.88 m/s²

Uncertainty value(k): 1.1328 m/s²

These values are suitable for comparison with the vibration emission levels of other tools that have been obtained using the same test method.

This tool may cause hand-arm vibration syndrome if its use is not adequately managed.

A health and safety assessment by the user (or employer) will need to be carried out to determine the suitable duration of use for each tool. Note that the value declared is an average figure from a series of tests according to the applicable standard. The value may differ depending on a number of variables including but not limited to; the user; the condition of the tool; attachments made to the tool i.e. sockets, grinding/cutting discs, sanding discs, blades, handles, leader hoses (always recommended as this helps to reduce vibration).

Correct use and maintenance.

The vibration emission is closely linked to the operating pressure in the air supply. You should ensure that the pressure is set in accordance with our recommendations to assure optimum efficiency with minimised vibration exposure.

Health surveillance.

We recommend a programme of health surveillance to detect early symptoms of vibration injury so that management procedures can be modified to help prevent significant handicap.

Personal protective equipment.

We are not aware of any personal protective equipment (PPE) that provides protection against vibration injury by attenuating the vibration emissions of this tool. We recommend a sufficient supply of clothing (including gloves) to enable the operator to remain warm and dry and maintain good blood circulation in fingers etc.

Guidance relating to the management of hand arm vibration can be found on the HSC website www.hse.gov.uk – Hand-arm Vibration at Work.

NOTE: It is our policy to continually improve products and as such we reserve the right to alter data, specifications and component parts without prior notice.

IMPORTANT: No liability is accepted for incorrect use of this product.

WARRANTY: Guarantee is 12 months from purchase date, proof of which will be required for any claim.

INFORMATION: For a copy of our latest catalogue and promotions call us on 01284 757525 and leave your full name and address, including postcode.



Sole UK Distributor, Sealey Group,
Kempson Way, Suffolk Business Park,
Bury St. Edmunds, Suffolk,
IP32 7AR



01284 757500



www.sealey.co.uk



01284 703534



sales@sealey.co.uk