

Thank you for purchasing a Sealey product. Manufactured to a high standard this product will, if used according to these instructions and properly maintained, give you years of trouble free performance.

IMPORTANT: PLEASE READ THESE INSTRUCTIONS CAREFULLY. NOTE THE SAFE OPERATIONAL REQUIREMENTS, WARNINGS AND CAUTIONS. USE THIS PRODUCT CORRECTLY AND WITH CARE FOR THE PURPOSE FOR WHICH IT IS INTENDED. FAILURE TO DO SO MAY CAUSE DAMAGE AND/OR PERSONAL INJURY AND WILL INVALIDATE THE WARRANTY. PLEASE KEEP INSTRUCTIONS SAFE FOR FUTURE USE.

1. SAFETY INSTRUCTIONS

- WARNING! Ensure any Health & Safety, Government, or local authority regulations are adhered to when using this equipment.**
- ✓ Familiarise yourself with the application and limitations, as well as the potential hazards, of the generator.
- ✓ Maintain the generator in good condition (use an authorised service agent). Replace or repair damaged parts. Use genuine parts only. Unauthorised parts may be dangerous and will invalidate the warranty.
- ✓ This generator is designed and manufactured for specific applications. Do not attempt to modify the unit or use it for any application for which it is not designed. If you have any questions regarding the application of the unit please contact your local Sealey dealer.
- WARNING! DO NOT exceed the Wattage/Amperage capacity of the generator.** Add rated wattage of all devices intended for connection at any one time. The total must not exceed rated wattage of generator (see specification). In most cases the rated wattage of an electrical device can be found on the nameplate. If the nameplate only gives voltage and amperage, multiply the two to give rated wattage (Volts x Amps = Watts)
- WARNING! Generator exhaust gases contain deadly carbon monoxide which must not be inhaled. Always allow sufficient ventilation.**
- WARNING! If you decide to use an Earth Leakage Circuit Breaker (also referred to as an RCD or Ground Fault Circuit Interrupter), it is imperative that the neutral end of the power winding is connected to the frame of the generator set and that the earth lug on the frame is connected with a low impedance connector to the local earth via an earth spike or local protective earth conductor. This connection should only be attempted by a qualified electrician, after first having consulted your local dealer.**
- ▲ **DANGER! This generator is designed for outdoor use only. To use the generator inside any building or enclosure, including the generator compartment of a caravan, may result in fire or an explosion. No user-performed modifications, including venting of the exhaust and/or cooling ventilation, will eliminate the danger.**
- ▲ **DANGER! If this unit is used for back-up power in the event of a commercial power failure, the following steps must be taken. Before connecting the generator to the electrical system, open the main circuit breaker to isolate the generator and system from the commercial electric supply. Failure to do this may result in damage to the generator and may result in serious injury or fatality, due to a back-feed of electrical energy.**
- ▲ **DANGER! The generator produces a very powerful voltage that can cause a severe electrical shock. Avoid contact with bare wires, terminals etc. Never allow any unqualified person to operate or service the generator.**
- WARNING! Petrol is highly flammable and petrol vapour is explosive. Do not permit smoking, naked flames, sparks or heat in the vicinity while handling petrol. Avoid spilling petrol onto a hot engine. Comply with all laws regulating storage and handling of fuels.**
- WARNING! NEVER refuel when the engine is running or when the engine is hot.**
- ✓ Operate the generator only on level surfaces (maximum allowable tilt is 10°) and where it will not be exposed to excessive moisture, dirt or corrosive vapours or be in the proximity of combustible material (flammable liquids, solids or gases).
- ✓ Remove ill fitting clothing, ties, watches, rings and other loose jewellery and contain long hair. Wear appropriate protective clothing.
- ✓ Keep non-essential persons away from the working area.
- WARNING! Never start or stop the generator while electrical loads are connected and switched on. Start the engine, let it stabilise, then connect the electrical load. To stop engine, disconnect the electrical load and let engine stabilise before switching off.**
- WARNING! Do not use worn, bare, frayed or otherwise damaged electrical cables with the generator. To do so may result in electric shock.**
- X **DO NOT** use the generator for any purpose other than that for which it is designed.
- X **DO NOT** operate the generator if any parts are missing or damaged, as this may cause failure and/or personal injury.
- X **DO NOT** over-fill fuel tank. Always leave room for fuel to expand.
- X **DO NOT** operate in the rain.
- ▲ **DANGER! Do not tamper with the engine governed speed setting. Higher operating speeds are dangerous and increase the risk of personal injury and/or equipment damage. The generator supplies the correct rated frequencies and voltages only when running at the correct governed speed. Incorrect frequency and/or voltage can damage some connected electrical loads. Operating at excessively low speeds may result in shortened engine life. Over-speeding will invalidate the warranty.**
- X **DO NOT** operate the generator when you are tired or under the influence of alcohol, drugs or intoxicating medication.
- X **DO NOT** store generator with fuel in tank where petrol vapours might reach an open flame or spark.



2. INTRODUCTION & SPECIFICATION

Compact and lightweight unit capable of running small tools and lights etc. Ideal for roadside, site or leisure use. Powerful and reliable generator fitted with maintenance free brushless alternator. Fitted with 12V battery charging outlet, 230V 3-pin socket and tough composite carry handle.

Motor Power:	2hp	Fuel Tank Capacity:	4.2ltr
Motor Type:	2 Stroke	Max Running Time:	6hrs
Output:	230V - 50Hz/12V DC	Noise Rating LwA:	91dB
Current Rating:	2.8A/5.8A	Dry Weight:	18.5kg
Continuous Power Rating:	650W	Dimensions:	337 x 325 x 382mm
Max Power Rating:	720W		

3. OPERATING INSTRUCTIONS

- ❑ **WARNING! Before use, ensure you read, understand and comply with the safety instructions in this document. Ensure you fully understand the application and limitations, as well as the potential hazards of the generator.**
- ❑ **WARNING! Never connect the generating set earth lead to pipes. Pipes may carry inflammable substances such as gas or domestic fuel and there is a risk of fire or explosion in the event of a short circuit.**
- ❑ **WARNING! Never run the engine without an air filter fitted.**

PRE START-UP OF THE GENERATOR

- ✓ Check the air filter elements to ensure they are clean and in good condition, clean or replace as necessary.

3.1 FILLING WITH FUEL/OIL MIXTURE

- ❑ **WARNING! NEVER refuel when the engine is running or when the engine is hot. Allow cool down time.**

- ❑ **WARNING! Petrol is highly flammable and petrol vapour is explosive.**

- 3.1.1 Ensure the generator set is on a flat horizontal surface strong enough to prevent it from sinking.

- 3.1.2 Ensure all electrical loads are disconnected.

- 3.1.3 Ensure the area around the fuel tank filler hole is clean.

- 3.1.4 Prepare fuel/oil mixture by mixing at a ratio of 50:1 = fuel:oil.

- 3.1.5 Remove the fuel tank filler cap, check the level of the fuel and refill with the recommended fuel if necessary.

- 3.1.6 Do not over-fill the fuel tank, always leave room for the fuel to expand.

3.2 STARTING THE GENERATOR

- ❑ **WARNING! The output sockets will be live once the engine has started.**

- 3.2.1 Ensure you have performed all actions in paragraphs 3.1 above.

- 3.2.2 Turn the fuel valve to the ON position (fig.1).

Note: If starting a warm engine or when the ambient temperature is high, move the choke control to the RUN position.

- 3.2.3 Move the choke lever to the CHOKE position (fig 2).

- 3.2.4 Set the Engine Switch to the I position (fig 2).

Note: Ensure there is sufficient free area behind to prevent personal injury when pulling the rope.

- 3.2.5 Grasp the recoil handle and pull rope slowly until some resistance is felt. Let rope rewind slowly, then pull with a rapid full arm stroke (fig 3). Let rope slowly return.

- 3.2.6 When engine starts, move choke lever to half choke position until engine runs smoothly and then to the RUN position.

- 3.2.7 If engine fails to start, repeat the procedure from paragraph 3.2.5. If it still will not start, refer to 'Trouble-Shooting' section. If necessary contact your authorised Sealey service agent.

3.3 USING THE GENERATOR

- ❑ **WARNING! Do not exceed the wattage capacity of the generator.**

- 3.3.1 Allow the engine to warm up (approximately 3 minutes).

- 3.3.2 Connect the equipment to the generator socket.

- 3.3.3 Always observe the safety instructions for the equipment being used.

- 3.3.4 Carry out the following checks whilst the generator is in use:

Is there any vibration or abnormal noise?

Is there any backfiring or is the engine not running smoothly?

What colour is the exhaust gas? (Is it black or too white.)

- 3.3.5 If you notice any of the above points stop the generator (paragraph 3.4) and contact your local Sealey dealer.

3.4 TO STOP THE GENERATOR

- 3.4.1 Disconnect the electrical load.

- 3.4.2 Allow the engine to run unloaded for 1 - 2 mins.

- 3.4.3 Stop engine by moving the engine switch to the 0 position (fig 2).

- 3.4.4 Turn off the fuel valve (fig 1).

fig 1

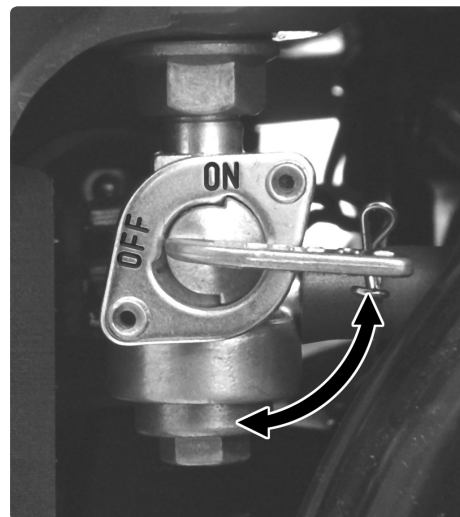

fig 2

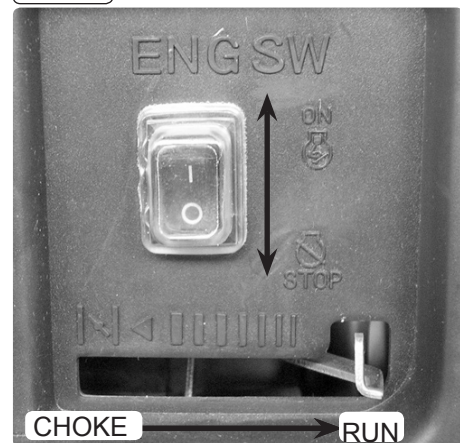
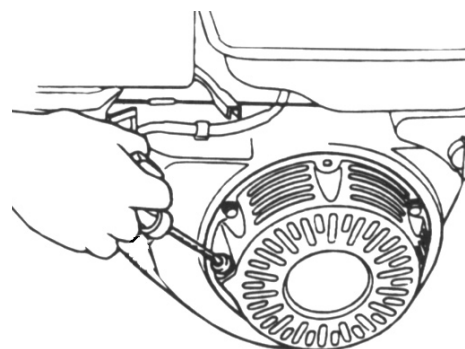

fig 3



4. MAINTENANCE

4.1 GENERAL MAINTENANCE SCHEDULE

- WARNING!** All maintenance work is carried out when the engine is stopped. If the engine must run, ensure that the working area is well ventilated. Exhaust gases contain carbon monoxide; exposure to this toxic gas can cause loss of consciousness and can be fatal.
- WARNING!** If the engine has just been running, the muffler will be very hot, take care not to touch it.
- ✓ Ensure the spark plug HT lead has been disconnected prior to commencing maintenance.
- ✓ All other maintenance must be carried out by qualified staff, contact your local Sealey service agent.

Item	Remarks	Every 50hrs or Monthly	Every 150hrs or 3 Monthly
Spark Plug	Remove carbon	✓	✗
	Adjust gap		
	Replace if necessary		
Air Filter	Clean	✗	✓
	Replace if necessary		
Fuel Filter	Clean	✗	✓
	Replace if necessary		

4.2 MAINTAINING THE AIR FILTER (fig 4)

Note: If the air filter is dirty, air passing towards the carburettor will be restricted. To avoid the carburettor from malfunctioning, clean the air filter regularly. Clean more often when the engine is used in extremely dusty places.

- WARNING!** Never use fuel or solvent to clean the foam element. This can cause a fire or an explosion.

- 4.2.1 Unscrew the two securing screws and remove the air filter cover.
- 4.2.2 Carefully check the element for tears or holes and replace if damaged.
- 4.2.3 Clean the element using compressed air. Replace the element if it is very dirty.

Note: Never attempt to remove dirt with a brush as brushing could imbed the dirt into the fibres.

- 4.2.4 Wash the foam element in household detergent diluted in warm water, rinse with plenty of water and dry thoroughly.
- 4.2.5 Dip the foam element into some clean engine oil and press out to remove any excess oil.

Note: The engine will start smoking during the first start up if too much oil is left on the foam.

- 4.2.6 The refitting procedure is the reverse of the above.

4.3 CLEANING THE FUEL FILTER (fig 5)

- 4.3.1 Close the fuel valve located on the rear of the generator.
- 4.3.2 Remove the fuel cap to expose the fuel filter, remove carefully.
- 4.3.3 Wash the fuel filter with a non flammable high flash point solvent.
- 4.3.4 Dry thoroughly and refit ensuring the lid is fully tightened.
- 4.3.5 Open the fuel valve and check for leaks.

4.4 MAINTAINING THE SPARK PLUG (fig 6)

- WARNING!** If the engine has just been running, the muffler and the spark plug will be very hot, Allow them to cool.
- WARNING!** The spark plug must be correctly tightened. If the plug is not well tightened, it can overheat and damage the engine.

Note: To ensure that the engine performs correctly, the spark plug must not have any deposits on it and its gap must be correct.

- 4.4.1 Remove the spark plug cap and the spark plug using a spark plug wrench.
- 4.4.2 Inspect the spark plug and discard it if the electrodes are worn or if the porcelain is cracked or scaled. If the spark plug is to be re-used, clean with a wire brush.
- 4.4.3 Measure the electrode gap using a feeler gauge. The gap must be between 0.7mm and 0.8mm. Adjustment of the gap can be achieved by bending the side electrode.
- 4.4.4 Check the spark plug washer is in good condition and screw the plug in by hand to avoid cross threading.
- 4.4.5 Once the spark plug is installed, tighten it using a spark plug wrench to compress the washer.

Note: In the case of a new spark plug being fitted, screw it in by hand and tighten it by 1/2 turn with a spark plug wrench to compress the washer. If the spark plug has already been used, screw it in by hand and only tighten it by 1/8 to 1/4 turn to compress the washer.

4.5 CLEANING THE GENERATING SET

- 4.5.1 Clean the generating set using a brush and cloth. Remove dust and debris around the exhaust muffler and the cooling fins.
- WARNING! DO NOT use a jet wash or get the generating set wet.**
- 4.5.2 Clean the engine and alternator air inlets and outlets. Make the most of this cleaning by checking the general condition of the generating set and change any defective or worn parts.

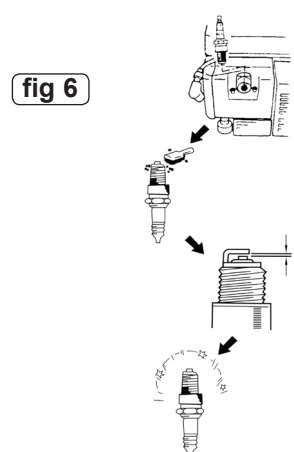
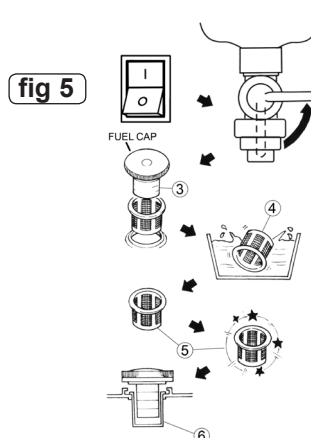
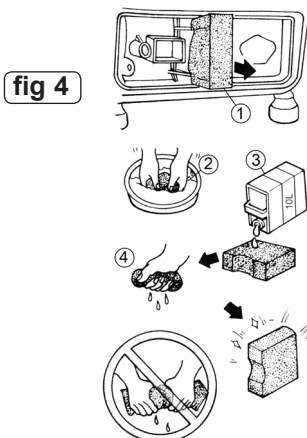

5. STORAGE OF MORE THAN 30 DAYS

Note: If you store the generator for more than 30 days it is essential to protect the fuel system. This can be done by draining all the fuel or by adding a fuel additive to prevent fuel gum deposits from forming.

Note: Store the generator in a safe, dry, childproof area, free of excessive humidity and dust.

- WARNING!** Petrol is highly flammable and petrol vapour is explosive. Do not permit smoking, naked flames, sparks or heat in the vicinity while handling petrol. Avoid spilling petrol onto a hot engine. Comply with all laws regulating storage and handling of fuels.

5.1 CLEAN

5.1.1 Remove debris and dust accumulations from the generating set surfaces.

5.2 DRAINING ALL THE FUEL

5.2.1 Turn the fuel valve ON and siphon the fuel into an approved container.

5.3 USING A FUEL ADDITIVE

5.3.1 Fill the fuel tank with fresh fuel.

Note: If only partially filled, air in the tank will promote fuel deterioration during storage.

5.3.2 Add the fuel stabiliser following the manufacturer's instructions.

5.3.3 Run the engine outdoors for ten minutes to ensure that all untreated fuel has been used.

5.3.4 Stop the engine and move the fuel valve to the OFF position.

5.4 BORE LUBRICATION

5.4.1 Remove the spark plug and pour approximately 25ml of clean engine oil into the cylinder.

5.4.2 Crank the engine several times in order to circulate the the oil into the cylinder, then refit the spark plug.

5.4.3 Slowly pull the recoil starter cord until some resistance is felt, then keep pulling until the arrow on the starter pulley aligns with the hole on the recoil starter.

6. TROUBLESHOOTING

PROBLEM	CAUSE	REMEDY
Engine will not start	Fuel tap not turned on No fuel in tank Engine run switch not turned on Choke not set correctly Spark plug fouled Air filter blocked	Turn fuel on Fill fuel tank Switch to ON position Adjust choke position Clean/replace spark plug Clean/replace air filter
Engine runs rough	Air filter blocked Spark plug fouled Choke not set correctly Dirty/stale fuel	Clean/replace air filter Clean/replace spark plug Adjust choke position Drain and replace fuel

NOTE: It is our policy to continually improve products and as such we reserve the right to alter data, specifications and component parts without prior notice.

IMPORTANT: No liability is accepted for incorrect use of this product.

WARRANTY: Guarantee is 12 months from purchase date, proof of which will be required for any claim.

INFORMATION: For a copy of our latest catalogue and promotions call us on 01284 757525 and leave your full name and address, including postcode.



Sole UK Distributor, Sealey Group,
Kempson Way, Suffolk Business Park,
Bury St. Edmunds, Suffolk,
IP32 7AR



01284 757500



www.sealey.co.uk



01284 703534



sales@sealey.co.uk