

Thank you for purchasing a Sealey Product. Manufactured to a high standard this product will, if used according to these instructions and properly maintained, give you years of trouble free performance.

1. ASSEMBLY INSTRUCTIONS

1.1. Wheel kit for Generators HG55.28.V2 and HG65.30. - Fig.1.

Note: All item numbers refer to the parts shown in fig.1.

- 1.1.1. Fit the wheel axle (10) to the engine end of the frame using the bolts, washers and nuts (1, 3 & 4).
- 1.1.2. Fit the wheels (13) onto the axle (10), ensuring the collared side faces the frame and secure using the retaining washers (9).
- 1.1.3. Fit the front support stand (11) to the alternator end of the frame using the bolts, washers and nuts (2, 3 & 4).
- 1.1.4. Fit the handle (12) to the front support stand (11) and secure using the wing nut (7).
- 1.1.5. Fit the suspension mount to the front support stand and secure using the washer and nut (5 & 6).
- 1.1.6. Ensure all nuts are correctly tightened.

Gen Kit 1 - Contents List

| Item No | Description | Item No | Description |
|---------|--------------------------|---------|---------------------------------|
| 1 | Bolt, M8 x 60mm (qty 2) | 8 | Suspension mount, M10 (qty 1) |
| 2 | Bolt, M8 x 50 mm (qty 2) | 9 | Retaining washer, Ø20mm (qty 2) |
| 3 | Washer, Ø8mm (qty 5) | 10 | Axle |
| 4 | Nut, M8 (qty 4) | 11 | Front support stand |
| 5 | Washer, Ø10mm (qty 1) | 12 | Handle |
| 6 | Nut, M10 (qty 1) | 13 | Wheel (qty 2) |
| 7 | Wing nut, M8 (qty 1) | | |

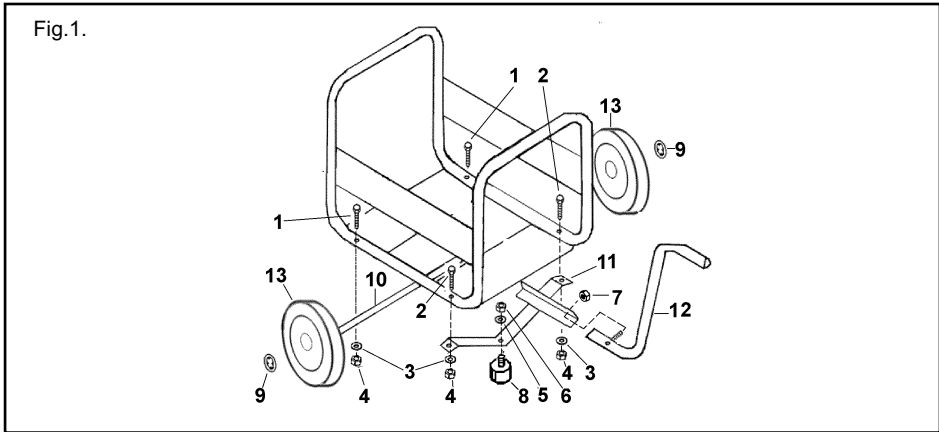

NOTE: It is our policy to continually improve products and as such we reserve the right to alter data, specifications and component parts without prior notice. **IMPORTANT:** No liability is accepted for incorrect use of this equipment. **WARRANTY:** Guarantee is 12 months from purchase date, proof of which will be required for any claim. **INFORMATION:** For a copy of our latest catalogue and promotions call us on 01284 757525 and leave your full name and address including your postcode.