

baridi

Wall Hung Toilet with Soft Close Seat & Rimless Flush, White Gloss



Model No: DH335

Thank you for purchasing a Dellonda product. Manufactured to a high standard, this product will, if used according to these instructions, and properly maintained, give you years of trouble free performance.

Important Information

Please read these instructions carefully. Note the safe operational requirements, warnings & cautions. Use the product correctly and with care for the purpose for which it is intended. Failure to do so may cause damage and/or personal injury and will invalidate the warranty. Keep these instructions safe for future use.



Refer to
instruction
manual

SPECIFICATION

| | |
|--------------------|---------|
| MODEL NO: | DH335 |
| Colour of Product: | White |
| Drainage Distance: | 180mm |
| Flush Method: | Rimless |

| | |
|---------------------------------|-------------------|
| Nett Weight: | 26.5kg |
| Pan Height: | 360mm |
| Product Dimensions (W x D x H): | 365 x 520 x 360mm |
| Type: | Wall Hung |

CONTENTS

| | |
|--|---|
| Wall-hung toilet bowl & Soft close seat | 1 |
| Fixing kit: bolts, wall anchors, washers | 1 |

TOOLS REQUIRED (not supplied)

| | | |
|-------------|--------------|------------------|
| Screwdriver | Spirit level | Spanner |
| Pencil | Drill | Adjustable grips |
| Drill bits | Hacksaw | Silicone sealant |
| Hammer | Pipe cutter | Tape measure |
| Hacksaw | Hex wrench | |

IMPORTANT SAFETY INFORMATION

- ✓ **Check for damage:** Inspect the product immediately for visible damage (cracks, chips,). **DO NOT** install a damaged product. Report any issues to the supplier.
- ✓ **Lift with care:** The product may be heavy or awkward to carry. Use two people and proper lifting technique to avoid strain or injury.
- ✓ This product must be installed and maintained by a qualified plumber in accordance with local plumbing regulations and standards.
- ✗ **DO NOT** modify the toilet or cistern components. Unauthorised modifications may cause leaks, failure, or void the warranty.
- ✗ **DO NOT** overtighten fixing bolts or connections, as this may cause ceramic cracking or breakage.
- ✗ **DO NOT** place the toilet on hard or uneven surfaces without protective padding.
- ✗ **DO NOT** stand, kneel, or place excessive weight on the toilet.
- ✗ **DO NOT** dispose of non-flushable items (e.g. wipes, sanitary products, paper towels) as this may cause blockages or damage.
- ✗ **DO NOT** allow children to play with the toilet or components.
- ✓ Inspect all components before installation. **DO NOT** install if any part is cracked, damaged, or missing.
- ✓ Ensure the toilet is installed on a wall capable of supporting the required load.
- ✓ Always use the supplied seals, washers, and fixings. Substituting components may lead to leaks.
- ✓ Confirm that the water supply pressure complies with the product specifications. Excessive pressure may damage internal fittings.
- ✓ Turn off the water supply before installation or maintenance to prevent flooding or water damage.
- ✓ This toilet is designed for domestic use only unless otherwise specified.
- ✓ Use only mild, non-abrasive cleaning agents. Abrasive or corrosive cleaners may damage the glaze and fittings.

GENERAL HANDLING

- ✓ Wear PPE: Use safety gloves and steel-toe footwear when handling the product or tools.
- ✓ Avoid impact: This product can crack or shatter if dropped. Always handle with care.
- ✓ Keep packaging away from children: Plastic bags and packaging materials are suffocation hazards.



INSTALLATION

Please read these installation procedures carefully and familiarise yourself with all components before beginning. Upon receipt of the toilet, inspect the product immediately and thoroughly for any signs of transit damage or manufacturing defects. **DO NOT** proceed with installation if any issues are identified; contact your supplier for guidance. The toilet is supplied with protective packaging—carefully check all ceramic surfaces for damage. Ensure all required parts, fittings, and accessories are present before starting the installation process.

IMPORTANT: Isolate the water supply before commencing any installation work.

IMPORTANT: Where practicable and safe to do so, leak testing should be carried out progressively throughout the installation process.

PREPARE THE WALL & FRAME

Prepare the wall and frame by first turning off the water supply before beginning any plumbing work. Assess the wall to ensure it is structural or properly reinforced, as wall-mounted toilets must be securely fixed to a load-bearing wall or reinforced stud frame. Install the in-wall carrier frame by positioning it at the desired toilet bowl height (typically around 400 mm from the finished floor to the rim of the bowl, adjustable as required). Use a spirit level to confirm the frame is perfectly vertical and horizontal, then drill and securely fix it to wall studs or a solid wall using heavy-duty anchors and bolts. Finally, secure the carrier frame to the floor to provide additional stability and support (see Fig.1).

fig.1

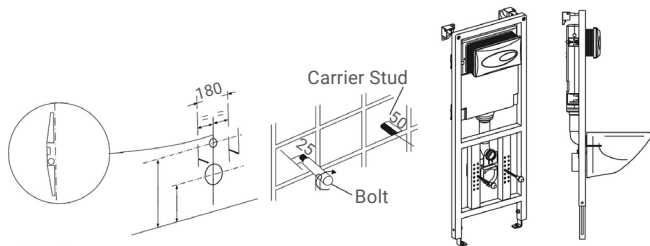
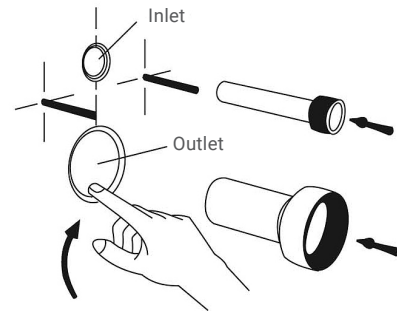

fig.2



ATTACH CONNECTION PIPE (WASTE PIPE)

Connect the waste outlet to the existing drain pipe (see Fig. 2), ensuring it is correctly aligned with the carrier frame outlet and installed with the required fall to allow proper drainage. The waste pipe must be securely jointed, adequately supported, and installed in accordance with local plumbing codes.

Connect the cold water supply to the cistern inlet (typically ½"), ensuring all fittings are tight and leak-free. Position both the flush pipe and the waste pipe so they pass cleanly through the designated access holes in the wall lining (tiles or drywall), ready for final connection after the wall finish is completed.

Once the plumbing has been tested and confirmed to be leak-free, cover the carrier frame with moisture-resistant plasterboard or cement board suitable for wet areas. Carefully cut precise openings for the flush actuator, flush pipe, and waste pipe, ensuring all components remain accessible and correctly aligned. Finish the wall surface as planned (for example, tiling), taking care not to disturb the frame or pipework during this process.

fig.3

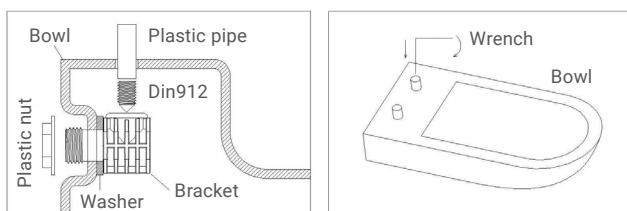

INSTALL THE TOILET BOWL

Before installation, lightly lubricate the seals on the waste and flush pipes to ease connection. Carefully slide the toilet bowl onto the carrier frame, ensuring the flush and waste connections are correctly aligned (see fig.3). Push the bowl back until it seats fully against the wall and the seals are fully engaged. Secure the bowl using the supplied nuts, washers, and bolts fitted to the threaded rods protruding from the frame, tightening evenly to avoid over-torquing and potential damage to the ceramic. Before final tightening, check that the bowl is level and correctly positioned.

CONNECT WATER & TEST / FINISHING TOUCHES

Turn on the water supply and operate the flush to check for leaks at the cistern, water supply connection, and bowl joints. Confirm that the toilet flushes correctly, the bowl drains properly, and the flush plate operates as intended. Once testing is complete, apply a neat bead of sanitary silicone around the perimeter between the toilet bowl and the wall to improve hygiene and provide moisture protection. Install the toilet seat in accordance with the manufacturer's instructions, noting that many seats clip on from above for ease of adjustment. Finally, fit the flush plate into its mounting bracket, ensuring it is securely positioned and allows easy access to the cistern controls.

Environment Protection and Waste Protection

Recycle unwanted packaging materials. When this product is no longer required, or has reached the end of its useful life, please dispose of it in an environmentally friendly way. Drain any fluids (if applicable) into approved containers, in accordance with local waste regulations. It is our policy to continually improve products and we reserve the right to alter data, specifications and parts without prior notice. No liability is accepted for incorrect use of this product. Guarantee is 12 months from purchase date, proof of which is required for any claim.

Jack Sealey Ltd t/a Baridi, Kempson Way, Suffolk Business Park, Bury St Edmunds, Suffolk, IP32 7AR UK
Jack Sealey (EU) Ltd t/a Baridi, Farney Street, Carrickmacross, Co. Monaghan, A81 PK68 Ireland
Tel: 01284 757575 • **Email:** support@baridi.co.uk • **Web:** www.baridi.co.uk