

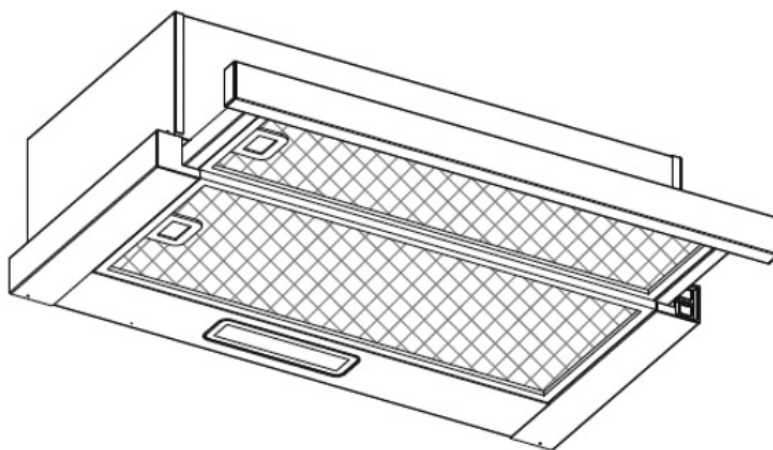

Telescopic Cooker Hood with Aluminium Filters 60cm - Stainless Steel / Black



Model No. DH286 DH287

Thank you for purchasing a Dellonda product. Manufactured to a high standard, this product will, if used according to these instructions, and properly maintained, give you years of trouble free performance.

Important Information

Please read these instructions carefully. Note the safe operational requirements, warnings & cautions. Use the product correctly and with care for the purpose for which it is intended. Failure to do so may cause damage and/or personal injury and will invalidate the warranty. Keep these instructions safe for future use.



Refer to
instruction
manual



Warning:
Hot
Surface

SPECIFICATION

Airflow: 350m³/h
Cable Length: 1.5m
Colour: Stainless steel 430 DH286, Black DH287
Control: 2 Speed Rocker switch
Design: Telescopic
Energy Efficiency Class: A+ : Energy Rating: A+
Lamp power: 2W
Nett weight: 5.5kg
Power: 33W
Product Depth (Front to Back): 440mm
Product dimensions: 60 x 44 x 19.5cm
Product Height (Floor to Top): 19.5mm
Product Width (Side to Side): 600mm
Supply: 220-240V
Type: Wall Mounted

SAFETY INSTRUCTIONS

• ELECTRICAL SAFETY

- **WARNING!** It is the user's responsibility to check the following:
- Check all electrical equipment and appliances to ensure that they are safe before using.
- Inspect power supply leads, plugs and all electrical connections for wear and damage.
- Ensure that the insulation on all cables and on the appliance is safe before connecting it to the power supply.
- **DO NOT** use worn or damaged cables, plugs or connectors.
- Ensure that any faulty item is repaired or replaced immediately by a Sealey qualified technician.
- If the cable or plug is damaged during use, switch off the electricity supply and remove from use.
- Sealey recommend that an RCD (Residual Current Device) is used with all electrical products.
- **Important:** Ensure that the voltage rating on the appliance suits the mains power supply.
- **DO NOT** pull or carry the appliance by the power cable.
- **DO NOT** pull the plug from the socket by the cable.

• GENERAL SAFETY

- This manual explains the proper installation and use of your cooker hood, please read it carefully before using even if you are familiar with the product. The manual should be kept in a safe place for future reference.
- **DO NOT** try to use the cooker hood without the grease filters or if the filters are excessively greasy!
- **DO NOT** install above a cooker with a high level grill.
- **DO NOT** leave frying pans unattended during use because overheated fats or oils might catch fire.
- Never leave naked flames under the cooker hood.
- **DO NOT** flambé under the range hood.
- If the cooker hood is damaged, do not attempt to use.
- **DO NOT** flambé under the cooker hood.
- **CAUTION:** Accessible parts may become hot when used with cooking appliances.
- The minimum distance between the supporting surface for the cooking vessels on the hob and the lowest part of the cooker hood, when the cooker hood is located above a gas appliance, shall be at least 65 cm.(fig.2).
- **ALWAYS:**
- Important! Always switch off the electricity supply at the mains during installation and maintenance such as light bulb replacement.
- The cooker hood must be installed in accordance with the installation instructions and all measurements followed.
- All installation work must be carried out by a competent person or qualified electrician.
- Please dispose of the packing material carefully. Children are vulnerable to it.
- Pay attention to the sharp edges inside the cooker hood especially during installation and cleaning.
- Make sure the ducting has no bends sharper than 90 degrees as this will reduce the efficiency of the cooker hood.
- **WARNING!** Failure to install the screws or fixing device in accordance with these instructions may result in electrical hazards.
- **WARNING!** Before obtaining access to terminals, all supply circuits must be disconnected.
- Always put lids on pots and pans when cooking on a gas cooker.
- When in extraction mode, air in the room is being removed by the cooker hood. Please make sure that proper ventilation measures are being observed.
- There shall be adequate ventilation of the room when the range hood is used at the same time as appliances burning gas or other fuels.
- The cooker hood removes odours from room but not steam.
- Cooker hood is for domestic use only.

- Children from age 8 years and above, persons with reduced physical, sensory, or mental capabilities those with lack of experience and knowledge can use the appliance, if they have been given supervision or instruction concerning the use of the appliance in a safe way to understand the hazards involved.
- Children shall not play with the appliance. Cleaning and user maintenance shall not be made by children without supervision.
- **WARNING!** Before obtaining access to terminals, all supply circuits must be disconnected.
- The appliance shall be disconnected from its power source during service and when replacing parts.
- **CAUTION:** The appliance and its accessible parts can become hot during operation. Be careful to avoid touching the heating elements. Children younger than 8 years old should stay away unless they are under permanent supervision.
- There is a fire risk if cleaning is not carried out in accordance with the instructions
- Regulations concerning the discharge of air have to be fulfilled.
- Clean your appliance periodically by following the method given in the chapter MAINTENANCE.
- For safety reason, please use only the same size of fixing or mounting screw which are recommended in this instruction manual.
- Regarding the details about the method and frequency of cleaning, please refer to maintenance and cleaning section in the instruction manual.
- Cleaning and user maintenance shall not be made by children without supervision.
- When the cooker hood and appliances supplied with energy other than electricity are simultaneously in operation, the negative pressure in the room must not exceed 4 Pa (4×10^{-5} bar).
- **WARNING!** Danger of fire: do not store items on the cooking surfaces.
- A steam cleaner is not to be used.
- NEVER try to extinguish a fire with water, but switch off the appliance and then cover flame e.g. with a lid or a fire blanket.

• INSTALLATION (VENT OUTSIDE)

• V-FLAP MOUNTING

- If the cooker hood does not have an assembled V-flap 1, mount the half-parts to its body. The images only show an example of how to mount the V-flap, the outlet may be various according to different models and configuration.
- To mount the V-flap 1:
- Mount two halves 2 into the body 6
- pin 3 should be on the top;
- the axle 4 should be inserted in the holes 5 on body;
- repeat all the operations for the 2nd half.

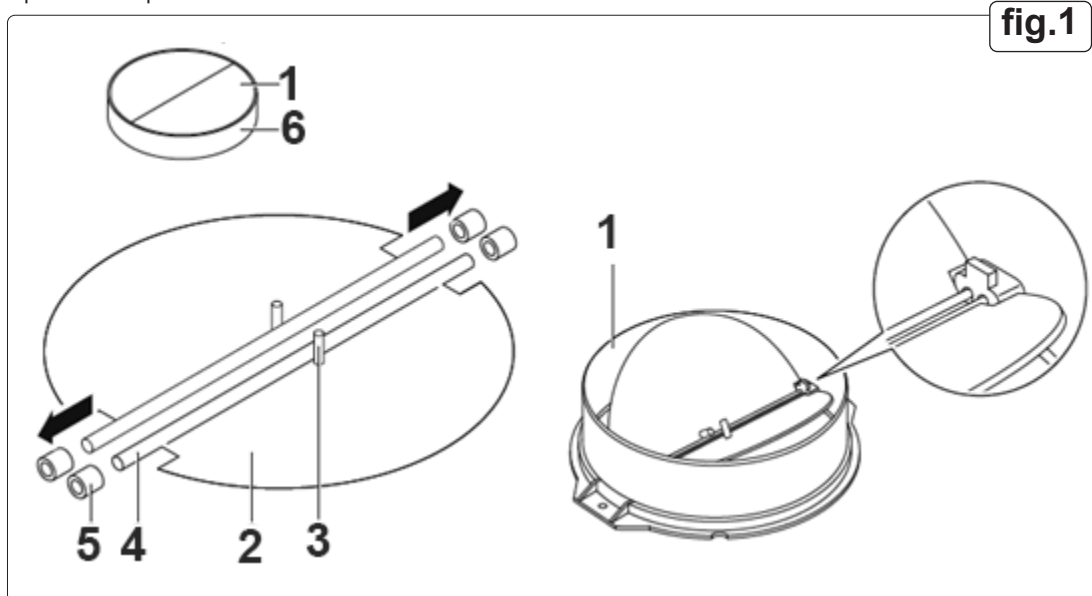

fig.1

• INSTALLATION (WALL MOUNTING)

- Decide the location of the holes for fixing the cooker hood.

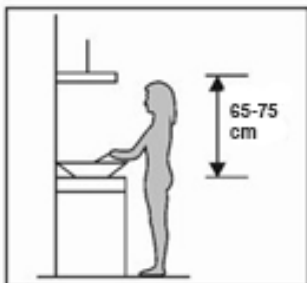

fig.2

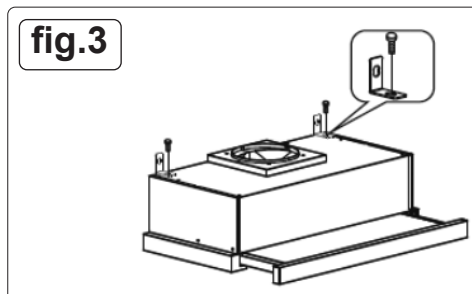
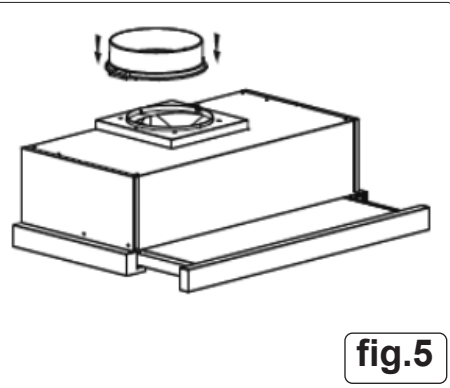
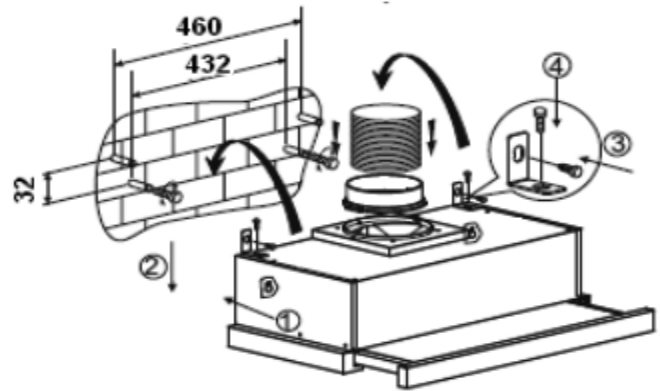
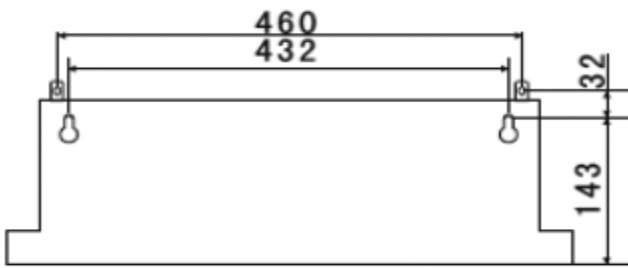

fig.3

- Install the L-shaped bracket on the top of the hood by two screws (4mm x 10mm).(fig.3).
- The cooker hood is wall mounted by 4 screws (4mm x 30mm) and wall plugs.
- Mount the cooker hood on the wall on the back of the cooker hood by 2 screws (4mm x 30mm) and wall plugs. Then fix the cooker hood on the wall by 2 screws (4mm x 30mm) and wall plugs through the small L-shaped bracket.

fig.4**fig.5**

• **INSTALLATION (CABINET MOUNTING) (fig.6).**

- Fix the one-way-valve to the air outlet of the cooker hood.
- Mount the cooker hood on the cabinet by 6 screws (4x35mm) and flat washers.
- If there is gap between the wall and the cooker hood, you may install the L-shaped bracket on the bottom of the hood by two screws (3 x 12mm).
- The installation of the L-shaped bracket is optional.

NOTE: The expansion pipe is not included in the product.

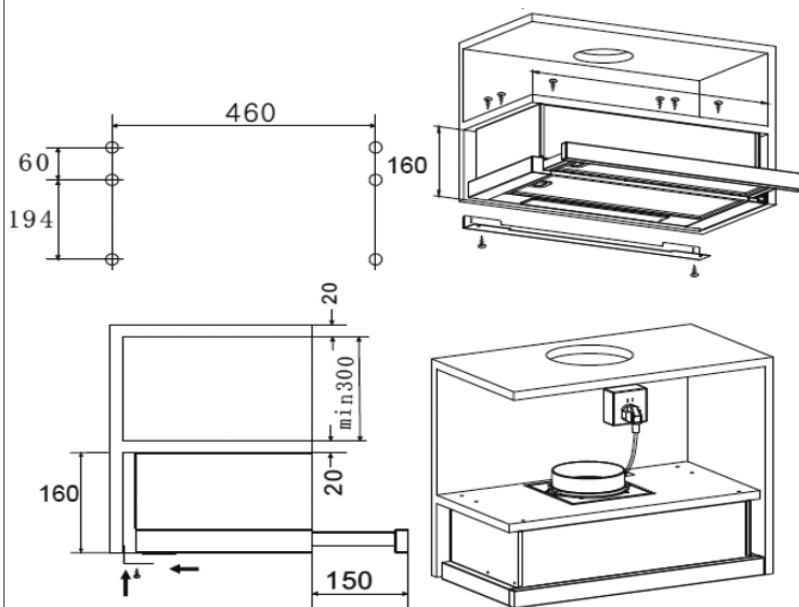
fig.6

- **WARNING!** For safety reason, please use only the same size of fixing or mounting screws which are recommended in this instruction manual. Failure to install the screws or fixing device in accordance with these instructions may result in electrical hazards.

• OPERATION (fig.7).

fig.7

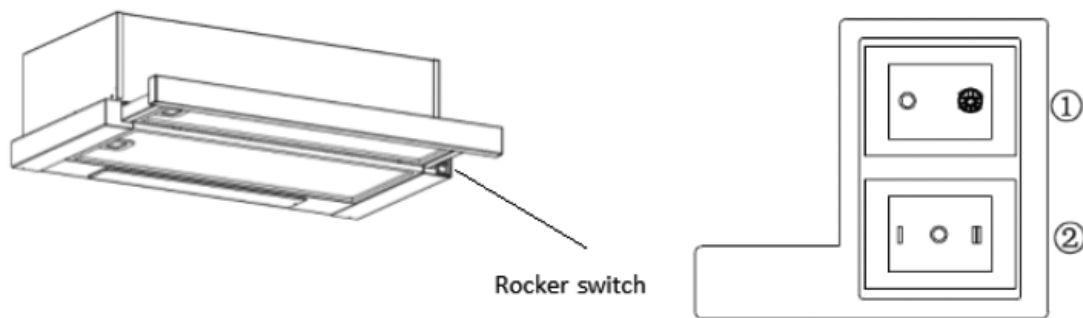

- Insert the plug into the mains supply.
- Push switch 1 to "I", the lamp will be on; push switch 1 to "0", the lamp will be off.
- Push the switch 2 into "I, II", the motor will be on "low, high" two speeds, push into "0", the motor will be off.
- The power will be connected when pull out the front panel. Conversely, the power will be automatically disconnected

• TROUBLESHOOTING

Fault	Cause	Solution
Light on but motor does not work	Fan switch turned off	Select a fan switch position
	Fan switch failed	Contact service centre
	Motor failed	Contact service centre
Light does not work, motor does not work	House fuses blown	Reset/replace fuses
	Mains cable loose or disconnected	Refit mains power cable to power outlet. Switch power on.
Leakage	One way valve and the outlet are not tightly sealed	Remove one way valve and seal with sealant
	Leakage from the connection of chimney and cover	Take chimney down and seal
Lights not working	Broken or faulty bulbs	Replace bulbs as per instructions in this manual
Insufficient suction	Distance between the cooker hood and the gas hob is too great	Refit the cooker hood to the correct distance
Cooker hood inclines	Fixing screws are not tight enough	Tighten the hanging screw and make horizontal

• MAINTENANCE AND CLEANING

- **WARNING!** Before maintenance or cleaning is carried out, the cooker hood should be disconnected from the main power supply. Ensure that the cooker hood is switched off at the wall socket and the plug removed.
- External surfaces are susceptible to scratches and abrasions, so please follow the cleaning instructions to ensure the best possible result is achieved without damage.
- **GENERAL**
- Cleaning and maintenance should be carried out with the appliance cold especially cleaning. Avoid leaving alkaline or acid substances (lemon juice, vinegar etc.) on the surfaces.
- **STAINLESS STEEL**
- The stainless steel must be cleaned regularly (e.g. weekly) to ensure long life expectancy. Dry with a clean soft cloth. A specialised stainless steel cleaning fluid may be used.
- **NOTE:** Ensure that wiping is done along with the grain of the stainless steel to prevent any unsightly criss-cross scratching patterns from appearing.
- **CONTROL PANEL SURFACE**
- The control panel can be cleaned using warm soapy water. Ensure the cloth is clean and well wrung before cleaning. Use a dry soft cloth to remove any excess moisture left after cleaning.
- **IMPORTANT**
- **Use mild detergents and steer clear of harsh cleaning agents, strong household cleaners, or products with abrasives, as these can damage the appliance's appearance, potentially erase printed artwork on the control panel, and void the manufacturer's warranty.**
- **GREASE MESH FILTERS (fig.8)**
- The mesh filters can be cleaned by hand. Soak them for about 3 minutes in water with a grease-loosening detergent then brush it gently with a soft brush. Do not apply too much pressure, to avoid damage . (Leave to dry naturally out of direct sun light).
- Filters should be washed separately to crockery and kitchen utensils. It is advisable not to use rinse aid.

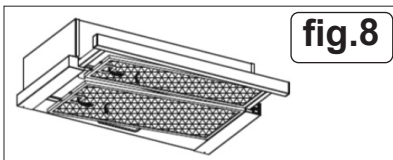

fig.8

• **INSTALLING GREASE MESH FILTERS** (fig.8).

- To install filters:
- - Angle the filter into slots at the back of the hood.
- - Push the button on handle of the filter.
- - Release the handle once the filter fits into a resting position.
- - Repeat to install all filters.

• **CARBON FILTERS** (fig.9).

- Activated carbon filter can be used to trap odours. Normally the activated carbon filter should be changed at three or six months according to your cooking habits. The installation procedure of activated carbon filter is as below.
- 1. **WARNING** Before installing or replacing the carbon filters, remove from mains supply.
- 2. Match the hole of carbon filter to the installation buckle on the both sides of blower.
- 3. Turn the carbon filter until you feel it click into place.
- 4. If you want to replace the filter, turn it anticlockwise until remove it.

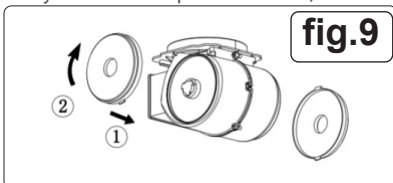

fig.9

- **NOTE:** Make sure the filter is securely locked. Otherwise, it could loosen and be dangerous.
- When the activated carbon filter is fitted, the suction power will be lowered.

• **BULB REPLACEMENT**

- The bulb must be replaced by the manufacturer, its service agent or similarly qualified persons.
- **WARNING!** Always switch off the electricity supply before carrying out any operations on the appliance. When handling bulb, make sure it is completely cool down before any direct contact to hands.
- When handling hood hold with a cloth or gloves to ensure perspiration does not come in contact with the hood as this can reduce the life of the hood.
- Remove the grease filter.
- Locate the junction box, unscrew the screws on the junction box cover, then take off the junction box cover. If there is wire retaining plate this needs to be dismantled first. See fig.10.

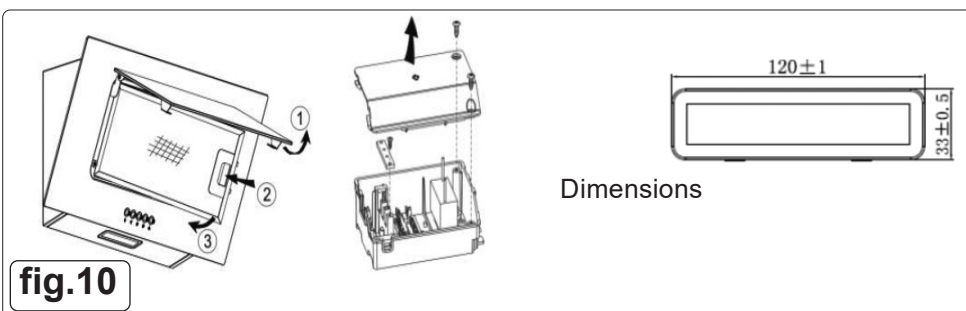

fig.10

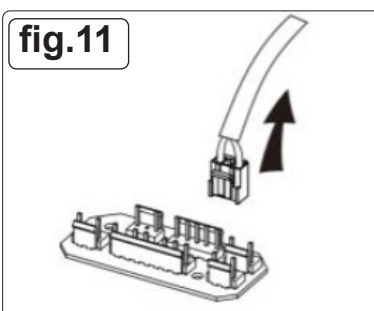

fig.11

- Locate the terminal of the light connecting wire disconnect. (See fig.10).
- Unscrew the screws on the junction box cover, then take down the junction box cover (If there is wire pressing plate which pressed the light wire, the wire pressing plate needs to be dismantled first).
- Find out the terminal of the light connecting wire and dismantle it. (See fig.11).
- 1. Use a tool or the hand to press the spring splinter of both sides of LED light to the inside, until the light is pressed out, then slightly pull the light connecting wire out. (See fig.12 and fig.13).

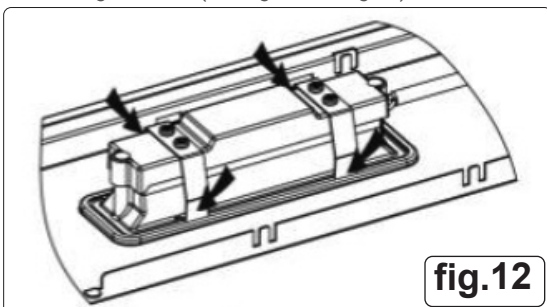

fig.12

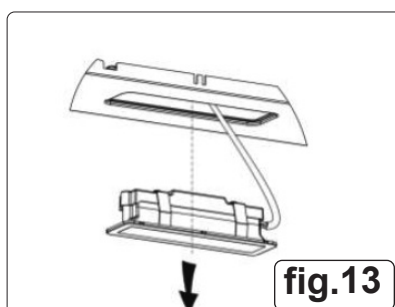

fig.13

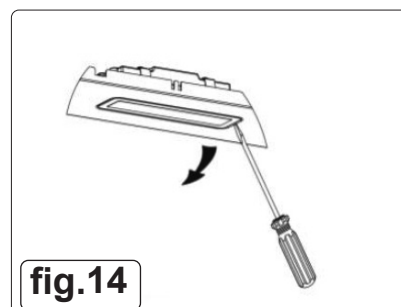

fig.14

- 2. Alternatively
- Use straight screwdriver to prize up the **LED** light bottom edge, (see fig.14). then slightly pull out the **LED** light and light connecting wire. (See fig.13).
- Apply the reverse procedure to install the light back.
- Refitting is the reverse procedure.
- **ILCOS** D code for this lamp is: **DBS-2/65-H-120/33**
- **LED** modules –rectangle lamp
- Max wattage: 1× 2W
- Voltage range: **AC** 220-240V
- dimensions see fig.10.

• **END OF LIFE**

- Disconnect from mains supply and remove from operating position.
- Dismantle chimney assembly.
- Recycle components according to regional regulations in force.

Environment Protection and Waste Protection and Electrical Equipment Regulations (WEEE)

Recycle unwanted packaging materials. When this product is no longer required, or has reached the end of it's useful life, please dispose of it in an environmentally friendly way. Drain any fluids (if applicable) into approved containers, in accordance with local waste regulations. Under the Waste Batteries and Accumulators Regulations 2009, Dellonda would like to inform the user that this product contains one or more batteries. It is our policy to continually improve products and we reserve the right to alter data, specifications and parts without prior notice. No liability is accepted for incorrect use of this product. Guarantee is 12 months from purchase date, proof of which is required for any claim.

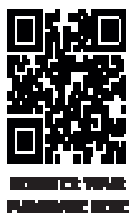

Jack Sealey Ltd t/a Baridi, Kempson Way, Suffolk Business Park, Bury St Edmunds, Suffolk, IP32 7AR UK

Jack Sealey (EU) Ltd t/a Baridi, Farney Street, Carrickmacross, Co. Monaghan, A81 PK68 Ireland

Tel: 01284 757575 • **Email:** support@baridi.co.uk • **Web:** www.baridi.co.uk

Product Information Sheet. Hoods

SUPPLIER_NAME_OR_TRADEMARK

Dellonda EU Ltd.

DELEGATED_ACT

66/2014/EU

MODEL_IDENTIFIER

DH286

Baridi Telescopic Cooker Hood with Aluminium Filters 60cm - Stainless Steel

ADDRESS

Farney Street, Carrickmacross, Co. Monaghan, A81 PK68 Ireland

PHONE_NUMBER

01284 757 500

EMAIL_ADDRESS

TechnicalCompliance@dellonda.co.uk

Parameter

Verification tolerances

Annual energy consumption, AEChood. kWh/a	11
Time increase factor.	1.2
Fluid dynamic efficiency.	23.1
Energy efficiency index.	38.0
Measured air flow rate at best efficiency point.	143.6
Measured air pressure at best efficiency point.	115
Maximum air flow.	315.3
Minimum air flow.	154.3
Measured electric power input at best efficiency point.	19.9
Nominal power of the lighting system.	2.4
Average illumination of the lighting system on the cooking surface.	77
Measured power consumption in standby mode.	-
Measured power consumption off mode.	0.48
Sound power level, highest setting. dB	59
Sound power level, lowest setting. dB	43
Suppliers website	https://www.dellonda.co.uk/

Product Information Sheet. Hoods

SUPPLIER_NAME_OR_TRADEMARK Dellonda EU Ltd.
 DELEGATED_ACT 66/2014/EU
 MODEL_IDENTIFIER DH287

Baridi Telescopic Cooker Hood with Aluminium Filters 60cm - Black

ADDRESS Farney Street, Carrickmacross, Co. Monaghan, A81 PK68 Ireland
 PHONE_NUMBER 01284 757 500
 EMAIL_ADDRESS TechnicalCompliance@dellonda.co.uk

Parameter	Verification tolerances
Annual energy consumption, AEC _{hood} . kWh/a	11
Time increase factor.	1.2
Fluid dynamic efficiency.	23.1
Energy efficiency index.	38.0
Measured air flow rate at best efficiency point.	143.6
Measured air pressure at best efficiency point.	115
Maximum air flow.	315.3
Minimum air flow.	154.3
Measured electric power input at best efficiency point.	19.9
Nominal power of the lighting system.	2.4
Average illumination of the lighting system on the cooking surface.	77
Measured power consumption in standby mode.	-
Measured power consumption off mode.	0.48
Sound power level, highest setting. dB	59
Sound power level, lowest setting. dB	43
Suppliers website	https://www.dellonda.co.uk/