



Baridi 12" Pedestal Fan with Remote Control, 12 speeds, 90° 3D Oscillation, Adjustable Height & Pivoting Fan Head, Back Light Function, 12hr timer, Grey,



Models: DH264

Thank you for purchasing a Dellonda product. Manufactured to a high standard, this product will, if used according to these instructions, and properly maintained, give you years of trouble free performance.

Important Information

Please read these instructions carefully. Note the safe operational requirements, warnings & cautions. Use the product correctly and with care for the purpose for which it is intended. Failure to do so may cause damage and/or personal injury and will invalidate the warranty. Keep these instructions safe for future use.



Refer to
instruction
manual



Indoor use
only

SPECIFICATION

MODEL NO:	DH264		
Colour of Product:	Grey	No. of blades:	5
Maximum Airflow:	31.4m³/min	Ambient Operating Temperature:	23°C ± 2°C
Air Velocity:	6.2m/s	Tropical Climate:	T
Fan Diameter:	300mm		
Height:	1150mm		
Plug Type:	3-Pin BS		
Power Supply Cable Length:	1.6m		
Power:	50W		
Dimensions (WxDxH):	360 x 340x x1150mm		
Speeds:	12		
Supply:	230V 50-60Hz		

SAFETY INSTRUCTIONS

- **WARNING!** The warnings, cautions and instructions in this manual cannot cover all possible conditions and situations that may occur. It must be understood by the operator that common sense and caution are factors which cannot be built into this product, but must be applied by the operator.

This manual explains the proper use of your fan, please read it carefully before using even if you are familiar with the product. The manual should be kept in a safe place for future reference.

ELECTRICAL SAFETY

- **WARNING!** It is the user's responsibility to check the following:
- Check all electrical equipment and appliances to ensure that they are safe before using.
- Inspect power supply leads, plugs and all electrical connections for wear and damage.
- Ensure that the insulation on all cables and on the appliance is safe before connecting it to the power supply.
- **DO NOT** use worn or damaged cables, plugs or connectors.
- Ensure that any faulty item is repaired or replaced immediately by a Dellonda qualified technician.
- If the cable or plug is damaged during use, switch off the electricity supply and remove from use.
- We recommend that an **RCD** (Residual Current Device) is used with all electrical products.
- **Important:** Ensure that the voltage rating on the appliance suits the mains power supply.
- **DO NOT** pull or carry the appliance by the power cable.
- **DO NOT** pull the plug from the socket by the cable.
- **WARNING!** If the supply cord is damaged, it must be replaced by the manufacturer, its service agent or similarly qualified persons in order to avoid a hazard.
- Ensure that repairs are carried out by a qualified electrician.

GENERAL SAFETY

- Read all safety warnings, instructions, illustrations and specifications provided with this product. Failure to follow all instructions listed below may result in electric shock, fire and/or serious injury.
- Children from age 8 years and above, persons with reduced physical, sensory, or mental capabilities those with lack of experience and knowledge can use the appliance, if they have been given supervision or instruction concerning use of the appliance in a safe way to understand the hazards involved.
- Children shall **NOT** play with the appliance.
- Cleaning and user maintenance on the appliance shall not be made by children without supervision.
- Ensure that the fan is switched off from the mains supply before removing the guard.
- **DO NOT** use: in wet places, in direct sunlight, in explosive or corrosive atmospheres, extreme temperatures.
- **DO NOT** use outdoors.
- **DO NOT** place near curtains, obstacles or unstable objects.
- **DO NOT** poke anything through the mesh of the fan head.

- Protect from impacts or rough handling.
- **DO NOT** place under a power socket.
- **DO NOT** unplug with wet hands.
- Unplug before moving.

CONTENTS

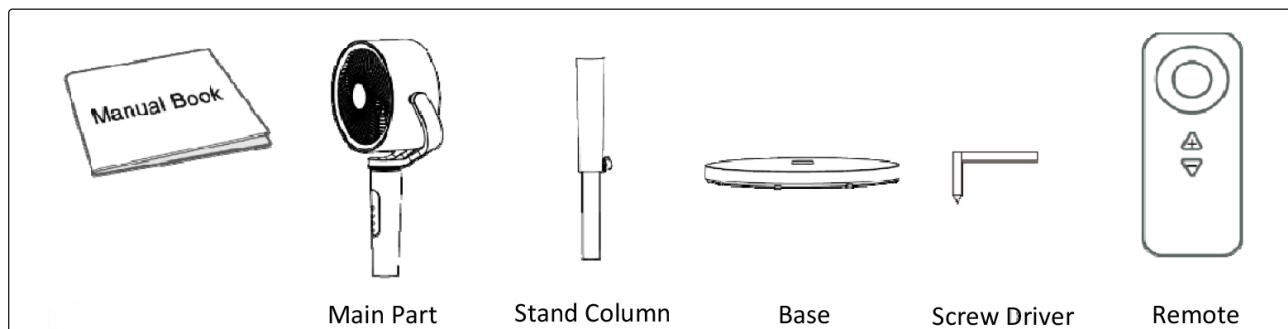

PRODUCT OVERVIEW

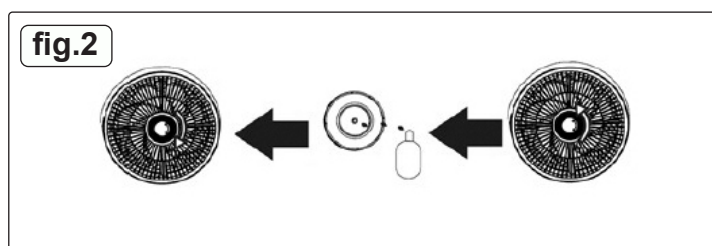
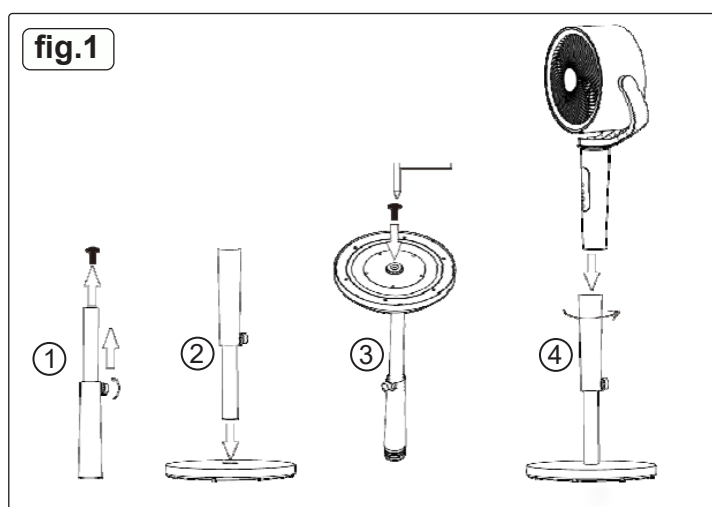
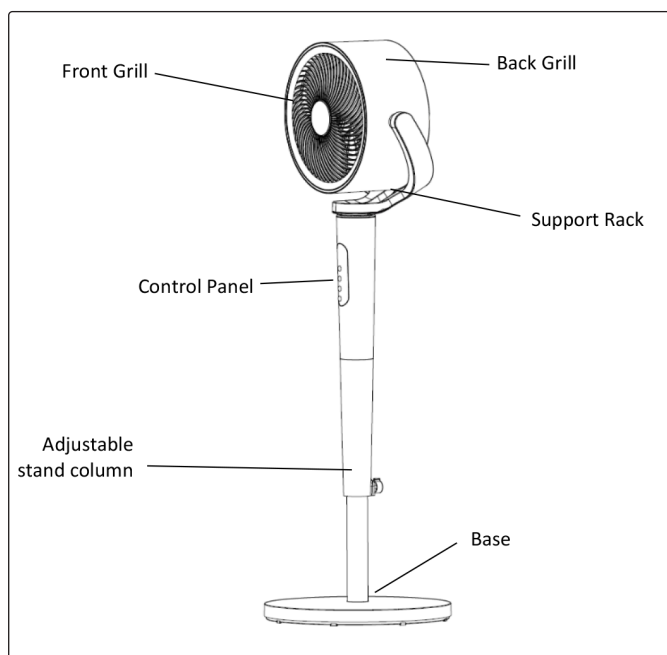

ASSEMBLY (see above right)

- 1. Remove all the parts from the outer packaging.
- 2. Remove the lock screw from the bottom of the column.
- 3. Place the column into the hole on the base and fasten the lock screw.
- 4. Install the main fan head onto the top of the column. See fig.1.

AROMA INSTALLATION

- Unscrew aroma holder from the centre of the front grill. See fig.2.
- Place drops of aroma oil on to the pad in the aroma cavity of the aroma holder.
- Replace aroma holder by screwing back into front grill.

OPERATION

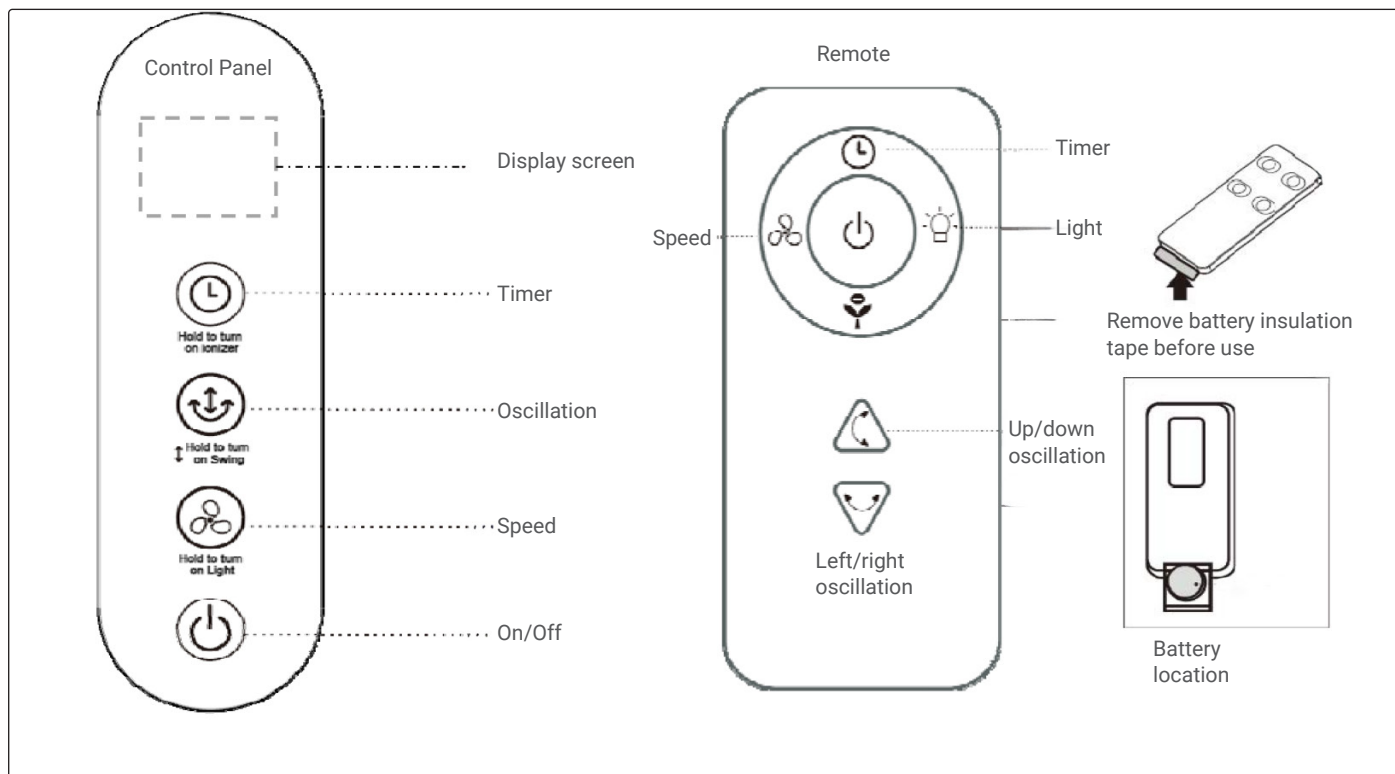

- **ON/OFF:** The fan beeps and turns on when this button is pressed, all buttons flash once and enters standby mode.
- **OSCILLATION:** A quick touch to turn on or turn off the left-right oscillation, hold on for 3 sec. to turn on or turn off the up-down oscillation.
- **SPEED:** the default speed is 'F6' when fan is turned on. Speed increases by one level per touch up to speed 12. Returns back to speed with one more touch. (old on for 3 sec. to turn on the Light on the back.)
- **TIMER:** The timer increased 1 hour by one touch until 12 hours, displays from '0H', '1H'... to '12' in a cycle. Hold on for 3 sec. to turn on or turn off the ionizer.
- **DISPLAY SCREEN:** The screen displays the fan speed and timer. It displays '—' when turn the fan on. The screen turns off without operation for 3 minutes, and 'awakens' by touch of any button.

MAINTENANCE

- **WARNING!** Turn off and remove from mains supply before Maintenance.
- **DO NOT** disassemble the product to clean inside.
- **CLEANING THE EXTERIOR:**
 - Use a clean, soft cloth or with neutral detergent to clean the exterior. **DO NOT** use solvents to clean this product.
 - **DO NOT** clean the inside of this product (circuit board, motor, etc) with any solvent, and ensure no water reaches the control circuit in case of short circuit.
 - **DO NOT** submerge the product, power cord or plug in water under any circumstances.
 - *It's recommended to clean the product every 2 months.
- **SEASONAL MAINTENANCE:** Clean the product at the end of the season before storing it.
- **STORAGE:**
 - Store in a safe place out of reach of children.

DECOMMISSIONING/ LIFE TIME OF THE PRODUCT/ DISPOSAL

- Through years of normal wear, the fan will eventually become unserviceable. When this happens ensure that it is disposed of in accordance with local authority regulations.

Environment Protection and Waste Protection and Electrical Equipment Regulations (WEEE)

Recycle unwanted packaging materials. When this product is no longer required, or has reached the end of its useful life, please dispose of it in an environmentally friendly way. Drain any fluids (if applicable) into approved containers, in accordance with local waste regulations. Under the Waste Batteries and Accumulators Regulations 2009, Baridi would like to inform the user that this product contains one or more batteries. It is our policy to continually improve products and we reserve the right to alter data, specifications and parts without prior notice. No liability is accepted for incorrect use of this product. Guarantee is 12 months from purchase date, proof of which is required for any claim.

Jack Sealey Ltd t/a Baridi, Kempson Way, Suffolk Business Park, Bury St Edmunds, Suffolk, IP32 7AR UK
Jack Sealey (EU) Ltd t/a Baridi, Farney Street, Carrickmacross, Co. Monaghan, A81 PK68 Ireland
Tel: 01284 757575 • Email: support@baridi.co.uk • Web: www.baridi.co.uk