



35-50MM DIAL BORE GAUGE

MODEL NO: **DBG509.V2**

Thank you for purchasing a Sealey product. Manufactured to a high standard, this product will, if used according to these instructions, and properly maintained, give you years of trouble free performance.

IMPORTANT: PLEASE READ THESE INSTRUCTIONS CAREFULLY. NOTE THE SAFE OPERATIONAL REQUIREMENTS, WARNINGS & CAUTIONS. USE THE PRODUCT CORRECTLY AND WITH CARE FOR THE PURPOSE FOR WHICH IT IS INTENDED. FAILURE TO DO SO MAY CAUSE DAMAGE AND/OR PERSONAL INJURY AND WILL INVALIDATE THE WARRANTY. KEEP THESE INSTRUCTIONS SAFE FOR FUTURE USE.



Refer to instructions

1. SAFETY

- ❑ **WARNING!** Ensure Health and Safety, local authority and general workshop practice regulations are adhered to when using tools and equipment.
- ✗ **DO NOT** use the dial bore gauge if damaged.
- ✗ **DO NOT** drop.
- ✓ This is a precision instrument, always return gauge components to the internally lined storage case.
- ✓ Maintain the gauge in good and clean condition for best and safest performance.
- ✓ Keep the work area clean, uncluttered and ensure there is adequate lighting.
- ✓ Ensure the work area floor is not slippery; wear non slip shoes.
- ✓ Components to be measured and the dial bore gauge to be stored at room temperature (21°C).

2. INTRODUCTION

Precision mechanism with $\varnothing 58\text{mm}$ dial and locking rotating bezel, offering an accurate method of measuring a bore or detecting a taper or ovality. Will indicate the deviation from set size by up to 1mm with an accuracy of 0.01mm. Probe body, dial indicator, anvils and locking nut are also included. Supplied in BMC.

3. SPECIFICATION

Model No.: DBG509.V2
Dial Diameter: $\varnothing 58\text{mm}$
Maximum Deviation Measurement with Stem: 1mm
Maximum Deviation Measurement, Gauge: 10mm
Range: 35 - 50mm
Resolution: 0.01mm

4. CONTENTS

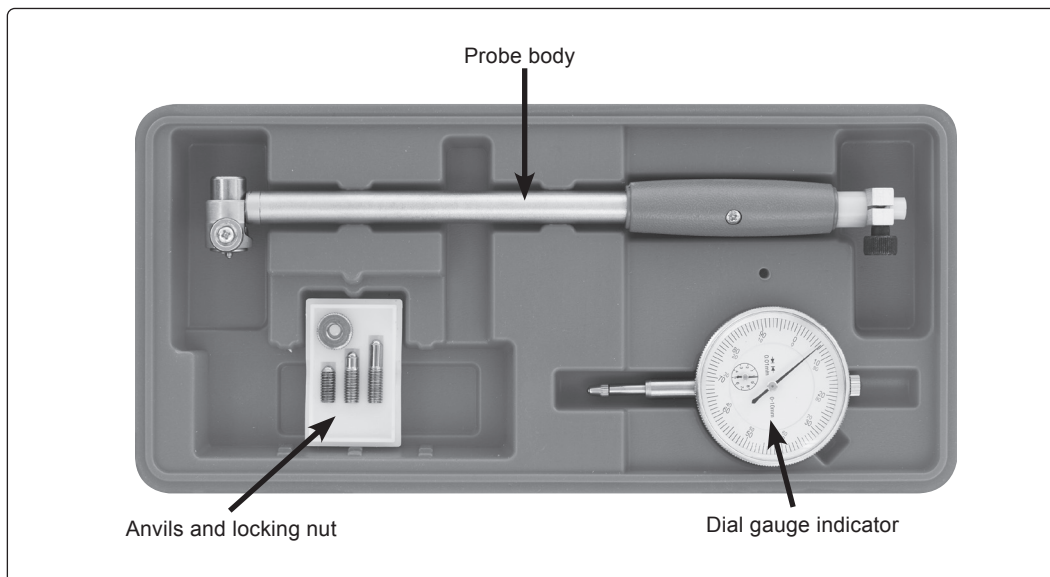

5. MAINTENANCE

- 5.1. Keep all components dry and clean with a soft micro fibre cloth.
- 5.2. Return all items to the presentation case after use.
- 5.3. Store indoors in a temperature controlled dry environment, circa 21°C.
- 5.4. This is a precision instrument intended for use by engineers and engineering inspectors, keep out of reach of children.



ENVIRONMENT PROTECTION

Recycle unwanted materials instead of disposing of them as waste. All tools, accessories and packaging should be sorted, taken to a recycling centre and disposed of in a manner which is compatible with the environment. When the product becomes completely unserviceable and requires disposal, drain any fluids (if applicable) into approved containers and dispose of the product and fluids according to local regulations.

Note: It is our policy to continually improve products and as such we reserve the right to alter data, specifications and component parts without prior notice. Please note that other versions of this product are available. If you require documentation for alternative versions, please email or call our technical team on technical@sealey.co.uk or 01284 757505.

Important: No Liability is accepted for incorrect use of this product.

Warranty: Guarantee is 12 months from purchase date, proof of which is required for any claim.

Sealey Group, Kempson Way, Suffolk Business Park, Bury St Edmunds, Suffolk. IP32 7AR



01284 757500



01284 703534



sales@sealey.co.uk



www.sealey.co.uk