



Ø150MM DUAL ACTION SANDER/POLISHER 600W

MODEL NO: **DAS149**

Thank you for purchasing a Sealey product. Manufactured to a high standard, this product will, if used according to these instructions, and properly maintained, give you years of trouble free performance.

IMPORTANT: PLEASE READ THESE INSTRUCTIONS CAREFULLY. NOTE THE SAFE OPERATIONAL REQUIREMENTS, WARNINGS & CAUTIONS. USE THE PRODUCT CORRECTLY AND WITH CARE FOR THE PURPOSE FOR WHICH IT IS INTENDED. FAILURE TO DO SO MAY CAUSE DAMAGE AND/OR PERSONAL INJURY AND WILL INVALIDATE THE WARRANTY. KEEP THESE INSTRUCTIONS SAFE FOR FUTURE USE.



Refer to
instruction
manual



Wear eye
protection



Wear ear
protection



Wear
protective
gloves



Wear
a mask

1. SAFETY

1.1. ELECTRICAL SAFETY

- WARNING!** It is the user's responsibility to check the following:
Check all electrical equipment and appliances to ensure that they are safe before using.
Inspect power supply leads, plugs and all electrical connections for wear and damage.
Ensure that the insulation on all cables and on the appliance is safe before connecting it to the power supply.
- × **DO NOT** use worn or damaged cables, plugs or connectors.
- ✓ Ensure that any faulty item is repaired or is replaced immediately by a qualified electrician.
- ✓ If the cable or plug is damaged during use, switch off the electricity supply and remove from use.
Ensure that repairs are carried out by a qualified electrician.
- ✓ Sealey recommend that an RCD (Residual Current Device) is used with all electrical products.
Important: Ensure that the voltage rating on the appliance suits the power supply to be used and that the plug is fitted with the correct fuse.
- × **DO NOT** pull or carry the appliance by the power cable.
- × **DO NOT** pull the plug from the socket by the cable.

1.2. GENERAL SAFETY

- WARNING!** Ensure Health & Safety, local authority, and general workshop practice regulations are adhered to when using this equipment.
- WARNING!** Disconnect from mains power before changing accessories or servicing.
- ✓ Maintain the sander in good condition (use an authorised service agent).
- ✓ Replace or repair damaged parts. *Use genuine parts only. Unauthorised parts may be dangerous and will invalidate the warranty.*
- ✓ Use the sander in a suitable work area. Keep area clean, tidy and free from unrelated materials. Ensure that there is adequate lighting
- ✓ Before use, check abrasive pad condition. If worn or damaged replace immediately.
- WARNING!** Always wear approved eye or face protection when operating the sander.
- ✓ If dust is generated, use face, dust, or respiratory protection in accordance with COSHH regulations.
- ✓ Depending on use, sander noise level may exceed 85dB - in which case wear safety ear defenders.
- ✓ Remove ill fitting clothing, ties, watches, rings, other loose jewellery and contain and/or tie back long hair.
- ✓ Wear appropriate protective clothing and keep hands and body clear of moving parts.
- ✓ Maintain correct balance and footing. Ensure the floor is not slippery and wear non-slip shoes.
- ✓ Keep children and unauthorised persons away from the work area.
- ✓ Always use with the handle attached securely.
- ✓ Ensure the workpiece is correctly secured before operating the sander. Never hold workpiece by hand and check the workpiece to ensure there are no protruding nails, screws, rivets, etc.
- ✓ Avoid unintentional starting.
- × **DO NOT** use the sander for a task it is not designed to perform.
- × **DO NOT** operate the sander if any parts are damaged or missing. This may cause failure and/or injury.
- WARNING! DO NOT** sand any materials containing asbestos.
- × **DO NOT** carry the sander by the electrical cable.
- × **DO NOT** connect to a standard vacuum cleaner to extract dust as damage to the cleaner may result.
- × **DO NOT** get the sander wet or use in damp or wet locations.
- × **DO NOT** use the sander with water, the sander is for dry use only.
- × **DO NOT** operate the sander if you are tired or under the influence of alcohol, drugs or intoxicating medication.
- × **DO NOT** use where there are flammable liquids, solids or gases such as paint solvents or waste wiping or cleaning rags.
- × **DO NOT** leave the sander running unattended.
- × **DO NOT** carry the sander with your finger on the power switch.
- ✓ When not in use disconnect from the power supply and store in a safe, dry, childproof area.
- WARNING!** The warnings, cautions and instructions in this manual cannot cover all possible conditions and situations that may occur. It must be understood by the operator that common sense and caution are factors which cannot be built into this product, but must be applied by the operator.



LEAD PAINT WARNING!

Paint once contained lead as a traditional ingredient. The dust from the removal of such paint is toxic if inhaled or ingested and must, therefore, be avoided. The following action must be taken before using the sander on a surface that you suspect may have contained lead in the paint.

1. User must determine potential hazard relating to age of paint to be removed. (Modern paints do not contain lead).
2. **DANGER!** Keep all persons and pets away from the work area. The following are particularly vulnerable to the effects of lead paint dust: *Expectant women, babies and children.*
3. We recommend personal protection by using the following safety items:
 - a) Paint Spray Respirator
 - b) PE Coated Hooded Coverall
 - c) Latex Gloves
4. Take adequate measures to contain the paint dust, flakes, and scrapings.
5. Continue to wear safety equipment as in 3 above, and thoroughly clean all areas when task is complete. Ensure that paint waste is disposed of in sealed bags or containers, according to local authority regulations.

2. INTRODUCTION

Lightweight, compact sander with variable speed control from 1500-6800rpm. Dual action orbit of Ø8mm helps cover more surface. Also suitable for polishing when fitted with Model No. PTC115VA516 Backing Pad (not included).

3. SPECIFICATION

Model No:	DAS149
Consumable Parts:	Ø145mm DA Pad Hook-and-Loop 5/16"UNF - PTC/150VA Carbon Brush - DAS149.04
Fuse Rating:	5A
Motor Power:	600W
Nett Weight:	2.3kg
Noise Power/Pressure:	91/80dB(A)
No-Load Speed:	1500-6800rpm
Optional Accessories:	PTC/150SA - Stick-On Backing Pad, PTC115VA516 - Hook-and-Loop Pad
Orbit Size:	Ø8mm
Pad Size:	Ø150mm
Supply:	230V
Thread Size:	5/16"UNF
Vibration/Uncertainty:	2.3/1.5m/s ²

4. ASSEMBLY

- WARNING! DO NOT** plug sander into the mains power supply before it is fully assembled. Screw the sanding pad onto the spindle (fig.1.3). To remove pad, hold spindle with the spanner supplied whilst unscrewing the pad.

5. OPERATION

- WARNING!** Before use, ensure that you have read and understood Section 1 Safety Instructions.
- 5.1. Attach the correctly rated sanding disc (not supplied) to the sanding pad.
 - 5.2. Plug the sander into the mains power supply.
 - 5.3. Ensure that the speed scroll switch is set to the lowest setting before starting the sander (fig.1). Grip the handle and turn on by pushing switch (fig.1) forward. Let go of the switch and the machine will continue running. Increase the speed of the sander using the variable switch located at the rear of the sander (fig.1).

NOTE: The sander is designed for dry use only. **DO NOT** use with water or any other liquids.

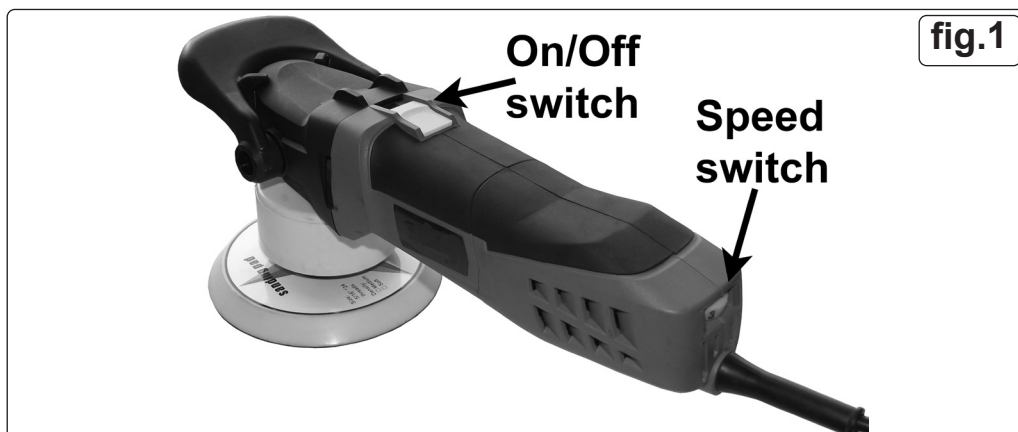

6. MAINTENANCE

WARNING! Disconnect sander from power supply before changing accessories, servicing or performing maintenance. Replace or repair any damaged parts. Use genuine parts only, unauthorised parts may be dangerous and will invalidate the warranty.

- 6.1. After each 50 hours use (or as required), remove dust by blowing air through the side vents and around the pad bearing. Periodic cleaning will prolong machine life.
- 6.2. Change pads when required. Ensure pad and disc RPM ratings are equal to the machine rating. If the disc becomes unbalanced, it will cause the bearings to wear.
- 6.3. When not in use store in a safe, dry, childproof location.
- 6.4. Check brushes every 200 hours of use. To access the brushes refer to fig.2. Undo the screws in the side of the motor casing and slide off the covers. Using a small screwdriver lift the brush spring to one side and slide the brush out of its holder. If the brush is worn to half of its original length it should be renewed. Using thin nosed pliers pull the brush connector off its connector. Slide the new brush into its holder. Slide the connector onto the connector. Position the spring so that it bears down onto the end of the brush. Remember to renew brushes as a pair. Fit rear covers back into place and retain it with the screws.
- 6.5. All other service and maintenance must be carried out by an authorised service agent.

WARNING! – RISK OF HAND ARM VIBRATION INJURY.

THIS TOOL MAY CAUSE HAND ARM VIBRATION SYNDROME IF ITS USE IS NOT MANAGED ADEQUATELY.

This tool is subject to the vibration testing section of the Machinery Directive 2006/42/EC.
This tool is to be operated in accordance with these instructions.

MEASURED VIBRATION EMISSION VALUE (a): 2.3m/s²

UNCERTAINTY VALUE (k) : 1.5m/s²

Please note that the application of the tool to a sole specialist task may produce a different average vibration emission. We recommend that a specific evaluation of the vibration emission is conducted prior to commencing with a specialist task.

A health and safety assessment by the user (or employer) will need to be carried out to determine the suitable duration of use for each tool.

NB: Stated Vibration Emission values are type-test values and are intended to be typical.

Whilst in use, the actual value will vary considerably from and depend on many factors.

Such factors include; the operator, the task and the inserted tool or consumable.

NB: ensure that the length of leader hoses is sufficient to allow unrestricted use, as this also helps to reduce vibration.

The state of maintenance of the tool itself is also an important factor, a poorly maintained tool will also increase the risk of Hand Arm Vibration Syndrome.

HEALTH SURVEILLANCE.

We recommend a programme of health surveillance to detect early symptoms of vibration injury so that management procedures can be modified accordingly.

PERSONAL PROTECTIVE EQUIPMENT.

We are not aware of any personal protective equipment (PPE) that provides protection against vibration injury that may result from the uncontrolled use of this tool. We recommend a sufficient supply of clothing (including gloves) to enable the operator to remain warm and dry and maintain good blood circulation in fingers etc. Please note that the most effective protection is prevention, please refer to the Correct Use and Maintenance section in these instructions. Guidance relating to the management of hand arm vibration can be found on the HSC website

www.hse.gov.uk - Hand-Arm Vibration at Work.



WEEE REGULATIONS

Dispose of this product at the end of its working life in compliance with the EU Directive on Waste Electrical and Electronic Equipment (WEEE). When the product is no longer required, it must be disposed of in an environmentally protective way. Contact your local solid waste authority for recycling information.



ENVIRONMENT PROTECTION

Recycle unwanted materials instead of disposing of them as waste. All tools, accessories and packaging should be sorted, taken to a recycling centre and disposed of in a manner which is compatible with the environment. When the product becomes completely unserviceable and requires disposal, drain any fluids (if applicable) into approved containers and dispose of the product and fluids according to local regulations.

Note: It is our policy to continually improve products and as such we reserve the right to alter data, specifications and component parts without prior notice.

Important: No Liability is accepted for incorrect use of this product.

Warranty: Guarantee is 12 months from purchase date, proof of which is required for any claim.



REGISTER YOUR PURCHASE HERE

Sealey Group, Kempson Way, Suffolk Business Park, Bury St Edmunds, Suffolk. IP32 7AR

 **01284 757500**

 **sales@sealey.co.uk**

 **www.sealey.co.uk**