

Thank you for purchasing a Sealey product. Manufactured to a high standard this product will, if used according to these instructions and properly maintained, give you years of trouble free performance.



IMPORTANT: PLEASE READ THESE INSTRUCTIONS CAREFULLY. NOTE THE SAFE OPERATIONAL REQUIREMENTS, WARNINGS AND CAUTIONS. USE THIS PRODUCT CORRECTLY AND WITH CARE FOR THE PURPOSE FOR WHICH IT IS INTENDED. FAILURE TO DO SO MAY CAUSE DAMAGE AND/OR PERSONAL INJURY AND WILL INVALIDATE THE WARRANTY. KEEP THESE INSTRUCTIONS FOR FUTURE USE.

1. SAFETY INSTRUCTIONS

1.1. GENERAL

- ✓ Keep the vac clean and in good condition.
- ✓ Replace or repair damaged parts. *Use recommended parts only. Unauthorised parts may be dangerous and will invalidate the warranty.*
- ✓ Keep children and non-essential persons away from the work area.
- x **DO NOT** leave the vac operating unattended.
- x **DO NOT** use the vac for a task it is not designed for.
- x **DO NOT** operate the vac when you are tired or under the influence of alcohol, drugs or intoxicating medication.
- x **DO NOT** operate the vac if any parts are missing or damaged, as this may cause failure and/or personal injury.
- ✓ Stay alert, watch what you are doing and use common sense when operating vac.
- ✓ Do not allow persons unfamiliar with the vac or these instructions to operate the vac.
- ✓ Ensure the switch is in the off position before inserting battery pack.
- ✓ Recharge only with the charger supplied.
- ✓ Use vac only with specifically designated battery packs.
- WARNING!** Under extreme conditions, liquid may be ejected from the battery: avoid contact. If contact accidentally occurs, flush with water. If liquid contacts eyes, also seek medical help.
- WARNING!** Sparks inside motor can ignite flammable vapours or dust. To avoid fire or explosion do not use near flammable or combustible liquids or gases.
- x **DO NOT** vacuum anything that is burning or smoking such as cigarettes, matches or hot ashes.
- x **DO NOT** vacuum toxic materials to avoid health hazards from vapours or dusts.
- ✓ Keep the vac and all accessories where they will not be subjected to heat or flame. To avoid injury, shock, or fire, never use a damaged vac, cord or charger.
- x **DO NOT** put any object into openings.
- x **DO NOT** use with any opening blocked.
- ✓ Keep free of dust, lint, hair, and anything that may reduce air flow. Keep hair, loose clothing, fingers away from openings and moving parts.
- x **DO NOT** use for dry vacuuming without filter in place.
- x **DO NOT** use any charger other than the one with the vac.
- x **DO NOT** handle plug or charging unit with wet hands.
- ✓ Replace or repair damaged parts. *Use recommended parts only. Unauthorised parts may be dangerous and will invalidate the warranty.*

1.2. BATTERY SAFETY

BATTERIES MAY BE DANGEROUS IF NOT HANDLED WITH CARE AND ACCORDING TO THESE INSTRUCTIONS.

- ✓ Before removing battery from charger or vac, remove personal metallic items such as rings, bracelets, necklaces and watches.
- ✓ Ensure the charger is switched off and disconnected before attempting to remove the battery.

- ✓ If the battery terminals are corroded or dirty, clean them before replacing battery.
- x **DO NOT** dis-assemble the battery for any reason.
- WARNING! DO NOT** allow metal objects to touch both battery terminals simultaneously. Arcing or short circuit will result.
- x **DO NOT** allow battery terminals to make contact with any other metallic part.
- x **DO NOT** leave battery in a discharged state, recharge battery immediately. If the vac is not in use, recharge the battery every three months.
- ✓ Dispose of the old battery in accordance with local authority acid battery regulations. **DO NOT** dispose of with regular refuse.

1.3. ELECTRICAL SAFETY

USE ONLY SUPPLIED CHARGER PLUG FOR VAC.

- WARNING!** It is the user's responsibility to read, understand and comply with the following electrical instructions: You must ensure the risk of electric shock is minimised by the installation of appropriate safety devices. An RCCB (Residual Current Circuit Breaker) should be incorporated in the main distribution board. We also recommend that an RCD (Residual Current Device) is used with all electrical products, particularly portable equipment which is plugged into an electrical supply not protected by an RCCB.

You must also read and understand the following instructions concerning electrical safety.

- 1.3.1. **The Electricity At Work Act 1989** requires all portable electrical appliances, if used on business premises, to be tested by a qualified electrician, using a Portable Appliance Tester (PAT), at least once a year.

- 1.3.2. **The Health & Safety at Work Act 1974** makes owners of electrical appliances responsible for the safe condition of the appliance and the safety of the appliance operator. **If in any doubt about electrical safety, contact a qualified electrician.**

1.3.3. You must ensure that you:

- ✓ Inspect the charger plug, cable and connector for wear and damage to ensure items are safe before connecting to the mains power supply. If worn or damaged **DO NOT** use.
- ✓ Check cables are always protected against short circuit and overload.
- ✓ Important: Check that the voltage marked on the charger plug is the same as the power supply to be used.
- ✓ Uncoil the cable between charger and the charger base.
- x **DO NOT** pull the charger plug from the mains socket by the lead.
- x **DO NOT** use any other type of charger with this product.
- x **DO NOT** try to take the charger plug apart.
- x **DO NOT** use the charger plug to charge or power any other electrical item.
- x **DO NOT** get charger wet, or use in wet, damp conditions (for indoor use only).

2. SPECIFICATIONS

Ideal for quick clearing up of spillage. Convenient for use in the home, workshop or car. Supplied with crevice tool. Features removable collection chamber for easy disposal of waste and removable battery with base charger.

Voltage:..... 14.4V
Charging Time:..... 3-5hr
Weight:1.6kg

3. OPERATION

IMPORTANT WARRANTY INFORMATION:

The battery pack fitted to this cordless tool is considered to be a consumable item and its ability to accept charge will reduce over time. We will warranty it against mechanical and electrical defect for a period of one year - this does not cover fair wear and tear. If the battery is not properly charged before first use, or regularly conditioned, its capacity will diminish. Under these circumstances we will not replace the battery pack even if it is less than one year old.

3.1 CHARGING BATTERY PACK

WARNING! Ensure you read and understand safety instructions before use.

- 3.1.1 Ensure your supply corresponds with the voltage rating of the charger, 230V 50Hz AC only.
- 3.1.2 Connect the charger plug to the power supply. Plug the lead from the charger plug into the charger stand.
- 3.1.3 Insert the battery pack into the charge stand. Align the raised rib on battery pack with groove in the charging stand (fig.1). As the pack is inserted into the stand the red charging light will come on.
- 3.1.4 Press lightly down on the battery pack to ensure the contacts on the battery pack engage properly with the contacts in charging stand.
- 3.1.5 Charging time is 3 - 5 hours. The red charging light will remain on until the battery pack is removed from the charging stand or the charger is disconnected from the supply.

Note: The battery pack will become slightly warm to the touch while charging. This is normal and does not indicate a problem.

- 3.1.6 The battery pack will only go into the main body one way round. Hold the battery pack with the neck towards the bottom of the pack and insert it into the back of the main body. Push the battery home until it snaps into place.

IMPORTANT! When using your vac continuously, the batteries will become very hot. You should let a hot battery pack cool down for approximately 30 minutes before attempting to recharge.

3.2 TO VACUUM DRY SPILLS, DUST AND DIRT

Warning. When dry vacuuming, the filter must be attached to the inner baffle moulding. Failure to do this will result in debris entering the motor compartment causing damage to the motor and invalidating your warranty.

- 3.2.1 If required attach the crevice tool to the dust collector by pushing it into the front opening as indicated in fig.7.
- 3.2.2 Slide the ON/OFF switch forwards (fig 2) and proceed to vacuum.
- 3.2.3 Upon completion of vacuuming slide the On/Off switch back to the OFF position.
- 3.2.4 To empty the dust collector, position the vac over a suitable waste receptacle with the dust collector pointing downward by 45°.

- 3.2.5 Press down on the release button (fig.3-1) and release the dust collector carefully to avoid spilling the contents.
- 3.2.6 Remove the filter and inner baffle from the dust collector (fig.4).
- 3.2.7 Tip the dust collector contents into the waste receptacle. The dust collector may be rinsed in warm soapy water but must be dried thoroughly before use.
- 3.2.8 The filter moulding is attached to the baffle moulding with four keyholes positioned north, south, east and west. Remove the filter from the inner baffle using a rotational movement as indicated in fig.5. Hold the inner baffle with one hand and turn the filter moulding clockwise using the rib across the filter moulding aperture. Apply pressure to the points indicated by the two white arrows in fig.5. To clean the filter, shake the dirt out over a suitable waste receptacle. Do not scrub the filter material. If necessary reverse flush the filter by holding it under a flow of warm water and dry thoroughly afterwards. This will be necessary after considerable use as the filter will restrict the airflow and performance of the vac if it becomes blocked.
- 3.2.9 Re-assemble the vac by firstly re-attaching the filter to the inner baffle moulding. Place the filter moulding over the four pins on the baffle and rotate the moulding anti clockwise to lock it into place. Push the assembly into the dust collector until it makes contact with the ribs inside the collector. Reattach the dust collector to the main vac body as indicated in fig.3. Firstly hook the projection on the underside of the main body into the slot in the lower back edge of the collector (fig.3-4). Swing the collector upwards so that the top back edge snaps into place on the catch (fig.3-2).

3.3 TO VACUUM WET SPILLS

Warning. The vacuum is designed to pick up small spills of liquid only such as a spilled drink. Any attempt to vacuum larger quantities of water may result in water entering the motor compartment damaging the product and invalidating your warranty.

- 3.3.1 For wet vacuuming detach the filter moulding from the inner baffle as described in section 3.2.8.
- 3.3.2 The inner baffle has an integral rubber seal around its outer perimeter. Make sure that the baffle is pressed fully home into the collector moulding. Reattach the collector moulding to the main body.
- 3.3.3 If required attach the crevice tool to the collector by pushing it into the front opening as indicated in fig.7.
- 3.3.4 Slide the ON/OFF switch forwards (fig 2) and, holding the unit with the nose of the collector pointing downwards at 45°, move slowly over the liquid.
- 3.3.5 Upon completion of vacuuming slide the On/Off switch back to the OFF position. Do not turn the unit horizontal as the small amount of water in the nose will run out of the collector intake.
- 3.3.6 Keeping the collector pointing downwards at 45° release the main body from the collector. Remove the inner baffle and pour the liquid down a drain or into a suitable receptacle such as a bucket.
- 3.3.7 When vacuuming is complete, thoroughly dry every thing including the inside of the collector and the baffle moulding.
- 3.3.8 Re-assemble the vac and store in a dry location out of reach of children. If the vac is to be stored for a long period of time remove the battery from the vac and store in a safe location.
- 3.3.9 **NOTE:** Next time the vac is required for dry vacuuming ensure that the filter is fitted.

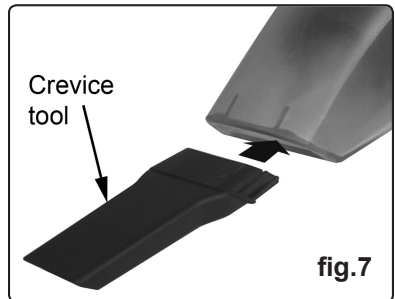
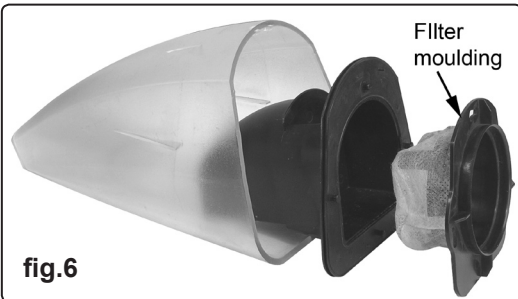
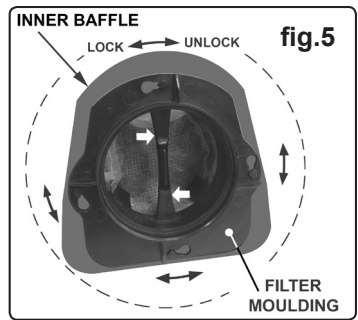
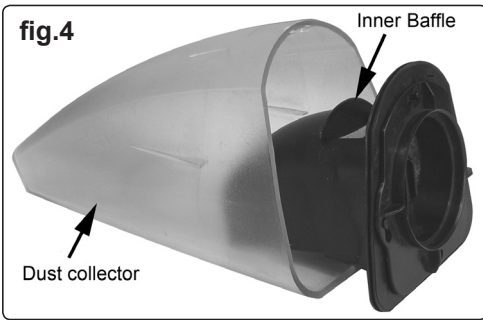
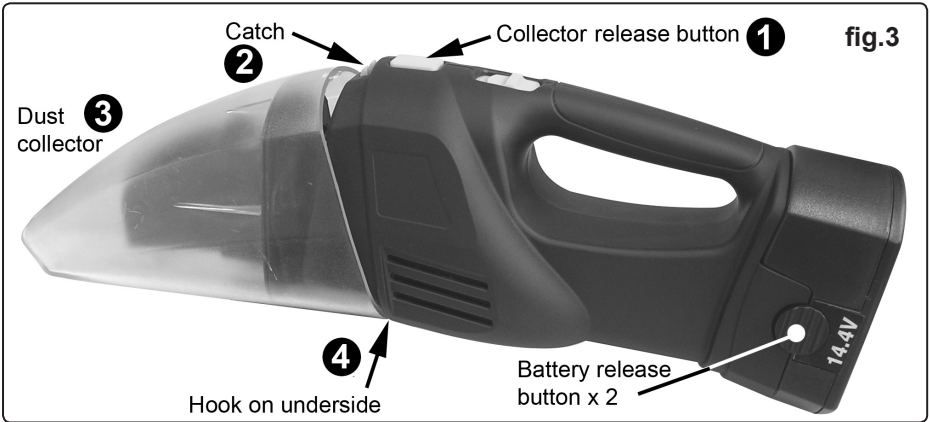
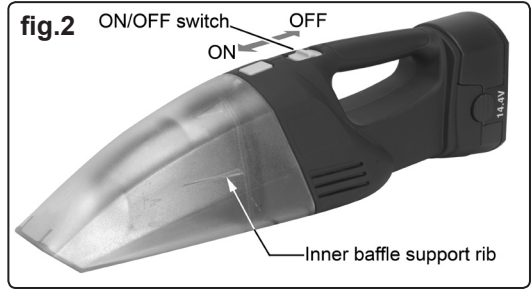

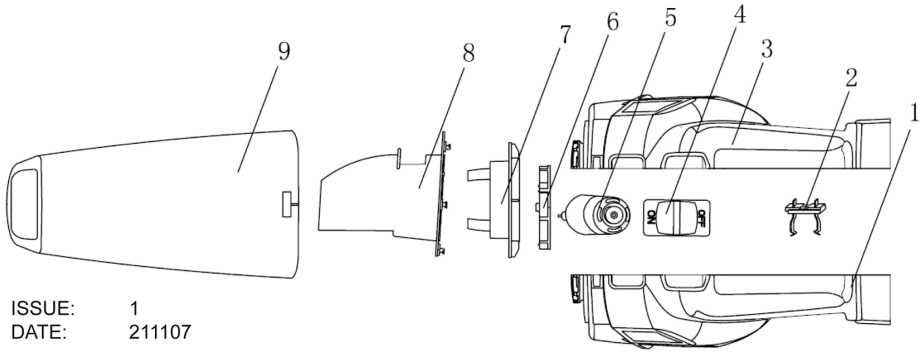

ISSUE: 1
 DATE: 211107

ITEM	PART NO	DESCRIPTION	ITEM	PART NO	DESCRIPTION
1	CPV144.V2-01	HOUSING (LEFT)	7	CPV144.V2-07	FILTER MOULDING
2	CPV144.V2-02	BATTERY CLIP	8	CPV144.V2-08	INNER BAFFLE
3	CPV144.V2-03	HOUSING (RIGHT)	9	CPV144.V2-09	NOZZLE
4	CPV144.V2-04	SWITCH	ITEMS NOT SHOWN		
5	CPV144.V2-05	D.C. MOTOR	10	CPV144.V2-CP	SLOW CHARGER PACK
6	CPV144.V2-06	PNEUMATIC WHEEL	11	CPV144BP2	CORDLESS BATTERY PACK

Environmental Protection



Recycle unwanted materials instead of disposing of them as waste.

All tools, accessories and packaging should be sorted, taken to a recycle centre and disposed of in a manner which is compatible with the environment.



When the product is no longer required, it must be disposed of in an environmentally protective way. Contact your local solid waste authority for recycling information.

Battery Removal



1. To disconnect the battery pack squeeze the two battery release buttons (fig.3) on the side of the pack and pull away from the vac.

Dispose of batteries according to local authority guidelines.

Under the Waste Batteries and Accumulators Regulations 2009, Jack Sealey Ltd are required to inform potential purchasers of products containing batteries (as defined within these regulations), that they are registered with Valpak's registered compliance scheme.

Jack Sealey Ltd's Batteries Producer Registration Number (BPRN) is BPRN00705

NOTE: It is our policy to continually improve products and as such we reserve the right to alter data, specifications and component parts without prior notice.

IMPORTANT: No liability is accepted for incorrect use of this product.

WARRANTY: Guarantee is 12 months from purchase date, proof of which will be required for any claim.

INFORMATION: For a copy of our latest catalogue and promotions call us on 01284 757525 and leave your full name and address, including postcode.

