

Thank you for purchasing a Sealey product. Manufactured to a high standard this product will, if used according to these instructions and properly maintained, give you years of trouble free performance.



IMPORTANT: PLEASE READ THESE INSTRUCTIONS CAREFULLY. NOTE THE SAFE OPERATIONAL REQUIREMENTS, WARNINGS & CAUTIONS. USE THE PRODUCT CORRECTLY AND WITH CARE FOR THE PURPOSE FOR WHICH IT IS INTENDED. FAILURE TO DO SO MAY CAUSE DAMAGE AND/OR PERSONAL INJURY AND WILL INVALIDATE THE WARRANTY. PLEASE KEEP INSTRUCTIONS SAFE FOR FUTURE USE.

1. SAFETY INSTRUCTIONS

1.1 BATTERY SAFETY INSTRUCTIONS.

- WARNING!** Battery contains nickel-cadmium which is dangerous. Handle with care to avoid damage, fire, corrosion or personal injury.
- ✓ Charge battery prior to first use. The battery pack will have been shipped in a low charge state.
- ✓ Use only the charger provided to charge the drill battery.
- ✗ DO NOT charge battery when room temperature is below 50°F (10°C) or above 104°F (40°C).
- ✗ DO NOT attempt recharging the battery by means of an engine generator or a DC power source.
- ✗ DO NOT short-circuit the battery by linking both terminals with a metal object, or your fingers etc.
- ✗ DO NOT store the battery (or polisher) in locations where the temperature may exceed 104°F (40°C) such as outside sheds, above heaters, or metal buildings in summer.
- WARNING!** Dispose of spent batteries correctly as they contain nickel-cadmium. **DANGER!** DO NOT attempt to disassemble the battery pack. For safety and environmental reasons DO NOT discard in domestic waste or by burning. ONLY discard or recycle according to local authority regulations.
- WARNING!** DO NOT allow a leaking battery to contact your person. If you come into contact with battery liquid take the following immediate action:
 - a) **Skin contact:** Wash immediately with soap and water, then wash flesh in either lemon juice or vinegar.
 - b) **Eye contact:** Wash with a strong solution of boric acid, and seek immediate medical attention.

1.2 ELECTRICAL SAFETY.

REGARDING DIRECT MAINS POWER USE WITH THE CHARGER.

- WARNING!** It is the owner's responsibility to read, understand and comply with the following electrical instructions: You must ensure the risk of electric shock is minimised by the installation of appropriate safety devices. An RCCB (Residual Current Circuit Breaker) should be incorporated in the main distribution board. We also recommend that an RCD (Residual Current Device) is used with all electrical products, particularly portable equipment which is plugged into an electrical supply not protected by an RCCB. **You must** also read and understand the following instructions concerning electrical safety.
- 1.2.1 The Electricity At Work Act 1989** requires all portable electrical appliances, if used on business premises, to be tested by a qualified electrician, using a Portable Appliance Tester (PAT), at least once a year.
- 1.2.2 The Health & Safety at Work Act 1974** makes owners of electrical appliances responsible for the safe condition of the appliance, and the safety of the appliance operator. **If in any doubt about electrical safety, contact a qualified electrician.**
- 1.2.3 You must ensure that you:**
 - ✓ Inspect the charger and cable for wear and damage to ensure items are safe before connecting to the mains power supply. If worn or damaged DO NOT use, immediately replace, or contact a qualified electrician.
 - ✓ Check cables are always protected against short circuit and overload.
 - ✓ Important: Check that the voltage marked on the charger is the same as the power supply to be used.
 - ✗ DO NOT pull or carry the charger by the power lead, or pull the plug from the mains socket by the power lead.
 - ✗ DO NOT use any other type of charger.
 - ✗ DO NOT try to open or dis-assemble the charger.

- ✗ DO NOT get the charger wet, or use in wet, damp conditions (for indoor use only).
- 1.3 BATTERY CHARGER SAFETY INSTRUCTIONS.**
- WARNING!** DO NOT use the charger to charge any battery other than that supplied for the polisher. Other types of batteries may explode!
- ✓ All mains electrical supply safety features must be followed as described in 1.2.
- ✓ Disconnect the charger from the mains power supply when not in use.
- ✗ DO NOT operate the charger if it has been dropped, or has received a sharp knock, or is damaged. Contact an authorised service agent.
- ✗ DO NOT insert foreign objects or material into the hole reserved for the battery.
- ✗ DO NOT force the battery into the charger. The battery will only fit one way to ensure correct polarity alignment.
- ✗ DO NOT immediately charge a second battery. Consecutive charging will overheat the charger. Allow the unit to cool for 15 minutes before charging the next battery.
- ✗ DO NOT attempt to connect two chargers together.
- ✓ Store the charger in the same manner as battery, see section 1.2.
- 1.4 GENERAL SAFETY**
- WARNING!** Ensure that Health & Safety, local authority and general workshop practice regulations are adhered to when using this equipment.
- ✓ Familiarise yourself with the application, limitations and potential hazards of the polisher.
- WARNING!** Disconnect from the mains power before changing accessories, servicing or performing any maintenance.
- ✓ Maintain the polisher in good condition (use an authorised service agent).
- ✓ Replace or repair damaged parts. *Use genuine parts only. Unauthorised parts may be dangerous and will invalidate the warranty.*
- WARNING!** Keep all guards and holding screws in place, tight and in good working order. Check regularly for damaged parts. A guard or any other part that is damaged must be repaired/replaced before the tool is next used.
- ✓ Use the polisher in a suitable work area and keep the area clean and tidy and free from unrelated materials. Ensure that there is adequate lighting.
- ✓ Keep the polisher clean for best and safest performance.
- ✓ Before each use check all attachments for condition. If worn or damaged replace immediately.
- ✓ Ensure that there are no flammable materials near the work area.
- WARNING!** Wear approved safety eye protection, ear defenders and, if dust is generated, respiratory protection.
- ✓ Maintain correct balance and footing. Ensure that the floor is not slippery and wear non-slip shoes.
- ✓ Remove ill fitting clothing. Remove ties, watches, rings and other loose jewellery and contain and/or tie back long hair.
- ✓ Keep children and unauthorised persons away from the work area.
- ✓ Avoid unintentional starting.
- ✗ **DO NOT** use the polisher for any purpose other than that for which it is designed.
- ✗ **DO NOT** operate the polisher if any parts are damaged or missing as this may cause failure and/or personal injury.
- ✗ **DO NOT** switch the polisher on until the head is in contact with the panel and switch the unit off before removing the head from the panel.
- ✗ **DO NOT** use the polisher with abrasive cleaners or rubbing compounds as excessive paint removal may result.

- x **DO NOT** get the polisher wet or use in damp or wet locations or areas where there is condensation.
- x **DO NOT** allow untrained persons to operate the polisher.
- x **DO NOT** operate the polisher when you are tired or under the influence of alcohol, drugs or intoxicating medication.
- x **DO NOT** use the polisher where there are flammable liquids, solids or gases such as paint solvents, etc.
- x **DO NOT** leave the polisher operating unattended.
- x **DO NOT** carry the polisher with your finger on the power switch.
- x **DO NOT** pull the cord from the power supply.
- ✓ Use a qualified person to maintain the polisher.
- ✓ When not in use, unplug from the mains power supply and store in a safe, dry, childproof area.

2. INTRODUCTION

Cordless random orbital polisher with Ø230mm 5 ply foam pad and two polishing bonnets. Smooth operation provides even buffing/polishing with no hot spots. Impact resistant ABS housing with twin grips. Supplied with 18V Ni-Cd battery pack and battery charger. GS/TUV and CE approved.

3. SPECIFICATION

Model No:	CP2518
Battery:	18V
Speed:	2800rpm
Pad Size:	230mm
Battery Pack:	CP2518BP
Replacement Bonnet Terry Cloth:	ER230P.TB
Replacement Bonnet Synthetic Wool:	ER230P.WB
Vibration	3.2m/s ²

4. CHARGING THE BATTERY

Note: When new, the battery is shipped in a low charge state. It will take longer to charge the battery initially (about 7 hours) and several subsequent charges may also take a little longer until the battery reaches its optimum performance. In general use the battery should be charged for 4-5 hours.

- 4.1. To remove the battery pack from the polisher, depress the two side clips on the battery. Do not touch the metal battery terminals.
- 4.2. Connect mains transformer to the charging base and place the base on a safe flat surface. Plug the transformer into the mains socket and switch on.
- 4.3. The battery is designed to fit into the charger one way only. This is to ensure that the positive (+) and negative (-) polarities correspond. Align the ridge on the battery stem with the keyway in the charger recess and insert the battery. Press lightly on the battery to ensure that it makes connection with the terminals at the bottom of the charger recess.
- 4.4. The charge light will come on when the battery is inserted indicating that charging has commenced. Do not charge the battery for more than 7 hours.
- 4.5. When charging is complete remove the battery from the charger at which point the charge light will go out. Switch off and remove the transformer plug from the mains. Push the battery into the polisher base until it latches into place. The polisher is now ready for use.

Note: Do not attempt to recharge a battery *immediately* after use. In such a case allow the battery to cool for a time before recharging.

5. OPERATION

- **WARNING!** Ensure that you read, understand and apply the safety instructions in Section 1.
 - **WARNING!** Do not use the polisher with abrasive or rubbing compounds.
 - **WARNING!** Excess pressure can cause damage to paintwork and will put the polisher motor under strain. Polishers returned with burnt out motors will be rejected as a warranty claim. Normally the weight of the polisher is sufficient.
- 5.1. Regularly check that the bonnet is clean and free of abrasive particles and is undamaged and that the pad rotates freely.
 - 5.2. Apply a small amount of polish/wax evenly over the surface of the bonnet. Do not apply polish directly to the vehicle surface.
 - 5.3. Hold the polisher firmly by the handles and place the polishing face onto the panel to be polished.
 - 5.4. Start the polisher using the red On/Off switch on the handle ensuring that the pad is still in contact with the vehicle panel.
 - 5.5. Move the polisher with broad sweeping strokes over the surface in a criss-cross pattern. Do not apply pressure to the polisher when in use. Work in logical areas and re-apply the polish/wax at intervals during the polish application process. Do not allow the foam pad to become saturated with polish/wax as this will make polishing more difficult and will reduce pad life.
 - 5.6. Polish/wax should be applied to difficult-to-reach areas by hand.
 - 5.7. Switch Off the polisher before lifting it from the panel when polish application is completed.
 - 5.8. Remove the application bonnet and replace it with the wool bonnet.
 - 5.9. Buff the polish/wax in the same order it was applied. Do not put pressure on the polisher but allow its weight and action to do the job.
 - 5.10. Badly oxidised paint may require several applications. Do not use abrasive compounds.
 - 5.11. If the polish/wax is difficult to buff too much has been applied. This may also cause the bonnet to come off the pad.
- **WARNING!** Do not immerse the polisher in water.

6. MAINTENANCE

- 6.1. Always store the polisher on its side so that the foam pad does not become compressed and/or distorted.
- 6.2. Remove bonnet when not in use to allow foam pad to dry out.
- 6.3. Clean the bonnet regularly by hand washing with soap and water. DO NOT immerse the foam pad in water. Washing the bonnet is sufficient.
- 6.4. To remove the foam pad, proceed as follows:
 1. Remove the bonnet.
 2. Insert a rod (cross-head screwdriver or similar) into one of the two holes in the pad.
 3. Rotate the pad until the rod contacts the counter-weight.
 4. Undo the centre bolt using a 14mm socket. The socket has a reversed thread, turn it clockwise to undo it and anticlockwise to tighten it.

Environmental Protection.



Recycle unwanted materials instead of disposing of them as waste. All tools, accessories and packaging should be sorted, taken to a recycle centre and disposed of in a manner which is compatible with the environment.



When the product is no longer required, it must be disposed of in an environmentally protective way.



Rechargeable battery contains nickel cadmium (NiCad). It is recyclable. Take to your local recycling centre to be disposed of properly. Do not incinerate NiCad battery as it may explode when exposed to fire. Do not attempt to open battery pack.

NOTE: It is our policy to continually improve products and as such we reserve the right to alter data, specifications and component parts without prior notice.

IMPORTANT: No liability is accepted for incorrect use of this product.

WARRANTY: Guarantee is 12 months from purchase date, proof of which will be required for any claim.

INFORMATION: For a copy of our latest catalogue and promotions call us on 01284 757525 and leave your full name and address, including postcode.



Sole UK Distributor, Sealey Group,
Kempson Way, Suffolk Business Park,
Bury St. Edmunds, Suffolk,
IP32 7AR



01284 757500



www.sealey.co.uk



01284 703534



sales@sealey.co.uk



EC DECLARATION OF CONFORMITY

We the sole importers into the UK, hereby declare that the equipment described below

Description and Function:.....Cordless Polisher 230mm 18V + Charger.....

Model/Type:.....CP2518.....

Manufacturing Date / Serial number (optional).....

Manufacturer's authorised representative within the EC: **Jack Sealey Ltd. Kempson Way, Suffolk Business Park, Bury St. Edmunds, Suffolk, IP32 7AR**

Conforms to the requirements of the following Directives, as indicated.

- 2006/42/EC Machinery Directive
- 2000/14/EC Outdoor Noise Emissions Directive
- 2006/95/EC Low Voltage Directive
- 2002/96/EC WEEE Directive
- 2004/108/EC EMC Directive
- 2002/95/EC RoHS Directive
- 93/68/EEC CE Marking Directive
- 97/23/EC Pressure Equipment Directive

And the following harmonised standard(s): **BS EN 60745 part 1: 2006 & part 2-1: 2003**.....

BS EN 61558 part 1: 1998 & part 2-6: 1997 .. **BS EN 55014 part 1: 2006 + A1: 2009** .. **BS EN 61000 part 6-3:2007**.....

National technical standards and specifications (if applicable):.....

Technical file compiled by: **Jack Sealey Ltd.**

Signed:.....

Date:.....16-Dec-2009.....

Place: Bury St.Edmunds.

Name:.....Mark Sweetman.....

Position:.....Managing Director.....

Being the responsible person appointed by the manufacturer.



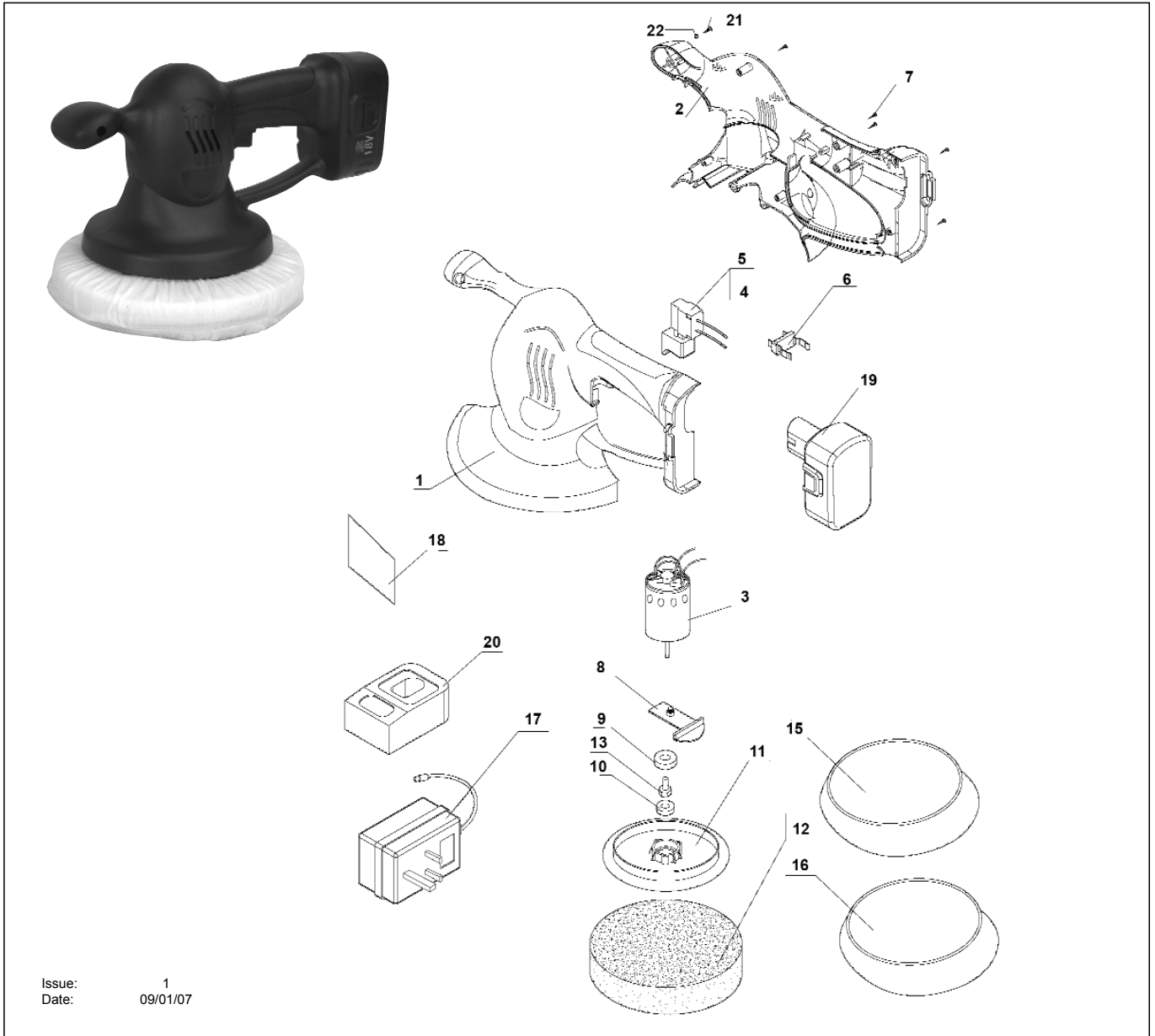

Issue: 1
 Date: 09/01/07

ITEM	PART NO.	DESCRIPTION
1	CP2518.01	LEFT HAND SIDE CASING
2	CP2518.02	RIGHT HAND SIDE CASING
3	CP2518.03	MOTOR ASSY
4	CP2518.04	USE CP2518.05 (SWITCH ASSY)
5	CP2518.05	SINGLE SPEED SWITCH, c/w WIRE FITTINGS
6	CP2518.06	POSITIVE & NEGATIVE CONTACT
7	CP2518.07	SELF TAPPING SCREW
8	CP2518.08	COUNTERWEIGHT
9	CP2518.09	USE CP2518.BP (BACKING PAD)
10	CP2518.10	USE CP2518.BP (BACKING PAD)
11	CP2518.11	USE CP2518.BP (BACKING PAD)

ITEM	PART NO.	DESCRIPTION
12	CP2518.12	USE CP2518.BP (BACKING PAD)
13	CP2518.13	BOLT, LEFT HAND THREAD
15	CP2518.15	USE ER230P.TB (TERRY BONNET)
16	CP2518.16	USE ER230P.WB (WOVEN BONNET)
17	CP2518.C	BATTERY CHARGER c/w BASE
18	CP2518.18	LABEL
19	CP2518.19	USE CP2518BP (BATTERY PACK)
20	CP2518.CB	USE CP2518.C (BATTERY CHARGER)
21	CP2518.21	CASING SCREW
22	CP2518.22	NUT