



VEHICLE STORAGE SHELTER

MODEL NO: **CCS01.V2**

Thank you for purchasing a Sealey product. Manufactured to a high standard, this product will, if used according to these instructions, and properly maintained, give you years of trouble free performance.

IMPORTANT: PLEASE READ THESE INSTRUCTIONS CAREFULLY. NOTE THE SAFE OPERATIONAL REQUIREMENTS, WARNINGS & CAUTIONS. USE THE PRODUCT CORRECTLY AND WITH CARE FOR THE PURPOSE FOR WHICH IT IS INTENDED. FAILURE TO DO SO MAY CAUSE DAMAGE AND/OR PERSONAL INJURY AND WILL INVALIDATE THE WARRANTY. KEEP THESE INSTRUCTIONS SAFE FOR FUTURE USE.



Refer to instruction manual

1. SAFETY

- ✓ Read these instructions before assembling and/or using the product.
- ✓ Perform a risk assessment before assembling the product.
NOTE: This is a temporary structure and is not recommended as a permanent structure.
- ✓ This product requires 2-3 people to assemble.
- ✓ This temporary shelter is intended to offer protection from damages caused by the sun, light rain, light snow, tree sap, bird and animal excrements.
- ✓ Have an overview of all parts before attempting installation. Make sure all components are available.
- ✓ Always wear safety glasses when assembling this product.
- ✓ Wear gloves when working with tubing to prevent cuts or abrasions.
- ❑ **WARNING!** Keep away from electrical wires!
- ❑ **WARNING!** Anchors must be used with all shelters. Covers should **NOT** be installed until it has been properly anchored to the ground.
NOTE: Proper anchoring and keeping cover tight and free of snow and debris, is the responsibility of the consumer. Damages caused by improper anchoring are not covered under warranty.
- ❑ **WARNING!** Keep all flame and heat sources away from the shelter fabric. The fabric will burn if left in continuous contact with a flame source.
- ❑ **WARNING!** In order to reduce risk of burning and avoid damage, **DO NOT:**
 - cook, smoke, refuel or use any open flame devices in or around the shelter.
 - store flammable liquids (gasoline, kerosene, propane, etc.) in the shelter.
 - operate gas powered equipment in or around the shelter.
- ✗ **DO NOT** install the shelter near overhead utility lines, branches etc.
- ✗ **DO NOT** install the shelter near roofs or other structures that may shed snow, ice or excessive run-off onto your shelter.
- ✗ **DO NOT** use this product in environments for which it is not intended (i.e. extreme cold, high winds, extreme heat, heavy rainfall, etc)
- ✗ **DO NOT** use hard-edged tools or instruments, such as rakes or shovels, to remove snow. These can cause punctures to the cover.
- ✗ **DO NOT** use it to shield goods from high winds, heavy snow or ice storms. Only use it for its intended purpose.
- ✗ **DO NOT** use open flames or cooking or heating devices inside or in close proximity to the product, including all types of stoves, gas heaters, gas lanterns, citronella torches, mosquito coils, etc.
- ▲ **DANGER! DO NOT** start the engine of any vehicle or machine inside a closed shelter. Ensure that there is adequate ventilation for starting engines and for any work with paints, cleaners, etc.

2. INTRODUCTION

Durable, water-resistant polyester cover suitable for year round protection. Mesh vent windows with covers that can be unfolded and secured with a hook and loop pad, or rolled up and tied in place to ventilate the car shelter. Hook and loop sections means the cover is easy to attach to the frame. Built in locking mechanism can be locked with a padlock to keep the shelter secure. Manufactured with painted steel frame and a hinged opening for easy-access. Shelter can be secured to the ground via a central anchor point (ground fixings included).

3. SPECIFICATION

Model No:	CCS01.V2
Overall Size (W x D x H):	2.7 x 5.5 x 2m
Material:	600D with PU coating



4. ASSEMBLY

NOTE: this product requires 2-3 people to assemble.

- 4.1. Check parts/fixings prior to assembly.
- 4.2. Attach the straight poles to the feet (fig.2), as per the numbers, using the fixings provided. Repeat for the other foot.
IMPORTANT: Ensure the poles attach on the outside of the feet, with the buttons (fig.3) facing inwards when assembled. Install the anchor bar (fig.4) at the back of the shelter using appropriate fixings for the ground surface.



4.3. INSTALLING THE COVER

☐ **WARNING!** Anchors must be used with shelters. Covers should **NOT** be installed until the frame has been anchored to the ground.

- 4.3.1. When installing the cover, start by threading an angled pole through the fixed sleeve. This is the back of the storage shelter.
- 4.3.2. Attach the angled pole to the straight poles (1-9 & 2-9) which are located at the back of the storage shelter. This will rest on the floor.
- 4.3.3. Attach the remaining angled poles to the straight poles to form the structure of the storage shelter.
- 4.3.4. Attach the support bars, from pole 1-9/2-9 to 1-6/2-6 with the fixings provided.
- 4.3.5. Attach the metal locking bars to 1-1 and 2-1/. Use the metal sleeves to lock the frame into position (fig.5).
- 4.3.6. Use the velcro sleeves to attach the cover onto the frame.
- 4.3.7. Tighten all fixings.
- 4.3.8. The fully closed position is shown in fig.6.



5. CLEANING

- ✓ Use warm water and mild soap to clean the shelter.
- ✗ **DO NOT** use bleach, alkaline or harsh detergents for cleaning. Doing so will damage the material.

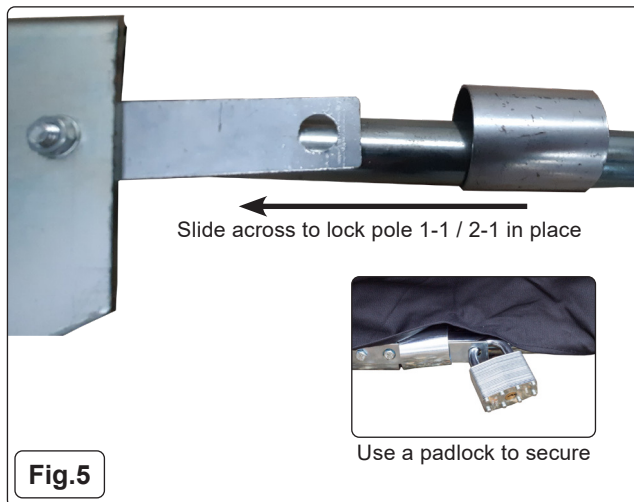

ENVIRONMENT PROTECTION

Recycle unwanted materials instead of disposing of them as waste. All tools, accessories and packaging should be sorted, taken to a recycling centre and disposed of in a manner which is compatible with the environment. When the product becomes completely unserviceable and requires disposal, drain any fluids (if applicable) into approved containers and dispose of the product and fluids according to local regulations.



Note: It is our policy to continually improve products and as such we reserve the right to alter data, specifications and component parts without prior notice. Please note that other versions of this product are available. If you require documentation for alternative versions, please email or call our technical team on technical@sealey.co.uk or 01284 757505.

Important: No Liability is accepted for incorrect use of this product.

Warranty: Guarantee is 12 months from purchase date, proof of which is required for any claim.

Sealey Group, Kempson Way, Suffolk Business Park, Bury St Edmunds, Suffolk. IP32 7AR



01284 757500



sales@sealey.co.uk



www.sealey.co.uk