



INSTRUCTIONS FOR:  
**AXLE STAND (SINGLE) 15 TONNE**  
**CAPACITY PER STAND ADJUSTABLE**  
MODEL NO: **ASA15000**

Thank you for purchasing a Sealey product. Manufactured to a high standard, this product will, if used according to these instructions and maintained properly, give you years of trouble free performance.

**IMPORTANT: PLEASE READ THESE INSTRUCTIONS CAREFULLY. NOTE THE SAFE OPERATIONAL REQUIREMENTS, WARNINGS & CAUTIONS. USE THE PRODUCT CORRECTLY AND WITH CARE FOR THE PURPOSE FOR WHICH IT IS INTENDED. FAILURE TO DO SO MAY CAUSE DAMAGE AND/OR PERSONAL INJURY AND WILL INVALIDATE THE WARRANTY. KEEP THESE INSTRUCTIONS SAFE FOR FUTURE USE.**

# PRODUCT RECALL

Due to potential safety issue these stands are subject to a product recall. If you have one or more of these stands please immediately remove from use and return to your place of purchase.



Refer to Instruction  
Manual

## 1. SAFETY

- ❑ **WARNING!**  
**DO NOT OVERLOAD AXLE STANDS BEYOND RATED CAPACITY. OVERLOADING CAN CAUSE DAMAGE TO, OR FAILURE OF, THE AXLE STANDS. POSITION LOAD ON CENTRE OF CRUTCH/SADDLE ONLY. ALWAYS USE STANDS IN PAIRS ON HARD LEVEL SURFACE CAPABLE OF SUSTAINING THE LOAD. USE OF STANDS ON OTHER THAN HARD LEVEL SURFACES CAN RESULT IN LOAD INSTABILITY AND POSSIBLE LOSS OF LOAD. DO NOT USE ON TARMACADAM. FAILURE TO FOLLOW THESE INSTRUCTIONS MAY RESULT IN DAMAGE TO AXLE STANDS, LOSS OF LOAD RESULTING IN PROPERTY DAMAGE, SERIOUS PERSONAL INJURY OR LOSS OF LIFE.**
  
- ▲ **DANGER! GREAT CARE MUST BE TAKEN TO ENSURE YOU LOWER THE VEHICLE (OR OTHER LOAD) SLOWLY AND CAREFULLY ONTO THE CENTRES OF THE CRUTCH/SADDLE OF THE AXLE STANDS.**
- ✓ Use only as specified by the manufacturer.
- ✓ Ensure the load does not exceed the maximum capacity as marked on the axle stand, per pair.
- ✓ Use no more than a single pair of stands. Use in pairs.
- ✓ No alterations or modifications shall be made to this product.
- ✓ Use on a hard, level surface, e.g. concrete. **DO NOT** use on uneven ground or asphalt
- ✓ Apply vehicle handbrake (put automatics in 'Park') before jacking and using the stands.
- ✓ Make sure that each stand is securely located under a strong point on the vehicle; consult the vehicle manufacturer's handbook for guidance.
- ✓ Ensure the load is directed through the vertical axis of the stand.
- ✓ Exercise extra care when using with a three wheeled vehicle or a trailer. Refer to vehicle manufacturer's instructions.
- ✓ Ensure that the vehicle and stands are stable before starting work.
- ✓ Inspect stands before each use. **DO NOT** use if they show signs of damage, or if it is suspected that they have been overloaded.
- ✓ Before commencing any work or going beneath the vehicle, undertake a risk assessment. Ensure that a responsible person is aware of the work about to be undertaken.
- ✓ Replace any labels on the axle stand should they become unreadable. This applies in particular to any warning or operation instruction labels. If replacement labels are required, contact your Sealey stockist.
- \* **DO NOT** push or twist the vehicle/load whilst it is supported on stands.
- \* **DO NOT** mix components between stands. Use only as supplied.
- \* **DO NOT** allow children or animals in the vicinity of a vehicle supported on axle stands.
- \* **DO NOT** leave a vehicle on axle stands in an area that could be considered a hazard to others or property.
- \* **DO NOT** apply horizontal forces or excessive torque load to vehicle whilst on stands.
- \* **DO NOT** use axle stands on the highway, or anywhere else if it is deemed to be unsafe.
- ✓ **FOLLOW STEPS 1, 2, AND 3 TO CORRECTLY PLACE VEHICLE / LOAD ONTO AXLE STANDS.**



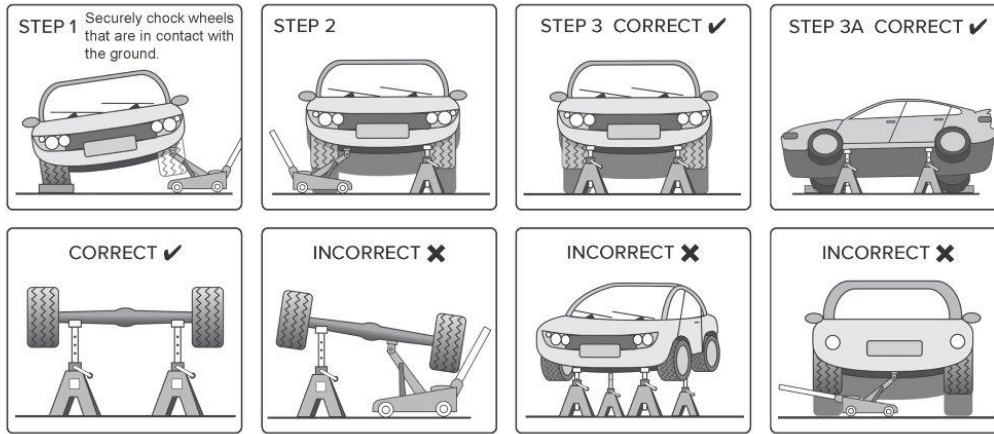

## 2. INTRODUCTION

Screw type axle stands with ball bearing thrust-race for smooth operation. Includes height adjustment extension handle. Ideal for supporting and positioning heavy loads. Sold as singles, but must be used in pairs.

## 3. SPECIFICATION

Model No: .....	<b>ASA15000</b>
Capacity: .....	15tonne
Minimum Height: .....	620mm
Maximum Height: .....	825mm

## 4. OPERATION

- 4.1. Refer to vehicle handbook for correct jacking procedure. Check to ensure manufacturer's recommended jacking points are in good condition.
  - 4.2. Position stands under recommended support points.
  - 4.3. To adjust the stands, hold the saddle and rotate the thrust race (using the extension handle if necessary) until the correct height has been achieved.
  - 4.4. Lower the vehicle carefully and slowly onto the stands. Ensure load bearing points sit in the centre of the saddles and that the stands are stable.
- ▲ **DANGER!** You must follow instructions carefully and ensure you **DO NOT** load the stands off centre. Failure to heed these warnings may cause damage, injury or loss of life.



## 5. MAINTENANCE

- 5.1. Before each use, check that stands and stand welds are not cracked and that there are no missing or damaged parts. Any suspect axle stands must be removed from service immediately.
- 5.2. Owing to the potential hazards associated with stands do not misuse, or make any modification, to the stands or components.
- 5.3. It is the responsibility of the owner to ensure that the operator has read these instructions and that the operator is familiar with its use and limitations.

**Parts support is available for this product. To obtain a parts listing and/or diagram, please log on to [www.sealey.co.uk](http://www.sealey.co.uk), email [sales@sealey.co.uk](mailto:sales@sealey.co.uk) or telephone 01284 757500.**

**Environmental Protection**



Recycle unwanted materials instead of disposing of them as waste. All tools, accessories and packaging should be sorted, taken to a recycling centre and disposed of in a manner which is compatible with the environment. When the product becomes completely unserviceable and requires disposal, dispose of it according to local regulations.

**NOTE:** It is our policy to improve products continually and as such we reserve the right to alter data, specifications and component parts without prior notice.

**IMPORTANT:** No liability is accepted for incorrect use of this product.

**WARRANTY:** Guarantee is 12 months from purchase date, proof of which will be required for any claim.

	Sole UK Distributor, Sealey Group, Kempson Way, Suffolk Business Park, Bury St. Edmunds, Suffolk, IP32 7AR	01284 757500	<a href="http://www.sealey.co.uk">www.sealey.co.uk</a>
		01284 703534	<a href="mailto:sales@sealey.co.uk">sales@sealey.co.uk</a>