



AXLE STANDS (PAIR) 2.5TONNE CAPACITY PER STAND

MODEL NO: **AS2500**

Thank you for purchasing a Sealey product. Manufactured to a high standard, this product will, if used according to these instructions, and properly maintained, give you years of trouble free performance.

IMPORTANT: PLEASE READ THESE INSTRUCTIONS CAREFULLY. NOTE THE SAFE OPERATIONAL REQUIREMENTS, WARNINGS & CAUTIONS. USE THE PRODUCT CORRECTLY AND WITH CARE FOR THE PURPOSE FOR WHICH IT IS INTENDED. FAILURE TO DO SO MAY CAUSE DAMAGE AND/OR PERSONAL INJURY AND WILL INVALIDATE THE WARRANTY. KEEP THESE INSTRUCTIONS SAFE FOR FUTURE USE.



Refer to instructions

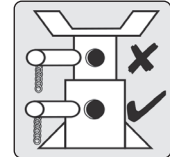

Fit pin through both the stands collar and the centre tube

1. SAFETY

❑ WARNING!

DO NOT OVERLOAD AXLE STANDS BEYOND RATED CAPACITY. OVERLOADING CAN CAUSE DAMAGE TO, OR FAILURE OF, THE AXLE STANDS. POSITION LOAD ON CENTRE OF CRUTCH/SADDLE ONLY. ALWAYS USE STANDS IN PAIRS ON HARD LEVEL SURFACE CAPABLE OF SUSTAINING THE LOAD. USE OF STANDS ON OTHER THAN HARD LEVEL SURFACES CAN RESULT IN LOAD INSTABILITY AND POSSIBLE LOSS OF LOAD. DO NOT USE ON TARMACADAM. FAILURE TO FOLLOW THESE INSTRUCTIONS MAY RESULT IN DAMAGE TO AXLE STANDS, LOSS OF LOAD RESULTING IN PROPERTY DAMAGE, SERIOUS PERSONAL INJURY OR LOSS OF LIFE.

▲ DANGER! GREAT CARE MUST BE TAKEN TO ENSURE YOU LOWER THE VEHICLE (OR OTHER LOAD) SLOWLY AND CAREFULLY ONTO THE CENTRES OF THE CRUTCH/SADDLE OF THE AXLE STANDS.

- ✓ Use only as specified by the manufacturer.
- ✓ Ensure the load does not exceed the maximum capacity as marked on the axle stand, per pair.
- ✓ Use no more than a single pair of stands either on the front, rear or one side of the vehicle. Use in pairs.
- ✓ No alterations or modifications shall be made to this product.
- ✓ Use on a hard, level surface, e.g. concrete. **DO NOT** use on uneven ground or tarmacadam.
- ✓ Securely chock wheels in contact with the ground. Before jacking and placing the stands, apply vehicle handbrake (put automatics in 'Park').
- ✓ Make sure that each stand is securely located under a strong point on the vehicle; consult the vehicle manufacturer's handbook for guidance. Ensure that height adjust locking mechanism is fully located before applying any load to the axle stand.
- ✓ Ensure that the load is located centrally on the saddle, and that the weight is directed through the vertical axis of the stand.
- ✓ Exercise extra care when using with a three wheeled vehicle or a trailer. Refer to vehicle manufacturer's instructions.
- ✓ Once vehicle is supported, ensure that the vehicle and stands are stable before starting work. Ensure that it is not possible for the vehicle to move before commencing any work.
- ✓ Inspect stands before each use. **DO NOT** use if they show signs of damage. **DO NOT** use if it is suspected that they have been overloaded.
- ✓ Before commencing any work or going beneath the vehicle, undertake a risk assessment. Ensure that a responsible person is aware of the work about to be undertaken.
- ✓ Replace any labels on the axle stand should they become unreadable. This applies in particular to any warning or operation instruction labels. If replacement labels are required, contact your Sealey stockist.
- ✗ **DO NOT** use axle stands on the highway, or anywhere else if it is deemed to be unsafe.
- ✗ **DO NOT** push or twist the vehicle/load whilst it is supported on stands.
- ✗ **DO NOT** mix components between stands. Use only as supplied.
- ✗ **DO NOT** allow children or animals in the vicinity of a vehicle supported on axle stands.
- ✗ **DO NOT** leave a vehicle on axle stands in an area that could be considered a hazard to others or property.
- ✓ **FOLLOW STEPS 1, 2, AND 3 TO PLACE VEHICLE / LOAD CORRECTLY ONTO AXLE STANDS.**

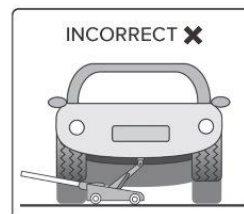
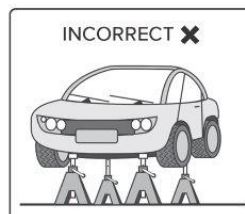
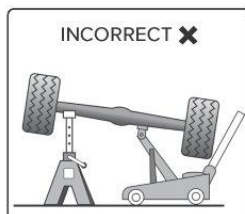
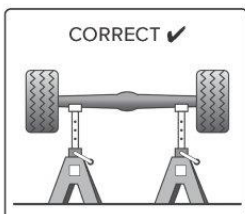
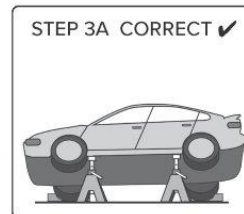
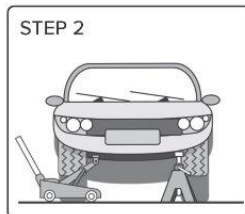
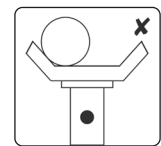
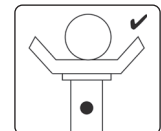

2. INTRODUCTION

All steel vehicle support stand with pin and chain. Full width V-crutch for safe support of load. Manufactured to vigorous safety standards. Proven workshop quality and reliability. Sold in pairs.

3. SPECIFICATION

Model No:..... **AS2500**
Capacity Each:..... 2.5tonne (2,500 kg)
Capacity Pair:..... 5tonne (5,000 kg)
Minimum Working Height:..... 342mm
Maximum Working Height:..... 500mm

4. OPERATION

- 4.1. Refer to vehicle handbook for correct jacking procedure and points. Check to ensure manufacturer's recommended jacking points are in good condition.
- 4.2. Position stands under recommended strong points and adjust to the required height.
 - **WARNING! IN THE HIGHEST POSITION BOTH ARMS OF THE 'U' PIN MUST PASS THROUGH THE UPPER COLUMN - THERE MUST NEVER BE MORE THAN FOUR HOLES VISIBLE ABOVE THE LOWER COLUMN (fig.1). ENSURE THAT THE 'U' PIN HAS PASSED RIGHT THROUGH THE UPPER AND LOWER COLUMN SO THAT BOTH ENDS ARE VISIBLE (fig.2)**
Lower the load onto stands carefully and slowly. Ensure load bearing points sit in the centres of the stand crutches and that the stands are stable. Also ensure that there are no objects or persons that could impede the safe lowering of the vehicle onto the stands.
 - ▲ **DANGER! You must follow instructions carefully and DO NOT load stand off centre. Failure to heed these warnings may cause damage and/or injury or loss of life!**

5. MAINTENANCE

- 5.1. Before each use, check that stands and stand welds are not cracked and that there are no missing or damaged parts.
- 5.2. Any suspect axle stand must be removed from service immediately.
- 5.3. Owing to the potential hazards associated with stands, do not misuse, or make any modification to, the stands or components.
- 5.4. It is the responsibility of the owner to ensure that the operator has read these instructions, together with the safety features on the side of the stand, and that the operator is familiar with the use and limitations of the stands.

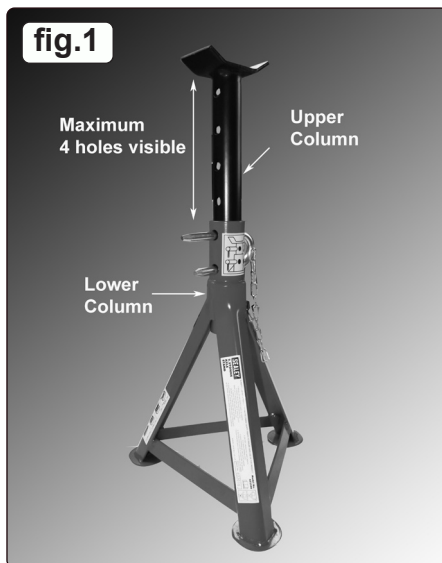

ENVIRONMENT PROTECTION

Recycle unwanted materials instead of disposing of them as waste. All tools, accessories and packaging should be sorted, taken to a recycling centre and disposed of in a manner which is compatible with the environment. When the product becomes completely unserviceable and requires disposal, drain any fluids (if applicable) into approved containers and dispose of the product and fluids according to local regulations.

Note: It is our policy to continually improve products and as such we reserve the right to alter data, specifications and component parts without prior notice. Important: No Liability is accepted for incorrect use of this product.

Warranty: Guarantee is 12 months from purchase date, proof of which is required for any claim.

Sealey Group, Kempson Way, Suffolk Business Park, Bury St Edmunds, Suffolk. IP32 7AR



01284 757500



01284 703534



sales@sealey.co.uk



www.sealey.co.uk