

Thank you for purchasing a Sealey Product. Manufactured to a high standard this product will, if used according to these instructions and properly maintained, give you years of trouble free performance.



IMPORTANT: PLEASE READ THESE INSTRUCTIONS CAREFULLY. NOTE THE SAFE OPERATIONAL REQUIREMENTS, WARNINGS AND CAUTIONS. USE THIS PRODUCT CORRECTLY AND WITH CARE FOR THE PURPOSE FOR WHICH IT IS INTENDED. FAILURE TO DO SO MAY CAUSE DAMAGE AND/OR PERSONAL INJURY AND WILL INVALIDATE THE WARRANTY. PLEASE KEEP INSTRUCTIONS SAFE FOR FUTURE USE.

1. SAFETY INSTRUCTIONS

- WARNING!** Ensure Health & Safety, local authority and general workshop practice regulations are adhered to when using this equipment.
- ✓ Familiarise yourself with the applications, limitations and potential hazards of this spring compressor.
- ✓ Maintain the spring compressor in good condition. Replace or repair damaged parts. Use genuine parts only. *Unauthorised parts may be dangerous and will invalidate the warranty.*
- ✓ Keep the work area clean, uncluttered and ensure there is adequate lighting.
- ✓ **WARNING!** Wear approved safety eye protection (standard spectacles are not adequate).
- ✓ Maintain correct balance and footing. Ensure the floor is not slippery and wear non-slip shoes.
- ✓ Remove ill fitting clothes. Remove ties, watches, rings and other loose jewellery. Contain or tie back long hair.
- ✓ Wear appropriate protective clothing.
- ✓ Keep children and unauthorised persons away from the working area.
- ✓ Ensure jaws are correctly engaged on spring before commencing compression.
- ▲ **DANGER!** Stop compressing the spring before it becomes coil bound.
- X **DO NOT** leave compressed spring unattended.
- X **DO NOT** operate spring compressor if parts are damaged or missing as this may cause failure and/or personal injury.
- X **DO NOT** use the spring compressor for a task it was not designed to perform.
- X **DO NOT** allow untrained persons to use the spring compressor.
- X **DO NOT** operate spring compressor if you are tired, or under the influence of alcohol, drugs or intoxicating medication.
- ✓ When not in use clean and store the spring compressor in a safe, dry, childproof location.
- WARNING!** Do not use air tools with this product.
- WARNING!** Do not compress the spring to an extent where the coil windings touch.
- WARNING!** Do not compress the spring to an extent where the jaws touch.
- ✓ Ensure the jaws and the body of the compressor are correctly aligned at all times during spring compression.

- WARNING!** The warnings, cautions and instructions discussed in this instruction manual cannot cover all possible conditions and situations that may occur. It must be understood that common sense and caution are factors which cannot be built into this product, but must be applied by the operator.

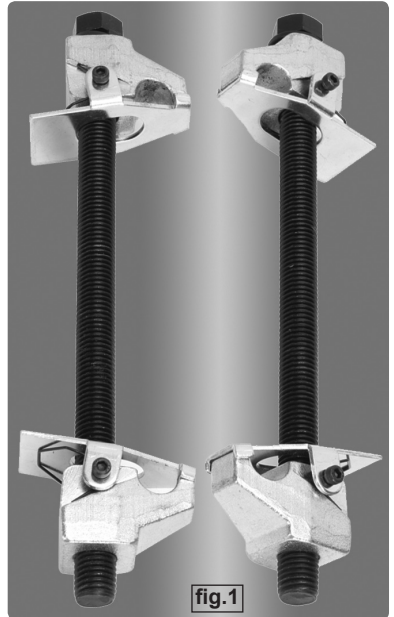

2. DESCRIPTION & SPECIFICATION

Features spring loaded safety jaws for easy location of the jaws on assembly. Prevents accidental release of spring under load. Use with 24mm hex socket or spanner.

Drive: 24mm Hex Max. Jaw Opening . . 230mm

3. INSTRUCTIONS FOR USE

- 3.1. Remove strut from vehicle according to procedures recommended in the manufacturer's service manual.
 - 3.1.1. Rotate the lower jaw on each compressor screw anticlockwise so that it is near to the bottom of the thread.
 - 3.1.2. The two compressor screws should be attached to the spring directly opposite each other as shown in fig.2.
 - 3.1.3. Attach the first screw by opening the lower jaw and placing it low down on the spring. Slide the moving jaw upwards, open it and place it as high as possible on the spring.
 - 3.1.4. Ensure that the compressor screw is vertical then rotate it clockwise until it makes contact with the sprung washer on top of the upper jaw. Do not put it under tension yet.
 - 3.1.2. Attach the second compressor screw in the same way ensuring that it is vertical and opposite the first screw.
 - 3.1.3. Make a final check that the jaws are correctly aligned, and the two screws are parallel to each other, see fig.2.
 - 3.1.4. Commence compressing the spring by turning the two screws clockwise using a suitable 24mm socket or spanner. The coil will need to be compressed equally on each side, alternate between each arm so as to not unbalance the spring. Compress the spring without allowing it to become coil bound.
 - 3.1.5. When spring is sufficiently compressed and is free to rotate on the strut remove top plate from strut, then withdraw the spring. **DO NOT drop the compressed spring assembly or subject it to any shock.**
 - 3.1.6. Reverse above procedure to replace spring.

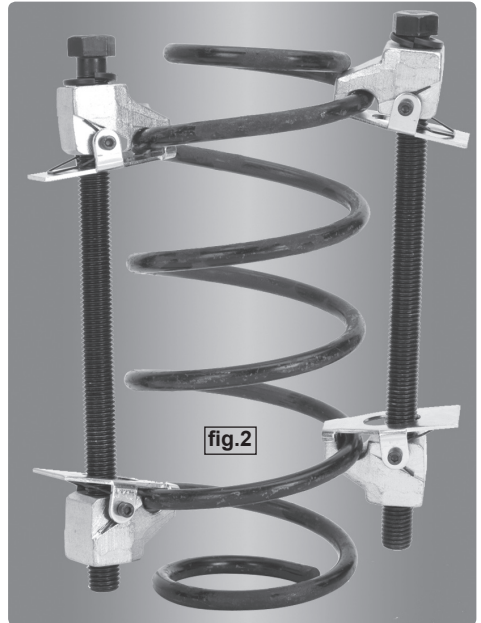

ALWAYS KEEP FORCE SCREW WELL LUBRICATED.



DO NOT USE AIR TOOLS

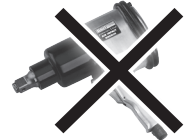

4. MAINTAINING THE COMPRESSOR

- 4.1. Before each use check the compressor components to ensure they are not damaged or worn. If suspect do not use the unit, but contact your local Sealey Dealer who will be able to advise you regarding repair kits and spare parts.
- 4.2. Keep the compressor screws lubricated.
- 4.3. Keep the compressor components clean, and when not in use store in a safe, dry, childproof location.

Parts support is available for this product. To obtain a parts listing and/or diagram, please log on to www.sealey.co.uk, email sales@sealey.co.uk or phone 01284 757500.

NOTE: It is our policy to continually improve products and as such we reserve the right to alter data, specifications and component parts without prior notice.

IMPORTANT: No liability is accepted for incorrect use of this product.

WARRANTY: Guarantee is 12 months from purchase date, proof of which will be required for any claim.

INFORMATION: For a copy of our latest catalogue and promotions call us on 01284 757525 and leave your full name and address, including postcode.



Sole UK Distributor, Sealey Group,
Kempson Way, Suffolk Business Park,
Bury St. Edmunds, Suffolk,
IP32 7AR

 01284 757500

 01284 703534

 www.sealey.co.uk

 sales@sealey.co.uk