



# VIKING 4TONNE LOW ENTRY TYRE BAY TROLLEY JACK WITH ROCKET LIFT

MODEL NO: **4040TB.V2**

Thank you for purchasing a Sealey product. Manufactured to a high standard, this product will, if used according to these instructions, and properly maintained, give you years of trouble free performance.

**IMPORTANT:** PLEASE READ THESE INSTRUCTIONS CAREFULLY. NOTE THE SAFE OPERATIONAL REQUIREMENTS, WARNINGS & CAUTIONS. USE THE PRODUCT CORRECTLY AND WITH CARE FOR THE PURPOSE FOR WHICH IT IS INTENDED. FAILURE TO DO SO MAY CAUSE DAMAGE AND/OR PERSONAL INJURY AND WILL INVALIDATE THE WARRANTY. KEEP THESE INSTRUCTIONS SAFE FOR FUTURE USE.



Refer to instructions



Wear safety footwear

## 1. SAFETY

### IMPORTANT SAFETY WARNING: ALWAYS USE AXLE STANDS

- ✓ Ensure the jack is in sound condition and good working order. Take action for immediate repair or replacement of damaged parts. *Use genuine parts only. The use of improper parts may be dangerous and will invalidate the warranty.*
  - ✓ Locate the jack in a suitable, well lit working area.
  - ✓ Keep working area clean and tidy and free from unrelated materials.
  - ✓ Use jack on level and solid ground, preferably concrete.
  - ✓ Avoid tarmac/adam as jack may sink in. Chock wheels of vehicle.
  - ✓ Ensure the vehicle handbrake is engaged, engine is switched off and transmission is in gear (or "PARK" if automatic).
  - ✓ Ensure minimum distance of 0.5m between vehicle and static objects such as doors, walls, etc., to allow for vehicle tilting.
  - ✓ Ensure all non-essential persons keep a safe distance whilst the jack is in use.
  - ✓ Ensure there are no passengers in the vehicle.
  - ✓ Place jack under only those lifting points recommended by vehicle manufacturer (see vehicle handbook).
  - ✓ Check that the lifting point is stable and centred on the jack saddle.
  - ✓ Ensure the jack wheels are free to move and that there are no obstructions.
  - ▲ **DANGER:** Use the jack for lifting only, **NOT** for supporting the lifted load.
  - ✓ Ensure there are no persons or obstructions beneath the vehicle before lowering.
  - ✓ Use suitable axle stands under the vehicle before proceeding with any task.
  - ✓ Use a qualified person to lubricate and maintain the jack.
- NOTE:** Use Sealey quality hydraulic jack oil, **Model No.s HJO500MLS / HJO5LS** to top up or replace the hydraulic fluid.
- ✗ **DO NOT** operate the jack if damaged.
  - ✗ **DO NOT** allow untrained persons to operate the jack.
  - ✗ **DO NOT** exceed the rated capacity of the jack.
  - ✗ **DO NOT** allow the vehicle to move during lifting or lowering, or use the jack to move the vehicle.
  - ✗ **DO NOT** jack vehicle if there is a risk of spillage of fuel, battery acid, or other dangerous substances.
  - ✗ **DO NOT** work under the vehicle until appropriately rated axle stands have been correctly positioned.
  - ✗ **DO NOT** use the jack for purposes other than that for which it is intended.
  - ✗ **DO NOT** top up hydraulic system with brake fluid. Use hydraulic jack oil only.
  - ✗ **DO NOT** adjust the safety overload valve.
  - ✓ When not in use store jack, fully lowered, in a safe, dry, childproof area.

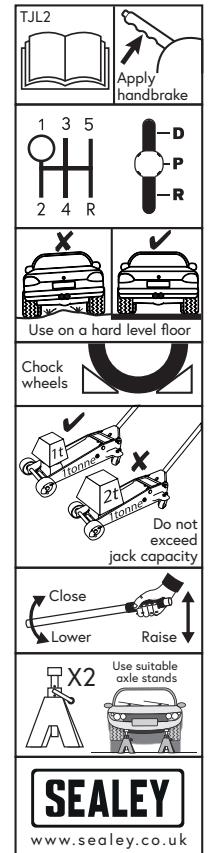

## 2. INTRODUCTION

Heavy-duty 10mm gauge steel base design with large jacking pad for greater strength and load stability. Universal joint release mechanism allows safer, more controlled lowering of the jack. Rocket Lift feature brings lifting arm into contact with jacking point with minimal pumps. Polyurethane wheels for smoother manoeuvrability and helps prevent damage to workshop floor. Protective jack handle sleeve helps prevent accidental damage to car bodywork when pumping the handle. Foot pedal for quick approach of the lifting saddle to the vehicle in confined spaces. Includes removable rubber saddle pad and built-in tool tray for fasteners and tools. 3 Year Warranty - 2nd & 3rd year subject to T's&C's and registration on website ([www.sealey.co.uk](http://www.sealey.co.uk)).

## 3. SPECIFICATION

Model No: ..... **4040TB.V2**  
 Applicable Standard: .....EN 1494:2000  
 Capacity:.....4tonne  
 Maximum Saddle Height:..... 533mm  
 Minimum Saddle Height: ..... 100mm  
 Consumable Parts: ..... Replacement Rubber Jack Pad - **JP17**

## 4. ASSEMBLY

- 4.1. Insert the upper handle into the lower handle. Secure the two pieces together with the bolt (fig.1.A).
- 4.2. Undo the handle socket screw until it no longer protrudes into the handle socket (fig.2.B).
- 4.3. Insert the pump handle into the handle socket, engaging the square drive of the release valve.
- 4.4. Ensure the handle is correctly inserted into the socket, then tighten the handle socket screw (fig.3.B).

## 5. OPERATION

- ❑ **WARNING!** Ensure you have read, understood and applied Section 1 safety precautions. **IMPORTANT:** Before use, the operator is to visually inspect the jack for cracked welds, damaged or missing parts or hydraulic leaks.

### 5.1. BEFORE FIRST USE

- 5.1.1. Before using jack for the first time, purge the hydraulic unit in order to eliminate any air in the system. Turn handle anti clockwise to open release valve.
- 5.1.2. Pump for 30 to 40 seconds. When complete, close the release valve by turning the handle clockwise.
- 5.1.3. Place a few drops of hydraulic jack oil on pump piston and pump handle several times to distribute oil. Thoroughly lubricate moving parts.

### 5.2. GENERAL JACKING

- ❑ **WARNING!** Before lifting ensure Safety instructions are read and understood.

- 5.2.1. Position the jack saddle under the vehicle manufacturer's recommended lifting point.

### 5.3. RAISING THE VEHICLE

- 5.3.1. Rotate handle clockwise to close the release valve.
- 5.3.2. Commence pumping handle up and down using maximum strokes until the jack saddle reaches the vehicle manufactures jacking point. Use the foot pedal as a fast lifting alternative method of raising saddle, especially useful in restricted spaces. Check the jacking point is centrally located on the saddle and raise the vehicle.
- 5.3.3. Should the jack become overloaded, a safety excess pressure valve will open, and stop the vehicle from lifting.

- ❑ **WARNING!** The jack is a lifting device only and must not be used to support the load. Use correctly rated axle stands to support the load.

### 5.4. LOWERING THE VEHICLE

- 5.4.1. If using axle stands, raise the jack high enough for the stands to be easily removed. Then turn handle anticlockwise very slowly to open the valve.
  - 5.4.2. The lowering speed is controlled by the amount you turn the handle. Lower carefully, avoid any sudden speed changes in descent rate which would shock load the hydraulic system.
- ❑ **WARNING!** Ensure there are no persons or obstacles beneath the vehicle, or in the path of its descent.

## 6. MAINTENANCE

**IMPORTANT:** Only fully qualified personnel should attempt maintenance or repair.

### 6.1. MONTHLY MAINTENANCE

Lubrication is critical to jacks. Any restriction due to dirt or rust can cause either slow or extremely rapid jack movement, causing damage to the internal components. To keep the jack well lubricated, carry out the following steps.

- 6.1.1. Lubricate the ram, the linkages and the saddle and pump mechanism with light oil.
- 6.1.2. Grease the wheel bearings and axles.
- 6.1.3. Keep all jack surfaces and warning labels clean.
- 6.1.4. Check and maintain the ram oil level (Section 7.3).

### 6.2. THREE MONTHLY MAINTENANCE

- 6.2.1. At three monthly intervals, check the ram for any signs of rust or corrosion. Clean the ram as required and wipe with an oiled cloth.

### 6.3. CHECKING THE OIL LEVEL

- 6.3.1. Fully retract the ram by turning the release valve counter-clockwise.
- 6.3.2. With the jack in the level position, remove the oil filler plug found under the removable magnetic wheel nut retention tray (fig.4).
- 6.3.3. The oil should be level with the bottom of the oil filler hole. If it is not, top up with clean hydraulic jack oil.
- 6.3.4. Replace the oil filler plug and check the jack operation.
- 6.3.5. Purge air from the hydraulic unit as required. Refer to Section 5.

**NOTE:** Always store the jack in the fully lowered position. This will protect critical areas from excessive corrosion. Owing to their size and weight, hydraulic products should ideally be repaired by local service agents. We have service / repair agents in most parts of the UK. Before returning your product please call our technical helpline on **01284 757505** for advice and troubleshooting guidance. *If the jack is under guarantee please contact your stockist.*

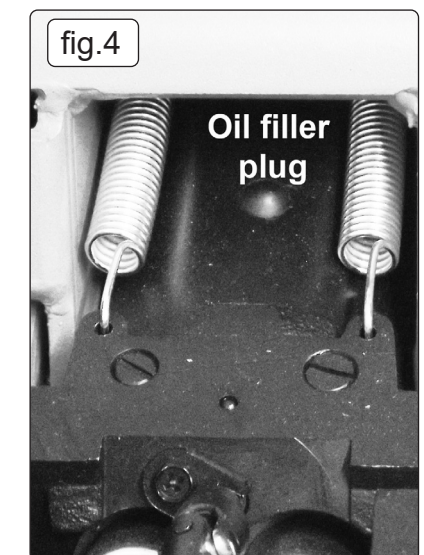
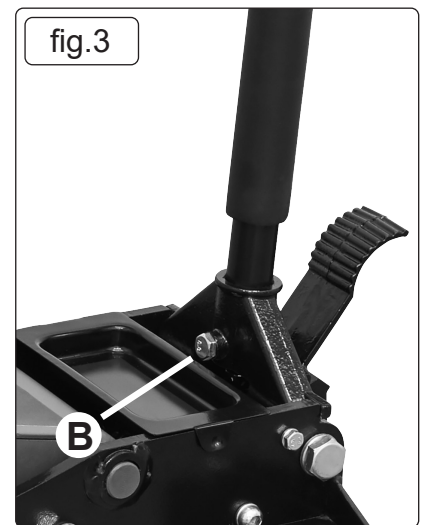
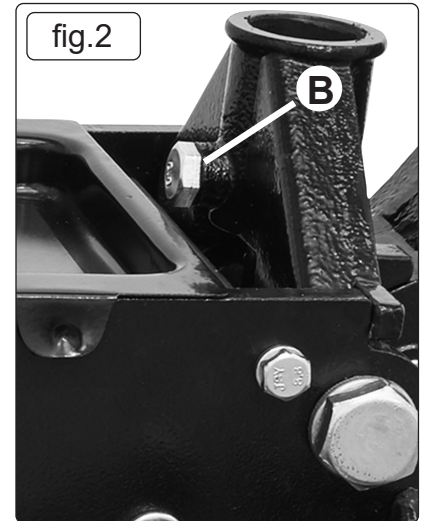
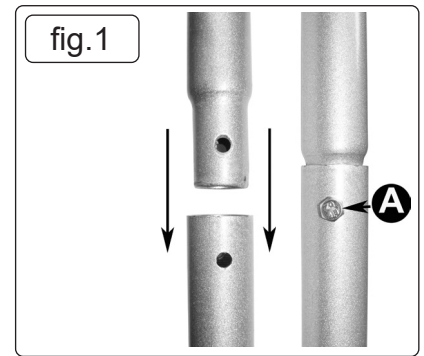

## 7. TROUBLESHOOTING

PROBLEM	POSSIBLE CAUSE	REMEDY
Jack will not lift the load	<ol style="list-style-type: none"> <li>1) Overloaded</li> <li>2) Oil level low</li> <li>3) Release valve not correctly closed</li> <li>4) Air in system</li> <li>5) Piston rod not functioning</li> <li>6) Packing worn or defective</li> </ol>	<ol style="list-style-type: none"> <li>1) Be sure to use jack with adequate capacity</li> <li>2) Top up oil level</li> <li>3) Check and close release valve</li> <li>4) Open release valve and pump the handle a few times. Close valve and re-try</li> <li>5) Clean and replace oil</li> <li>6) Replace packing</li> </ol>
Jack does not lift high enough Or feels "spongy"	<ol style="list-style-type: none"> <li>1) Oil level too high or too low</li> <li>2) Worn seals</li> <li>3) Air in system</li> <li>4) Release valve not closed</li> </ol>	<ol style="list-style-type: none"> <li>1) Fill or remove excess oil</li> <li>2) Return jack to local service agent</li> <li>3) Open release valve and pump the handle a few times. Close valve and re-try</li> <li>4) Check and close release valve</li> </ol>
Jack lifts poorly	<ol style="list-style-type: none"> <li>1) Pump packing or valves malfunctioning</li> <li>2) Oil is dirty</li> <li>3) Air in the system</li> </ol>	<ol style="list-style-type: none"> <li>1) Replace packing and/or clean valves</li> <li>2) Replace oil</li> <li>3) Open release valve and pump the handle a few times. Close valve and re-try</li> </ol>
Jack lifts but will not hold load	<ol style="list-style-type: none"> <li>1) Release valve partially open</li> <li>2) Dirt on valve seats</li> <li>3) Air in system</li> <li>4) Faulty seals</li> <li>5) Packing worn or defective</li> </ol>	<ol style="list-style-type: none"> <li>1) Check and close release valve</li> <li>2) Lower jack, close release valve. Place foot on front wheel and pull up lifting arm to it's full height by hand. Open the release valve to lower arm</li> <li>3) Open release valve and pump the handle a few times. Close valve and re-try</li> <li>4) Replace packing or contact local service agent</li> <li>5) Replace packing</li> </ol>
Jack will not lower completely	<ol style="list-style-type: none"> <li>1) Unit requires lubrication</li> <li>2) Piston rod bent or damaged</li> <li>3) Jack frame/link system distorted due to overloading/poor positioning</li> <li>4) Air in system</li> <li>5) Release valve partially closed</li> <li>6) Jack spring damaged or unhooked.</li> </ol>	<ol style="list-style-type: none"> <li>1) Oil all external moving parts</li> <li>2) Replace rod or contact local service agent</li> <li>3) Replace damaged parts or contact local service agent</li> <li>4) Open release valve and pump the handle a few times. Close valve and re-try</li> <li>5) Check and fully open release valve</li> <li>6) Replace spring or contact local service agent</li> </ol>
Jack does not lower at all	<ol style="list-style-type: none"> <li>1) Release valve closed</li> </ol>	<ol style="list-style-type: none"> <li>1) Check and fully open release valve</li> </ol>



### ENVIRONMENT PROTECTION

Recycle unwanted materials instead of disposing of them as waste. All tools, accessories and packaging should be sorted, taken to a recycling centre and disposed of in a manner which is compatible with the environment. When the product becomes completely unserviceable and requires disposal, drain any fluids (if applicable) into approved containers and dispose of the product and fluids according to local regulations.



**Note:** It is our policy to continually improve products and as such we reserve the right to alter data, specifications and component parts without prior notice. Please note that other versions of this product are available. If you require documentation for alternative versions, please email or call our technical team on [technical@sealey.co.uk](mailto:technical@sealey.co.uk) or 01284 757505.

**Important:** No Liability is accepted for incorrect use of this product.

**Warranty:** Guarantee is 36 months from purchase date, proof of which is required for any claim.

Sealey Group, Kempson Way, Suffolk Business Park, Bury St Edmunds, Suffolk. IP32 7AR



01284 757500



[sales@sealey.co.uk](mailto:sales@sealey.co.uk)



[www.sealey.co.uk](http://www.sealey.co.uk)