

SEALEY

BIG WHEEL HYBRID TROLLEY JACK FOR OFF ROAD VEHICLES, SUVS, VANS & 4X4S WITH SUPER ROCKET LIFT 2.5 TONNE

MODEL NO: **2500RG**

Thank you for purchasing a Sealey product. Manufactured to a high standard, this product will, if used according to these instructions, and properly maintained, give you years of trouble free performance.

IMPORTANT: PLEASE READ THESE INSTRUCTIONS CAREFULLY. NOTE THE SAFE OPERATIONAL REQUIREMENTS, WARNINGS & CAUTIONS. USE THE PRODUCT CORRECTLY AND WITH CARE FOR THE PURPOSE FOR WHICH IT IS INTENDED. FAILURE TO DO SO MAY CAUSE DAMAGE AND/OR PERSONAL INJURY AND WILL INVALIDATE THE WARRANTY. KEEP THESE INSTRUCTIONS SAFE FOR FUTURE USE.



Refer to instructions



Wear safety footwear

IMPORTANT. THE BIG WHEEL DESIGN AND CLOSED BASE OF THIS JACK MAKES IT EASY TO MOVE ON ROUGH GROUND OR OVER OBSTRUCTIONS IN THE WORKSHOP. IT IS NOT DESIGNED FOR LIFTING ON ROUGH OR SOFT GROUND AND IT IS ESSENTIAL THAT THE WHEELS OF THE JACK CAN MOVE FREELY ALONG THE FLOOR DURING THE LIFTING PROCESS. FAILURE TO RESPECT THIS WILL CREATE A SAFETY HAZARD AND WILL LIKELY INVALIDATE YOUR INSURANCE.

1. SAFETY

- ❑ **WARNING! ALWAYS USE AXLE STANDS**
- ❑ **WARNING!** Please note that the handle socket of this jack is retained under tension and must be released before use. Caution should be taken when releasing, as the handle socket will suddenly raise to its upright position if not controlled.
- ✓ The user shall work only in accordance with this instruction manual.
- ✓ The operator shall be provided with all necessary information about training and about pumping and translating forces.
- ✓ Ensure the jack is in sound condition and good working order. Take action for immediate repair or replacement of damaged parts. Use genuine parts only. **DO NOT** modify the jack. The use of non-genuine parts may be dangerous and will invalidate the warranty.
- ✓ Locate the jack in a suitable, well lit working area.
- ✓ Keep working area clean and tidy and free from unrelated materials. Use jack on level and solid ground, preferably concrete. Avoid tarmac as jack may sink in.
- ✓ Chock wheels of vehicle.
- ✓ Ensure the vehicle handbrake is engaged, engine is switched off and transmission is in gear (or "PARK" if automatic).
- ✓ Ensure minimum distance of 0.5m between vehicle and static objects such as doors, walls, etc. to allow for vehicle tilting.
- ✓ Ensure all non-essential persons keep a safe distance whilst the jack is in use.
- ✓ Ensure there are no passengers in the vehicle.
- ✓ It is necessary that the operator can watch the lifting device and the load during all movements.
- ✓ Place jack under only those lifting points recommended by vehicle manufacturer (see vehicle handbook).
- ✓ Check that the lifting point is stable and centred on the jack saddle.
- ✓ Ensure the jack wheels are free to move and that there are no obstructions.
- ▲ **DANGER:** Use the jack for lifting only, NOT for supporting the lifted load.
- ✓ Ensure there are no persons or obstructions beneath the vehicle before lowering.
- ✓ It is not allowed to work under the raised load until it is secured by suitable means. Use suitable axle stands under the vehicle before proceeding with any task.
- ✓ Use a qualified person to lubricate and maintain the jack.
- ✓ Ensure that only hydraulic jack oil is used in the jack.
- ✓ Lifting of persons is prohibited.
- ✗ **DO NOT** operate the jack if damaged.
- ✗ **DO NOT** allow untrained persons to operate the jack.
- ✗ **DO NOT** allow to come into contact with foodstuffs.
- ✗ **DO NOT** operate on sea ships.
- ✗ **DO NOT** operate the jack when tired or under the influence of drugs, alcohol or intoxicating medication.
- ✗ **DO NOT** exceed the rated capacity of the jack.
- ✗ **DO NOT** allow the vehicle to move during lifting or lowering, or use the jack to move the vehicle.
- ✗ **DO NOT** jack vehicle if there is a risk of spillage of fuel, battery acid, or other dangerous substances.
- ✗ **DO NOT** work under the vehicle until appropriately rated axle stands have been correctly positioned.
- ✗ **DO NOT** use the jack for purposes other than that for which it is intended.
- ✗ **DO NOT** top up hydraulic system with brake fluid. Use hydraulic jack oil only. (Sealey Part No: HJO500MLS or HJO5LS)
- ✗ **DO NOT** adjust the safety overload valve.
- ✓ When not in use store jack, fully lowered, in a safe, dry, childproof area.
- ✓ If more than 400N of effort is generated in lifting, the efforts shall be lowered by an additional person to help reduce the physical strain.
- ✓ Jacks shall be maintained and repaired in accordance with the manufacturer's instructions. Such maintenance and repair shall be carried out by qualified persons.
- ✓ No modifications shall be carried out which adversely affect the compliance of the jack with the standard.
- ✓ Check the state of the markings and that the markings remain as the initial one.
- ✓ **Environmental Factor Risks:** Wind, rain, or debris may affect jack stability and operator control.
- ✓ Avoid using the jack in adverse weather conditions.

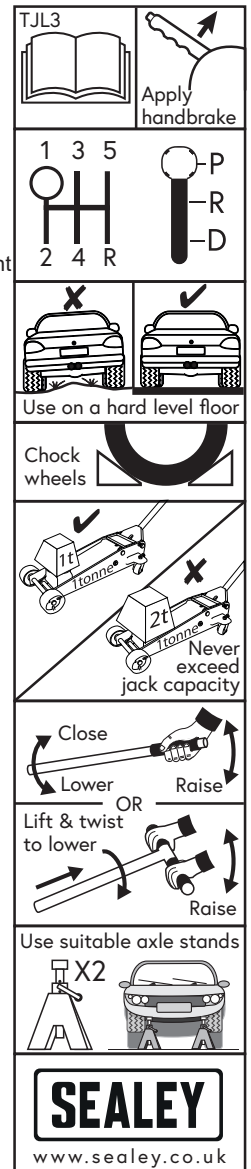

2. INTRODUCTION

Rocket Lift brings the lifting arm straight into contact with the jacking point with minimal pumps. Oversized fixed front and rear castor wheels allow this jack to travel effortlessly over rough ground, and obstructions on a workshop floor like cables or air hoses. Quick-change adjustable height extension with saddle giving an overall lifting range of 150mm to 714mm. Universal joint release mechanism and descent control valve allows for a safer, controlled lowering of the jack. Heavy-duty steel and aluminium construction provides stability and endurance.

3. SPECIFICATION

Model No:	2500RG
Capacity:	2.5 Tonne
Length:	749mm
Maximum Chassis Height:	374mm

Maximum Saddle Height:	246mm
Minimum Saddle Height:	200mm
Nett Weight:	32.7kg
Applicable Standards:	EN 1494:2000+A1:2008

4. ASSEMBLY

4.1. ATTACH WHEELS (FIG.1)

- 4.1.1. Slide a rear castor assembly onto each rear castor bracket, and front wheel onto each front axle.
- 4.1.2. Secure each wheel onto respective axle with provided lock nuts. Check to make sure lock nuts are tight.

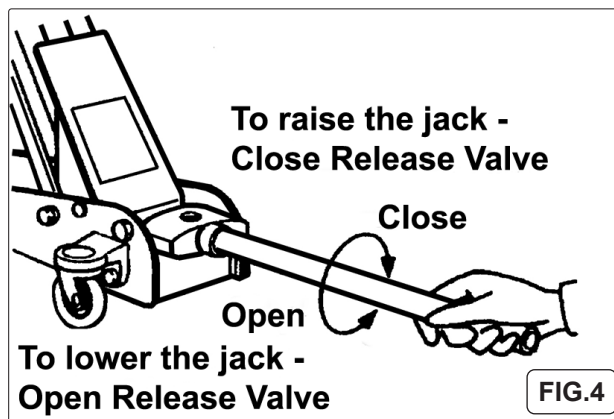
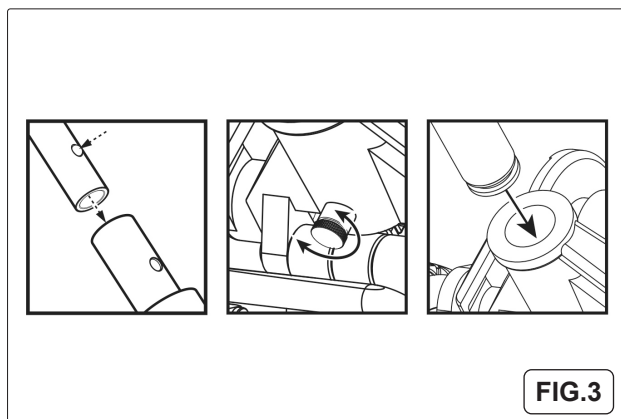
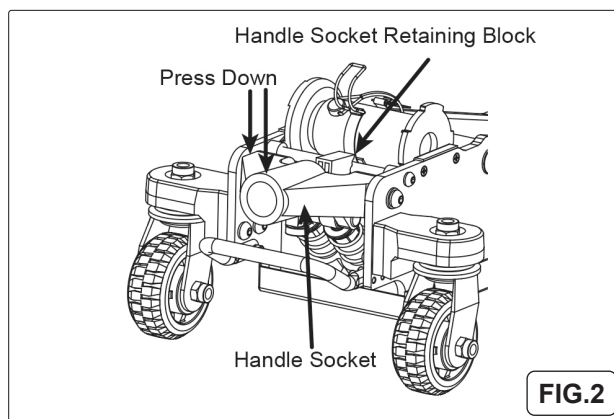
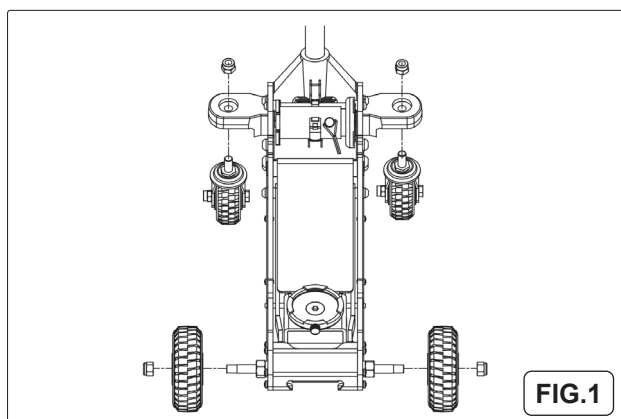

4.2. HANDLE SOCKET RETAINING BLOCK REMOVAL (FIG.2)

- 4.2.1. Your jack has been shipped with a retaining block to hold the handle socket in the downward position. This must be removed.
CAUTION: RETAINING BLOCK IS UNDER LOAD AND COULD POP OUT AND CAUSE PERSONAL OR PROPERTY DAMAGE. WEAR EYE PROTECTION AND GLOVES
- 4.2.2. **TO REMOVE.** Push down on the handle socket until the block can be removed from between handle socket and pull rod. A second person may be needed to hold the front of the jack down while applying downward force to the handle socket. Remove the block and allow the handle socket to raise to its upper resting position.

4.3. ATTACH PUMP HANDLE (FIGs.3 & 4)

- 4.3.1. Slide the lower handle into the upper handle until handle lock button locks. Loosen the handle socket screw in the handle socket.
- 4.3.2. Apply a small amount of grease to the handle socket. Place the assembled handle into the handle socket. Tighten the handle socket screw.

4.4. USE SADDLE EXTENSIONS:

Remove saddle pad, loosen the knurled flat head screw on the saddle.
Release saddle extension assembly from saddle extension holder (fig.8).
Place saddle extension on lower saddle.
Rotate saddle extension until locking flanges on both upper and lower saddle are fully engaged.
Tighten the knurled flat head screw.
Adjust saddle extension to desired height using locking pin.
Replace saddle pad.
Off centre load will make jack unstable.

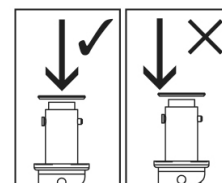

FIG.5

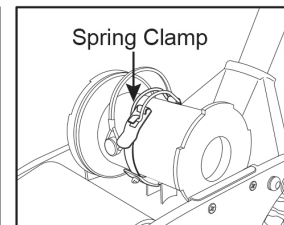
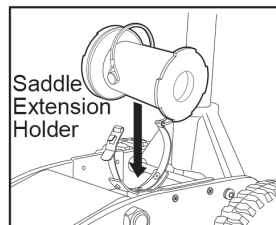
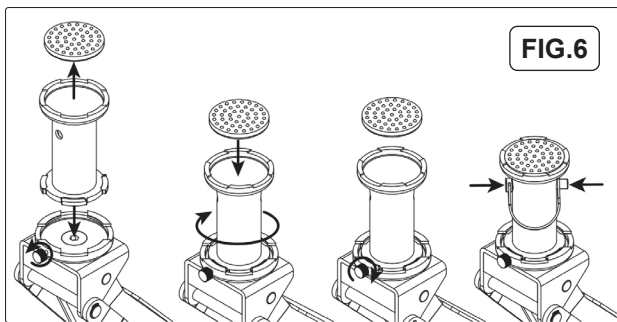
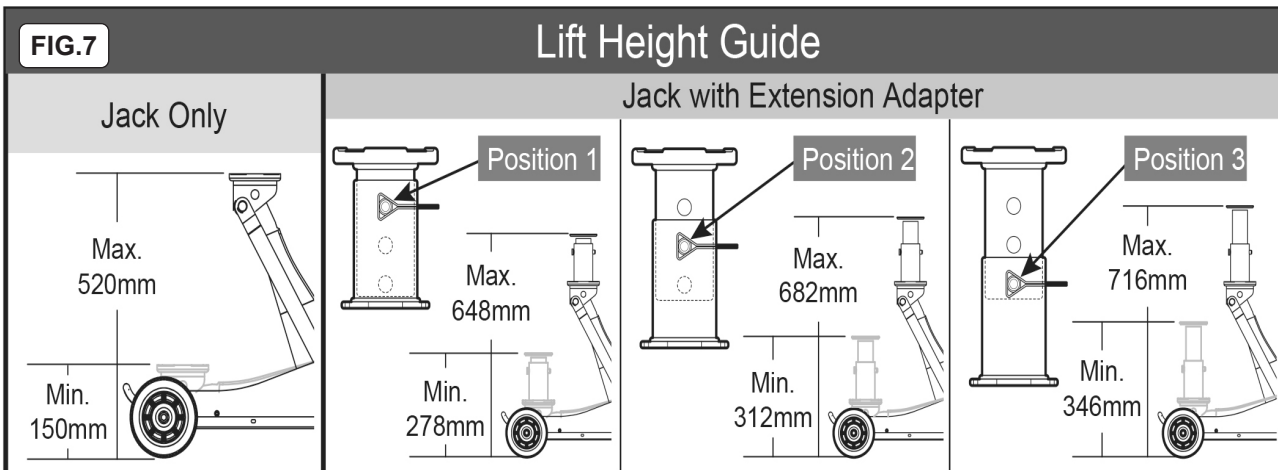

FIG.8



Make sure that load is always in the centre of the saddle. Saddle pad is removable, remove saddle pad to utilize saddle cup when necessary, (fig.5).

4.4.1. LIFT HEIGHT GUIDE (fig.7)

4.4.2. SADDLE EXTENSION HOLDER (fig.8):

Replace saddle extension in the holder:

Make sure saddle extension is on the lowest height setting and secure with pin.

Place saddle extension side-ways into the holder and secure spring clamp over the top, (fig.8).

4.5. BEFORE USE:

Before using this product, read the operator's instruction manual completely and familiarize yourself thoroughly with the product, its components and recognize the hazards associated with its use.

To familiarise yourself with basic operation, locate and turn the release valve (handle):

A. Clockwise until firm resistance is felt, indicating no further turning is possible. This is the "CLOSED" release valve position used to raise the saddle.

B. Turn the release valve counter-clockwise, but no more than 1/2 turn from the closed position. This is the "OPEN" position used to lower the saddle.

With the saddle fully lowered and the release valve closed, pump the operating handle. If the lift arm responds immediately, the jack is ready for use. If the jack does not respond, follow the Bleeding/Venting Trapped Air procedure below.

4.6. BLEEDING/VENTING TRAPPED AIR

With the release valve in the OPEN position and the saddle fully lowered, locate and remove the oil filler plug/screw. Pump the handle 6 to 8 full strokes. This will help release any pressurized air that may be trapped within the reservoir. Check the oil level and reinstall the oil filler plug/screw.

4.7. TO AVOID CRUSHING AND RELATED INJURIES:

Never work on, under, or around a load supported only by a hydraulic jack.

Always use a pair of adequately rated axle stands.

Chock each tyre in both directions.

DO NOT use this device to lift, level, lower, support, or move a house, mobile home, travel trailer, camper, or any building structure. Be alert and sober when using this product. **DO NOT** operate under the influence of drugs or alcohol.

5. OPERATION

❑ **WARNING!** Before use ensure you have read, understood and applied Section 1 safety precautions.

IMPORTANT: Before use, the operator is to visually inspect the jack for cracked welds, damaged or missing parts or hydraulic leaks.

5.1. MANUAL CONTROLS

5.1.1. LIFTING

Follow the vehicle manufacturer's recommended guidelines for lifting. Engage the emergency brake and chock each unlifted wheel in both directions to prevent inadvertent vehicle movement.

Close the release valve by turning the handle clockwise until firm resistance is felt.

Refer to the vehicle owner's manual to locate approved lifting points. Centre the jack saddle under the lift point.

Pump the handle to make contact with the lift point, then continue pumping until the load reaches the desired height.

Transfer the load immediately to appropriately rated axle stands.

5.1.2. LOWERING

- ❑ **WARNING!** Ensure that the area below, all tools and personnel are clear before lowering the load.
Stand clear of the load during lowering.
Maintain control of the load at all times.
Lower the load slowly and in a controlled manner.
After removing the jack from under the vehicle, lower the lifting arm completely to reduce ram exposure to rust and contamination.

5.2. IN THE EVENT OF MALFUNCTION OR BREAKDOWN:

If the load fails to lower:
Use a functioning jack to raise the vehicle high enough to reinstall the axle stands.
Remove the malfunctioning jack, then remove the axle stands.

6. MAINTENANCE

IMPORTANT: Only fully qualified personnel should attempt maintenance or repair.

Jacks shall be maintained and repaired in accordance with the manufacturer's instructions. Such maintenance and repair shall be carried out by qualified persons. No modifications shall be carried out which adversely affect the compliance of the jack with the standard. Check the state of the markings and that the markings remain as the initial one.

- 6.1. Before each use check for broken, cracked, bent, or loose parts, or any visible damage to ram, pump, saddle, lifting arm, frame and all parts including nuts, bolts, pins and other fasteners. If any suspect item is found remove jack from service and take necessary action to remedy the problem.

✱ **DO NOT** use the jack if believed to have been subjected to abnormal load or shock load.

- 6.2. When the jack is not in use, the ram should be in its lowest position to minimise corrosion. Remove the handle to inactivate jack.

- 6.3. Periodically check the pump piston and the ram for signs of corrosion. Clean exposed areas with a clean oiled cloth.

- 6.4. Keep the jack clean and lubricate all moving parts with oil on a regular basis.

6.5. ADDING OIL

When refilling the hydraulic system, the characteristics of the hydraulic fluid used in the jack and the level of the hydraulic fluid as it is given by the manufacturer shall be observed.

Lower the Saddle Completely: Ensure the saddle is fully lowered and the jack is in its upright, level position.

Remove saddle extension holder assembly (refer to Parts List).

Remove the Vent Screw: Unscrew and remove the vent screw to allow air to escape during the filling process.

Fill with Hydraulic Oil: Pour the hydraulic oil into the filler hole until the oil level reaches approximately 3/16" above the inner cylinder (this can be seen from the oil filler hole).

Reinstall the Vent Screw: Once the oil has been added, securely reinstall the vent screw to seal the system.

Replace saddle extension holder assembly.

6.6. CHANGING OIL

For optimal performance and longevity, replace the hydraulic fluid at least once per year.

Lower the Saddle Fully: Ensure the saddle is fully lowered, and place the jack in its upright, level position.

Remove saddle extension holder assembly (refer to Parts List).

Remove the Vent Screw: Unscrew and remove the vent screw to allow the fluid to drain properly.

Drain the Fluid: Lay the jack on its side and allow the hydraulic fluid to drain into a suitable container.

NOTE: Dispose of the used hydraulic fluid in accordance with local environmental regulations.

Fill with New Hydraulic Oil: Refill the jack with fresh hydraulic oil until the oil level is approximately 3/16" above the inner cylinder, which can be seen through the oil filler hole.

Reinstall the Vent Screw: Once the oil has been added, securely reinstall the vent screw to seal the system.

Replace saddle extension holder assembly.

6.7. LUBRICATION

To ensure smooth operation and prevent rust, periodically apply a light lubricating oil to the following components:

Pivot Points, Axles, and Hinges: Apply oil to these areas to prevent rust and ensure smooth movement.

Wheels and Castors: Lubricate the wheels and castors to maintain free movement.

Pump Assembly: Lubricate the pump assembly to ensure efficient operation.

Lift Arm: Apply grease to the lift arm through the grease fittings.

Regular lubrication helps extend the lifespan of the trolley jack and ensures it functions smoothly.

NOTE: Use Sealey quality hydraulic jack oil, Model No's HJO500MLS / HJO5LS to top up or replace the hydraulic fluid.

- ❑ **WARNING: DO NOT** use brake fluid, or any fluid other than hydraulic jack oil as this may cause serious damage to the jack and will invalidate the warranty.

- 6.8. **IN THE EVENT OF AN OIL SPILL:** Prevent spilled oil from spreading and, in particular, prevent it from getting into drains and waterways. Use absorbing material such as earth, sand, cat litter or commercial products.

7. TROUBLESHOOTING

PROBLEM	POSSIBLE CAUSE	REMEDY
Jack will not lift the load	1) Release valve not correctly closed 2) Overloaded 3) Air in system 4) Oil level low	1) Check and close release valve and try again 2) Be sure to use jack with adequate capacity 3) Open release valve and pump the handle a few times 4) Top up oil level and repeat point 3
Jack does not lift high enough Or feels "spongy"	1) Oil level too high or too low 2) Worn seals 3) Air in system 4) Release valve not closed	1) Fill or remove excess oil 2) Return jack to local service agent 3) Open release valve and pump the handle a few times. Close valve and re-try 4) Check and close release valve

Jack lifts poorly	1) Pump packing or valves malfunctioning 2) Oil is dirty 3) Air in the system	1) Replace packing and/or clean valves 2) Replace oil 3) Open release valve and pump the handle a few times. Close valve and re-try
Jack lifts but will not hold load	1) Release valve partially open 2) Dirt on valve seats 3) Air in system 4) Faulty seals 5) Packing worn or defective	1) Check and close release valve 2) Lower jack, close release valve. Place foot on front wheel and pull up lifting arm to it's full height by hand. Open the release valve to lower arm 3) Open release valve and pump the handle a few times. Close valve and re-try 4) Replace packing or contact local service agent 5) Replace packing
Jack will not lower completely	1) Unit requires lubrication 2) Piston rod bent or damaged 3) Jack frame/link system distorted due to overloading/poor positioning 4) Air in system 5) Release valve partially closed 6) Jack spring damaged or unhooked.	1) Oil all external moving parts 2) Replace rod or contact local service agent 3) Replace damaged parts or contact local service agent 4) Open release valve and pump the handle a few times. Close valve and re-try 5) Check and fully open release valve 6) Replace spring or contact local service agent
Jack does not lower at all	1) Release valve closed	1) Check and fully open release valve
If the above does not solve the problem contact your local Service agent by checking www.sealey.co.uk		



ENVIRONMENT PROTECTION

Recycle unwanted materials instead of disposing of them as waste. All tools, accessories and packaging should be sorted, taken to a recycling centre and disposed of in a manner which is compatible with the environment. When the product becomes completely unserviceable and requires disposal, drain any fluids (if applicable) into approved containers and dispose of the product and fluids according to local regulations.



REGISTER YOUR
PURCHASE HERE

Note: It is our policy to continually improve products and as such we reserve the right to alter data, specifications and component parts without prior notice.

Important: No Liability is accepted for incorrect use of this product.

Warranty: Guarantee is 12 months from purchase date, proof of which is required for any claim.

Jack Sealey Ltd t/a Sealey Group, Kempson Way, Suffolk Business Park, Bury St Edmunds, Suffolk, IP32 7AR UK

Jack Sealey (EU) Ltd t/a Sealey Group, Farney Street, Carrickmacross, Co. Monaghan, A81 PK68 Ireland

Tel: 01284 757500 • **Email:** sales@sealey.co.uk • **Web:** www.sealey.co.uk