

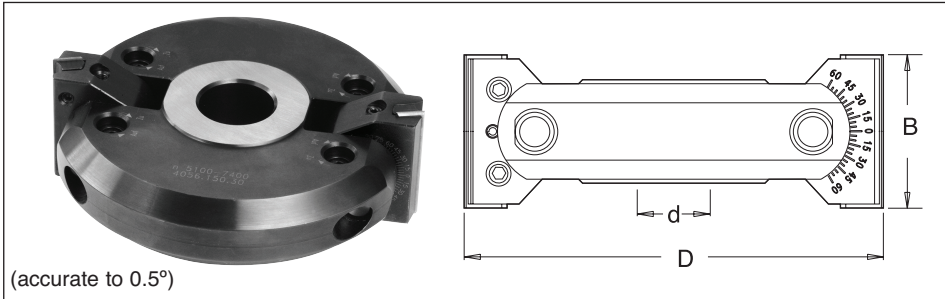

Disposable Insert Adjustable Chamfer Cutter Blocks

Cutterhead bodies available in hard wearing aluminium or steel, complete with disposable tungsten carbide knives. Suitable for producing chamfer cuts at various angles in softwood, hardwood and man-made boards on a spindle moulder. Cutting angle can be adjusted in 7.5° steps by using notched scale. Fine adjustment of 1° is also possible.



(accurate to 0.5°)

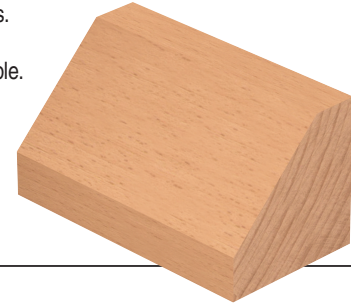

Hand Feed EN847-1/2

øD	B	Product Ref.	a	ød	n
110	40	IT/734 014 1	-45.0° → +45.0°	30	7,000 - 9,000
110	40	IT/734 014 7	-45.0° → +45.0°	1 1/4"	7,000 - 9,000
120	40	IT/734 015 1*	-45.0° → +45.0°	30	6,400 - 8,500
130	50	IT/734 016 1	-67.5° → +67.5°	30	5,000 - 8,500
150	50	IT/734 017 1	-90.0° → +90.0°	30	5,100 - 7,400
150	50	IT/734 017 7	-90.0° → +90.0°	1 1/4"	5,100 - 7,400

Spare Parts

Tools above also available with a 1 1/4" bore, replace last digit with a 7.

*Aluminium body

Description	T.C. Blade		Wedge		Hex Screw	Locking Wedge	Hex Key	
Product Ref.	IT/300 052 8/10 B=40	IT/310 125 0/10 B=50	IT/199 082 0 B=40	IT/199 083 0 B=50	IT/193 049 4	IT/199 403 1	IT/194 003 5	IT/194 003 6
Size	40x12x1.5	50x12x1.5	L=38	L=48	M6x8		S3	S4

Disposable Insert Adjustable Chamfer Cutter Blocks

Cutterhead bodies available in hard wearing aluminium complete with disposable tungsten carbide knives. Suitable for producing chamfer cuts at various angles in softwood, hardwood and man-made boards on a spindle moulder. Fine adjustment of the cutting angle in 1° steps is possible by using the special geared mechanism.

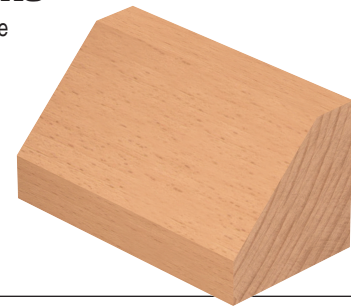
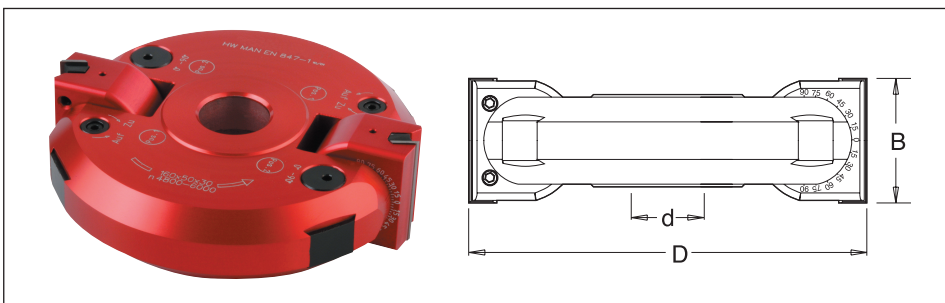

Hand Feed EN847-1/2

øD	B	Product Ref.	a	ød	n
160	50	IT/734 030 1	-90° → +90°	30	4,800 - 6,000
160	50	IT/734 030 7	-90° → +90°	1 1/4"	4,800 - 6,000
170	60	IT/734 035 1	-90° → +90°	30	4,500 - 6,000
170	60	IT/734 035 7	-90° → +90°	1 1/4"	4,500 - 6,000

Spare Parts

Description	T.C. Blade		Wedge		Hex Screw	Locking Wedge	Hex Key	
Product Ref.	IT/310 125 0/10 B=50	IT/300 053 1/10 B=60	IT/199 080 0 B=50	IT/199 081 0 B=60	IT/193 065 0	IT/199 403 0	IT/194 003 5	IT/194 003 6
Size	50x12x1.5	60x12x1.5	L=48	L=58	M6x10		S3	S4

Blades sold in packs of ten.