

# DISPOSABLE INSERT PROFILE - COUNTER/PROFILE ROUTER CUTTER SET - TWO FLUTE

- Suitable for various thickness profile, counter/profile joints in softwoods, hardwoods and man-made boards for kitchen and internal doors.
- Set 1, 2 and 3 come complete with profile 1 only.
- For use on routers and machining centres with CNC control.
- Recommended RPM (n): 12,000.

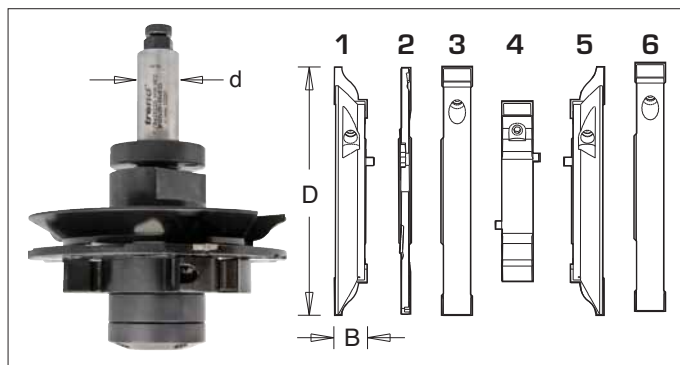

øD	Cutters	B	Fig.	L	ød	Product Ref.	Stock	Price
120	1,2,3,4	20-35	1,2	135	20	IT/842 021 0	N	£663.87
120	1,2,3,4,5	20-35	1,2,3	125	20	IT/842 022 0	Y	£924.21
120	1,2,3, 2x4,5,6	20-35	1,3,4	125	20	IT/842 061 0	N	£992.39

## INDIVIDUAL TOOLS

øD	B	Cutter No.	Profile	z	Product Ref.	Stock	Price
120	16	1	1	2	IT/842 111 3	N	£234.54
120	16	1	2	2	IT/842 211 3	N	£234.54
120	16	1	3	2	IT/842 311 3	N	£234.54
120	16	1	4	2	IT/842 411 3	N	£234.54

120	5	2	4	IT/842 012 3	N	£191.03
120	15	3	2	IT/842 013 3	Y	£175.62
88	15	4	2	IT/842 014 3	N	£175.62

120	16	5	1	2	IT/842 115 3	Y	£234.54
120	16	5	2	2	IT/842 215 3	N	£234.54
120	16	5	3	2	IT/842 315 3	N	£234.54
120	16	5	4	2	IT/842 415 3	N	£234.54
120	15	6	2	IT/842 016 3	N	£234.54	

### PROFILE 1

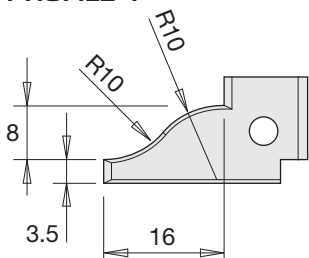

IT/311 752 0 - for cutter 1  
IT/311 752 0L - for cutter 5

### PROFILE 2

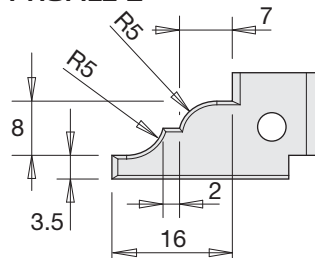

IT/311 752 1 - for cutter 1  
IT/311 752 1L - for cutter 5

### PROFILE 3

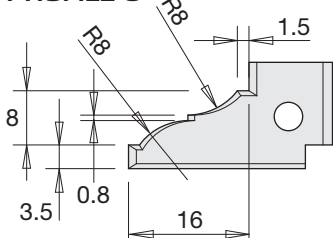

IT/311 752 2 - for cutter 1  
IT/311 752 2L - for cutter 5

### PROFILE 4

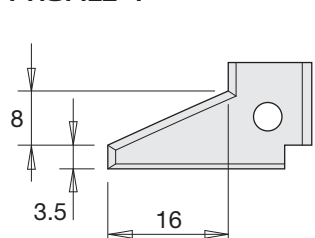

IT/311 752 3 - for cutter 1  
IT/311 752 3L - for cutter 5

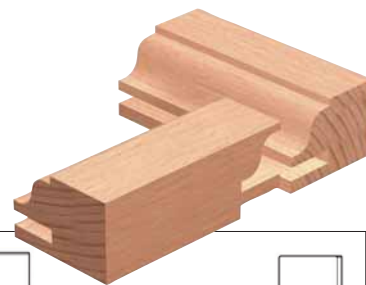

FIG. 1

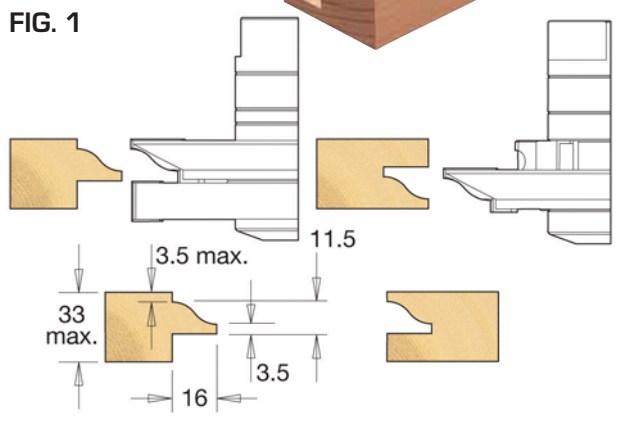
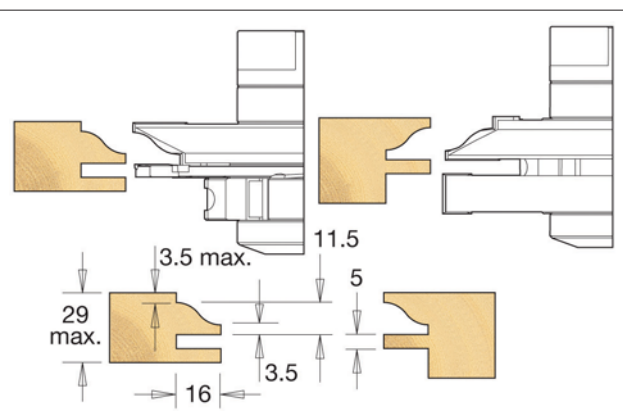
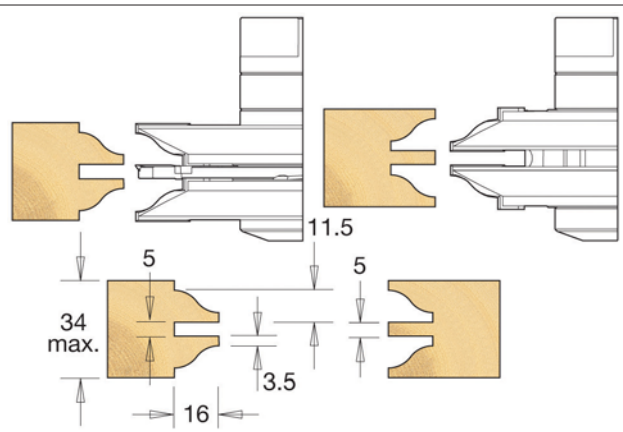
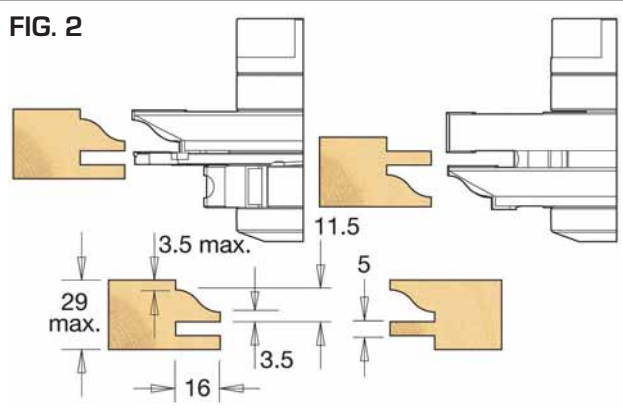

FIG. 2



### KEY

Stock - Y means normally kept in stock for next day delivery.  
N means not normally held in stock, delivery in a short time.

