

# LARGE COMPASS

*This router compass is used for cutting circles and arcs from 100mm up to 610mm radius.*

- Made from clear plastic.
- Printed graduated scale for precise radius setting.
- Fits to the base of a router.
- The hole accepts a 30mm guide bush.

**R/COMPASS/A** £49.38

**SPECIFICATION:**

Radius min. 100mm  
Radius max. 610mm

**INCLUDES:**

- 1 x Main plate
- 1 x 'V' pivot point
- 1 x 3mm pivot point
- 2 x Fixing screws



Two types of pivot can be fitted to compass, V-point or 3mm point.

## BEAM TRAMMELS

*For circle cutting with a router.*

### BEAM TRAMMEL BARS

- Can be used with the majority of routers on the market.
- The bar fits into one of the holes for the router side-fence.
- Pivot point height is adjustable.

**BEAM/001** £19.46

8mm rod dia. x 500mm

**BEAM/002** £28.58

10mm rod dia. x 500mm



### BEAM TRAMMEL ATTACHMENT POINT

- The point attaches to one of the router's fixed rods.
- Pivot point is adjustable in height and this trammel can be used on most 8mm rods.

**BEAM/005** £8.35

For 8mm dia. fence rods

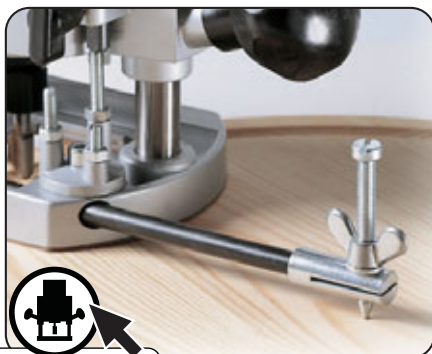

## ROUTING BOOK

*'Complete Routing' by Alan Holtham, an essential read for the amateur or the experienced router user.*

Full of easy to read routing techniques and step by step guides on how to use your router to its full potential. With only a little experience you will soon be using the router to transform both the making and the detail of all your woodworking projects.

Includes four step by step projects for all abilities:

- Bathroom cabinet
- Occasional table
- Bathroom storage rack
- Settle seat

**BOOK/CR** £20.16

(VAT exempt)

