

ROUTER TABLE ALLOY INSERT PLATE

Large alloy insert plate for incorporation into user made router tables.

Fitting Insert Plate into User Made Router

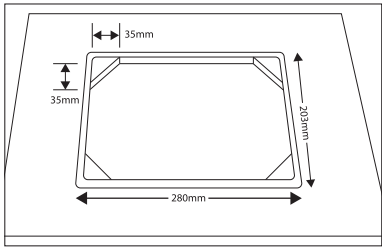

- Rout out aperture 280mm x 205mm leaving 35mm x 35mm mitre corners.
- Rebate inner top edge 8mm deep and minimum 12.7mm wide to accept insert plate. Recess 8mm deep above mitre corners.

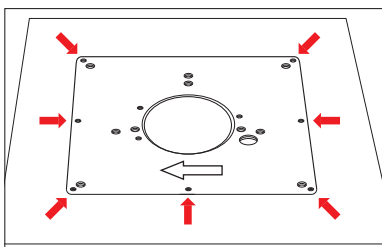

- Using insert plate as a guide, drill seven 8mm dia. holes 5mm deep to accept levelling plate magnets. Mark and drill four 7mm dia. holes for the M5 threaded inserts (the hole entrance will need a slight countersink).
- Thread the inserts into the table top using a 5mm A/F hex key (not supplied).
- Fit magnet into 8mm holes.
- Fit insert plate to table top. Level insert plate using 3mm A/F hex key. When level fix the insert plate to table top to secure using the M5 machines screws.
- Mount Trend Base Configuration (TBC) router using the M6 countersink machine screws. If your router does not have TBC holes, please follow instructions below.

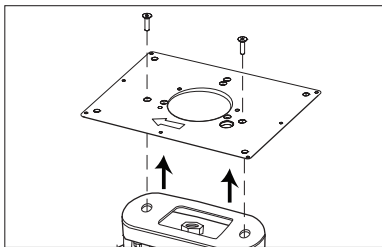

- After use leave insert plate in router table top.

Re-drilling Router Base Only

- Invert and stand your router on a suitable surface.
- Remove insert plate from table and place it facing upwards onto the base of your router.
- Adjust position of the insert plate to centralise.
- Ensure that the holes you are about to drill in the base (using the TBC holes in the insert plate) do not interfere with any of the features on the router or any webbings in the casting of the router base. A slight turning of the router may be required to miss such obstructions.
- Mark the centre of the holes onto the base.

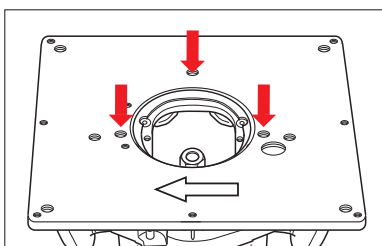

- Remove insert plate and mark the centre of the holes with a centre punch.

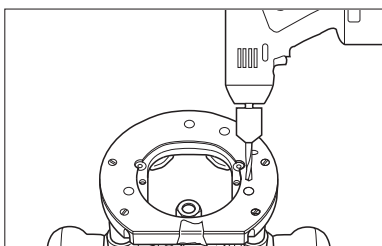

- Drill a hole at these points with a 6mm diameter drill bit.
- Clean up edges of holes if required.

Re-drilling Insert Plate Only

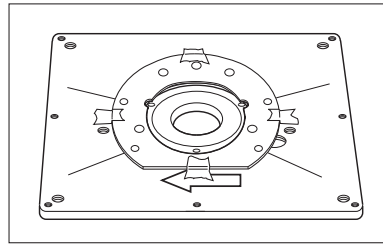

- Remove insert plate from table.
- Remove the plastic base of the router. Alternatively a photocopy or an outline of the base can be made of the plastic base instead.
- Align the centre of the insert plate to the router base and secure them together.
- Using a centre punch, mark the centres of holes.
- Drill the required hole size with a suitable metal cutting drill bit. Best results will be obtained if your power drill is mounted in a drill stand.

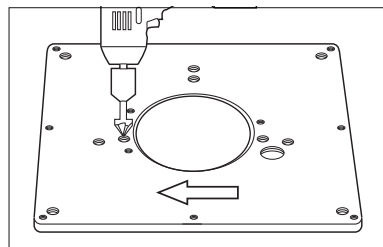

- Countersink the hole with a countersink bit to a depth so the heads of the screws are slightly below the top surface. Clean off any burrs created.

Re-drilling both Insert Plate and Router Base

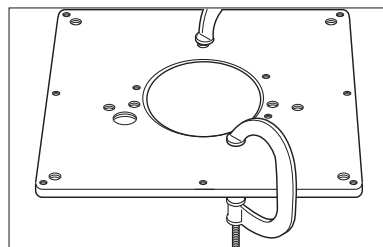

- Invert the router and lay the insert plate onto the upturned base.
- Clamp the insert plate and router base together with two clamps.

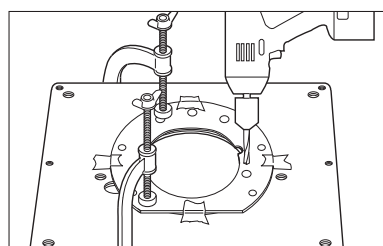

- Ensuring that the drill bit will not foul any webbing or fixtures on the router base, drill with a 6mm diameter metal cutting drill bit into the insert plate and through the router base two holes.

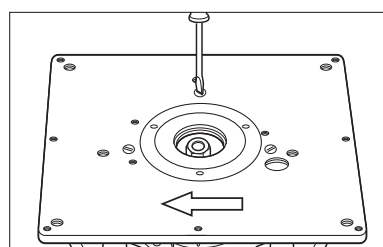

- Unclamp the router base and insert plate.
- Countersink the insert plate holes with a countersink bit to a depth so the screw heads are slightly below the top surface. Clean off any burrs created on both the insert plate and router base.

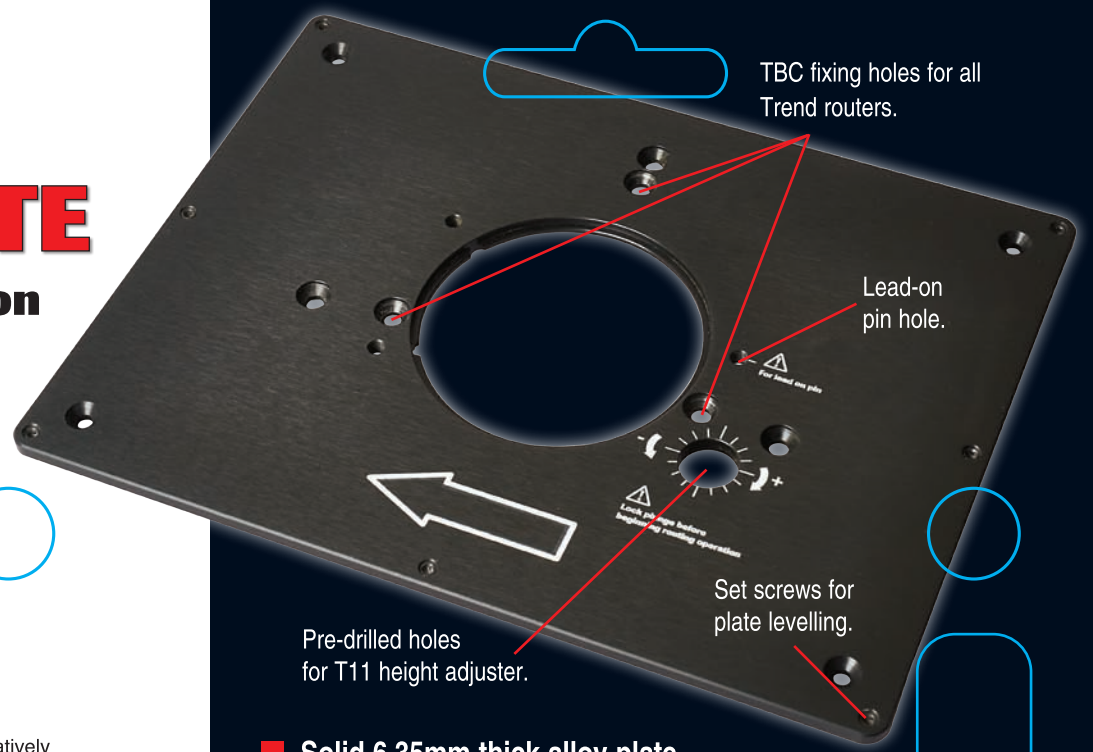

- Solid 6.35mm thick alloy plate.
- Supplied with two insert rings and a lead-on pin.
- Pre-drilled TBC holes for Trend and other popular makes of router.
- Pre-drilled for Trend T11 height adjuster.
- Includes threaded inserts and plate levelling facility.

Specification

Insert plate size	305.8mm x 229mm x 6.35mm
Aperture size required	280mm x 208mm
Aperture rebate size required	6.35mm x 12.7mm
Aperture corner radius	6.35mm
Suggested table thickness	26-35mm
Max. weight of router	8kg
Max. router base dia.	200mm
Router cutter aperture	98mm
Insert ring apertures	67.5mm/31.8mm
Cutter dia. max.	86mm/64mm/28mm

Intended Use

The plate is intended to accept a router. Plate is to be recessed into a user made table top to create a router table. It is to be used with a back fence, safety top guard, safety top & side pressures, a no-volt release switch, pushstick and fine height adjuster.

Safety

User must be competent in using woodworking equipment before using our products. Consider working environment before using tools.

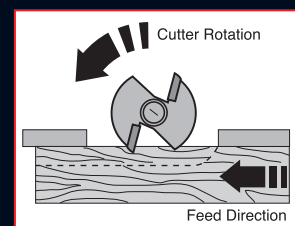

Ensure working position is comfortable and work bench is at a suitable working height. Ensure component is held securely. Please keep children and visitors away from tools and work area. All tools have a residual risk so must therefore be handled with caution. Please read all safety instructions supplied with the router before use. Only use router cutters to EN847-1/2 standard. See separate router table safety instruction leaflet Ref. LEAF/RTS/GB for router table safety rules.

Items Required

Hand tools, clamps, user made table top, 6mm, 7mm and 8mm drill bits, countersink bit, 5mm A/F hex key, router, rebate cutter and router table safety accessories.

Maintenance

Use only Trend original spare parts and accessories. Regularly clean with a soft cloth. No additional lubrication is required. After use keep plate in table top and cover with a dust cover. Product and accessories at the end of life should be sorted for environmentally friendly recycling.

SPARE PARTS:

- Insert 31.8mm to 67.5mm
Ref. WP-CRTMK3/32
- Insert 67.5mm to 98mm
Ref. WP-CRTMK3/33
- Lead-on Pin
Ref. WP-CRTMK3/35

ACCESSORIES:

- Countersink Screw Fixing Pack
Ref. FIX/FIT/2
- Pushstick
Ref. PUSHSTICK/1
- No Volt Release Switch 240v UK
Ref. NVRS/2/240V

Product Ref.
RTI/PLATE/A



5 027654 059616 >



Trend Machinery & Cutting Tools Ltd.
Tel: 0044(0)1923 249911
technical@trendm.co.uk
www.trend-uk.com

© 2018 Trend Machinery & Cutting Tools Ltd
All guards removed for clarity.

PP CRT/PLATE/AV1.0

trend[®]
routing technology