

Please
read carefully
before use

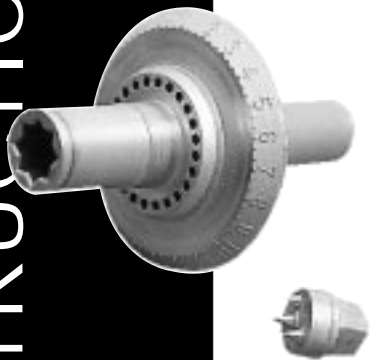

ROUTERLATHE DRIVE CENTRE REF. RL/DC

Thank you for purchasing this Drive Centre which is an accessory to be used with your Routerlathe to enable turning over the full length of the workpiece. It also allows square, round or other shaped workpieces to be mounted quickly and securely.

Parts supplied in Set

1. Drive Centre Holder Ref. WP-RLDC/01 (x1)
2. Drive Centre Ref. WP-RLDC/02 (x1)
3. External Ring Ref. WP-RLDC/03 (x1)

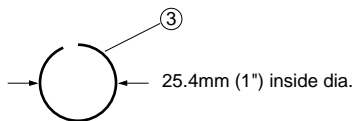
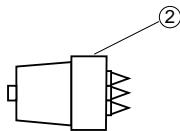
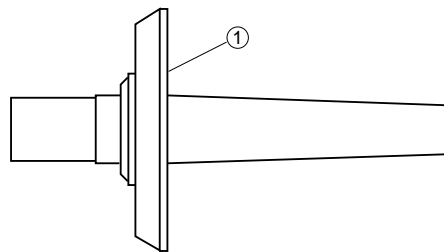

Assembly

1. Using a small screwdriver, remove the External Ring from the existing drive spindle.
2. Slide the drive spindle out of the cable drum.
3. Insert the Drive Centre Holder into the cable drum.
4. Attach the External Ring to the shank of the Drive Centre Holder. Ensure that the ring is seated in the groove of the Drive Centre Holder all the way around.



Please note:

Do not remove the large external ring which holds the cable drum in position.

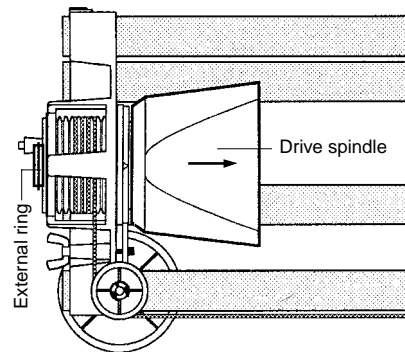

© Trend Machinery & Cutting Tools Ltd 2001 E & OE

Trend Machinery & Cutting Tools Ltd
Odhams Trading Estate St Albans Road
Watford WD24 7TR
Technical Support: 01923 224681
Fax: 01923 236879
Email: mailserver@trendm.co.uk
WWW: www.trendm.co.uk

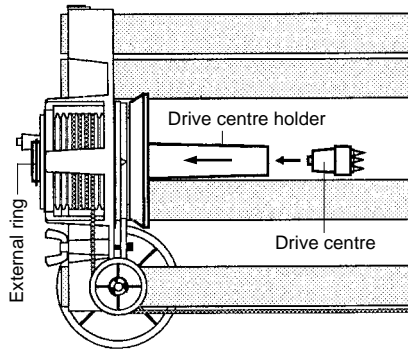

Mounting the work piece in the Routerlathe

1. Locate the centre of the workpiece.

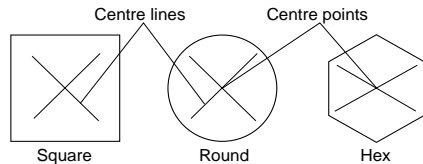

2. Position the Drive Centre onto the workpiece such that the centre pin in the Drive Centre lines up with the centre point on the workpiece.
3. Using a hammer, drive the Drive Centre into the workpiece. The pins should be driven into the wood so that the boss is hard against the workpiece.
4. Remove the Drive Centre from the workpiece.
5. Insert the Drive Centre into the Drive Centre Holder (which has been mounted into the Routerlathe).
6. Position the tail stock (see Routerlathe Manual) for the desired length of the work piece.
7. Mount the workpiece between the tail stock centre screw and the Drive Centre, such that the four holes in the workpiece line up with the Drive Centre pins.
8. The workpiece is now ready to be turned on.

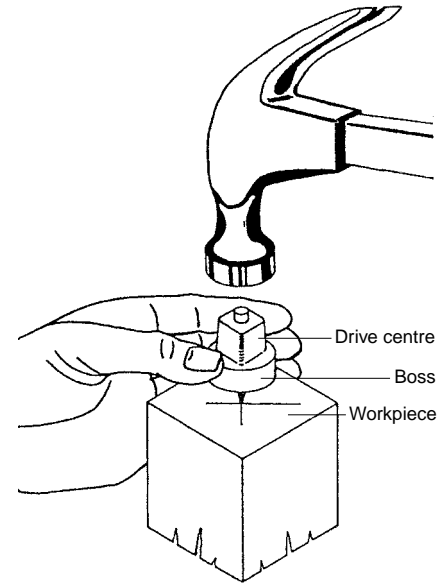

Please note:

The workpiece may be removed and remounted into the Routerlathe a number of times without losing the original centre.

Safety Steps

1. Always wear eye protection such as goggles, ear protection and use effective respiratory protection.
2. Before making adjustments to the router, like changing the cutter, make sure the power is isolated correctly.
3. Before re-connecting to the mains supply, make sure the power switch on the router is in the 'off' position.
4. Do not switch on the router with the cutter in contact with the workpiece.
5. Before making adjustments always allow the cutter to stop rotating.
6. When routing keep your hands, hair and clothing clear of the cutter.
7. Make sure you follow the instructions which came with your router.
8. Ensure all visors, guards and dust extraction are fitted.
9. Trial cuts should be made in waste material before starting any project.

All Trend tooling is guaranteed against any defects in either workmanship or material, except tools that have been damaged due to improper use or maintenance.

Our policy of continuous improvements mean that specifications may change without notice. Trend Machinery & Cutting Tools Ltd cannot be held liable for any material rendered unusable, or for any form of consequential loss.