

Please read carefully before use



NOVA SYSTEM REF. NT, NT/SET

Thank you for purchasing the Nova cutter system, which should perform for years when used in accordance with these instructions.

The Nova System uses two types of tooling body:

Type A - Body with a bearing (Guided Cutter).

Type B - Body without a bearing (Panel Cutter)

These bodies can be fitted with a number of different shaped knives, which allow the cutters to perform a variety of operations.

⚠ Please Note:
Before use of cutter, please ensure it is correctly assembled. Check the locking nut and the screws are fully tightened.

Assembly Instructions Type A (Guided Cutter)

When the cutter is fitted into the router, the machine spindle should be locked.

In the event that the cutter is not fitted to the router, clamp the flat sides of the cutter in a vice with soft jaws to protect the cutter body.

Loosen the nut with the enclosed spanner and remove the nut from the spindle. Then remove the spring washer, ball bearing and the safety cage and the knives out of the cutter body.

Clean the slots of the cutter with a brush.

Choose the appropriate set of knives and insert into the slots that you will find on both sides of the cutter. Ensure that the slots in the knives match the pins that protrude from the slot of the cutter.

Choose the safety cage that matches the knives. On each knife there is a symbol indicating the correct cage.

Slide the safety cage on the cutter body and ensure that the knives slide into the slots that are in the base of the safety cage.

Assemble the spring washer and the lock nut with the enclosed spanner. Ensure that the knives are in place and tighten by applying reasonable pressure.



⚠ Please Note:
Only use knives pre-fixed with letter 'A' in cutter type A.

Parts of tool

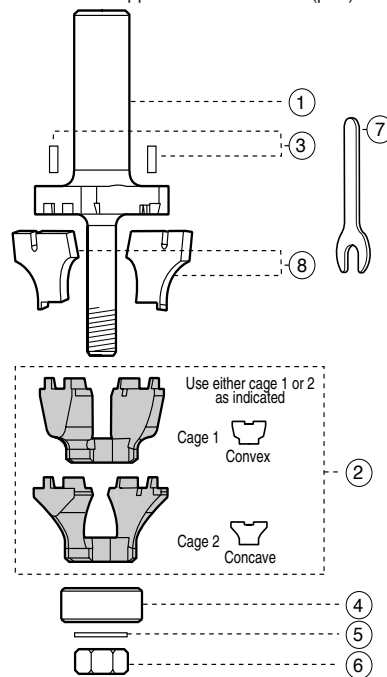
1. Body (x1)
2. Cage (x2)
3. Pins (x2)
4. Ball Bearing Ø 3/4" (x1)
5. Split Washer (x1)
6. Nut (x1)
7. Spanner 11.1mm A/F (x1)
8. Blades - supplied as accessories (pair)



List of Blades NT/A (pair)

Use with cage 1 						
Description	A	R1 mm	R2 mm	C mm	D mm	Order Ref.
Chamfer 30°	-	-	-	10.0	35.0	A01
Chamfer 45°	-	-	-	11.0	38.0	A02
Flat Round Over	-	3.2	-	17.0	35.0	A03
	-	4.8	-	17.0	35.0	A04
Cove	-	6.35	-	17.0	35.0	A11
	-	7.9	-	17.0	35.0	A12
	-	9.5	-	17.0	38.0	A13
Cavetto without quirk	-	4.8	-	17.0	35.0	A14
Ogee	-	4.5	4.0	10.0	36.0	A15
Ogee with quirk	-	4.5	4.0	11.0	38.0	A16
Roman Ogee	-	4.0	4.0	17.0	35.0	A17
Classic	-	4.0	4.0	17.0	35.0	A18
Classic with quirk	-	4.0	4.0	17.0	35.0	A19
Classic Decor	-	4.0	4.0	17.0	38.0	A20
Cavetto	-	4.8	-	17.0	35.0	A21
Bead Ovolo	-	4.0	4.0	17.0	35.0	A22
Bead Ovolo with quirk	-	4.0	4.0	17.0	38.0	A23
Use with cage 2 						
Round Over	-	6.35	-	17.0	35.0	A05
	-	7.9	-	17.0	35.0	A06
	-	9.5	-	17.0	38.0	A07
Ovolo	-	4.8	-	17.0	35.0	A08
	-	6.35	-	17.0	35.0	A09
	-	7.9	-	17.0	38.0	A10

PTO

® All trademarks acknowledged
© Trend Machinery & Cutting Tools Ltd 2001
E & OE

Trend Machinery & Cutting Tools Ltd
Odhams Trading Estate St Albans Road
Watford WD24 7TR
Technical Support: 01923 224681
Fax: 01923 236879
Email: mailserver@trendm.co.uk



RECYCLABLE



5 027654 516249 >

Assembly Type B (Panel Cutter)

When the cutter is fitted into the router, the machine spindle should be locked.

In the event that the cutter is not fitted to the router, clamp the sides of the cutter in a vice with soft jaws to protect the cutter body.

Undo both the grub screws that lock the knives with the aid of the enclosed hex key until you feel the knives being released. Pull the knives out from the side of the cutter.

Clean the slots of the cutter with a brush.

Choose the appropriate knives. First, insert one knife into the side of the cutter, (it is not possible to insert from the bottom of the cutter.) Slide the knife along the slot, until the slot at the head of the knife aligns with the protruding pin in the cutter. Partially lock the grub screw. Insert the second knife as above, fully tightening its grub screw and only then, fully tighten the first grub screw.

Please Note:
Only use knives pre-fixed with letter 'B' in cutter type B.

Parts of tool

1. Body (x1)
2. Pin 3mm x 1mm (x2)
3. Pin 3mm x 6mm (x1)
4. Grub Screw M5 x 10mm (x2)
5. Wedge (x1)
6. Hex key 2.5mm A/F (X1)
7. Blades - supplied as accessories (pair)

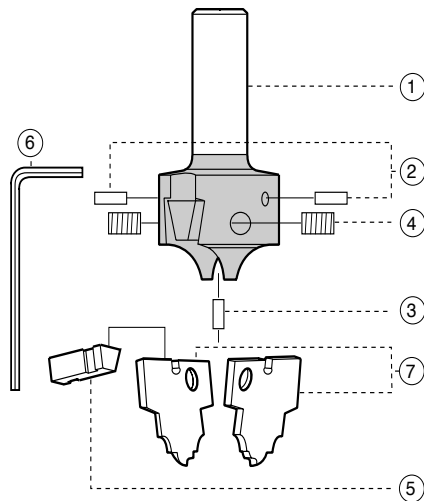

List of Blades NT/B (pair)

Description	A	R1 mm	R2 mm	C mm	D mm	Order Ref.
Chamfer	45°	-	-	7.0	9.5	B51
Bevel	60°	-	-	10.0	12.7	B52
Cove	-	6.35	-	10.0	12.7	B53
Cove	-	12.0	-	25.4	25.4	B54
Classic Decor	-	4.0	4.0	11.0	19.1	B55

Sets

Nova Guided Set - NT/SET/A

Comprising:
Cutter body Ref. NT/A
Pair of blades Ref. A02
Pair of blades Ref. A05
Pair of blades Ref. A11

Available in 1/4", 8mm, 12mm & 1/2" shanks

Nova Panel Set - NT/SET/B

Comprising:
Cutter body Ref. NT/B
Pair of blades Ref. B51
Pair of blades Ref. B54
Pair of blades Ref. B55

Available in 1/4", 8mm, 12mm & 1/2" shanks

Nova Guided/Panel Set - NT/SET/AB

Comprising:
Cutter body Ref. NT/A and NT/B
Pair of blades Ref. B52
Pair of blades Ref. B55
Pair of blades Ref. A02
Pair of blades Ref. A05
Pair of blades Ref. A11

Available in 1/4", 8mm, 12mm & 1/2" shanks

Spare Parts	Order Ref.
NT/A Convex cage (1 off) Concave cage (1 off) Pin 3mm x 8mm (one pair) Washer 1/4 NF (1 off) Nut 1/4 NF (1 off) Ball bearing 3/4 x 1/4 x 9/32 (1 off) Spanner 11.1mm A/F (1 off)	SP-NT/A/1 SP-NT/A/2 SP-NT/A/3 SP-NT/A/4 SP-NT/A/5 SP-NT/A/6 SP-NT/A/7
NT/B Pin 3mm x 10mm (one pair) Pin 3mm x 6mm (1 off) M5 screw pack (pair) with 2.5mm A/F hex key Locking wedge (1 off)	SP-NT/B/1 SP-NT/B/2 SP-NT/B/3 SP-NT/B/4

Safety Steps

1. Always wear eye protection such as goggles, ear protection and use effective respiratory protection.
2. Before making adjustments to the router, like changing the cutter, make sure the power is isolated correctly.
3. Before re-connecting to the mains supply, make sure the power switch on the router is in the 'off' position.
4. Do not switch on the router with the cutter in contact with the workpiece.
5. Before making adjustments always allow the cutter to stop rotating.
6. When routing keep your hands, hair and clothing clear of the cutter.
7. Make sure you follow the instructions which came with your router.
8. Ensure all visors, guards and dust extraction are fitted.
9. Trial cuts should be made in waste material before starting any project.

All Trend tooling is guaranteed against any defects in either workmanship or material, except tools that have been damaged due to improper use or maintenance.

Our policy of continuous improvements mean that specifications may change without notice. Trend Machinery & Cutting Tools Ltd cannot be held liable for any material rendered unusable, or for any form of consequential loss.