



**Adjustable Scoring System  
IT/9561**



Please read carefully before use

**LEADER ADJUSTABLE SCORING SYSTEM**

**REF. IT/95610303 to IT/9561040Z**

Trend takes the guesswork out of adjusting and readjusting scoring sawblades.

The **LEADER** system's patented adjustable scoring blades eliminate the need for spacers, endless measuring, reassembling, testing and adjusting to obtain the required width.

**HOW TO ADJUST THE SCORING WIDTH**

1. Release the locking screw (2) with the supplied Torx® key.
2. Turn the outer ring (1) anti-clockwise to increase the width of the scorer or clockwise to decrease it. Use the appropriate device to lock the saw spindle whilst adjusting the scorer.
3. Use the scorer's gauge to set the required cutting width.
4. Tighten the locking screw (2).
5. From time to time it is recommended that the scorer parts are cleaned with an air line.
6. Two washer rings (3) are available (Order Ref. IT/1963523 for 20mm spindles and Order Ref. IT/1963524 for 22mm spindles) for instances where the saw flange is too large to fit inside the **LEADER** scorer. The flange is left off and the spindle nut is tightened against the appropriate

washer ring.

7. Fitting rings are also available to adapt the **LEADER** scorer to smaller saw spindles. (For example – 15mm bore adapter for Altendorf machines. Order Ref. IT/19257001.)

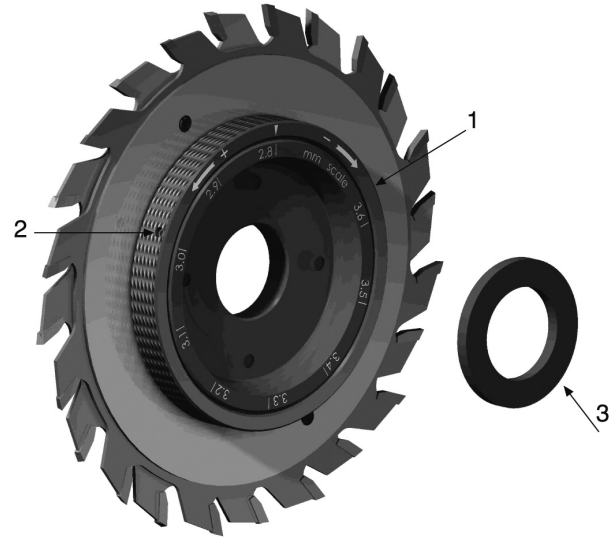

**ENVIRONMENTAL PROTECTION**   
Recycle raw materials instead of disposing  
as waste.

Packaging should be sorted for  
environmental-friendly recycling.  
The product and its accessories at the end of  
its life should be sorted for environmental-  
friendly recycling.

### GUARANTEE

All Trend products are guaranteed against any  
defects in either workmanship or material,  
except products that have been damaged due  
to improper use or maintenance.

© Trend Machinery & Cutting Tools Ltd. 2007 E&OE  
® All trademarks acknowledged

### Trend Machinery & Cutting Tools Ltd.

Odhams Trading Estate St. Albans Road  
Watford WD24 7TR England

Enquiries: \_\_\_\_\_ 0800 487363

Technical Support: \_0044 (0) 1923 224681

Fax: \_\_\_\_\_ 0044 (0) 1923 236879

Email: \_\_\_\_\_ enquiry@trendm.co.uk

Web: \_\_\_\_\_ www.trendmachinery.co.uk



RS 28982  
Stockholding  
& Supply



RECYCLABLE

### DISASSEMBLING AND ASSEMBLING INSTRUCTIONS FOR RE-SHARPENING

1. Disassembling and assembling should be  
done when the outer ring is fully opened to  
the maximum width of 3.6mm.
2. Hold the upper sawblade (4) to prevent the  
spring ring (3) from jumping out.
3. Release the four hex screws (6).
4. Disassemble all the parts.
5. To assemble the tool, follow the order  
shown in the drawing.
6. Make sure that the locating pins (5) fit into  
the holes in the lower blade (2).
7. Check that the spring ring (3) is fitted into  
its' slot correctly and then tighten the four  
hex screws (6).

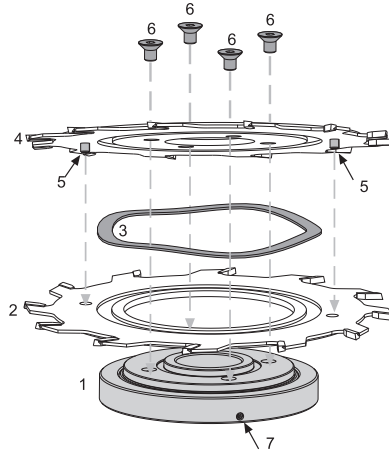

### PARTS SUPPLIED

1. Base
2. Lower sawblade
3. Spring ring
4. Upper sawblade
5. Locating pins
6. Hex screws
7. Locking screw

### INSTRUCTIONS FOR RE-SHARPENING

1. By using the necessary grinding  
attachment (Order Ref. IT/5510701) it is  
possible to grind both parts of the scorer  
together.
2. Follow the instructions for disassembling  
the scorer shown on the right.
3. Place the left (2) and right (3) sawblade  
together, making sure the locating pins fit  
into the holes in the opposite blade.
4. Screw the grinding fixture (1) to the two  
sawblades with the supplied hex screws  
(4). Ensure that the screws are placed  
into the holes as shown in the drawing.

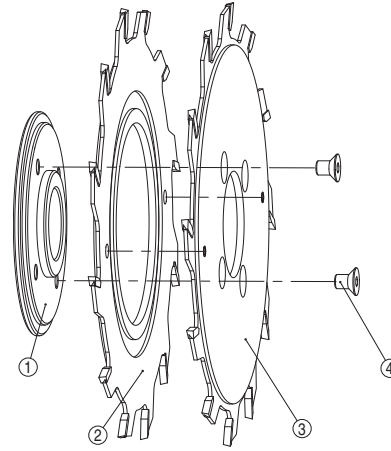

Our policy of continuous improvements mean that  
specifications may change without notice. Trend  
Machinery & Cutting Tools Ltd. cannot be held liable for  
any material rendered unusable, or for any form of  
consequential loss.