

# EURO CYLINDER BARREL JIG

**For use with a plunge router to rout out Euro cylinder lock barrel.**

- To suit Euro lock cylinder barrel size 33mm x 17mm/10mm with 1mm clearance all round.
- Handle pitch to lock body adjustment from 45mm to 115mm.
- 44mm and 57mm backset.
- Allows 16mm diameter hole for handle spindle to be routed.
- Reversible edge guides.
- Accessory templates available for small and large oval cylinders.

## Requires:

- Plunge router.
- 12mm Straight cutter Ref. C172 or C019A.
- 20mm Guide bush\* Ref. GB20.
- 2.75mm Drill bit guide Ref. SNAP/DBG/7.

Size: 490mm x 101mm x 12mm

\*A Unibase may be required for certain makes and models of router.

**trend**<sup>®</sup>  
*routing technology*

**FOR GUIDING  
THE ROUTER**

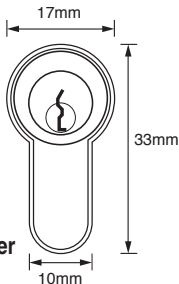
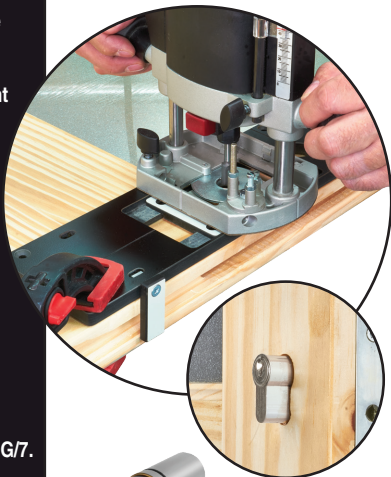

For Euro cylinder  
barrel only.

## **EURO CYLINDER LOCK JIG REF. ECL/JIG**

Thank you for purchasing this Trend product which should give lasting performance if used in accordance with these instructions.

The following symbols are used throughout these instructions.



Denotes risk of personal injury, loss of life or damage to the tool in case of non-observance of the instructions.



Refer to the instruction manual of your power tool.

This unit must not be put into service until it has been established that the power tool to be connected to this unit is in compliance with 2006/42/EC (identified by the CE marking on the power tool).

### **INTENDED USE**

This jig is intended for use with a plunge router with a suitable guide bush and router cutter fitted to rout the spindle hole and aperture for Euro cylinder lock barrel on doors that will have a suitable lock fitted. The jig has edge swivel stop plates allowing for use on doors with a leading edge. The aperture will give 1mm clearance all around barrel. A Trend Snappy self-centring drill bit guide can also be used to mark the handle lock plate bolt positions.



**The jig will not rout out the mortise/faceplate for the Euro lock casing, this has to be done separately.**

### **SAFETY**

Please read and understand these safety instructions, as well as the power tool instructions, before use.

#### **PLEASE KEEP THESE INSTRUCTIONS IN A SAFE PLACE.**

The attention of UK users is drawn to The Provision and Use of Work Equipment Regulations 1998, and any subsequent amendments.

Users should also read the HSE/HSC Safe Use of Woodworking Machinery Approved Code of practice and Guidance Document and any amendments.

Users must be competent in using woodworking equipment before using our products.

Consider working environment before using tools.

Ensure working position is comfortable and component is clamped securely.

Please keep children and visitors away from tools and work area. All power tools will have a residual risk, so must be operated with caution.

Only use tooling that meets EN847-1/2 safety standard and any amendments.

### **ITEMS REQUIRED**

- Plunge router with suitable size collet fitted.
- 20mm diameter guide bush.
- 12mm diameter router cutter.
- Door clamping device.
- Hand tools.
- No.2 Pozzi® screwdriver.
- Clamps x 2.
- 2.75mm diameter drill bit guide.
- Dowel drill bits.

## ITEMS ENCLOSED & DESCRIPTION OF PARTS

- A. Top plate **x1**
- B. Euro cylinder lock barrel template **x1**
- C. Template fixing machine screw **x2**
- D. Edge swivel stop plate **x2**
- E. Edge stop square nut **x2**
- F. Edge stop machine screw **x2**
- G. Handle spindle hole
- H. Handle lock plate hole
- I. Centre line
- J. Scale
- K. Spacer set **x1**

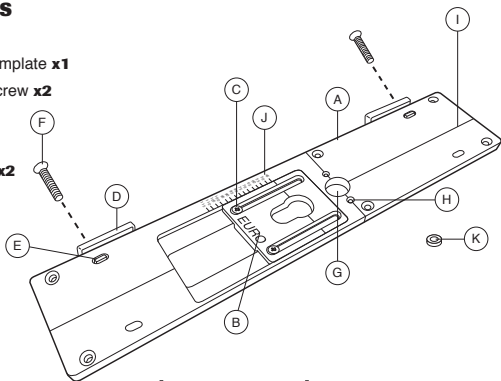

## ASSEMBLY

### Backset

This jig comes set for a 57mm backset from door edge to the spindle centre. The edge stops can be removed and fitted to the opposite edge of jig for a 44mm offset. To do this, undo the two edge stop screws, remove the edge stops plates and square nuts, refit to opposite edge of jig.

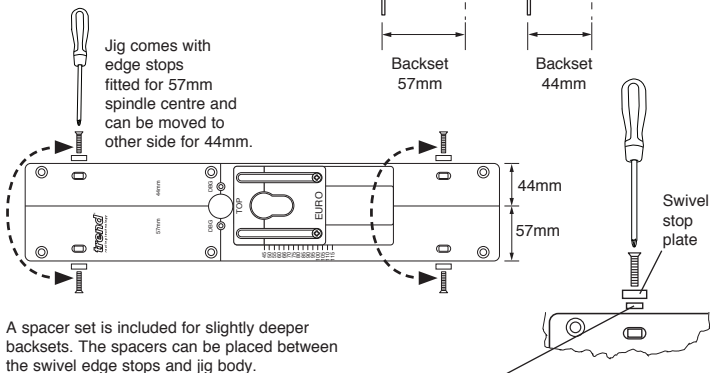
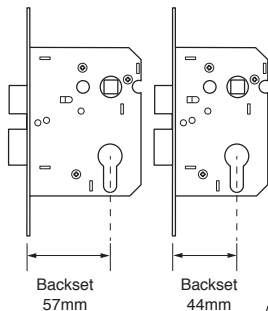

A spacer set is included for slightly deeper backsets. The spacers can be placed between the swivel edge stops and jig body.

Add spacers to both machine screws for deeper backsets.

## Setting & Fixing Template Height

Loosely screw the template to the jig, ensuring the top mark is positioned upright.

- For Euro cylinder locks, measure the distance between centre of spindle and centre of lock barrel and using the scale on the jig set the position of the lock barrel template.
- Screw down in place with a No. 2 Pozzi® screwdriver. Do not over-tighten screws.
- For the accessory templates for large and small barrels, set position by laying the lock over the jig, adjust the plate so that the lock spindle and barrel apertures are concentric around the apertures of the jig's handle hole and template aperture.
- Once position is established, screw lock barrel template in place, ensuring that the position of the template remains correct.
- Once the lock barrel template has been screwed in place, check again that the position is correct by laying the lock over the jig.
- Adjust and re-fix as required.

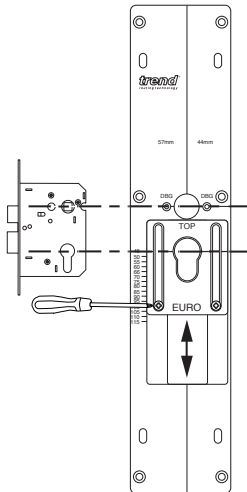

## Door Routing Positions

It is advisable to rout door removed from door frame.

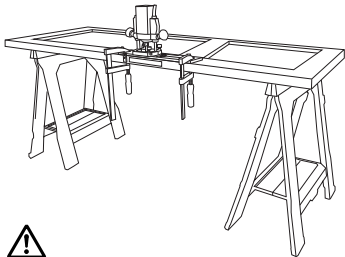

If using the jig whilst the door is hung, only a light weight router should be used. Door must be prevented from moving with wedge or similar device.

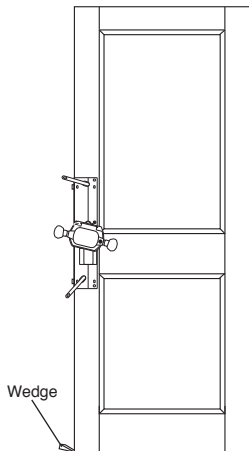

## OPERATION



It is advisable to rout the spindle and cylinder holes on both sides of the door (cutting to half the thickness of the door) to avoid breaking out the bottom face of the door.

### Positioning the Jig

- Mark spindle height on edge and both sides of door with a pencil.
- For doors with chipboard core, the mortise for the lock casing can be cut out before the spindle and barrel apertures are routed.
- For solid natural doors, rout spindle and cylinder holes before cutting out lock casing recess to avoid risk of breaking out inside of the mortise.
- Position jig on door.
- Secure jig in place with two clamps ensuring they do not foul the router path, carefully lining spindle line on jig with spindle height line on door.

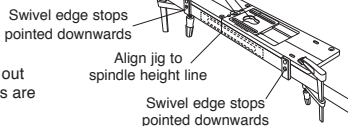

Ensure clamps do not foul router path. Ensure working position is comfortable. Keep proper footing and balance at all times. Ensure jig is clamped securely to door and placed at a comfortable working height.

### Routing the Apertures From One Side Only



- Fit 20mm diameter guide bush to the router.
- Fit a suitable 12mm diameter router cutter.
- When routing from one side only, there may be possible damage to door underside due to breakout. It is therefore advisable to use a sacrificial board clamped to underside of door.
- Ensure guide bush is inserted in aperture to be routed. Take light passes in clockwise direction until full depth is reached.
- Repeat for spindle hole.
- Before removing jig from door, mark handle lock plate bolt positions.



Ensure sacrificial board is fitted.

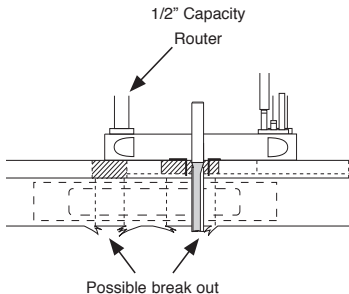

## Routing the Apertures on Both Sides of Door



### Side 1

- Take light passes in clockwise direction to half depth of door thickness.
- Repeat for hand spindle hole.
- Before removing jig from door, mark handle lock plate bolt positions.

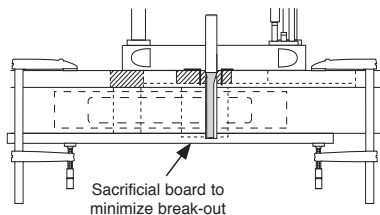

### Side 2



- Turn jig over and position on other side of door. Rotate edge guides 180 degrees.
- Re-clamp jig ensuring the jig is positioned accurately to the spindle height line.
- Take light passes in clockwise direction.
- Repeat for handle spindle hole.
- Before removing jig from door, mark handle lock plate bolt positions.

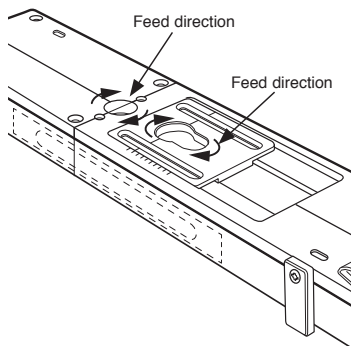

## Marking Handle Lock Plate with 40mm Centres



- Use a 2.75mm diameter drill-bit guide to mark the handle lock plate bolt positions.
- Drill down approximately 2mm deep.
- Remove jig from door.
- Drill halfway through door with a suitable diameter dowel drill. Repeat on other side of door.

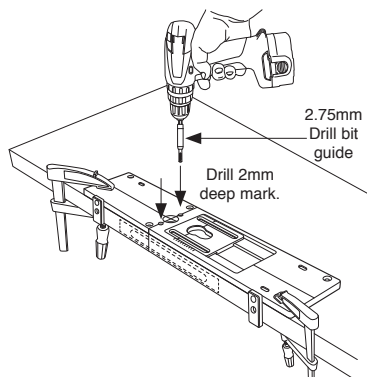

After use, store jig carefully.

## SPARE PARTS

Please use only Trend original spare parts.

Item	Qty.	Desc.	Ref. (1 off)
A	1	Top Plate	WP-ECL/01
B	1	Euro Barrel Template	WP-ECL/02
C	2	Template Fixing Screw Csk M5 x 8mm Pozi®	WP-SCW/121
D	2	Edge Stop Plate	WP-ECL/04
E	2	Square Nut M5	WP-NUT/07
F	2	Edge Stop Screw Csk M5 x 25mm Pozi®	WP-SCW/117
K	1	Spacer Set	WP-ECL/05



If escutcheon/handle size will allow, then an 18mm guide bush (Ref.GB18) can be used to create a larger cylinder aperture.

## ACCESSORIES

Please use only Trend original accessories.

### Ref. ECL/T/OCL

Large Oval Template  
to suit cylinder size  
31.5mm x 17.5mm

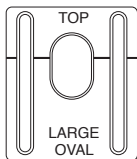

### Ref. ECL/T/OCS

Small Oval Template  
to suit cylinder size  
27.8mm x 13mm

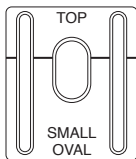

### Ref. 3/8LX1/4TC

#### C019AX1/4TC

12mmØ Router Cutter

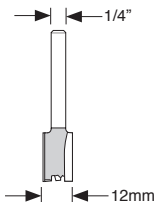

### Ref. 3/75X1/2TC

#### C172X1/2TC

12mmØ Router Cutter

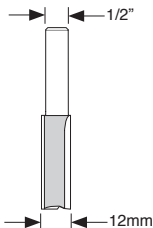

### Ref. GB20

Guide Bush



### Ref. SNAP/DBG/7

2.75mm Drill Bit Guide



### Ref. UNIBASE

For certain makes of router, a sub-base will be required to allow the guide bush to be fitted.

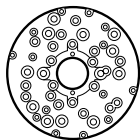

### Ref. FC/200

F Clamp

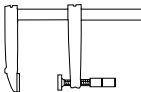

### Ref. D/STAND/A

Door Stand

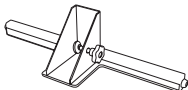

### Ref. ECL/SPAC/1

Pack of spacers for 44.5mm, 45mm, 47mm, 48mm, 55mm and 60mm backset

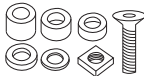

## MAINTENANCE



Please use only Trend original spare parts and accessories.

This accessory has been designed to operate over a long period of time, with the minimum amount of maintenance. Continual satisfactory operation depends upon proper tool care and regular cleaning.

### Cleaning

- Regularly clean jig with a soft cloth.
- Do not use a corrosive cleaning solutions.

### Lubrication

- Your accessory requires no additional lubrication.

### Storage

- Always return product to its packaging after use, or hang on a wall hook

## ENVIRONMENTAL PROTECTION



Recycle raw materials instead of disposing as waste.

Packaging should be sorted for environmental-friendly recycling. The product and its accessories at the end of its life should be sorted for environmental-friendly recycling.

## GUARANTEE

All Trend products are guaranteed against any defects in either workmanship or material, except products that have been damaged due to improper use or maintenance.

### Trend Machinery & Cutting Tools Ltd.

Odhams Trading Estate St Albans Road  
Watford WD24 7TR England

Tel: 0044(0)1923 249911

technical@trendm.co.uk

www.trend-uk.com



## Safety Points

1. Disconnect power tool and attachment from power supply when not in use, before servicing, when making adjustments and when changing accessories such as cutters. Ensure switch is in "off" position. Always ensure cutter has stopped rotating.
2. Read and understand instructions supplied with power tool, attachment and cutter.
3. Current Personal Protective Equipment (PPE) for eye, ear and respiratory protection must be worn. Keep hands, hair and clothes clear of the cutter.
4. Before each use check cutter is sharp and free from damage. Do not use if cutter is dull, broken or cracked or if any damage is noticeable or suspected.
5. The maximum speed (nmax) marked on tool or in instructions or on packaging shall not be exceeded. Where stated, the speed range should be adhered to.
6. Insert the shank into the router collet at least all the way to the marked line indicated on the shank. This ensures at least 3/4 of shank length is held in collet. Ensure clamping surfaces are clean.
7. Check all fixing and fastening nuts, bolts and screws on power tool, attachment and cutting tools are correctly assembled, tight and to correct torque setting before use.
8. Ensure all visors, guards and dust extraction is fitted.
9. The direction of routing must always be opposite to the cutter's direction of rotation.
10. Do not switch power tool on with the cutter touching the workpiece.
11. Trial cuts should be made in waste material before starting any project.
12. Repair of tools is only allowed according to tool manufacturers instructions.
13. Do not take deep cuts in one pass, take several shallow passes to reduce the side load applied to the cutter.

Please see [www.trend-uk.com/safety](http://www.trend-uk.com/safety) for more safety advice.



Our policy of continuous improvements mean that specifications may change without notice. Trend Machinery & Cutting Tools Ltd. cannot be held liable for any material rendered unusable, or for any form of consequential loss.

© Copyright Trend 2018. E&OE.

® All trademarks acknowledged.



RECYCLABLE