



Door Stand D/STAND/A



trend[®]
routing technology

INST/DS/A v1.0

Please
read carefully
before use

DOOR STAND REF. D/STAND/A

Thank you for purchasing this Trend product, which should give lasting performance if used in accordance with these instructions.

The following symbols are used throughout these instructions.



Denotes risk of personal injury, loss of life or damage to the tool in case of non-observance of the instructions.



Refer to the instruction manual of your power tool.

INTENDED USE

This accessory is intended to be used to hold a door on its edge, so that tools can be used to plane, hinge recess and cut the mortise in the door. The accessory will also allow the door to be tilted back to aid fitting the door into the frame, as well as keeping door stable while fitting door furniture.

- Maximum door thickness 32mm to 55mm (thinner doors require packing piece).
- Maximum door size 1981mm x 838mm.
- Maximum door weight 50kg.

SAFETY

Please read and understand the safety points at the end of these instructions as well as your power tool instructions before use.

ITEMS REQUIRED

- None required to use the stand.
- Tools required for working on the door.

DESCRIPTION OF PARTS

- A. Body
- B. Soft pad
- C. Clamping knob
- D. Plastic cap for clamping knob
- E. End pad
- G. Hanging holes
- F. Stabilisers
- H. Instructions

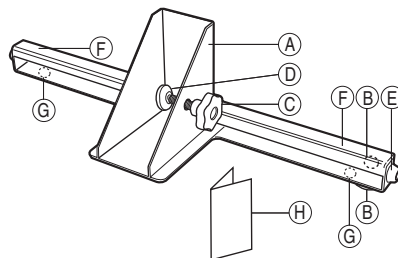

OPERATION



For Planing Door, Hinge Recessing and Lock Mortising

- Place door stand on the floor. Unwind the clamping knob.
- Lay the door on its edge to suit door hanging application (planing, door hinge recessing or mortising).
- Place the door edge into the door stand and tighten the clamping knob by hand. Do not over tighten.
- Door is now held.
- Carry out door application
- To remove the door, hold the door securely and loosen the clamping knob on the door stand. Lift the door slightly and slide door stand away.

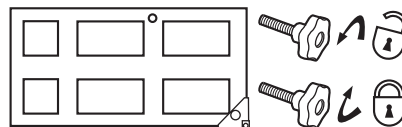

Regularly check that the door stand clamping knob is tight.
Do not overtighten.

For Supporting Door While Hanging in Frame



- After hinge recessing on door edge and fitting hinges, ensure door stand clamping knob is tight.
- Carefully lift top edge of door and tilt back the door using the door stand as a pivot.

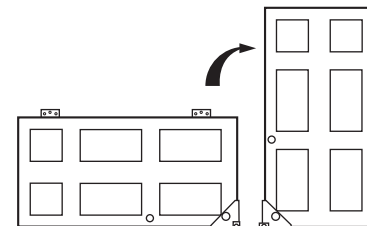

- Position the door into the frame or lining. Simultaneously push the bottom of the door in and pull top of the door out until top hinge lines up with its recess. Locate and secure with screws.



Hollow doors may require a load spread plate made of MDF placed between the plastic cap and the door to prevent door damage.

PTO

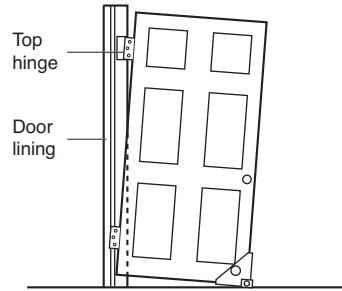

Door tilt shown exaggerated.

- Move bottom of the door out, the door will swing slightly then fit bottom hinge.
- Remove the door stand by loosening the clamping knob.
- Fit the remaining screws into the hinges.



When door is held in door clamp in vertical mode ensure door is always held by operator's hands. Do not leave door in the stand unattended.

For Fitting Door Furniture

- If there is a sufficient gap between the bottom of the door and the floor, the door stand can also be put on a hung door to clamp the door while drilling a keyhole or for fitting door furniture, such as handles.
- Open the door, place the door stand at the bottom of door. Loosely tighten clamping knob and then open the door fully so that the stabiliser arms with end pads are touching the skirting board. Tighten the clamping knob. The door is now secure to allow drilling of a keyhole, fitting handles etc. Alternatively place your foot on one of the stabilisers.

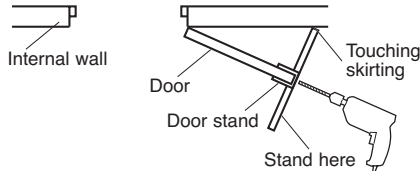

- Once operation is complete, release the clamping knob and remove the door stand.

SPARE PARTS

Only use original Trend spare parts.

No.	Desc.	Ref. (1 off)
C	Knob M10 x 40mm Ball End	WP-LOCK/06A
D	Plastic Cap For Ball End Stud	WP-LOCK/08A
H	Instructions	INST/DS/A

MAINTENANCE

The accessory has been designed to operate over a long period of time with minimum of maintenance. Continual satisfactory operation depends upon proper tool care and regular cleaning.

Cleaning

- Keep the threads clear of resin build up.
- Regularly clean with a soft cloth.

Lubrication

- Your accessory requires no additional lubrication.

Storage

- Return jig to the carton after use.

ENVIRONMENTAL PROTECTION

Recycle raw materials instead of disposing as waste.

Packaging should be sorted for environmental-friendly recycling. The product and its accessories at the end of its life should be sorted for environmental-friendly recycling.

GUARANTEE

All Trend products are guaranteed against any defects in either workmanship or material, except products that have been damaged due to improper use or maintenance.

Safety Points

1. Disconnect power tool and attachment from power supply when not in use, before servicing, when making adjustments and when changing accessories such as cutters. Ensure switch is in "off" position and cutter has stopped rotating.
2. Read and understand instructions supplied with power tool, attachment and cutter.
3. Current Personal Protective Equipment (PPE) for eye, ear and respiratory protection must be worn. Keep hands, hair and clothes clear of the cutter.
4. Before each use check cutter is sharp and free from damage. Do not use if cutter is dull, broken or cracked or if any damage is noticeable or suspected.
5. The maximum speed (rmax) marked on tool or in instructions or on packaging shall not be exceeded. Where stated, the speed range should be adhered to.
6. Insert the shank into the router collet at least all the way to the marked line indicated on the shank. This ensures at least 3/4 of shank length is held in collet. Ensure clamping surfaces are clean.
7. Check all fixing and fastening nuts, bolts and screws on power tool, attachment and cutting tools are correctly assembled, tight and to correct torque setting before use.
8. Ensure all visors, guards and dust extraction is fitted.
9. The direction of routing must always be opposite to the cutter's direction of rotation.
10. Do not switch power tool on with the cutter touching the workpiece.
11. Trial cuts should be made in waste material before starting any project.
12. Repair of tools is only allowed according to tool manufacturers instructions.

Please see www.trend-uk.com for more safety advice.

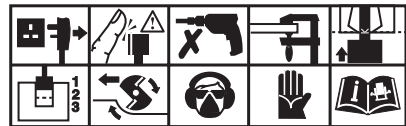

Our policy of continuous improvements mean that specifications may change without notice. Trend Machinery & Cutting Tools Ltd. cannot be held liable for any material rendered unusable, or for any form of consequential loss.

© Trend Machinery & Cutting Tools Ltd. 2006 E&OE
© All trademarks acknowledged

Trend Machinery & Cutting Tools Ltd.
Odhams Trading Estate St. Albans Road
Watford WD24 7TR England
Enquiries: 0800 487363
Technical Support: 0044 (0) 1923 224681
Fax: 0044 (0) 1923 236879
Email: enquiry@trendm.co.uk
Web: www.trend-uk.com



RS 28982
Stockholding
& Supply



RECYCLABLE

