

Adaptor for
Dovetail Jig
DJ/PLATE

INSTRUCTIONS

Phase 20
read carefully
before use

ADAPTOR PLATE
FOR DOVETAIL JIG
REF. DJ/PLATE

Thank you for purchasing this Trend Dovetail Jig Adaptor Plate.

These instructions are for fitting the DJ/PLATE and Dovetail Cutter, when using a Dovetail Jig.

1. The plate is pre-drilled to suit certain routers. The plate will need to be re-drilled and counterbored to suit other machines. Use the removeable base plate from the router to mark out the plate. Drill and counterbore to suit. Make the holes over size to allow for adjustment.
2. Fit the dovetail jig guide bush into the recess of the adaptor plate and securely fix the guide bush to the plate using the two 2BA x 5/16" countersunk screws.
3. Unplug the router from the power source. Hold the router held inverted and place the adaptor plate on the router base and align the standard or user drilled counterbored holes with the relevant fixings on the router base. Hand tighten the suitable fixing machine screws while still allowing adjustment of the adaptor plate.
4. Depress the router until the collet rests on the rear of the guide bush and lock the router in position.

5. Slide the cutter through the guide bush and into the collet of the router to a reasonable working depth.
6. By eye, centralise the guide bush and adaptor plate to the shank of the cutter. When correct tighten the fixing machine screws to securely fix the adaptor plate to the router.
7. Slide the cutter shank further into the collet to a depth of approximately 25mm.
8. Tighten the collet nut with the collet nut spanner.
9. With the cutter tightened, set the projection of the cutter as specified by the Dovetail Jig Manual and adjust up or down approximately 0.5mm to give a looser or tighter fit as required.

Please note:
⚠ To allow greater accuracy when setting the guide bush to the cutter, it is advisable to use a line-up pin (Ref. GB/3) and 10mm OD guide bush (Ref. GB/10), which are available as accessories.

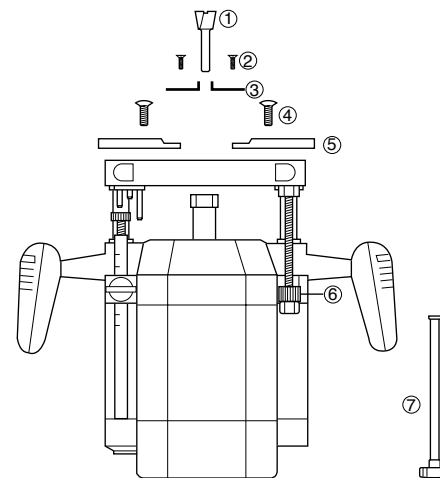

1. Dovetail Cutter
2. Machine Screw 2BA x 5/16" csk (x2)
3. Guide Bush
4. Machine Screw Pan (various sizes)
5. Adaptor Plate
6. Knurled Ring
7. } or { Fine Height Adjuster (if available)

© All trademarks acknowledged

© Trend Machinery & Cutting Tools Ltd 2000 E & OE

Trend Machinery & Cutting Tools Ltd

Unit 6 Odhams Trading Estate
Watford WD2 5TR

Technical Support: 01923 224681

Fax: 01923 236879

Email: mailserver@trendm.co.uk

WWW: www.trendm.co.uk



RS 28982
Stockholding
& Supply



RECYCLABLE



5 027654 319055 >

Safety Steps

1. Always wear eye protection such as goggles, ear protection and use effective respiratory protection.
2. Before making adjustments to the router, like changing the cutter, make sure the power is isolated correctly.
3. Before re-connecting to the mains supply, make sure the power switch on the router is in the 'off' position.
4. Do not switch on the router with the cutter in contact with the workpiece.
5. Before making adjustments always allow the cutter to stop rotating.
6. When routing keep your hands, hair and clothing clear of the cutter.
7. Make sure you follow the instructions which came with your router.
8. Ensure all visors, guards and dust extraction are fitted.

All Trend tooling is guaranteed against any defects in either workmanship or material, except tools that have been damaged due to improper use or maintenance.

Our policy of continuous improvements mean that specifications may change without notice. Trend Machinery & Cutting Tools Ltd cannot be held liable for any material rendered unusable, or for any form of consequential loss.