

Craft Range Profile
Scriber C149,
C156 & C157

INSTRUCTIONS

Please
read carefully
before use

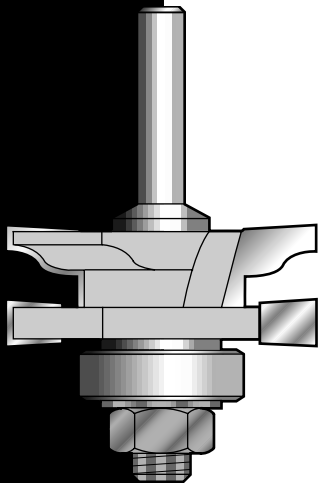

**CRAFT RANGE
PROFILE SCRIBER
REF. C149, C156 & C157**



Thank you for purchasing this Trend router cutter, which should give lasting performance if used in accordance with these instructions.

Profile Scriber sets should be used in a fixed position, either in an overhead or table routing machine, or in a portable router mounted in a fixed mode. The router should have a minimum power rating of 750 watts.

Material thickness should be between 18mm and 22mm, with 20mm thickness preferable. Material should be squared all round to ensure perfect joints are achieved. Always unplug the router from the power supply before making any adjustments and ensure that the cutter is guarded so that operator's fingers cannot contact the cutter. This cutter is fitted with a small diameter shank, so extra care should be taken to avoid over-loading the cutter and causing shank deflection.

When using this set, shallow passes must be taken at all times. This can be achieved by adjusting the back fence. The final cut using the ball bearing as a guide.

The set is supplied with spare shims for use after resharpening or if especially tight or loose joints are required.

-  Shim 0.05mm
-  Shim 0.1mm

Parts of a Panelled Door

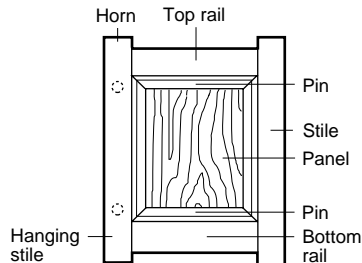
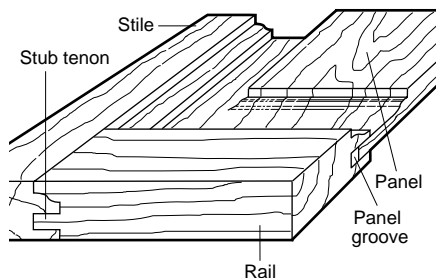

The Joint

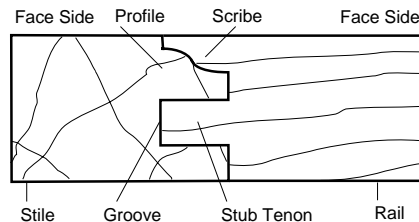

Parts supplied in set

1. Arbor (x1)
2. Nut 12mm A/F (x1)
3. Profile Block (x1)
4. Groover 6.35mm Kerf (x1)
5. Bearing 22mm Diameter (x1)
6. Washer 1.6mm Thick (x1)
7. Shim 0.1mm Thick (x3)
8. Shim 0.05mm Thick (x3)

The set is supplied in profiling mode and must be re-assembled into scribing mode for the first routing operation.

The joint will be fairly loose to allow for glue, so changes in tightness can be achieved by adding or removing shims 7 & 8. This is most important after resharpening.

Cutters are rearranged on the arbor to either cut the profile or the scribe.

The ball bearing will automatically give the correct final depth of cut.

When re-assembling follow the sequence of the two diagrams shown on these instructions.

Spare Parts	Order Ref.
Profile Block for C149	SP-C149A
Profile Block for C156	SP-C156A
Profile Block for C157	SP-C157A
Groover for C149, C156 & C157	SP-C149C
Bearing 22mm Ø	BB22
Replacement Arbor 1/4" Shank	33/30X1/4"
Replacement Arbor 8mm Shank	33/30X8mm
Alternative Arbor 12mm Shank	33/30X12mm
Alternative Arbor 1/2" Shank	33/30X1/2"
Replacement Arbor Nut	ANUT/33/30
Spacer Set	SPACER/8

Scribe Set-up

Assemble cutter as below. Parts 3 & 4 should be assembled 90° to each other to help reduce the cutting impact. This set-up is used for cutting the scribe across the ends of the rails.

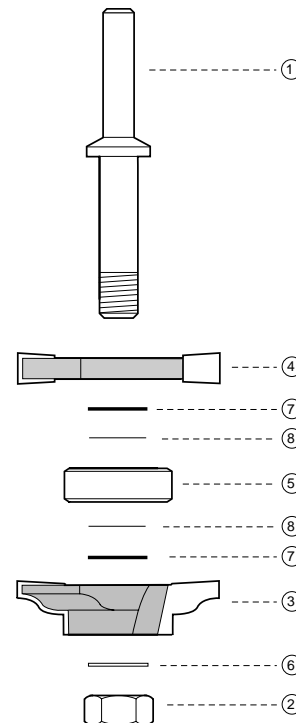

To produce the Frame

Cut stiles to size leaving (25mm) extra length. These 'horns' will give the door protection while glueing and finishing applications. They will be trimmed to size once the door is complete.

Cut rails squarely to length, allowing an extra 9.5mm (3/8") on each end for the scribe.

Set the profile scriber cutter into scribing mode as shown below. The height of the cutter should be adjusted according to the thickness of the timber. The router table's mitre fence should be set to 90° or a rail holder should be used to ensure the end of the rail is scribed at 90°. Use a waste piece of timber behind the rail to prevent breakout. Set the back fence level with the bearing guide. Switch on and cut the scribes at each end of the rail.

Cutting the scribe

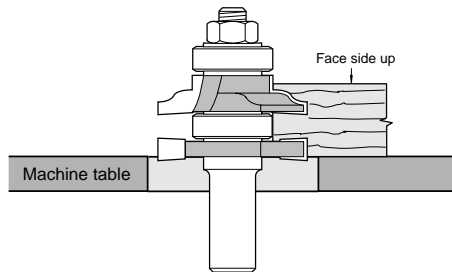

Profile Set-up

This assembly is for the cutting of the profile along the rails and stiles. Parts 3 and 4 should be assembled 90° to each other.

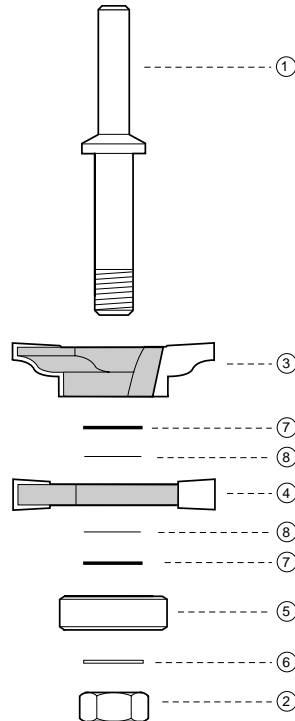

The timber should be inverted first. Switch off the power to the router at the source. Leaving the cutter in the machine, rearrange the components of the cutter into the profiling mode as shown on the left. The height of the cutter should be adjusted according to the scribe. Invert timber and rout mould.

Cutting the profile

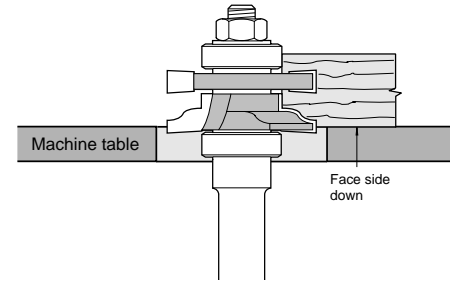

⚠ Please note:
Before using cutter, please ensure it is correctly assembled and the locking nut is fully tightened.

Safety Steps

1. Always wear eye protection such as goggles, ear protection and use effective respiratory protection.
2. Before making adjustments to the router, like changing the cutter, make sure the power is isolated correctly.
3. Before re-connecting to the mains supply, make sure the power switch on the router is in the 'off' position.
4. Do not switch on the router with the cutter in contact with the workpiece.
5. Before making adjustments always allow the cutter to stop rotating.
6. When routing keep your hands, hair and clothing clear of the cutter.
7. Make sure you follow the instructions which came with your router.
8. Ensure all visors, guards and dust extraction are fitted.
9. Trial cuts should be made in waste material before starting any project.

All Trend tooling is guaranteed against any defects in either workmanship or material, except tools that have been damaged due to improper use or maintenance.

Our policy of continuous improvements mean that specifications may change without notice. Trend Machinery & Cutting Tools Ltd cannot be held liable for any material rendered unusable, or for any form of consequential loss.

© Trend Machinery & Cutting Tools Ltd 2001 E & OE

Trend Machinery & Cutting Tools Ltd
Odhams Trading Estate St Albans Road
Watford WD24 7TR
Technical Support: 01923 224681
Fax: 01923 236879
Email: mailserver@trendm.co.uk
WWW: www.trendm.co.uk

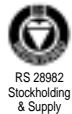

RS 28982
Stockholding
& Supply



RECYCLABLE

