

# INPROFILE

THE NEWS LETTER FOR ALL TREND USERS

**Routing Advice  
for those Getting  
Started**

**Time Saving  
Solutions On-site**

**Latest New  
Products**

**T5 Router  
Promotions**

**Latest New Videos**

**Tradesman Jig  
Promotion**

**CDJ300 DOVET**

**7** ISSUE  
2017

**trend**<sup>®</sup>  
routing technology



# ▶ WATCH OUR ROUTER CUTTERS

## STRAIGHTS VIDEO

Discover the versatility of straight cutters showing 40 different applications.

WATCH IT NOW!

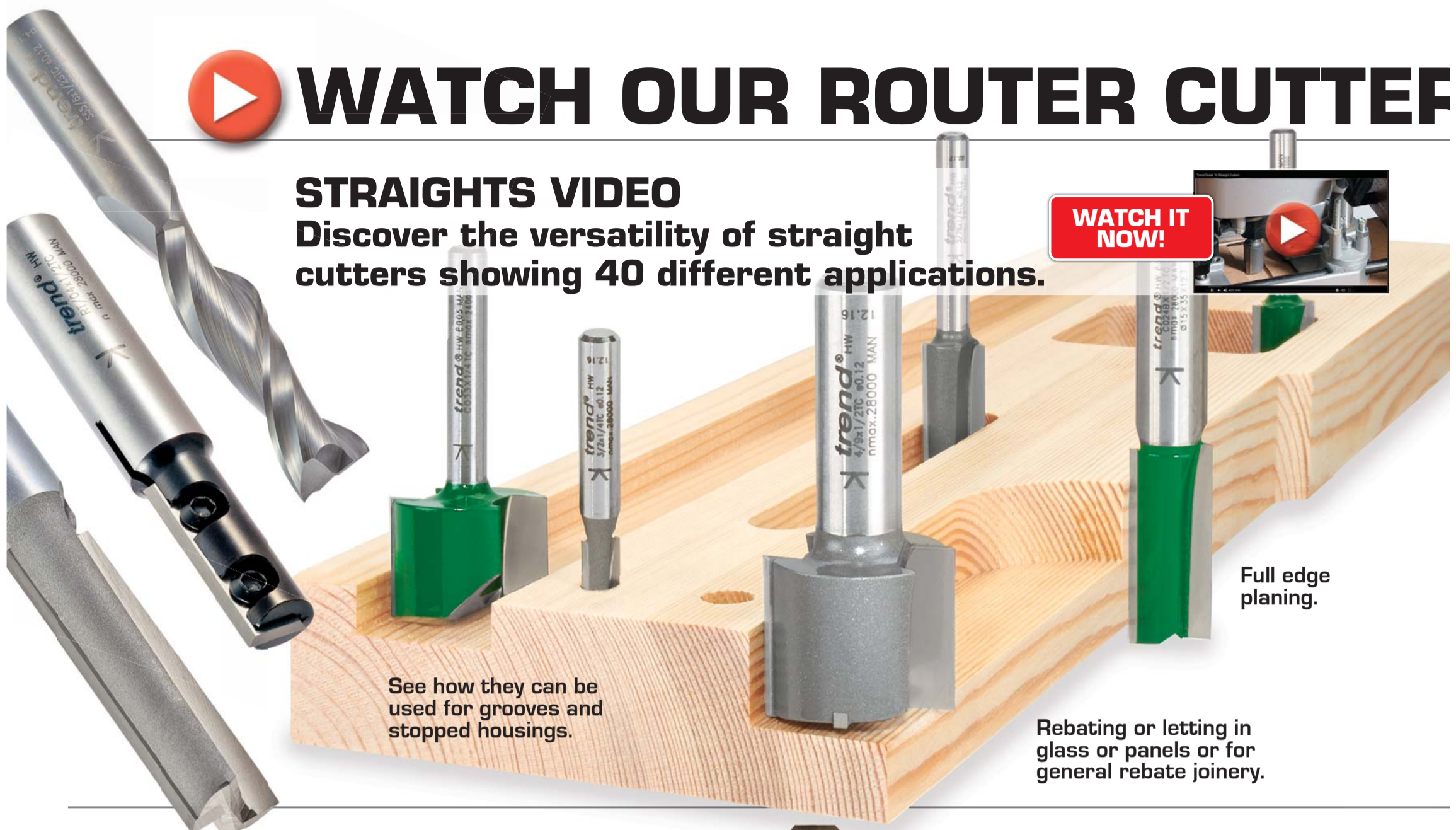

See how they can be used for grooves and stopped housings.

Full edge planing.

Rebating or letting in glass or panels or for general rebate joinery.

## BEARING GUIDED VIDEO

For moulding & jointing of straight and shaped workpieces.

WATCH IT NOW!



See how changing the height of the cutter and the size of the bearing can alter the profile.

Stopping the moulding can create interesting effects for columns or table legs.

Also how bearing guided cutters can be used in a router table either with a backfence for straight work or without for shaped work.

## ▶ LATEST NEW VIDEOS [www.trend-uk.com/video](http://www.trend-uk.com/video)



T5 Router video features this compact and versatile router.



Letter and number template video, ideal for house numbers and signs.



The CRT/MK3 Craftsman router table video, ideal for expanding the creativity of your router.



# R VIDEO GUIDES [www.trend-uk.com/video](http://www.trend-uk.com/video)



Ideal for full lap and half lap joints,

tongue & groove joints,

mortise & tenons,

and comb joints.



Create rebates, grooves or stopped housings with a side-fence,



grooving, rebating and full edge profile planing in router tables with the backfence,



and freehand routing of nameplates.



When used portably a batten or clamp guide can be followed with the side of the router.



Use guide bushes and templates to create a perfect repeatable shaped or cut out. For straight or shaped work.



Cut complete circles or arcs with a beam trammel.

## GUIDE TO RANGES

### CRAFTPRO RANGE **TCT**

Comprehensive range of Tungsten Carbide Tipped cutters specifically designed to meet the needs of the discerning woodworker and tradesman.

SEE PAGES 86-110 CATALOGUE 2017



500 LINES

### PROFESSIONAL RANGE **TCT**

The most popular range of Tungsten Carbide Tipped router cutters in the UK. Includes superior D-Namic extended life Carbide. For the most demanding applications in the woodworking and manufacturing trades.

SEE PAGES 5-79 CATALOGUE 2017



1800 LINES



Bearing guided profilers and trimmers can be used to shape the workpiece to replicate exactly the shape of a template.



Bearing guided trimmers can be used to trim the veneer using the workpiece as the guide.



Bearings on the ends of cutters can follow the straight and shaped workpiece itself.

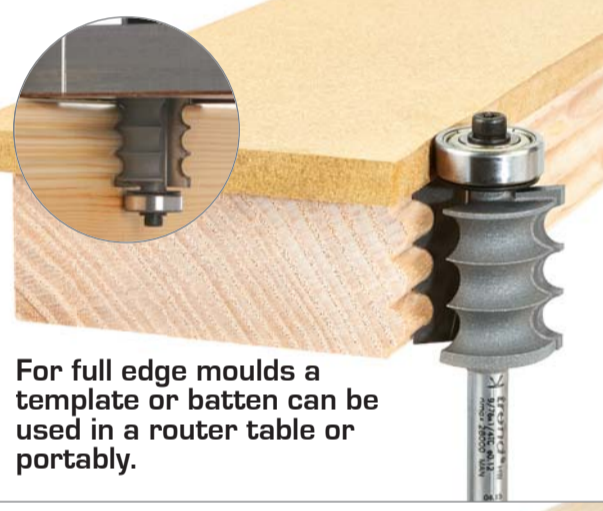

For full edge moulds a template or batten can be used in a router table or portably.

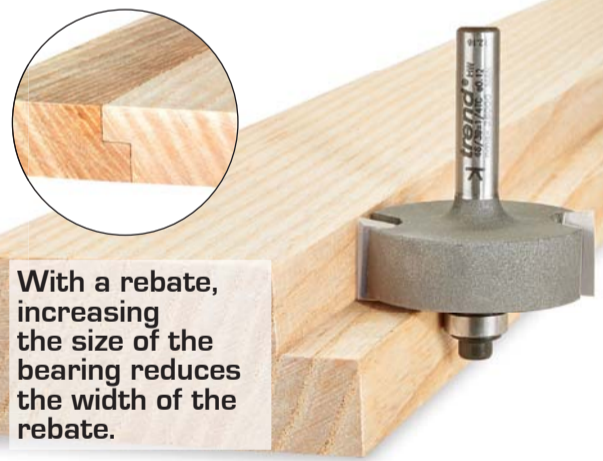

With a rebate, increasing the size of the bearing reduces the width of the rebate.



Bearings can be used on arbor systems such as the biscuit jointer which is supplied with bearings to suit the 3 sizes of biscuits.

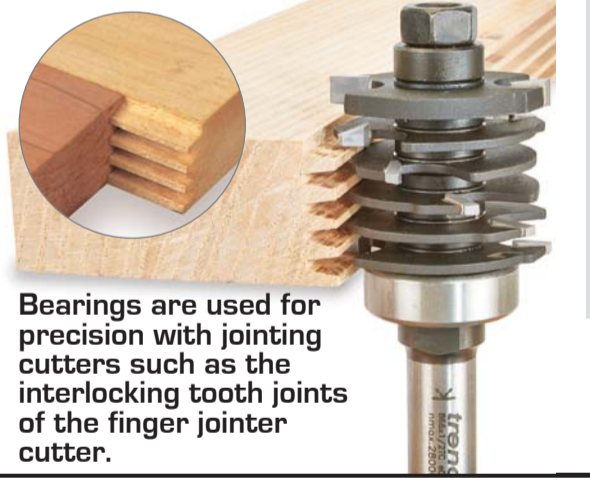

Bearings are used for precision with jointing cutters such as the interlocking tooth joints of the finger jointer cutter.

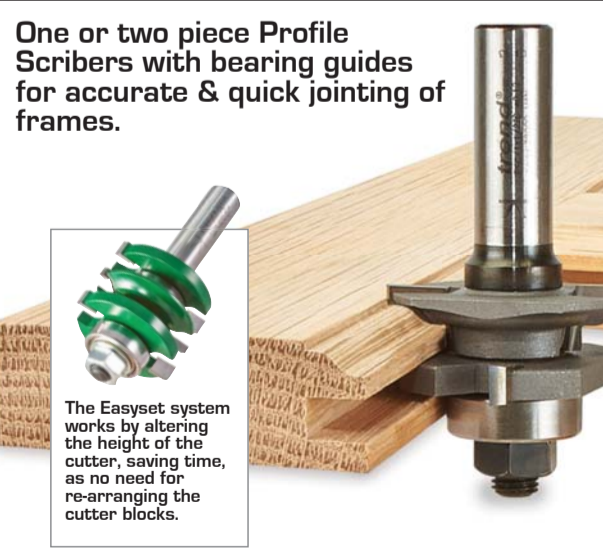

One or two piece Profile Scribers with bearing guides for accurate & quick jointing of frames.



The Easyset system works by altering the height of the cutter, saving time, as no need for re-arranging the cutter blocks.

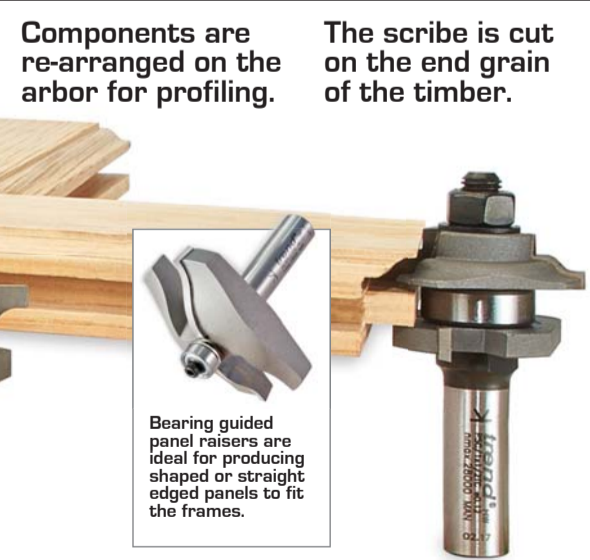

Components are re-arranged on the arbor for profiling.

The scribe is cut on the end grain of the timber.



Bearing guided panel raisers are ideal for producing shaped or straight edged panels to fit the frames.

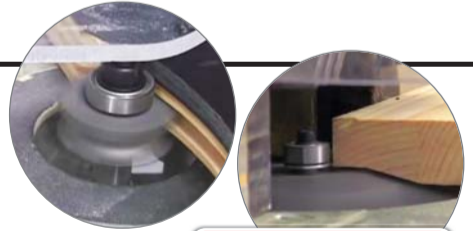

WATCH IT NOW!



See our Profile Scriber & Panel Cutters video



The New full featured workshop WRT router table.



The New T35A professional Class M wet & dry dust extractor.



Pocket Hole Jig is ideal for precise quick joinery of frames and sheet material.



# T5 VARIABLE SPEED ROUTER

The compact, powerful and manoeuvrable Trend T5 router has a soft start variable speed 1000 watt motor that is capable of working bigger profiles and finer detailed moulds while remaining lightweight and controllable.

Complete with a micro-adjustable side-fence, it allows any routing job to be carried out with speed, ease and accuracy.

**3 YEAR WARRANTY**  
WITH ONLINE REGISTRATION

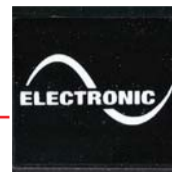

1000 watt motor, electronic variable speed with soft start feature.



The variable speed dial allows optimum control to match the cutter diameter and materials being used.



Cutters are easily changed using the built-in spindle lock.



The precision nut & collet assembly can be exchanged for the optional 8mm size.  
Ref. CNS/T5/8 £18.85 Exc. VAT

The fine control of the micro-adjustable side-fence ensures accurate results. The fence is guided by the edge of the workpiece.



The plunge can be controlled with the adjustable depth stop.



Used with the turret, the depth stop allows accurate inlays and depth setting.



For fine control a fine height adjuster is available.  
Ref. FHA/001 £15.25 Exc. VAT



The low profile dust spout clips easily into the router base.

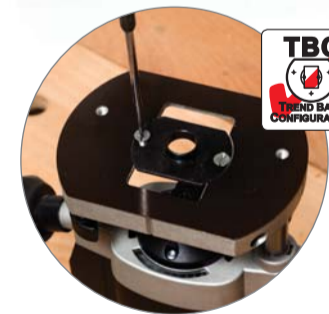

Guides bushes fit directly to the base for jig and template work. 35 different diameter sizes are available.

For full details see  
**SEE PAGE 132**  
CATALOGUE 2017

SPECIFICATION:	
Rating	Professional / Trade
Plunge stroke	0-50mm
Power input	1000w
Standard collet dia.	1/4"
Cutter dia. max.	40mm
No load speeds	9-27000 rpm
Dust spout size (ID)	35mm
Guide bush dia.	20mm
Weight	3.3kg
Voltages	240v or 115v*

INCLUDES:	
1 x 1/4" (6.35mm) Collet	
1 x 35mm Clip-in dust spout	
1 x 20mm Guide bush	
1 x Side-fence with micro adjuster	
1 x Beam trammel attachment	

**OFFER PRICE**  
 £124.17 EX VAT ~~List Price £267.94~~  
 REF. T5EB (240v) **£149** INC VAT  
 REF. T5ELB (115v)  
**PLUS**  
**GREAT VALUE T5 PROMOTION KITS**  
 SEE BACK COVER

Line-up sight marks.

The three stage turret stop allows controlled depth increments on deeper cuts.



Watch our new T5 Router video  
[www.trend-uk.com/video](http://www.trend-uk.com/video)



The plunge is controlled with the twist lock soft grip handle.



A beam trammel attachment is included to make circles and arcs.

## OTHER TREND ROUTERS IN THE RANGE

### T4 LIGHT DUTY PLUNGE ROUTER FOR THE HOBBYIST

850 WATT  
1/4" & 8mm collet capacity with removeable base.

Product Refs.  
**T4EK** (240v) **T4ELK** (115v)  
**£102.92** EX VAT  
**SEE PAGE 133**  
CATALOGUE 2017



### T10 IDEAL ON-SITE ROUTER FOR THE TRADESMAN

2000 WATT  
1/2" collet capacity with adjustable inner plate to ensure superior guide bush concentricity.

Product Refs.  
**T10EK** (230v) **T10ELK** (115v)  
**£336.41** EX VAT  
**SEE PAGE 131**  
CATALOGUE 2017



### T11 ROUTER IDEAL FOR USE IN THE WORKSHOP

2000 WATT  
1/2" collet capacity with built-in Quick Raiser.

Product Refs.  
**T11EK** (230v) **T11ELK** (115v)  
**£376.85** EX VAT  
**SEE PAGE 130**  
CATALOGUE 2017





# IMPORTANT SAFETY PRACTICES

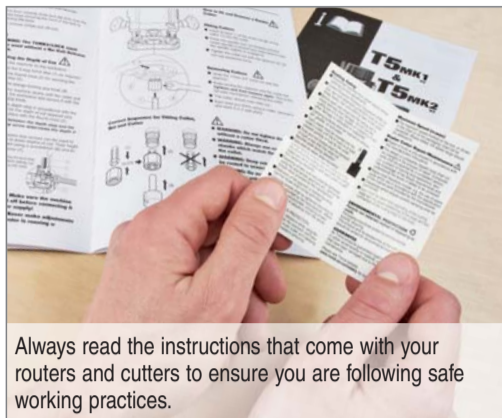

Always read the instructions that come with your routers and cutters to ensure you are following safe working practices.

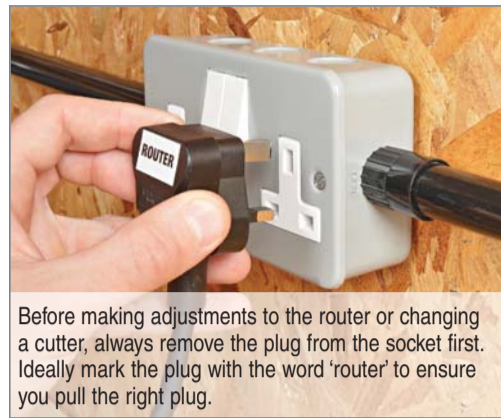

Before making adjustments to the router or changing a cutter, always remove the plug from the socket first. Ideally mark the plug with the word 'router' to ensure you pull the right plug.

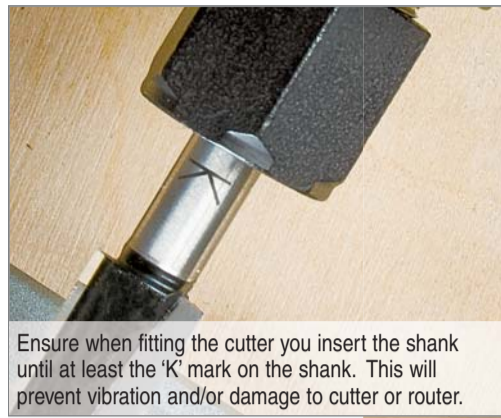

Ensure when fitting the cutter you insert the shank until at least the 'K' mark on the shank. This will prevent vibration and/or damage to cutter or router.



Always wear safety eyewear to ensure you protect your eyes from flying debris and a face mask to stop the inhalation of fine dust particles. Ear defenders are also advisable.

# FIRST STEPS TO GETTING STARTED



**1** First run a bearing guided edge mould around the outside of a square piece of material or against a long edge. Keep the router flat on the work and the bearing tight to the edge and feed at a steady rate.

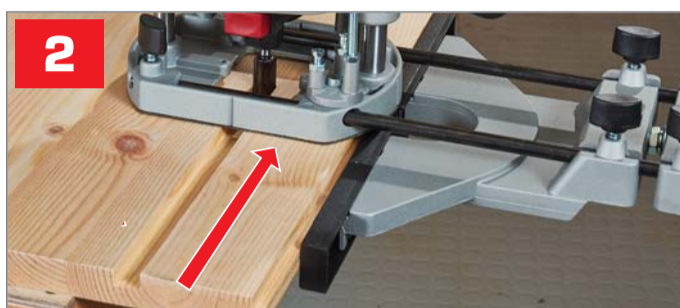

**2** Practice using the fence by making a rebate and a continuous groove. Close the fence cheeks. Keep firm pressure at the leading edge of the fence as the cut starts. Towards the end transfer pressure to rear of the fence.



**3** Using the fence, practice plunge stopped grooves. First set cut depth with depth stop. Plunge router into the work keeping firm pressure against the fence, move smoothly until you reach the stop point and release the plunge.



**4** Using the V groove cutter, practice freehand engraving & sign writing. Set a minimal depth of cut with the plunge stop. First sketch in pencil the lettering required taking into account the thickness of cut you will make.



**5** The V groove & fence are used to good effect to make false panels. Use the fence to rout the outer edges to give the effect of a frame & then adjust it to make the infill panel lines by using the plunge to start & stop the cuts.



**6** Making grooves beyond the reach of the fence is easy to achieve by clamping a batten as a guide and running the router against it. Mark up the position of groove required and position the batten appropriately.



**7** Cut a circle by fixing the trammel guide to one fence rod. Mark the centre and radius of the circle. Using the straight cutter, position trammel on the centre point and adjust the fence rod until the inside edge of the cutter is against your mark. Keep firm pressure on trammel point to prevent it lifting.



**8** Using a bearing guided moulding cutter, rout a mould around the edge of the circular blank. Move in an anti-clockwise rotation keeping pressure directly over the workpiece as you work to prevent tipping.

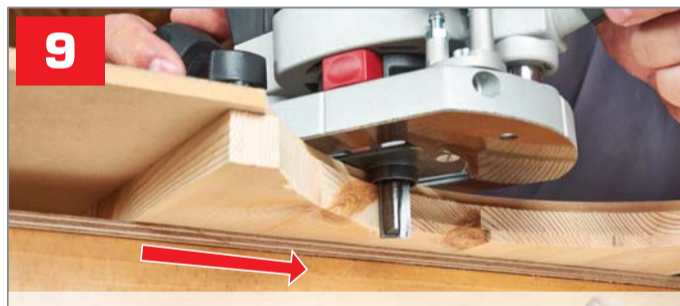

**9** Templates can be easily made from 6mm MDF for replicating shapes. Ensure any edge the guide bush has to follow is smooth as any roughness will be replicated in the finished workpiece. Secure the template to the work and keep the guide bush tight to the template.

# TIPS & ADVICE TO GET IT RIGHT

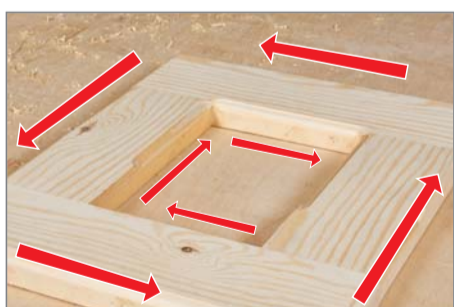

For internal moulding or template work, feed the router in a clockwise direction. For outside work feed in an anti-clockwise direction.



For deep grooves or edge work, take repeated passes to prevent motor overload.



Keep the weight over the workpiece to prevent router tipping.



Plan the order of cuts to prevent breakout. Rout the cross grain edge before the long grain edge.



Ensure an even feed speed to prevent burning. Burn marks often happen when the user repositions themselves, so the router path should be planned in advance. With experience the cutter can be pulled away from the workpiece at the crucial points to prevent burning. To remove burning a second pass can be made.



# TAKE YOUR ROUTER FURTHER

## 6 PIECE SET 1/4" SHANK

For decorative woodworking, such as grooving, profiling and moulding. Includes three self-guided cutters for straight and shaped work.

Product Ref.  
**SET/SS11X1/4TC**  
**£21.69**

**TCT**



SEE PAGES 112 & 114  
CATALOGUE 2017

## 24 PIECE SET 1/4" SHANK

Contains a range of widely used cutters for decorative woodworking.

Product Ref.  
**SET/SS24X1/4TC**  
**£70.60**

**TCT**



## 30 PIECE STARTER SET 1/4" SHANK

Cutter set aimed at those new to routing. To be used for a variety of woodworking applications on timbers and man-made timber based boards. Fifteen unguided and fifteen guided cutters.

Product Ref.  
**SET/SS31X1/4TC**  
**£84.90**

**TCT**

SEE PAGE 2  
CATALOGUE 2017



## DIGITAL DEPTH GAUGE

LCD depth gauge for setting tool height in a plunge router, router table and saw bench.

Product Ref.  
**GAUGE/D60**  
**£21.91**

SEE PAGE 187  
CATALOGUE 2017



## FINE HEIGHT ADJUSTER

Fine height adjusters simply fit onto the router and allow fine adjustment of the cutter height.

Product Ref.  
**FHA/001** (for T5)  
**£15.25**

SEE PAGE 185  
CATALOGUE 2017



## LETTER & NUMBER TEMPLATES

Clear plastic letter and number templates for routing signs including house names and numbers. The templates are used with a 13mm guide bush and 8mm diameter cutter. Letters are uppercase and all characters are nominal 57mm high.

Product Refs.  
**TEMP/NUC/57**  
**£21.68**  
(numbers)

**TEMP/LUC/57**  
**£43.47**  
(letters)

SEE PAGE 180  
CATALOGUE 2017

Cutter & Guide Bush Set  
Ref. **TEMP/LN57X1/4** **£15.25**



## VARIJIG SELF CLAMPING GUIDES

Self clamping, straight line clamp guides that use the Varijig low profile extrusion.

Product Refs.  
**VJS/CG/24** (610mm)  
**£30.39**

**VJS/CG/36** (915mm)  
**£36.00**

**VJS/CG/50** (1270mm)  
**£41.64**

SEE PAGE 210  
CATALOGUE 2017



## LARGE COMPASS

A router compass used for cutting circles and arcs from 100mm up to 610mm radius.

Product Ref.  
**R/COMPASS/A**  
**£45.18**

SEE PAGE 174  
CATALOGUE 2017



## OFFSET BASE

This teardrop shaped base is fitted to the router to allow better control when edge moulding by preventing router tilt.

Product Ref.  
**OFS/BASE**  
**£30.15**

SEE PAGE 179  
CATALOGUE 2017



## DOVETAIL JIGS

Two accurate and easy to use Dovetail Jigs for a variety of elegant joints. Cuts pins and tails in one operation.

Product Refs.  
**CDJ300** (300mm)  
**£119.89**

**CDJ600** (600mm)  
**£204.66**

SEE PAGE 148  
CATALOGUE 2017



## CRAFTPRO ROUTER TABLE

The CraftPro router table will suit craftsmen and woodworking enthusiasts. It is packed with features to maximise the versatility of all popular portable routers. Table top 610 x 405mm.

Product Refs.  
**CRT/MK3** (240v)  
**£223.90**

**CRT/MK3L** (115v)  
**£253.71**

SEE PAGE 139  
CATALOGUE 2017



## AIRSHIELD PRO

Powered respirator for all woodworking applications with built-in fan and protection shield.

Product Ref.  
**AIR/PRO**  
**£224.97**

SEE PAGES 136 & 137  
CATALOGUE 2017



## DUST MASK RESPIRATOR

With replaceable filter system, ideal for use when routing.

Product Ref.  
**AIRACE**  
**£38.76**



## T31A LIGHT DUTY WET & DRY VACUUM EXTRACTOR

Semi-professional wet and dry dust extractor with power tool take off, for hobbyist, DIY and light trade use. Large 35 litre capacity with 7 metre long power cable and 5 metre extra long hose.

Product Ref.  
**T31A** (230v, 1400W)  
**£190.77**

SEE PAGE 134  
CATALOGUE 2017



## MULTI-FUNCTIONAL COMBINATION ROUTER BASE

Quick fitting, multi-functional router base. Fits most routers with 8mm, 10mm and 12mm diameter rods at 78mm to 130mm centres.

Product Ref.  
**CRB**  
**£77.64**

SEE PAGE 173  
CATALOGUE 2017



## MINI ELLIPSE & CIRCLE CUTTING JIG

This jig is ideal for routing elliptical picture frames, mirrors, clocks and small tables etc. Maximum circle diameter is 600mm.

Product Ref.  
**ME/JIG**  
**£119.89**

SEE PAGE 175  
CATALOGUE 2017



## FLEXIBLE CURVE GUIDE TEMPLATES

An 8mm thick mini flexible curve used to make templates, enabling a shape to be cut repeatedly with precision. Use in conjunction with a self-guided cutter in a router. Alternatively a standard cutter can be used with a guide bush. Includes fixing screws.

Product Ref. Length Price  
**CURV/8X500** 500mm **£27.00**  
**CURV/8X1000** 1000mm **£52.00**

SEE PAGE 3  
CATALOGUE 2017

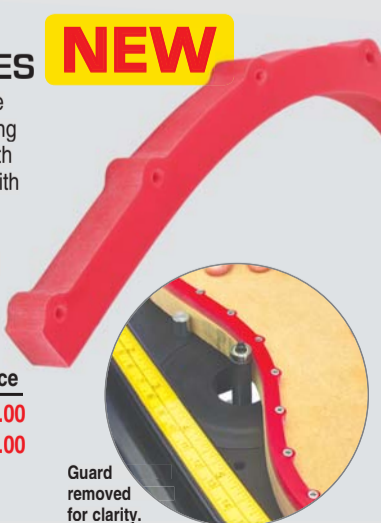

## MORTISE & TENON JIG

Enables mortise and tenons and dowel joints to be cut with a router. Ideal for cabinet, chair and table construction. One set-up for both mortise and tenon giving perfectly fitting joints.

Product Ref.  
**MT/JIG**  
**£216.75**

SEE PAGE 147  
CATALOGUE 2017



## BUTT HINGE TEMPLATE

A routing template that allows a router to create a hinge recess on a door. For 75mm and 100mm hinges.

Product Ref.  
**TEMP/BH/A**  
**£42.62**

SEE PAGE 171  
CATALOGUE 2017



ALL PRICES EXCLUDE VAT



# LATEST **NEW** PRODUCTS

**trend**<sup>®</sup>  
routing technology

## WORKSHOP ROUTER TABLE

The WRT will suit craftsmen and woodworking enthusiasts. It is packed with the necessary features to maximise the versatility of all popular portable routers.

Product Ref. **WRT** (240v)  
**£399.00**  
SEE PAGE 1  
CATALOGUE 2017



Check our website for compatibility with your router.

**Two insert rings** in sizes 31.8mm & 67.5mmØ to suit different cutter diameters.

**Insert plate** includes hole for the T11's Quick Raiser fine height adjuster with park position at rear of fence.

**Finger pressure guard assembly** fully adjustable.

**57mmØ (2-1/4") Dust spout aperture**

**Optional hose with adaptor** is available, 39mmØ x 3m with 57mmØ (2-1/4") adaptor. Ref. **CRT/4** £22.89

**Lead-on pin** for safe moulding with bearing cutters. Park position at rear of fence.

**Adjustable cheeks** with full edge planing attachments. 1.4mm and 2.4mm widths.

**Aluminium backfence** Quick release with adjustable cheeks and planing facility.

**Optional down pressures** (pair) available for machining longer lengths of timber. Ref. **WRT/1** £14.95

**Aluminium insert plate** with TBC fittings. **98mmØ Aperture** for large panel raiser cutters.

**Mitre fence** with zeroing and splach block facility.

**Optional pushblock** for scribing rails. Ref. **PUSHBLOCK/4** £53.40

**T11 Quick release fixing holes** allow T11 to be fitted to the table quickly when used with optional Quick release kit.

**T11 Quick release kit** Ref. **T11/JT/KIT** £27.97

**No-volt release switch** easy safe access to switch router on/off.

**Optional limit stop** available for stopped moulding & grooves. Ref. **WRT/2** £14.95

**Neat cable storage**

**Side finger pressure**

**Bench Weight** 27.5 Kg

**MDF table top** 804mm x 604mm Height 890mm

**Pushstick** supplied with park location.

**Adjustable feet** for uneven surfaces.

**Optional castors** (4 off) available for ease of movement. Ref. **WRT/3** £29.95

## DUST EXTRACTOR

Wet and dry dust extractor with power tool take off for professional use. 27 litre capacity with extra long 7 metre power cable and 5 metre long hose with blower facility. Rated dust category Class M to maintain a clean and safe working environment. Includes floor cleaning kit.



SEE PAGE 1  
CATALOGUE 2017

**Powerful motor** providing an airflow of 4,200 L/min.

**Capacity** 27 litres (dry). Weight 7.5kg.

**Adaptors, floor cleaning tubes & spouts** for wet & dry applications.

Product Refs.  
**T35A** (230v, 1400W) **£349.00**  
**T35AL** (115v, 800W) **£379.00**



**Large rear castors** for extra stability.

**Extra long hose** 5 metre x 39mmØ.



Power take-off socket maximum 2200w (240v).



Optional dust spout adaptor for WRT, CRT & PRT tables. Ref. **CRT/3** £11.51



Automatic & manual shaker facility to clean filter.



Easy filter removal plus additional foam filter for sucking up water.



Easy fit bag with full bag closure system.

## ULTIMATE TABLE PACKAGE



### OFFER PRICE

£999.17 EX VAT

List Price £1,397.20

REF WRT/KIT/A (240v)

**£1,199** INC VAT

ALL PRICES EXCLUDE VAT





# TIME SAVING SOLUTIONS FOR

## KITCHEN WORKTOP JIGS

### PROFESSIONAL 650MM

Designed to enable all 1/2" shank plunge routers to cut precise butt and scribe joints in postform worktops 500 to 650mm wide with peninsular cut facility.



Product Ref.  
**COMBI66**  
**£112.22**

CHOOSE  
**1 FREE**  
ACCESSORY

### DRAINING GROOVE JIGS

For routing draining grooves in solid timber for Belfast type sinks.



Product Ref.  
**DG/JIG**  
**£123.51**

CHOOSE  
**1 FREE**  
ACCESSORY

### TRADESMAN 700MM

For up to 700mm wide worktops.

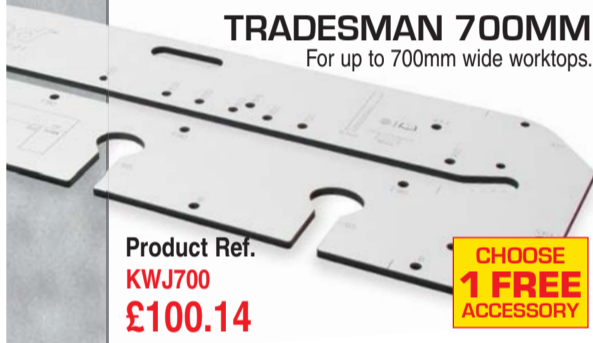

Product Ref.  
**KWJ700**  
**£100.14**

CHOOSE  
**1 FREE**  
ACCESSORY

### TRADESMAN ALL IN ONE 900MM

For upto 900mm wide worktops.



Product Ref.  
**KWJ900**  
**£163.02**

CHOOSE  
**1 FREE**  
ACCESSORY

### PROFESSIONAL 1000MM

For upto 1000mm worktops with cable tidy & circular hinge apertures.



Product Ref.  
**COMBI1002**  
**£313.92**

CHOOSE  
**2 FREE**  
ACCESSORIES

### APERTURE & RADIUS JIG

For routing apertures and radii in kitchen worktops to fit sinks, hobs and to suit curved cabinets.

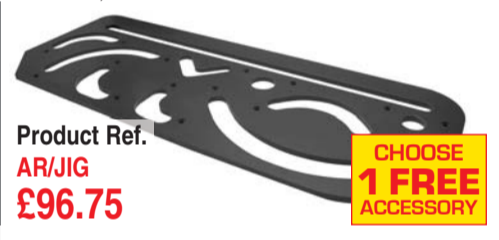

Product Ref.  
**AR/JIG**  
**£96.75**

CHOOSE  
**1 FREE**  
ACCESSORY

### BELFAST SINK JIG

For routing recesses into worktops for single or double Belfast sinks.



Product Ref.  
**BS/JIG**  
**£107.77**

CHOOSE  
**1 FREE**  
ACCESSORY

### HOT ROD JIG

For routing grooves in solid worktops to accept hot rods for prevention of heat damage to work surfaces.

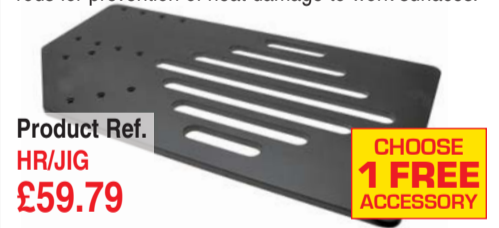

Product Ref.  
**HR/JIG**  
**£59.79**

CHOOSE  
**1 FREE**  
ACCESSORY

## SCRIBE & MEASURE

### EASYSCRIBE

A handheld offset pencil line drawing scribing tool with extendable plate.



Product Ref.  
**E/SCRIBE**  
**£27.16**

### MULTISCRIBE

Multi-use profile matching tool.



Product Ref.  
**MS/PRO**  
**£34.95**

15 FUNCTIONS  
IN ONE TOOL

### WORKTOP SCRIBER

Marks offset between worktop jig and guide bush for easy set-up.



Product Ref.  
**M/KWS01**  
**£20.48**

### ANGLE FINDER

Calculates angles from 0° to 220° with large butt facility.



Product Ref.  
**DAF/8**  
**£36.96**

### DIGITAL ANGLE RULES

Calculates angles quickly and accurately.

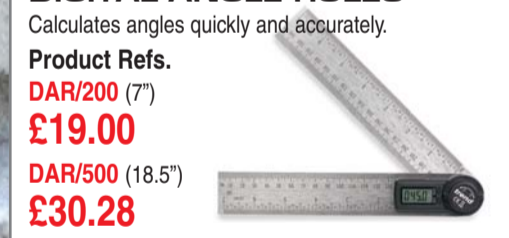

Product Refs.  
**DAR/200 (7")**  
**£19.00**  
**DAR/500 (18.5")**  
**£30.28**

## HINGE JIGS

### SKELETON HINGE JIG

To accurately recess hinges in wooden doors and frames with minimal set-up time, both on-site and in joinery shops.



Product Ref.  
**H/JIG/C**  
**£244.52**

CHOOSE  
**2 FREE**  
ACCESSORIES

### CONTRACTOR SINGLE PIECE

Constructed from aluminium extrusion.



Product Ref.  
**HINGE/JIG**  
**£240.96**

CHOOSE  
**2 FREE**  
ACCESSORIES

### CONTRACTOR TWO PIECE

Constructed from aluminium extrusion. Two sections for easy transportation.



Product Ref.  
**H/JIG/A**  
**£244.52**

CHOOSE  
**2 FREE**  
ACCESSORIES

### TRADE

Two piece jig constructed from 12mm Phenolic resin.



Product Ref.  
**H/JIG/B**  
**£204.66**

CHOOSE  
**2 FREE**  
ACCESSORIES

## ACCESSORIES

### WORKTOP CONNECTORS

Metal panel bolts to keep joints together. Four styles available.



SEE PAGE 157  
CATALOGUE 2017

### NO. 20 BISCUITS

Recommended for jointing worktops.

Product Ref.  
**BSC/20/100**  
(Qty 100)  
**£7.15**

Product Ref.  
**BSC/20/1000**  
(Qty 1000)  
**£31.48**



### CABINET DOOR HINGE TEMPLATE

To cut 26mm & 35mmØ blind holes for circular cabinet door hinges. Use with 1/2" cutter and 30mm guide bush.

Product Ref.  
**TEMP/CDH/A**  
**£52.45**



### CORNER CHISEL

For squaring hinge and lock faceplate recesses.

Product Ref.  
**C/CHISEL**  
**£14.42**



## WORKTOP CUTTERS

All 12.7mm (1/2") diameter x 50mm cut length.



Product Ref.  
**C153DX1/2TC**  
**£26.16**

Product Ref.  
**3/83DX1/2TC**  
**£35.11**

Product Ref.  
**3/83DUX1/2TC**  
**£45.50**

Product Ref.  
**RT/11X1/2TC**  
**£74.48**

Product Refs.  
**CR/KFP/5** £71.93  
**KFP/3/83D** £161.97

## BEARING GUIDED BISCUIT JOINTERS

Product Refs.  
**C152X1/4TC**  
**C152X8MMTC**  
**C152X1/2TC**  
**£38.16**

Product Refs.  
**342X1/4TC**  
**342X8MMTC**  
**342X1/2TC**  
**£59.82**



For 3 sizes of biscuit.

## HINGE & LOCK JIG CUTTERS

For routing the lock faceplate or hinge recess. Long reach 12mm cutters with 1/4" shank. Deepening of lock mortise with auger bit required.

Product Ref.  
**C019AX1/4TC**  
**£18.53**

Product Ref.  
**3/8LX1/4TC**  
**£27.73**





## LOCK JIGS

### STANDARD LOCK JIG

To precisely rout the mortise and faceplate recesses for popular doors and locks.



Product Ref.  
**LOCK/JIG**  
**£102.92**

CHOOSE  
**1 FREE**  
ACCESSORY

### LARGE LOCK JIG

For routing the faceplate and mortise for larger locks quickly and accurately.



Product Ref.  
**LOCK/JIG/A**  
**£148.94**

CHOOSE  
**1 FREE**  
ACCESSORY

### ADJUSTABLE LOCK JIG

For precision fitting of locks into doors. Faceplate lengths up to 250mm.



Product Ref.  
**LOCK/JIG/B**  
**£96.75**

CHOOSE  
**1 FREE**  
ACCESSORY

### LOCK RECESS TEMPLATE

Clear plastic template for use with any plunge router to accurately fit 2, 3 and 5 lever sash and dead mortise locks. Supplied with 6 plates.



Product Ref.  
**TEMPLR/A**  
**£56.67**

## SKIRTING SCRIBER

### SCRIBE-MASTER PRO JIG

A quick and accurate method to use a router to scribe skirting and dado rails, with minimal setting up time.



Product Ref.  
**SM/PRO**  
**£313.95**

CHOOSE  
**2 FREE**  
ACCESSORIES

### SCRIBE-MASTER PRO SKIRTING JIG

Cuts precise left and right hand scribes in seconds. Fully variable, up to ten times faster than manual scribes.



Includes 1/4" shank HSSE spiral router cutter.

## VARIJIG GUIDES

### VARIJIG FRAME SYSTEM

Adjustable frame and guide for use with a router. Allows recesses, slots and face panel moulds to be cut.

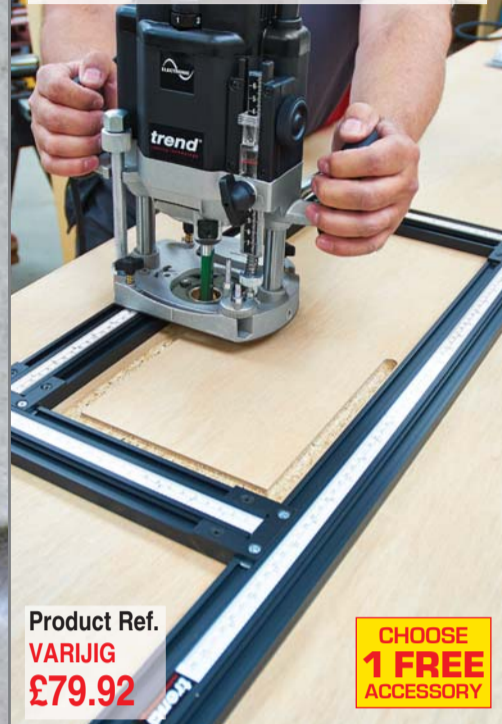

Product Ref.  
**VARIJIG**  
**£79.92**

CHOOSE  
**1 FREE**  
ACCESSORY

### VARIJIG 36" SELF CLAMPING GUIDE

Straight line clamp guide that uses the Varijig low profile extrusion.



Product Ref.  
**VJS/CG/36** (915mm)  
**£36.00**

### SQUARING ATTACHMENT

Allows clamp guide to be squared up for maximum accuracy.



Product Ref.  
**VJS/CG/SQA**  
**£10.69**

### VARIJIG 36" VARIABLE ANGLE GUIDE

Adjustable guide to allow grooving with a router, or crosscutting with a circular saw.



Product Ref.  
**VJS/AG/36** (915mm)  
**£62.37**

## FLOOR ACCESS

### ROUTABOUT HOLE CUTTER JIG KITS

A quick way to cut and complete a large access hole in about five minutes. Gives a neat flush finish under a carpet.



### ROUTABOUT HOLE CUTTER JIG

Access to pipes and cables beneath chipboard floors.



A unique stepped cutter is supplied in the kit,

and three insert rings included.

Ref.	Shank Dia.	Floor thick.	Price
<b>RBT/1</b>	1/4"	18mm	<b>£55.69</b>
<b>RBT/2</b>	1/2"	18mm	<b>£55.69</b>
<b>RBT/3</b>	1/4"	22mm	<b>£59.35</b>
<b>RBT/4</b>	1/2"	22mm	<b>£59.35</b>

EXTRA RINGS:	Product Ref.	Price
For 18mm thick floors		
Pack of 10	<b>RBTRNG18/10</b>	£42.02
Pack of 100	<b>RBTRNG18/100</b>	£389.80
Pack of 250	<b>RBTRNG18/250</b>	£949.84
For 22mm thick floors		
Pack of 10	<b>RBTRNG22/10</b>	£49.64
Pack of 100	<b>RBTRNG22/100</b>	£468.63
Pack of 250	<b>RBTRNG22/250</b>	£1,141.16

### DOOR STAND

Holds door on its edge while routing.



Product Ref.  
**D/STAND/A**  
**£45.91**

### DOOR & BOARD LIFTERS

Foot operated lifters to support door while fitting frame into door.



**D/LIFT/A**  
**£16.77**

Standard  
Max. weight  
75kg (165lbs)  
**D/LIFT/B**  
**£18.48**

**NEW**  
Heavy duty  
Max. weight  
200kg (440lbs)  
**D/LIFT/C**  
**£34.50**

### DOOR CLAMP

Holds door in position while drilling and fitting locks.



Product Ref.  
**D/CLAMP/A**  
**£21.68**

### LOCK JIG CUTTERS

Long reach 1/2" shank cutters for routing the mortise as well as the face plate.

Product Ref.  
**C172X1/2TC**  
**£23.60**



Product Ref.  
**3/75X1/2TC**  
**£41.41**

### INTUMESCENT RECESSERS

For 10, 15, 20 and 25mm wide 4mm thickness strip.



SEE PAGES 68 & 109  
PRICES FROM **£29.91**

### WEATHERSEAL CUTTERS

For Aquamac, Aquatex, Weather Pile & Weatherseal.



SEE PAGES 66-67, 108-109  
PRICES FROM **£32.63**

## FREE ACCESSORIES WITH SELECTED JIGS

Choose from 4 accessories:



**A** Worktop Cutter & Biscuit Jointer

**B** Standard Door Lifter

**C** Snappy Drill Bit Guide, Countersink & Drill

**D** Corner Chisel

SEE DETAILS ON  
PRODUCT PACKAGING

UK & Ireland only. Offer ends 1st June 2018.

ALL PRICES EXCLUDE VAT



# Strend<sup>®</sup> Snappy

The Quick Release Drill System

# THE QUICK RELEASE DRILL SYSTEM

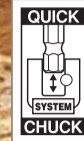

The most comprehensive range of Quick Change tooling on the market.

**LATEST ADDITIONS NOW 500+ LINES**



Chucks fits directly into any power drill

Standard Quick Chuck

SDS+ Shank Quick Chuck

Tools fit directly into any impact driver.

Tools fit directly into any power drill.

## 35MM MACHINE BIT WITH DEPTH STOP

**NEW**

A machine bit for circular hinges with built in depth stop which can be adjusted in height to suit hinge recess depth.



Product Ref. **SNAP/MB/35DS**  
**£22.95**

## DRILL COUNTERSINKS

Four new sizes of quick change drill countersinks with adjustable drills to bore various size holes for screws.

Prod. Ref.	Drill Dia.	CB	Price
<b>SNAP/CS/1814</b>	3.2mm	6.3mm	<b>£7.95</b>
<b>SNAP/CS/10H</b>	3.57mm	9.5mm	<b>£7.95</b>
<b>SNAP/CS/7C</b>	3.96mm	9.5mm	<b>£7.95</b>
<b>SNAP/CS/9C</b>	4.76mm	9.5mm	<b>£7.95</b>

**NEW**

## DEPTH STOP ACCESSORY

**NEW**

Rotating depth stop accessory that can be used with 9.5mm and 12.7mm adjustable drill countersinks to allow consistent drilling depths. Tool has large cavity to reduce clogging. Fits SNAP/CS/6-12 but not for TCT drill countersinks.



Product Ref. **SNAP/ROT/DS**  
**£16.95**

## 15 PIECE COLOUR RING BIT SET

Assorted screwdriver bit set for a range of applications. Colour rings on the shank to denote type for easy identification. Contains fourteen 25mm insert bits and a magnetic bit holder.

Product Ref. **SNAP/SB5/SET**  
**£9.95**



## ONE TOUCH BIT HOLDER

Magnetic holders with one touch button for quick and easy release of 25mm insert bits. Small 10.3mm diameter to allow access into tighter spaces.

Product Ref.	OL mm	Price
<b>SNAP/BH/OT</b>	66	<b>£6.95</b>
<b>SNAP/BH/OT/A</b>	150	<b>£9.95</b>



## FESTOOL<sup>®</sup> CENTROTEC COMPATIBLE TOOLS

For use in a Festool<sup>®</sup> Centrotec drill.

### Drill Countersinks

Prod. Ref.	Drill Dia.	Price
<b>SNAP/F/CS6</b>	2.38mm	<b>£15.70</b>
<b>SNAP/F/CS8</b>	2.75mm	<b>£15.70</b>
<b>SNAP/F/CS10</b>	3.25mm	<b>£15.70</b>
<b>SNAP/F/CS12</b>	3.5mm	<b>£15.70</b>



### Drill Bit Guides

Prod. Ref.	Drill Dia.	Price
<b>SNAP/F/DBG7</b>	2.75mm	<b>£19.90</b>
<b>SNAP/F/DBG9</b>	3.5mm	<b>£19.90</b>

## COLOUR RING SCREWDRIVER BIT SETS

Assorted bits for a range of applications. Colour coded rings for easy identification.

Product Refs. **SNAP/SB3/SET** **£28.67** (56 piece)  
**SNAP/SB4/SET** **£31.87** (41 piece)



## FLAT BIT 7 PIECE SET IN FABRIC HOLDER

Comprises 10mm, 12mm, 16mm, 20mm, 22mm, 25mm and 32mm flat bits.

Product Ref. **SNAP/FB3/SET**  
**£20.95**



**500+ LINES**

## 300MM MAGNETIC FLEXIBLE BIT HOLDER

For insert and direct drive shank screwdriver bits. Designed to flex and hold in various positions.

Product Ref. **SNAP/FMD/1**  
**£15.93**



## NO.2 POZI<sup>®</sup> & PHILLIPS<sup>®</sup> BITS 49MM

Designed especially to fit directly into impact drivers or bit holders. Torsion Zone for increase hardness with Optimum hardness for tough fastenings.

Product Refs. **SNAP/PZ2I/3** (3 pack)  
**SNAP/PH2I/3** (3 pack)  
**£10.40**



## 90° COMPACT ANGLE DRIVER

Allows access to tight corners. For use with drills, bits and countersinks.

Product Ref. **SNAP/ASA/3**  
**£42.40**



## HEX DOWEL DRILLS

Carbon Steel lip and spur dowel roll fluted one piece drill bits. Depth collars also available.

Product Ref.	Drill Dia.	Price
<b>SNAP/DD/6MM</b>	6mm	<b>£1.85</b>
<b>SNAP/DD/8MM</b>	8mm	<b>£1.96</b>
<b>SNAP/DD/10MM</b>	10mm	<b>£2.07</b>





# DRILLING TOOLS

## DOMINO BITS

Two flute spiral slotting tools for use with the Festool® Domino DF500 dowel mortising system. Creates pockets for Domino dowels.



**NEW**



Prod. Ref.	Drill Size	Price
DOM/04	4mm	£23.50
DOM/05	5mm	£21.50
DOM/06	6mm	£22.00
DOM/08	8mm	£22.50
DOM/10	10mm	£25.50

**TCT**  
TUNGSTEN CARBIDE TIPPED

SEE PAGE 3  
CATALOGUE 2017

## POCKET HOLE JIG

This is a great method of forming carcass and frame joints. It is both fast and strong. The joint is formed by drilling a screw hole and counterbore at an angle into one of the two pieces to be joined.

**NEW**



SEE PAGE 204  
CATALOGUE 2017

Product Ref. PH/JIG £71.44

## MINI POCKET HOLE JIG

For fast, accurate jointing of timber and plywood giving strong joints. Compact size is ideal for use on-site.



SEE PAGE 205  
CATALOGUE 2017

Product Ref. PH/JIG/M £37.99

Packs of standard and coarse square drive self tapping screws also available.



## SHELF SUPPORT TEMPLATE

A template to allow routing or drilling of 32mm centre holes for 5mm diameter shelf supports. A 5mm router drilling cutter and drill bit guide available.



SEE PAGE 172  
CATALOGUE 2017

Product Ref. TEMP/SS/A £45.18

# DIAMOND SHARPENING

## DIAMOND CROSS SHARPENING TOOLS

With unique Diamond Cross embossed markings and innovative gripping handles for smaller stones.

SEE PAGE 224  
CATALOGUE 2017

**D&C**  
DIAMOND CROSS

### 3" DOUBLE-SIDED ROUTER CUTTER STONE

A double-sided fine/coarse 3" stone with unique gripping handle. Specifically designed for router cutter sharpening.

Ref. DC/RC/FC £11.81

Size: 75 x 25 x 1.6mm (excluding handle).  
Fine 600 grit, coarse 300 grit.



VIDEO TO WATCH



### 8" X 2-3/4" DOUBLE-SIDED WORKSHOP STONE

For sharpening chisels and plane irons. Precision ground Tool Steel core with Stainless Steel plates. Supplied in fabric case with pair of magnetic bench holders and cleaning block.

Ref. DC/W8/FC £52.49

Size: 203 x 70 x 7mm  
Fine 1000 grit, coarse 300 grit.



### FASTTRACK CHISEL SHARPENER

Portable hand operated honing system giving your chisels guaranteed razor fine edges every time.

Ref. FTS/KIT £67.45

Includes 220 and 450 grit stones.



SEE PAGE 219  
CATALOGUE 2017

## PROFESSIONAL DIAMOND STONES

Continual diamond surfaced stones for sharpening, deburring or honing a wide range of tools.

SEE PAGE 220-223  
CATALOGUE 2017

VIDEO TO WATCH



### 3" DOUBLE-SIDED CREDIT CARD STONE

More robust thicker general purpose double-sided credit card size stones. Ideal for Carbide and HSS router cutters, chisels, turning tools and general joinery tooling.

Ref. DWS/CC/FC £21.93

Size: 84 x 50 x 1.8mm.  
Fine 600 grit, coarse 300 grit.



### 8" X 3" CLASSIC PROFESSIONAL DIAMOND WORKSHOP DOUBLE-SIDED STONE

1000 grit fine surface for smooth precise honing. 300 grit coarse surface has unique clearance channels. Suitable for re-shaping, general joinery & heavy duty work. Ideal for Carbide tooling, woodturning inserts & Carbide tips.

Product Ref. DWS/CP8/FC

£89.45

Size: 203 x 75 x 8mm.  
Fine 1000 grit, coarse 300 grit.



# SAWBLADE COMPATIBILITY

[www.trend-uk.com/compatibility](http://www.trend-uk.com/compatibility)



The new Sawblade Compatibility option on our website lists all models of saw machines for correct selection from our CraftPro and Professional Sawblade Ranges.

## CHOOSE THE RIGHT BLADE



### RIP

These blades have the least number of teeth for the diameter, i.e. 250mm, 24 teeth (24T). These are used for cutting with the grain in natural timbers, such as cutting down the length of a board or a baulk of timber.



### GENERAL PURPOSE OR COMBINATION

These have more teeth for the diameter. A 250mm blade would have around 40 teeth (40T). These blades can be used for all types of cutting in natural timbers, however you will not achieve the best results possible.



### CROSSCUT OR TRIMMING

Again, more teeth for the diameter eg. 250mm X 60T. Used for cutting natural timber across the grain, creating a smooth, tear free cut. Can also be used for ply and all other man-made boards.



### FINE TRIM/FINISH

Sometimes known as an Extra Fine blade, these have the most teeth (eg. 250mm x 80T) and will give the cleanest possible cut across the grain in natural timbers. These are especially good for sizing panels.



### THIN KERF

These are much thinner in section and are best suited to mitre or chop saws that have no riving knife or cordless saw. The thin blade section means that much less material is removed during the cut and so less power is required.



### NEGATIVE RAKE

Perfect for use on mitre saws and radial arm saws, the negative rake angle of the tooth prevents the blade from 'climbing' over the work. The cut entry is much softer which makes the machine safer to use.

## PLUNGE SAWBLADES

Designed for demanding professional and industrial applications using wood and wood based materials.

FOR FULL RANGE  
SEE PAGES 122-128  
CATALOGUE 2017



## DIGITAL LEVEL BOX

Find the angle on a surface quickly and accurately. With its magnetic base and LCD backlight, this level box is ideal for table and mitre saws.



SEE PAGE 214  
CATALOGUE 2017

Ref. DLB £17.80



# T5 ROUTER PROMOTIONS



## 9 GREAT VALUE T5 ROUTER KITS

### GETTING STARTED KITS

Ideal for those new to routing wanting a quality compact router to get started.

**6 Piece Cutter Set**  
SET/SS11X1/4TC  
Worth £26.03

**Safety Spectacles**  
SAFE/SPEC/A  
Worth £6.29

**Router T5EB**  
Worth £267.94

**SAVE £131**

£140.83 EX VAT  
REF. T5EB/KIT/A (240v)  
REF. T5ELB/KIT/A (115v)

**£169** INC VAT

**36" Varijig Clamp Guide**  
VJS/CG/36  
Worth £43.20

**Router T5EB**  
Worth £267.94

**SAVE £138**

£144.17 EX VAT  
REF. T5EB/KIT/B (240v)  
REF. T5ELB/KIT/B (115v)

**£173** INC VAT

**Number Template**  
TEMP/NUC/57  
Worth £26.02

**Cutter & Guide Bush Set**  
TEMP/LN57X1/4  
Worth £18.30

**Router T5EB**  
Worth £267.94

**SAVE £139**

£144.17 EX VAT  
REF. T5EB/KIT/C (240v)  
REF. T5ELB/KIT/C (115v)

**£173** INC VAT

### WOODWORKER KITS

Ideal for those wanting to take their routing projects that much further.

**CraftPro Diamond Bench Stone**  
CR/DWS/B6/FC  
Worth £40.37

**Digital Depth Gauge**  
GAUGE/D60  
Worth £26.29

**Router T5EB**  
Worth £267.94

**SAVE £152**

£151.67 EX VAT  
REF. T5EB/KIT/D (240v)  
REF. T5ELB/KIT/D (115v)

**£182** INC VAT

**24 Piece Cutter Set**  
SET/SS24X1/4TC  
Worth £84.72

**CraftPro Diamond Credit Card Stone**  
CR/DWS/CC/FC  
Worth £13.38

**Router T5EB**  
Worth £267.94

**SAVE £147**

£182.50 EX VAT  
REF. T5EB/KIT/E (240v)  
REF. T5ELB/KIT/E (115v)

**£219** INC VAT

**300mm Dovetail Jig**  
CDJ300  
Worth £143.87

**Fine height adjuster**  
FHA/001  
Worth £18.30

**Router T5EB**  
Worth £267.94

**SAVE £162**

£223.33 EX VAT  
REF. T5EB/KIT/F (240v)  
REF. T5ELB/KIT/F (115v)

**£268** INC VAT

## T5 PROMOTION

Enjoy the versatility of our popular T5 router at a great offer price.

Both compact & powerful for a perfect finish.

**OFFER PRICE**

**£124.17 EX VAT** List Price ~~£267.94~~

**£149** INC VAT

REF. T5EB (240v)  
REF. T5ELB (115v)

LIMITED OFFERS WHILE STOCKS LAST

### TRADESMAN KITS

Ideal for those on-site who need time saving solutions and precise results. T5 available in 240v or 115v.

**18mm Routabout Hole Cutter Jig**  
RBT/1  
Worth £66.83

**10 off Routabout Rings**  
RBTRNG18/10  
Worth £50.42

**Router T5EB**  
Worth £267.94

**SAVE £146**

£199.17 EX VAT  
REF. T5EB/KIT/G (240v)  
REF. T5ELB/KIT/G (115v)

**£239** INC VAT

**Adjustable Lock Jig**  
LOCK/JIG/B  
Worth £116.10

**12mm Router Cutter**  
TR12X1/4TC  
Worth £29.80

**Router T5EB**  
Worth £267.94

**SAVE £154**

£215.83 EX VAT  
REF. T5EB/KIT/H (240v)\*  
REF. T5ELB/KIT/H (115v)\*

**£259** INC VAT

**2 piece Hinge Jig**  
H/JIG/A  
Worth £293.42

**12mm Router Cutter**  
TR12X1/4TC  
Worth £29.80

**Router T5EB**  
Worth £267.94

**SAVE £192**

£332.50 EX VAT  
REF. T5EB/KIT/I (240v)  
REF. T5ELB/KIT/I (115v)

**£399** INC VAT

**NEW**

WEBSITE LAUNCHED WITH GREAT NEW FEATURES

www.trend-uk.com

#### ACTUAL SIZE ROUTER CUTTERS FEATURE

All our router cutters can be viewed on any device to the actual size, in high definition.

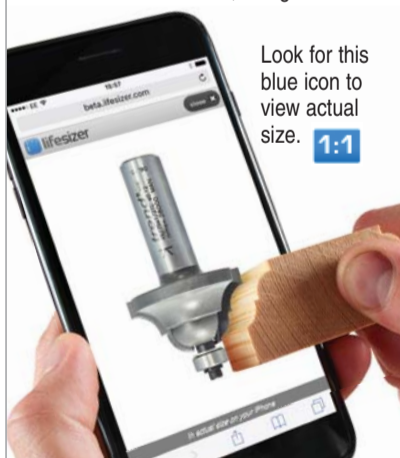

Look for this blue icon to view actual size. **1:1**

#### VIDEO GALLERY

Our videos are categorised into product ranges with a full range of links to related products, knowledge base and projects.

**12 NEW VIDEOS TO WATCH**



#### SAWBLADE COMPATIBILITY

Our new sawblade compatibility option lists all models of saw machines for the correct selection from our CraftPro and Professional Sawblade Ranges.



#### HI-DEFINITION IMAGES

All new photography in high definition of all cutters in our Professional, CraftPro and Trade Ranges. We now show 3D and 2D views of each cutter.



#### HOW TO GUIDES

We are regularly adding new How To Guides each week. They include tips, techniques and video clips to help you get the best from your Trend products.

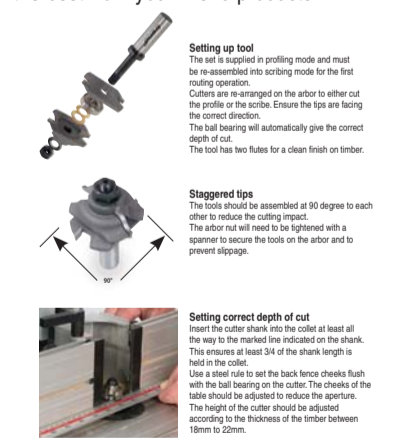

Available from:

Trend Machinery & Cutting Tools Ltd.  
Odhams Trading Estate  
St Albans Road Watford  
WD24 7TR England  
Tel: 01923 249911  
Fax: 01923 236879  
enquiry@trendm.co.uk  
www.trend-uk.com

**trend**<sup>®</sup>  
routing technology



Subscribe to our Newsletter

Enter your email address **Subscribe**

AVAILABLE FROM TREND ROUTING CENTRES IN THE UK AND IRELAND