

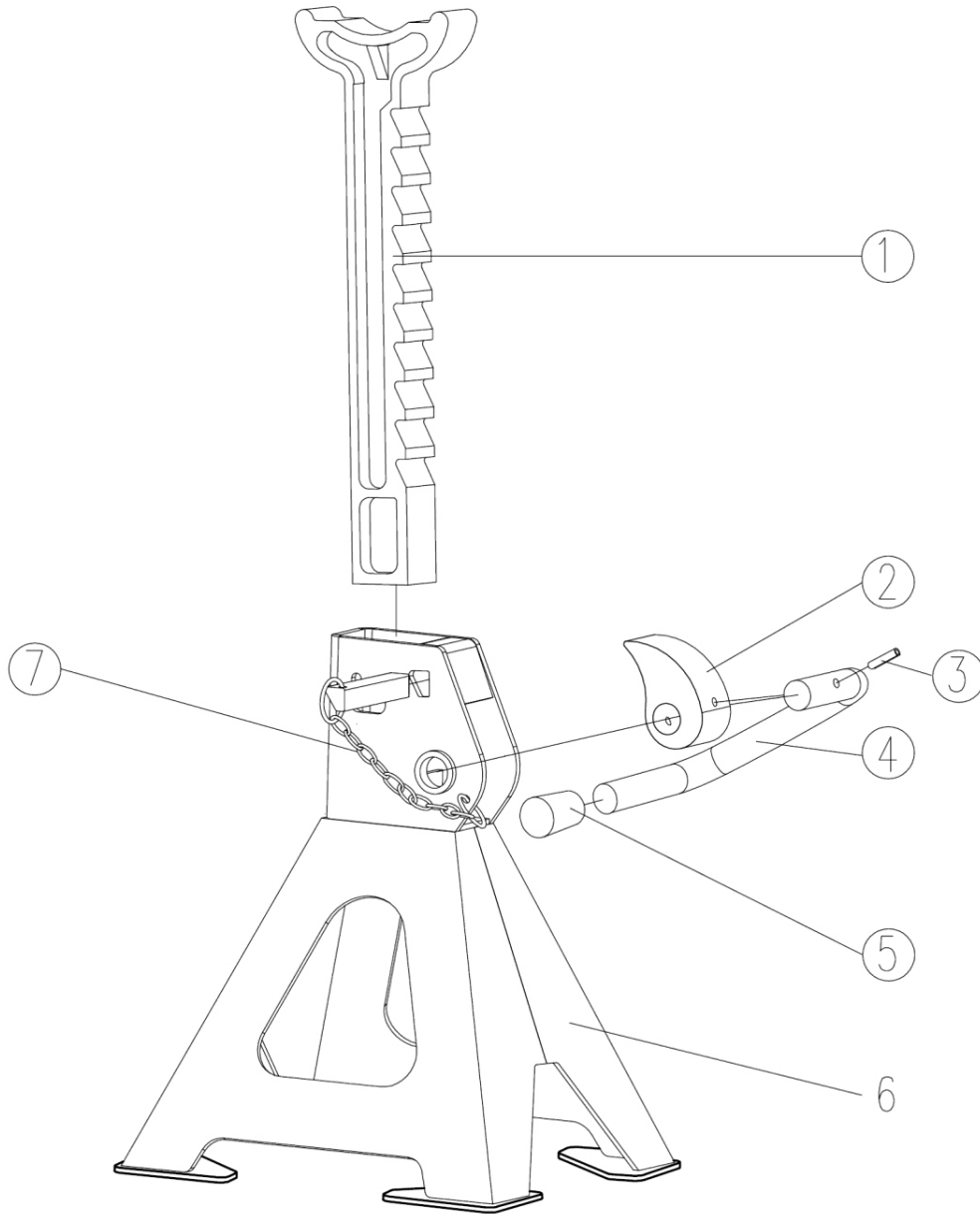

Parts Information:  
**Axle Stands (Pair) 3tonne Capacity per  
 Stand Ratchet Type with Safety Pin**  
**Model No: VS2003DL**



Item	Part No.	Description
10	VS2003DL.01	RATCHET BAR
20	VS2003DL.02	LOCKING PAWL
30	VS2003DL.03	SPRING PIN 4x30mm
40	VS2003DL.04	LOCKING HANDLE

Item	Part No.	Description
50	VS2003DL.05	HANDLE SLEEVE
60	VS2003DL.06	BASE FRAME
70	VS2003DL.07	SAFETY PIN ASSEMBLY

**NOTE:** It is our policy to continually improve products and as such we reserve the right to alter data, specifications and component parts without prior notice.

**IMPORTANT:** No liability is accepted for incorrect use of product.

**WARRANTY:** Guarantee is 12 months from purchase date, proof of which will be required for any claim.

**Sealey Group**, Kempson Way, Suffolk Business Park, Bury St Edmunds, Suffolk. IP32 7AR



01284 757500



01284 703534



sales@sealey.co.uk



www.sealey.co.uk