

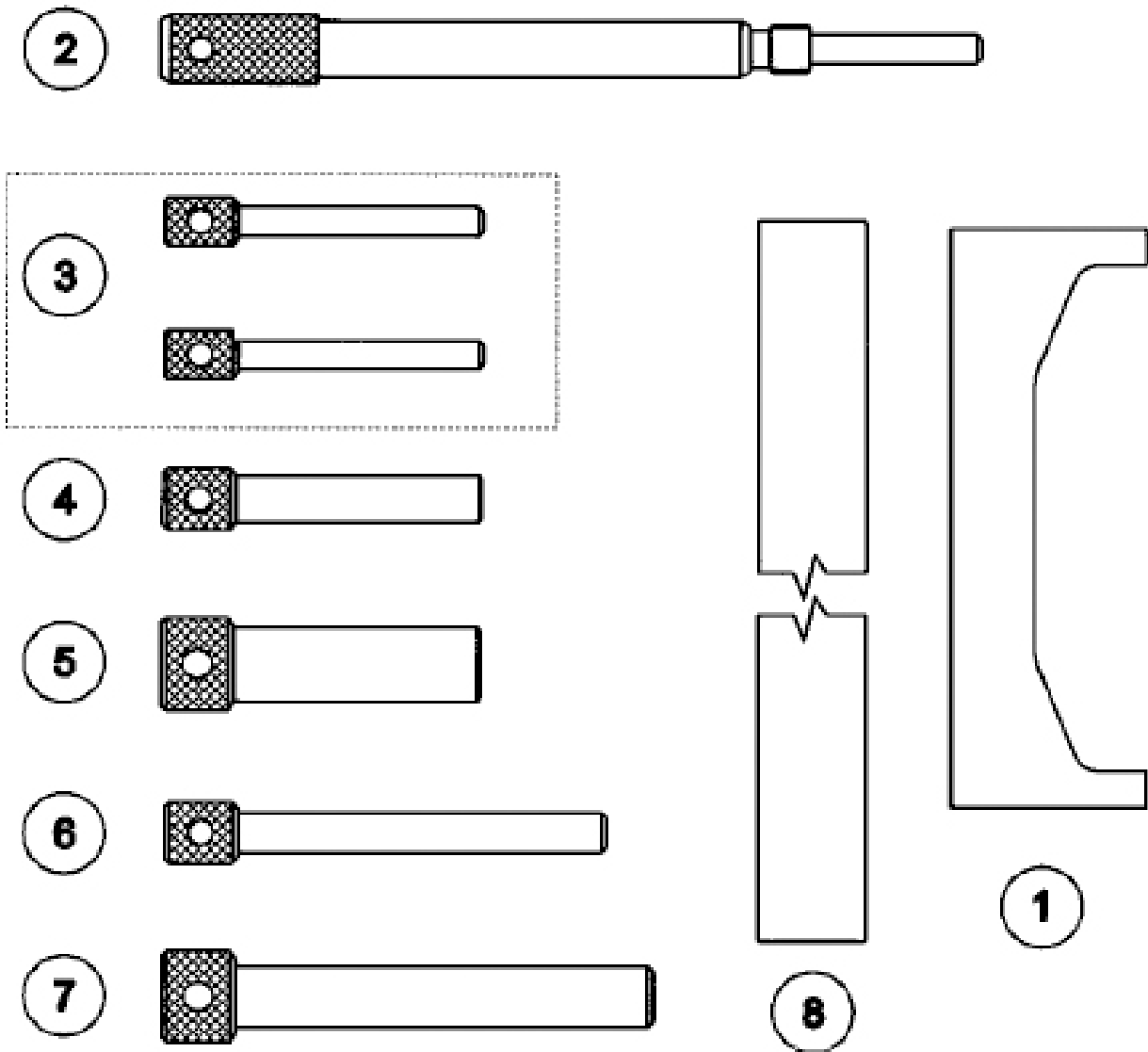

Parts Information:
**Diesel Engine Setting/Locking Kit 1.8D/TD,
 1.9D TDi, 2.5D/T/Tci - Ford/Mazda - Belt
 Drive**
Model No: VS1011



Item	Part No.	Description
1	VS101/1	CAMSHAFT LOCKING TOOL
2	VS101/2	CRANKSHAFT TDC PIN
3	VS101/3	PINS, LOCKING 6.0mm
4	VS101/4	PIN, LOCKING 9.5mm
5	VS101/5	PIN, LOCKING 15.4mm

Item	Part No.	Description
6	VS101/6	PIN, LOCKING 8.25mm
7	VS101/7	PIN, LOCKING 12.7mm
8	VS4933	CAMSHAFT SETTING PLATE
--	VS101/84	NEW CASE & INSERT (NOT SHOWN)
--	VS-TAG	WARNING TAG (NOT SHOWN)

NOTE: It is our policy to continually improve products and as such we reserve the right to alter data, specifications and component parts without prior notice.

IMPORTANT: No liability is accepted for incorrect use of product.

WARRANTY: Guarantee is 12 months from purchase date, proof of which will be required for any claim.

Sealey Group, Kempson Way, Suffolk Business Park, Bury St Edmunds, Suffolk. IP32 7AR



01284 757500



01284 703534



sales@sealey.co.uk



www.sealey.co.uk