

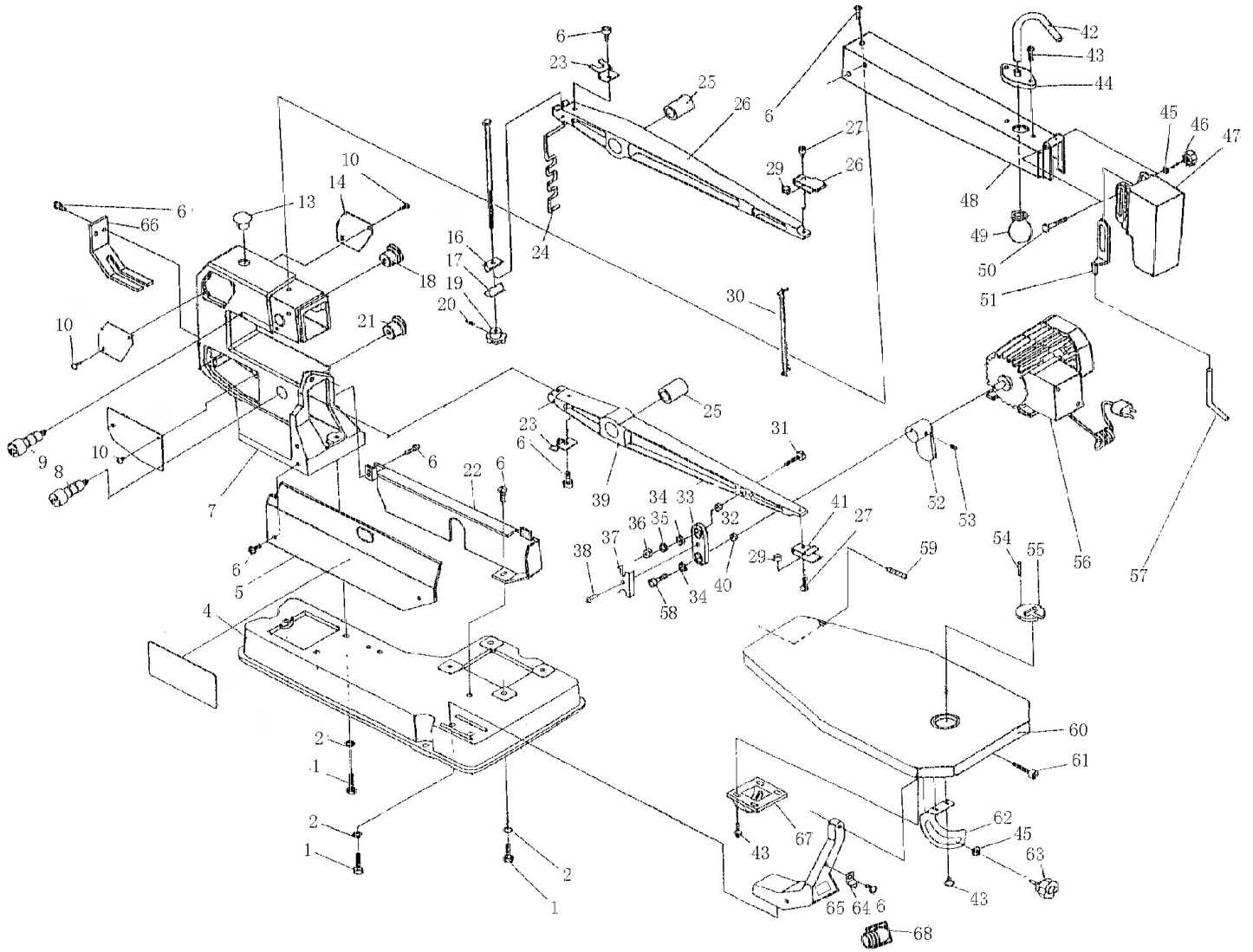

Parts Information:
Scroll Saw 406mm Throat 230V
Model No: SM43.V3



NOTE: It is our policy to continually improve products and as such we reserve the right to alter data, specifications and component parts without prior notice.

IMPORTANT: No liability is accepted for incorrect use of product.

WARRANTY: Guarantee is 12 months from purchase date, proof of which will be required for any claim.

Sealey Group, Kempson Way, Suffolk Business Park, Bury St Edmunds, Suffolk. IP32 7AR



01284 757500



01284 703534



sales@sealey.co.uk



www.sealey.co.uk



Parts Information:
Scroll Saw 406mm Throat 230V
Model No: SM43.V3

Item	Part No.	Description
1	SM43.V2-01	Bolt
2	SM43.V2-02	Washer
4	SM43.V3-04	Base (Blue)
5	SM43.V3-05	Cover, Left (Blue)
6	MSP58.S	Machine Screw Pan Head Phillips m5x8mm (Single)
7	SM43.V3-07	Body (Blue)
8	SM43.V2-08	Pin Shaft
9	SM43.V2-09	Pin Shaft
10	SM43.V2-10	Screw
13	SM43.V2-13	Plug
14	SM43.V2-15	Bolt m6x210
16	SM43.V2-16	Bolster
17	SM43.V2-17	Bolster
18	SM43.V2-18	Plug
19	SM43.V2-19	Locking Knob
20	SM43.V2-20	Pin
21	SM43.V2-21	Plug
22	SM43.V3-22	Cover, Right (Blue)
23	SM43.V2-23	Retainer
24	SM43.V2-24	Spring
25	SM43.V2-25	Bushing
26	SM43.V2-26	Upper Arm
27	SCB520.SB	Socket Head Cap Screw m5x20 Black
--	SM43.V2-28	Upper Blade Holder (NOT SHOWN)
29	SM43.V2-29	Collar
30	SM43B10	Scroll Saw Blade 10tpi Pack Of 12
30	SM43B15	Scroll Saw Blade 15tpi Pack Of 12
30	SM43B20	Scroll Saw Blade 20tpi Pack Of 12
30	SM43B25	Scroll Saw Blade 25tpi Pack Of 12
31	MSP525.S	Machine Screw Pan Head Phillips m5x25mm (Single)
32	SWM5.S	Spring Washer M5 Zinc (Single)
33	SM43.V2-33	Connecting Rod
34	SM43.V2-34	Bushing

Item	Part No.	Description
35	SWM5.S	Spring Washer M5 Zinc (Single)
36	SN5.S	Steel Nut M5 Zinc Din934 (Single)
37	SM43.V2-37	Retainer
38	SM43.V2-38	Screw
39	SM43.V2-39	Lower Arm
40	FWM4.SB	Flat Washer M4 Black (Single)
41	SM43.V2-41	Lower Blade Holder
42	SM43.V2-42	Tubing
43	SM43.V2-43	Screw
44	SM43.V2-44	Pad
45	SM43.V2-45	Washer
46	SM43.V2-46	Nut
47	SM43.V3-47	Blade Guard (Clear)
48	SM43.V3-48	Arm Cover (Blue)
49	SM43.V2-49	Air Diaphragm
50	SM43.V2-50	Bolt m6x60
51	SM43.V2-51	Holder
52	SM43.V2-52	Eccentric
53	SM43.V2-53	Screw
54	SM43.V2-54	Spring Pin
55	SM43.V2-55	Table Insert
56	SM43.V2-56	Motor
57	SM43.V2-57	Brass Tube
58	SM43.V2-58	Screw
59	SM43.V2-59	Screw
60	SM43.V3-60	Table (Blue)
61	SM43.V2-61	Screw
62	SM43.V2-62	Mitre Scale
63	SM43.V2-63	Threaded Knob
64	SM43.V2-64	Indicator
65	SM43.V3-65	Bracket (Blue)
66	SM43.V2-66	Retainer Plate
67	SM43.V2-67	Lower Guard
68	SM43.V3-68	Dust Chute
--	SM1302.72	On/off switch (NOT SHOWN)

NOTE: It is our policy to continually improve products and as such we reserve the right to alter data, specifications and component parts without prior notice.

IMPORTANT: No liability is accepted for incorrect use of product.

WARRANTY: Guarantee is 12 months from purchase date, proof of which will be required for any claim.

Sealey Group, Kempson Way, Suffolk Business Park, Bury St Edmunds, Suffolk. IP32 7AR



01284 757500



01284 703534



sales@sealey.co.uk



www.sealey.co.uk