

SEALEY

Quality MACHINERY

SM352CE BASE DIAGRAM

Original Date: 11/10/96
Issue Date: 11/10/96
Version Number: 0
Date Modified: N/A

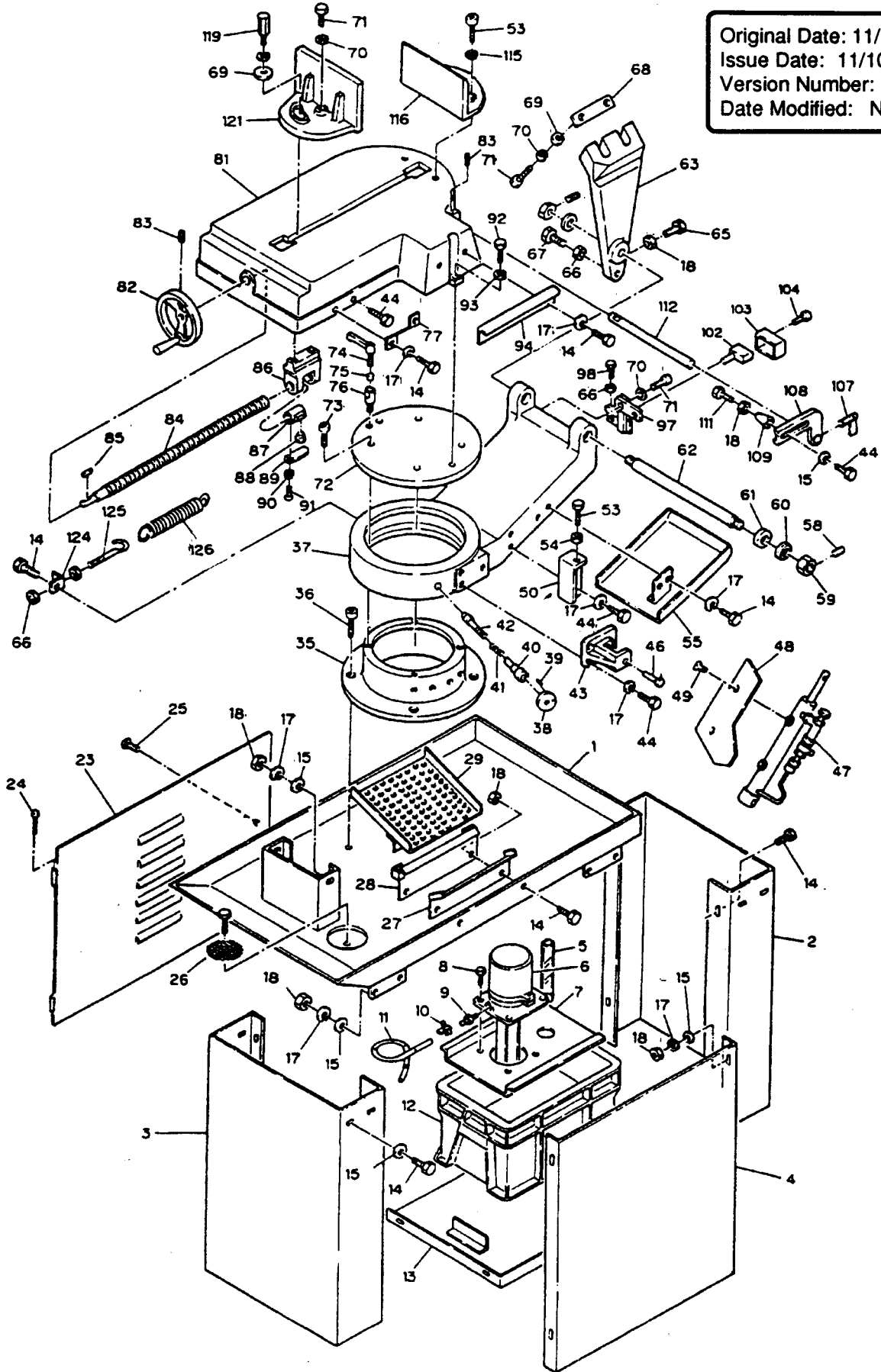

SEALEY

Quality MACHINERY

SEALEY*Quality*
MACHINERY**SM352CE PARTS LIST 1**

| Index no. | Stock Code | Description | Qty |
|-----------|-------------|----------------------|-----|
| 1 | SM352CE/001 | Bottom Dish | 1 |
| 2 | SM352CE/002 | Right Floor Stand | 1 |
| 3 | SM352CE/003 | Left Floor Stand | 1 |
| 4 | SM352CE/004 | Side Panel | 1 |
| 5 | SM352CE/005 | Hose | 1 |
| 6 | SM352CE/006 | Cooling Pump | 1 |
| 7 | SM352CE/007 | Tank Cover | 1 |
| 8 | SM352CE/008 | Hex Head Screw | 4 |
| 9 | SM352CE/009 | Pump Connector | 1 |
| 10 | SM352CE/010 | Hose Clamp | 1 |
| 11 | SM352CE/011 | Hose | 1 |
| 12 | SM352CE/012 | Tank | 1 |
| 13 | SM352CE/013 | Shelf | 1 |
| 14 | SM352CE/014 | Hex Head Screw | 24 |
| 15 | SM352CE/015 | Washer | 23 |
| 17 | SM352CE/017 | Spring Washer | 36 |
| 18 | SM352CE/018 | Nut | 22 |
| 23 | SM352CE/023 | Door | 1 |
| 24 | SM352CE/024 | Pin | 1 |
| 25 | SM352CE/025 | Lock Knob | 1 |
| 26 | SM352CE/026 | Filter | 1 |
| 27 | SM352CE/027 | Bracket | 1 |
| 28 | SM352CE/028 | Bracket | 1 |
| 29 | SM352CE/029 | Chip Guide Plate | 1 |
| 35 | SM352CE/035 | Low Base of Disc | 1 |
| 36 | SM352CE/036 | Hex Socket Cap Screw | 4 |
| 37 | SM352CE/037 | Swivel Base | 1 |
| 38 | SM352CE/038 | Adjustable Handle | 1 |
| 39 | SM352CE/039 | Key | 1 |
| 40 | SM352CE/040 | Thrust Shaft | 1 |
| 41 | SM352CE/041 | Spring | 1 |
| 42 | SM352CE/042 | Disc Thrust Shaft | 1 |
| 43 | SM352CE/043 | Bottom Support | 1 |
| 44 | SM352CE/044 | Hex Head Screw | 12 |
| 46 | SM352CE/046 | Support Rod | 1 |
| 47 | SM352CE/047 | Hydraulic Cylinder | 1 |
| 48 | SM352CE/048 | Cylinder Cover | 1 |
| 49 | SM352CE/049 | Round Head Screw | 2 |
| 50 | SM352CE/050 | Support Plate | 1 |
| 53 | SM352CE/053 | Hex Head Screw | 2 |
| 54 | SM352CE/054 | Nut | 1 |
| 55 | SM352CE/055 | Splash Guard | 1 |
| 58 | SM352CE/058 | Set Screw | 3 |
| 59 | SM352CE/059 | Nut | 2 |
| 60 | SM352CE/060 | Washer | 2 |

| Index no. | Stock Code | Description | Qty |
|-----------|-------------|----------------------|-----|
| 61 | SM352CE/061 | Nut | 1 |
| 62 | SM352CE/062 | Support Shaft | 1 |
| 63 | SM352CE/063 | Pivot Arm | 1 |
| 65 | SM352CE/065 | Hex Head Screw | 1 |
| 66 | SM352CE/066 | Nut | 3 |
| 67 | SM352CE/067 | Hex Head Screw | 1 |
| 68 | SM352CE/068 | Plate | 1 |
| 69 | SM352CE/069 | Washer | 6 |
| 70 | SM352CE/070 | Spring Washer | 9 |
| 71 | SM352CE/071 | Hex Head Screw | 3 |
| 72 | SM352CE/072 | Upper Swivel Disc | 1 |
| 73 | SM352CE/073 | Hex Socket Cap Screw | 4 |
| 74 | SM352CE/074 | Lock Handle | 1 |
| 75 | SM352CE/075 | Bronze Bushing | 1 |
| 76 | SM352CE/076 | Thrust Shaft | 1 |
| 77 | SM352CE/077 | Bracket | 1 |
| 81 | SM352CE/081 | Table | 1 |
| 82 | SM352CE/082 | Handle Wheel Assy | 1 |
| 83 | SM352CE/083 | Set Screw | 2 |
| 84 | SM352CE/084 | Lead Screw | 1 |
| 85 | SM352CE/085 | Key, 5mm | 1 |
| 86 | SM352CE/086 | Lead Screw Bracket | 1 |
| 87 | SM352CE/087 | Acme Nut | 1 |
| 88 | SM352CE/088 | Button | 1 |
| 89 | SM352CE/089 | Retainer | 1 |
| 90 | SM352CE/090 | Spring Washer | 1 |
| 91 | SM352CE/091 | Round Head Screw | 1 |
| 92 | SM352CE/092 | Hex Socket Cap Screw | 2 |
| 93 | SM352CE/093 | Spring Washer | 2 |
| 94 | SM352CE/094 | Top Support Bracket | 1 |
| 97 | SM352CE/097 | 90° Cutting Support | 1 |
| 98 | SM352CE/098 | Hex Head Screw | 1 |
| 102 | SM352CE/102 | Limit Switch | 1 |
| 103 | SM352CE/103 | Limit Switch Box | 1 |
| 104 | SM352CE/104 | Hex Head Screw | 4 |
| 107 | SM352CE/107 | Knob | 1 |
| 108 | SM352CE/108 | Stop Bracket | 1 |
| 109 | SM352CE/109 | Thumb Screw | 1 |
| 111 | SM352CE/111 | Hex Head Screw | 1 |
| 112 | SM352CE/112 | Stop Rod | 1 |
| 115 | SM352CE/115 | Spring Washer | 1 |
| 116 | SM352CE/116 | Rear Vice | 1 |
| 119 | SM352CE/119 | Vice Screw | 1 |
| 121 | SM352CE/121 | Front Vice | 1 |

SEALEY*Quality*
MACHINERY

SEALEY

Quality MACHINERY

SM352CE ARM DIAGRAM

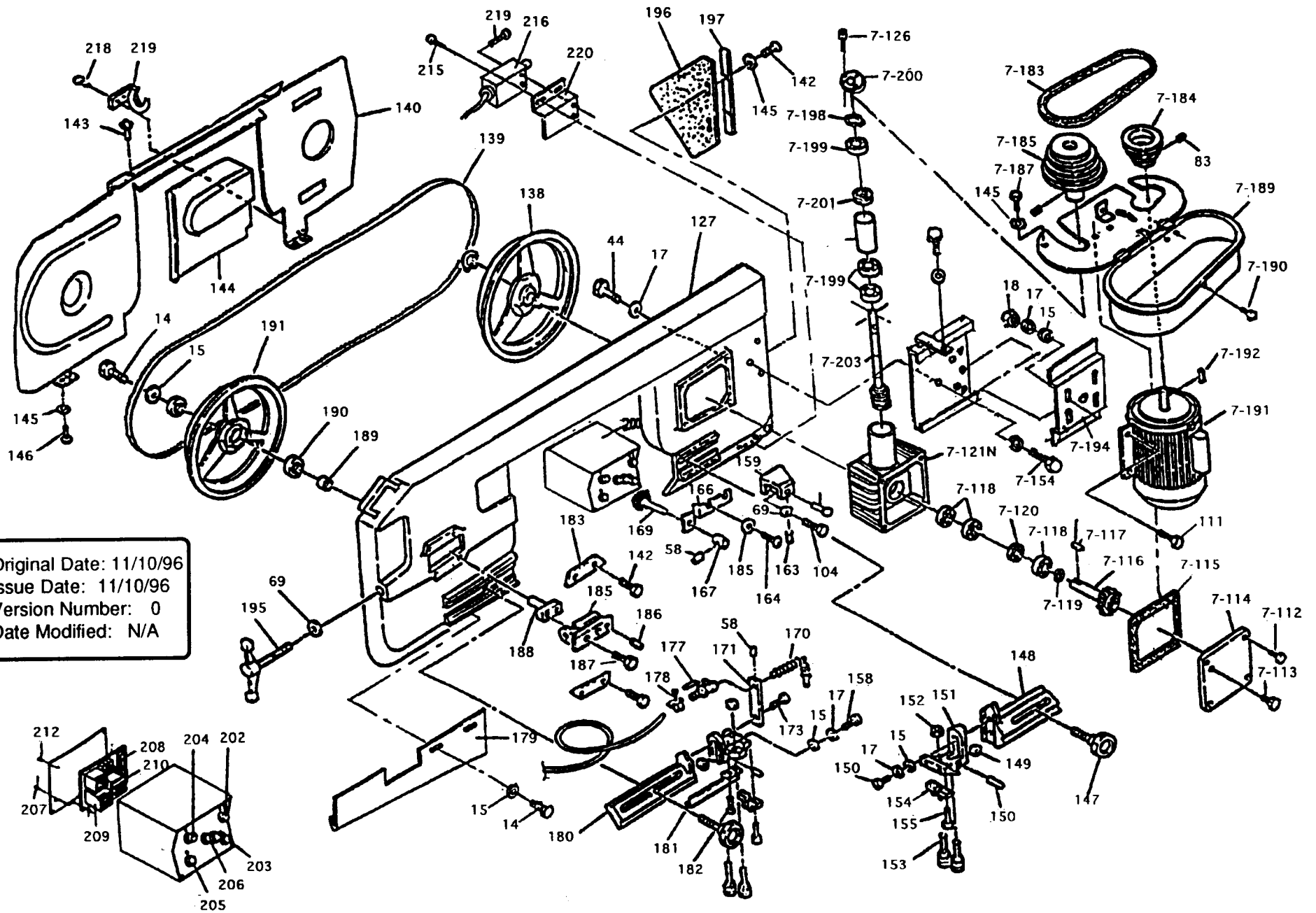

Original Date: 11/10/96
Issue Date: 11/10/96
Version Number: 0
Date Modified: N/A



SM352CE PARTS LIST 2

| Index | | | |
|-------|-------------|-----------------------|-----|
| no. | Stock Code | Description | Qty |
| 124 | SM352CE/124 | Spring Bracket | 1 |
| 125 | SM352CE/125 | Spring Adjust Rod | 1 |
| 126 | SM352CE/126 | Spring | 1 |
| 127 | SM352CE/127 | Saw Bow | 1 |
| 128 | SM352CE/128 | Hex Head Screw | 4 |
| 130 | SM352CE/130 | Gear Reducing Motor | 1 |
| 131 | SM352CE/131 | Key | 1 |
| 132 | SM352CE/132 | Motor Connect Plate | 1 |
| 134 | SM352CE/134 | C-Ring | 1 |
| 135 | SM352CE/135 | C-Ring | 3 |
| 138 | SM352CE/138 | Rear Blade Wheel | 1 |
| 139 | SM352CE/139 | Bandsaw Blade | 1 |
| 140 | SM352CE/140 | Blade Back Cover | 1 |
| 141 | SM352CE/141 | Limit Switch Top Tip | 1 |
| 142 | SM352CE/142 | Hex Head Screw | 5 |
| 143 | SM352CE/143 | Plum Screw | 2 |
| 144 | SM352CE/144 | Wheel Cover | 1 |
| 145 | SM352CE/145 | Washer | 10 |
| 146 | SM352CE/146 | Pan Head Screw | 4 |
| 147 | SM352CE/147 | Guide Adjust Knob | 2 |
| 148 | SM352CE/148 | Rear Adjust Bracket | 1 |
| 150 | SM352CE/150 | Bearing Pin | 2 |
| 151 | SM352CE/151 | Blade Adjusting Seat | 1 |
| 152 | SM352CE/152 | Nut | 4 |
| 153 | SM352CE/153 | Eccentric Shaft Ass'y | 4 |
| 154 | SM352CE/154 | Blade Guide | 4 |
| 155 | SM352CE/155 | Hex Socket Cap Screw | 4 |

| Index | | | |
|-------|-------------|-------------------------|-----|
| no. | Stock Code | Description | Qty |
| 158 | SM352CE/158 | Hex Socket Cap Screw | 3 |
| 159 | SM352CE/159 | Top Support | 1 |
| 160 | SM352CE/160 | Hex Socket Cap Screw | 1 |
| 163 | SM352CE/163 | Set Screw | 1 |
| 164 | SM352CE/164 | Pan Head Screw | 2 |
| 166 | SM352CE/166 | Brush Holder | 1 |
| 167 | SM352CE/167 | Fixed Bushing | 1 |
| 173 | SM352CE/173 | Hex Socket Cap Screw | 1 |
| 177 | SM352CE/177 | Valve | 1 |
| 178 | SM352CE/178 | Hose Clamp | 2 |
| 180 | SM352CE/180 | Front Adjust Bracket | 1 |
| 181 | SM352CE/181 | Blade Guard | 1 |
| 182 | SM352CE/182 | Round Head Screw | 2 |
| 183 | SM352CE/183 | Sliding Guide Plate | 2 |
| 185 | SM352CE/185 | Tension Slide Block | 1 |
| 186 | SM352CE/186 | Set Screw | 1 |
| 189 | SM352CE/189 | Bearing Bushing | 1 |
| 191 | SM352CE/191 | Front Blade Wheel | 1 |
| 195 | SM352CE/195 | Adjustable Handle | 1 |
| 196 | SM352CE/196 | Support Plate | 1 |
| 197 | SM352CE/197 | Fixed Plate | 1 |
| 215 | SM352CE/215 | Round Head Screw | 4 |
| 216 | SM352CE/216 | Limit Switch | 1 |
| 217 | SM352CE/217 | Round Head Screw | 2 |
| 219 | SM352CE/219 | Limit Switch Stop Plate | 1 |
| 220 | SM352CE/220 | Limit Switch Bracket | 1 |
| S | SM352CE/S | Complete Switch Ass'y | 1 |

