

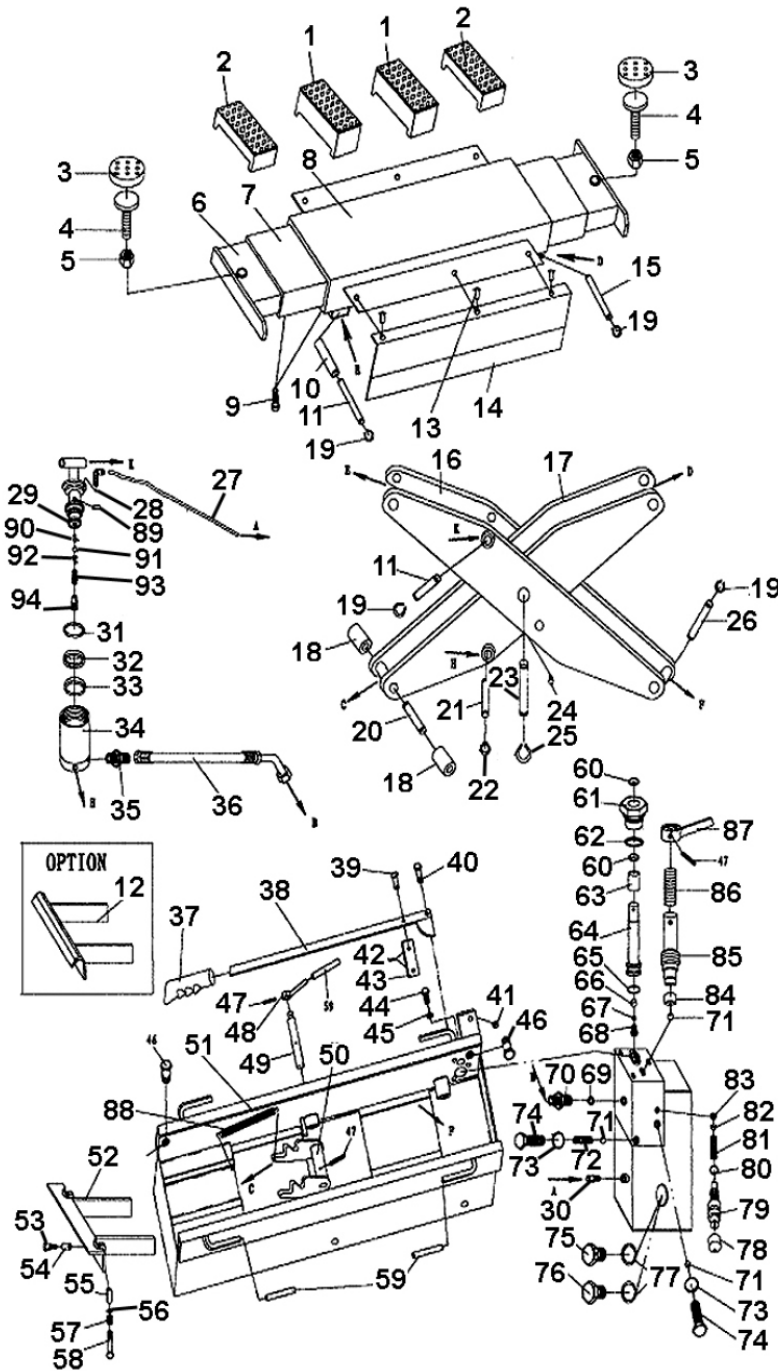

Parts Information:  
**Jacking Beam Yankee 2tonne with Arm  
 Extenders & Flat Roller Supports**  
**Model No: SJBEX200**



Item	Part No.	Description
1	SJBEX200.2-01	Aluminium Saddle 1 (Single)(Large)
2	SJBEX200.2-02	Aluminium Saddle 2 (Single)(Small)
3	SJBEX200.2-03	Rubber Saddle Cover
4	SJBEX200.2-04	Threaded Saddle
5	SN24.SB	Steel Nut M24 Black
6	SJBEX200.06	Adjustable Beam
7	SJBEX200.07	Adjustable Beam

Item	Part No.	Description
8	SJBEX200.2-08	Lifting Beam
9	SJBEX200.2-09	Screw
10	SJBEX200.2-10	Shaft Bushing (Length 98mm,o/d 36.5mm)
11	SJBEX200.2-11	Shaft (Length 130mm,o/d 19mm)
12	SJBEX200.2-12	Hook End Mounting
13	MSP68.S	Machine Screw Pan Head Phillips M6 X 8mm
14	SJBEX200.2-14	Protective Plate

**NOTE:** It is our policy to continually improve products and as such we reserve the right to alter data, specifications and component parts without prior notice. There may be alternative versions of this product, please contact us should you require this information.

**IMPORTANT:** No liability is accepted for incorrect use of product. Spare parts must be fitted by a competent person

**WARRANTY:** Guarantee is 12 months from purchase date, proof of which will be required for any claim.

Sealey Group, Kempson Way, Suffolk Business Park, Bury St Edmunds, Suffolk. IP32 7AR



01284 757500



01284 703534



sales@sealey.co.uk



www.sealey.co.uk



Parts Information:  
**Jacking Beam Yankee 2tonne with Arm  
 Extenders & Flat Roller Supports**  
**Model No: SJBEX200**

Item	Part No.	Description
15	SJBEX200.2-15	Shaft (Length 110mm,o/d 19mm)
16	SJBEX200.16	Outer Scissors Arm
17	SJBEX200.17	Inner Scissors Arm
18	SJBEX200.2-18	Shaft Bushing (Length 55mm,o/d 38.5mm,i/d 20mm)
19	3015CXD.01	External Circlip 16.3mm ID.
20	SJBEX200.2-20	Shaft (Length 210mm,o/d 19mm)
21	SJBEX200.21	Shaft
22	SJBEX200.22	Retaining Ring
23	SJBEX200.2-23	Shaft (Length 132mm,o/d 25mm)
24	SJBEX200.2-24	Oil Inlet
25	3015CXD.11	External Circlip 16.3mm ID.
26	SJBEX200.2-26	Shaft (Length 235mm,o/d 19mm)
27	SJBEX200.27	Pu Pipe
28	SJBEX200.28	Connector
29	SJBEX200.29	Piston
30	SJBEX200.30	Connector
31	SJBEX200.31	O-Ring
32	SJBEX200.2-32	Retaining Ring
33	SJBEX200.2-33	Seal 53*63*6
34	SJBEX200.34	Cylinder
35	SJBEX200.35	Connector
36	SJBEX200.36	Oil Pipe (340mm Long c/w 45 Degree Fitting)
37	SJBEX200.37	Handle Grip
38	SJBEX200.38A	Handle
39	SJBEX200.2-39	Pin Shaft
40	HHB845.S	Hex Head Bolt M8 x 45mm
41	SN8.S	Steel Nut M8 Zinc
42	BTR4.V2-10	Cotter Pin M2 x 25
43	SJBEX200.2-43	Block
44	SS812.S	Hex Head Set Screw M8 X 12 Zinc
45	FWM8.S	Flat Washer M8 Zinc
46	SS1225.S	Hex Head Set Screw M12 X 25 Zinc
47	SJBEX200.2-47	Spring Pin M4.4 X 25
48	SJBEX200.48	Handle Knob
49	SJBEX200.49	Shaft (Length 240mm,o/d 19mm)
50	SJBEX200.2-50	Safety Lock
51	SJBEX200.2-51	Chassis
52	SJBEX200.52	Flat-End Mounting
53	SJBEX200.2-53	Screw
54	SJBEX200.2-54	Bushing
55	SJBEX200.2-55	Block
56	SJBEX200.2-56	Washer

Item	Part No.	Description
57	SJBEX200.2-57	Spring Dia13.8mm
58	HHB865.S	Hex Head Bolt M8 x 65mm
59	SJBEX200.2-59	Handle Grip
60	SJBEX200.2-60	Seal Blue (12*18*6)
61	SJBEX200.2-61	Pump Housing
62	SJBEX200.2-62	Seal Washer
63	SJBEX200.2-63	Copper Bushing
64	SJBEX300.64A	Piston Complete
65	SJBEX200.2-65	Seal Ring
66	SJBEX200.66	Liner
67	SB-5.0	Steel Ball 5.0mm
68	SJBEX200.68	Screw
69	SJBEX200.69	Seal Washer
70	SJBEX200.70	Connector
71	SB-6.4	Steel Ball 6.4mm
72	SJBEX200.72	Spring Dia 5.1mm
73	SJBEX200.2-73	Seal Washer
74	SS1025.SB	Hex Head Set Screw M10 X 25 Black
75	SJBEX200.2-75	Air Vent Valve
76	SJBEX200.2-76	Screw
77	SJBEX200.77	O-Ring
78	SJBEX200.2-78	Cover
79	SJBEX200.79	Adjustment Screw
80	SJBEX200.2-80	O-Ring, (Ex: 12.45 In: 6.96 Cs: 2.75)
81	SJBEX200.2-81	Spring Dia 7.4mm
82	SJBEX200.2-82	Spring Guide
83	SB-5.6	Steel Ball 5.6mm
84	SJBEX200.2-84	Seal Washer
85	SJBEX200.2-85	Release Rod
86	SJBEX200.2-86	Spring Dia 17.2mm
87	SJBEX300.87	Lever, Release, M14 Castle Nut Fitting
88	SJBEX200.2-88	Spring Dia 12.8mm
89	SJBEX200.89	Pin
90	SJBEX200.90	Pin
91	SB-7.0	Steel Ball 7mm
92	SJBEX200.92	Spring Guide
93	SJBEX200.93	Spring Dia 6.2mm
94	SJBEX200.94	Screw
--	SJBEX200.PUMP	Pump For SJBEX200 (Not Shown)
--	SJBEX200.RAM	Ram For SJBEX200 (Not Shown)
--	SJBEX200.SK	Seal Kit (Not Shown)
--	SJBEX200.2-99	Complete Pump Unit (Not Shown)
--	SS850.SB	Hex Head Set Screw M8 X 50 (Not Shown)

**NOTE:** It is our policy to continually improve products and as such we reserve the right to alter data, specifications and component parts without prior notice. There may be alternative versions of this product, please contact us should you require this information.

**IMPORTANT:** No liability is accepted for incorrect use of product. Spare parts must be fitted by a competent person

**WARRANTY:** Guarantee is 12 months from purchase date, proof of which will be required for any claim.

**Sealey Group**, Kempson Way, Suffolk Business Park, Bury St Edmunds, Suffolk. IP32 7AR



01284 757500



01284 703534



sales@sealey.co.uk



www.sealey.co.uk