

SG11/12 SANDBLASTING GUNS

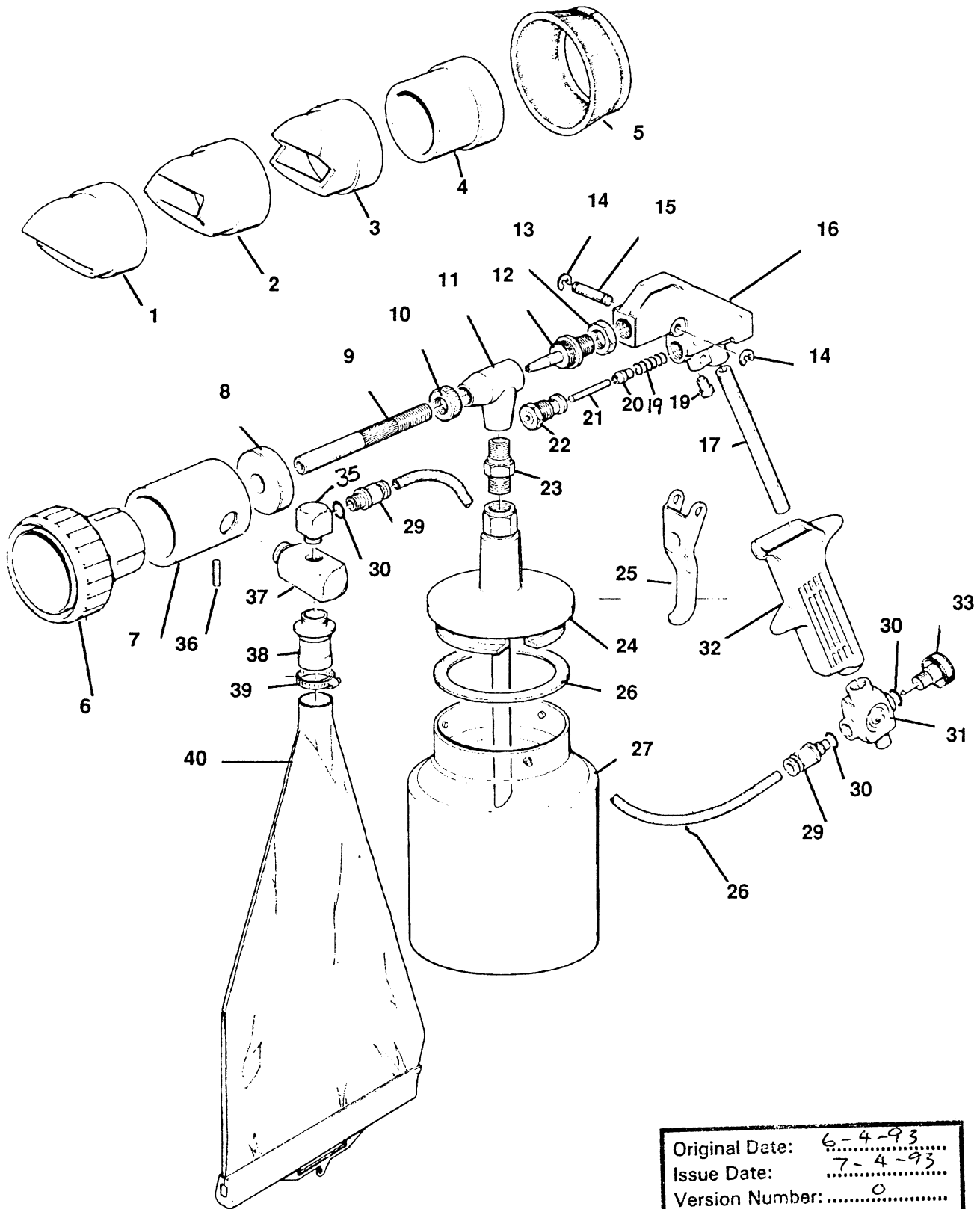

Original Date:	6-4-93
Issue Date:	7-4-93
Version Number:	0
Date Modified:	

PARTS LIST FOR SG11/12

Original Date:	6-4-93
Issue Date:	7-4-93
Version Number:	0
Date Modified:

POS	PART NUMBER	DESCRIPTION
1	131/20201715393	Adaptor, Large
2	131/20201715293	Adaptor, Internal Angles
3	131/20201715193	Adaptor, External Angles
4	131/20201715093	Adaptor, Plain
5	131/20201705096	Adaptor, Brush
6	131/20201691090	Sleeve, Adaptors
7	131/20201687190	Housing, Sleeve, Adaptors
8	131/20201687083	Ring, Housing
9	131/20201682394	Tube, Outlet <i>SAND NOZZLE 6mm</i>
10	131/20201684001	Ring Nut, Outlet Tube
11	131/20201588083	Connection
12	131/20201593000	Nozzle, Air Outlet
13	131/20201680001	Lock Nut, Air Outlet Nozzle
14	131/20100547094	Circlip
15	131/20100545094	Stud, Trigger Retaining
16	131/20201387083	Body
17	131/20100529083	Air Tube, Handle
18	131/20100519001	Screw, Air Control
19	131/20201313094	Spring, Air Valve
20	131/20201315090	Air Valve
21	131/20201309001	Rod, Air Valve
22	131/20201311001	Body, Air Valve
23	131/20201595001	Connection
24	131/20100811000	Lid c/w Riser Tube (pot with indentations)
25	131/20201768094	Trigger
26	131/20100818090	Gasket, Lid (synthetic)
27	131/20100817083	Tank, 1000cc
28*	131/20100633070	Tube, Air Recirculation
29*	131/20100631001	Connection
30*	131/20100629093	O-Ring
31*	131/20100628011	Tap, Three Way
32	131/20100535090	Handle
33*	131/20100629001	Knob, Recirculating Air Control
35*	131/20201695001	Connection
36	131/20201693094	Grub Screw
37*	131/20201697094	Connection
38*	131/20201699001	Connector, Bag
39*	131/20201703094	Jubilee Clip
40*	131/20201701096	Sand Return Bag

Parts marked * are standard on SG12 only

