

SG100DZ ELECTRIC ANGLE GRINDER

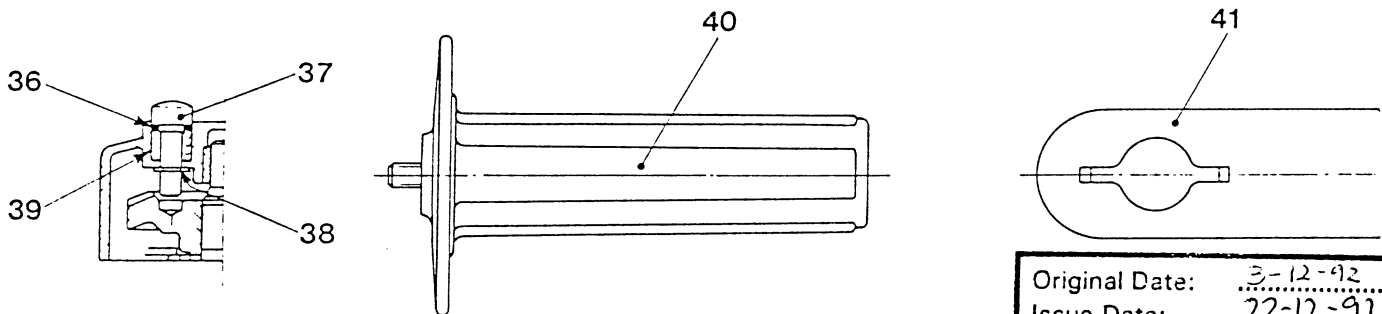
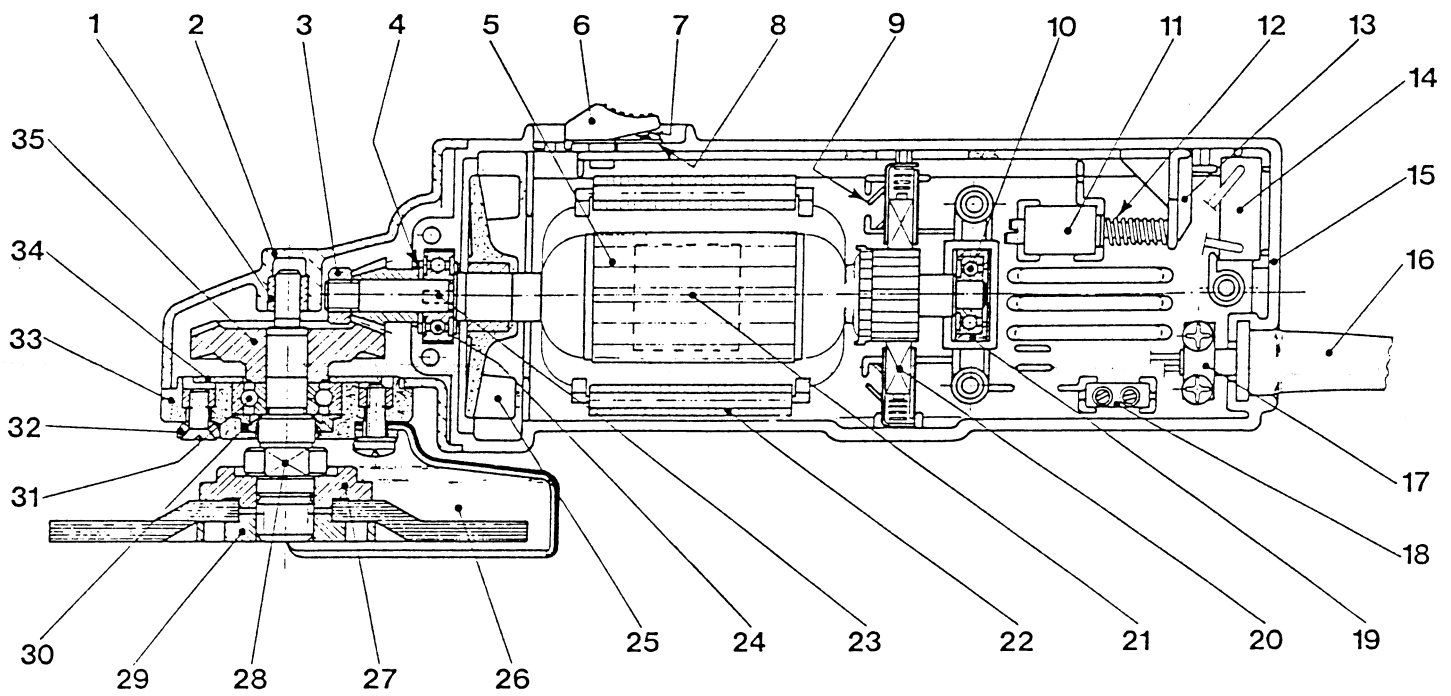

Original Date:	3-12-92
Issue Date:	22-12-92
Version Number:	C
Date Modified:	

NO.	PART NO.	DESCRIPTION
1	126/20200600	Bronze Bush
2	126/24500970	Gear Box
3	126/11400080	Nut
4	126/24500570	Washer
5	126/81400000	Armature
6	126/24300520	Switch Button
7	126/24100620	Spring
8	126/24100570	Plate
9	126/34500630	Brush Holder
10	B/607 Z	Bearing 607Z
11	126/24100540	Switch
12	126/24100550	Spring
13	126/24100521	Switch Button Lever
14	126/24553000	Condensor
15	126/24500990	Casing Complete
16	126/33500570	Cable Sleeve
17	126/10200581	Cable Clamp
18	126/2150690	Connecting Block
19	126/20200570	Bearing Cup
20	126/30300900	Carbon Brush Set
21	126/24500580	Rubber Block
22	126/49100000	Field Coil
23	126/35200550	Grommet

NO.	PART NO.	DESCRIPTION
24	B/608ZZ	Bearing 608ZZ
25	126/20781000	Fan
26	126/20200610	Guard
27	126/21600830	Backing Flange
28	126/20700631	Spindle
29	126/21600840	Locking Nut
30	126/24500530	Spacer
31	B/6000	Bearing 6000
32	126/20500141	Clamping Plate
33	126/20700511	Gear Box Cover
34	126/20700550	Clamp Plate
35	126/24500980	Gear Set
36	126/52500810	Rubber Ring
37	126/24500540	Gear Lock Pin
38	126/13100050	Circlip
39	126/24500550	Spring
40	126/20700670	Side Handle
41	126/24100630	Disc / Pin Spanner
-	PTC/100C	100 mm Cutting Disc
-	PTC/100G	100 mm Grinding Disc



SEALEY QUALITY MACHINERY
BURY St. EDMUNDS, SUFFOLK