

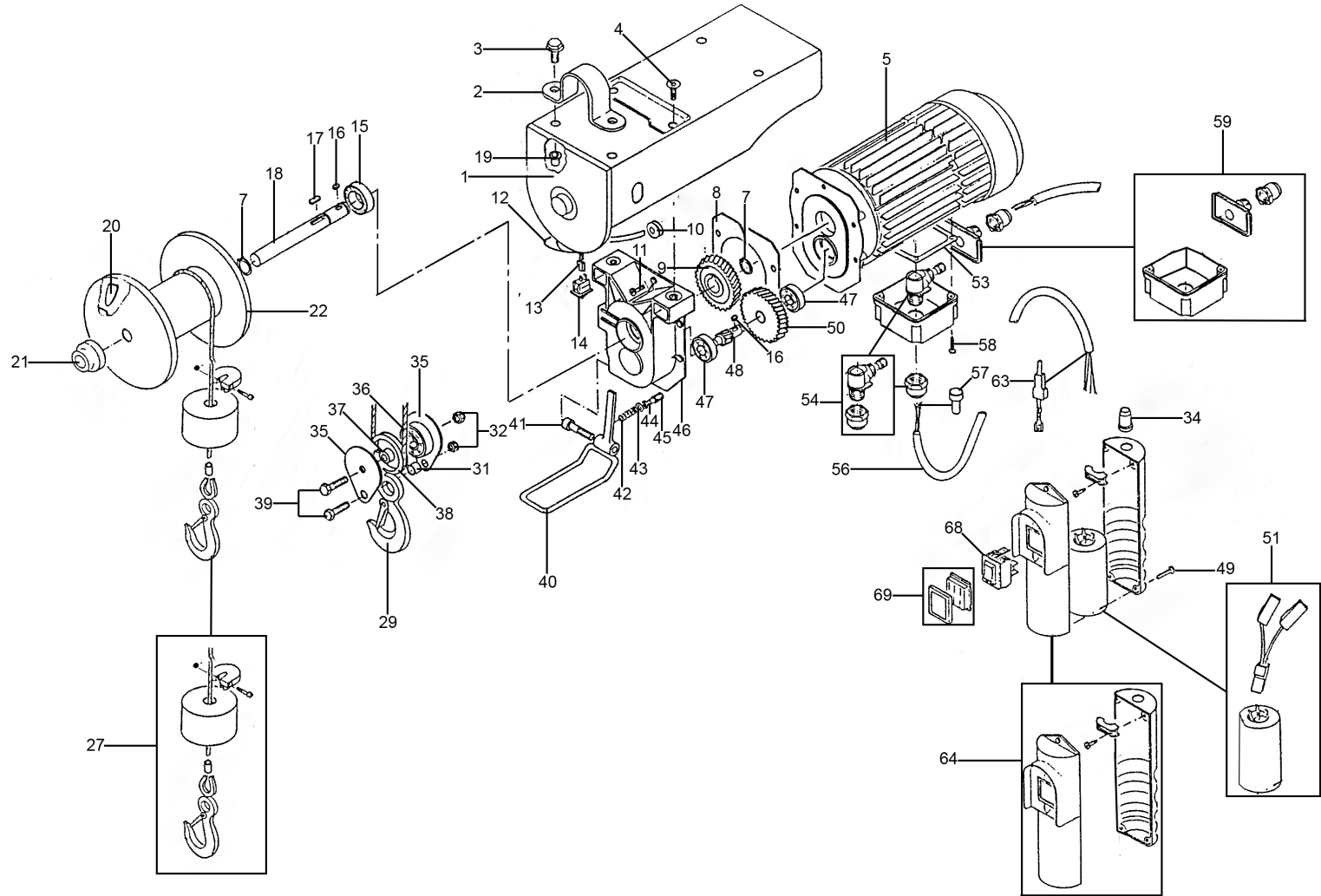

Parts Information:
Power Hoist 230V/1ph 250kg Capacity
Model No: PH250.V2



NOTE: It is our policy to continually improve products and as such we reserve the right to alter data, specifications and component parts without prior notice.

There may be alternative versions of this product, please contact us should you require this information.

IMPORTANT: No liability is accepted for incorrect use of product. Spare parts must be fitted by a competent person

WARRANTY: Guarantee is 12 months from purchase date, proof of which will be required for any claim.

Sealey Group, Kempson Way, Suffolk Business Park, Bury St Edmunds, Suffolk. IP32 7AR



01284 757500



01284 703534



sales@sealey.co.uk



www.sealey.co.uk



Parts Information:
Power Hoist 230V/1ph 250kg Capacity
Model No: PH250.V2

Item	Part No.	Description
1	PH250.V2/01	Casing (c/w Inserts)
2	PH250.V2/02	Support Bracket
3	PH250.V2/03	Hex-Head Screw (c/w Washer)
4	PH250.V2/04	HSFHC Screw M8 x 20mm
5	PH250.V2/05	Motor
7	PH250.V2/07	Snap Ring
8	PH250.V2/08	Gasket, Reducer Guard
9	PH250.V2/09	Wheel, Gear 1
10	PH250.V2/10	Grommet
11	PH250.V2/11	Screw, Trilobate M5 x 15mm
12	PH250.V2/12	Limit Switch, Relay Cable
13	PH250.V2/13	Cable
14	PH250.V2/14	Button, Limit Switch
15	B/6202ZZ	Bearing
16	PH250.V2/16	Key
17	PH250.V2/17	Key
18	PH250.V2/18	Shaft, Drum
19	PH250.V2/19	Steel Insert
20	PH250.V2/20	Locking Key, Steel Rope
21	PH250.V2/21	Bush, Nylon
22	PH250.V2/22	Drum
27	PH250.V4-10	Wire Rope Assembly
29	PH250.V2/29	Safety Hook
31	PH250.V2/31	Bushing
32	SN8.S	Steel Nut M8
34	PH250.V2/34	Cable Guide, Control Unit
35	PH250.V2/35	Bracket, Pulley
36	B/6203ZZ	Bearing
37	PH250.V2/37	Pulley
38	PH250.V2/38	Bushing, Brass
39	PH250.V2/39	Screw, Hex-Head M8 x 20mm

Item	Part No.	Description
40	PH250.V2/40	Bracket, Height Adjustment
41	PH250.V2/41	Fastening Screw, Bracket
42	PH250.V2/42	Return Spring, Bracket
43	PH250.V2/43	Toothed Washer M6
44	SN5.S	Steel Nut M5 Zinc
45	PH250.V2/45	Milled Screw M6 x 29mm
46	PH250.V2/46	Guard, Reducer
47	B/6200Z	Bearing
48	PH250.V2/48	Driving Pin, Toothed
49	PH250.V2/49	Screws
50	PH250.V2/50	Wheel, Gear 2
51	PH250.V2/51	Capacitor
53	PH250.V2/53	Seal
54	PH250.V2/54-5	Cable Gland
56	PH250.V2/56	Cable, Control Unit Switch
57	PH250.V2/57	End Connector
58	PH250.V2/58	Screw
59	PH250.V2/59	Terminal Box
63	PH250.V2/63	Insulator
64	PH250.V2/64-7	Control Unit Assembly
68	PH250.V3-67	Switch, Rocker
69	PH250.V2/69	Cover, Switch
--	PH250.V2/23	Hex Nut M4 (Not Shown)
--	PH250.V2/24	Shackle, Nylon (Not Shown)
--	PH250.V2/25	Hex Skt Head Screw M4 x 20mm (Not Shown)
--	PH250.V2/26	Counterweight (Not Shown)
--	PH400.09	Clip, Fixed (Not Shown)
--	PH400.12	Protector (Not Shown)
--	PH250.V2/62	Cable, Power Supply (Not Shown)
--	PH250.V2/65	Screw, Cross Head (Not Shown)

NOTE: It is our policy to continually improve products and as such we reserve the right to alter data, specifications and component parts without prior notice. There may be alternative versions of this product, please contact us should you require this information.

IMPORTANT: No liability is accepted for incorrect use of product. Spare parts must be fitted by a competent person

WARRANTY: Guarantee is 12 months from purchase date, proof of which will be required for any claim.

Sealey Group, Kempson Way, Suffolk Business Park, Bury St Edmunds, Suffolk. IP32 7AR



01284 757500



01284 703534



sales@sealey.co.uk



www.sealey.co.uk