

Parts Information:
Panel Stand - Door, Wing, Bonnet & Bumper
Model No: MK51.V3

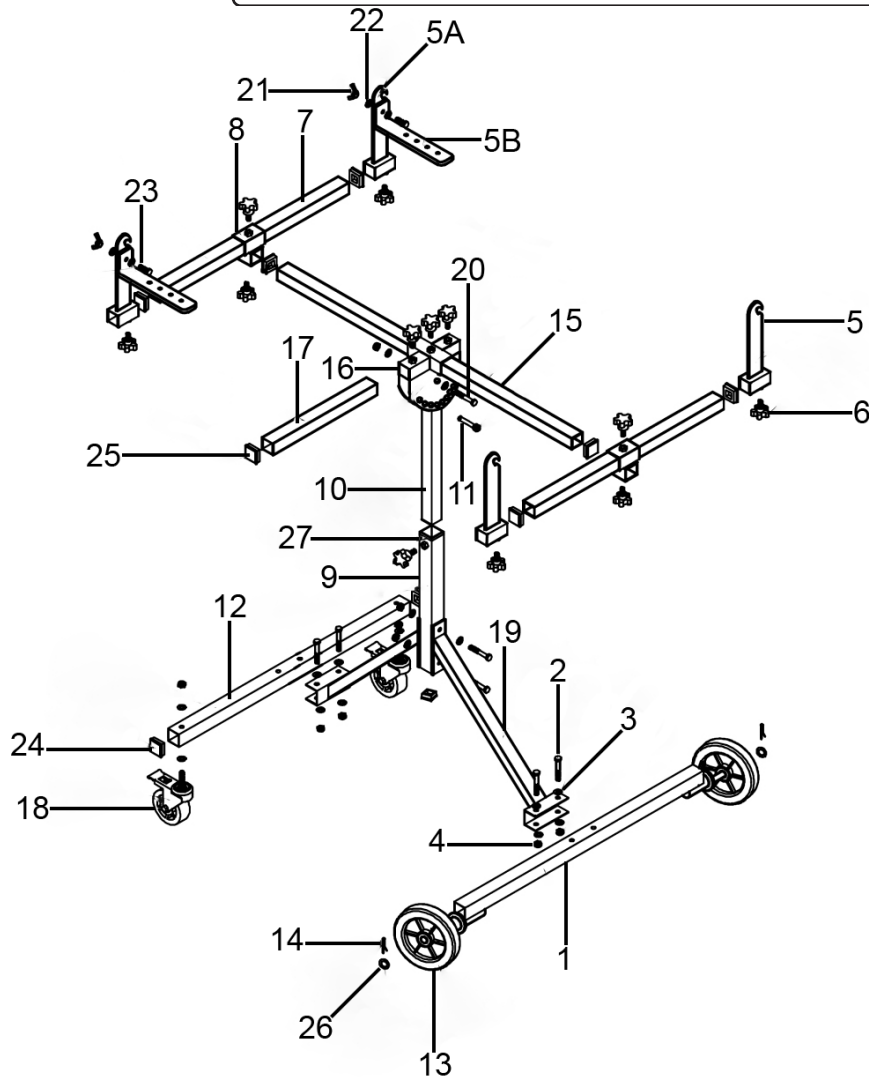

Item	Part No.	Description
1	MK51.V3-01	Base Frame, Wheel
2	SS1065.S	Hex Head Set Screw M10 x 65mm
3	FWM10.S	Flat Washer M10
4	NLN10.S	Nyloc Nut M10
5	MK51.V3-05	Hook
5A	MK51.V3-05A	Hook
5B	MK51.V3-05B	Bracket
6	IR1000STV2.12	Knob Screw
7	MK51.V3-07	Side Bracket, Upper
8	MK51.V3-08	Adaptor
9	MK51.V3-09	Base Frame, Upright
10	MK51.V3-10	Extension, Upright Tube
11	MK51.V3-11	Lock Pin
12	MK51.V3-12	Base Frame, Castor
13	MK51.V3-13	Wheel, Fixed (c/w Bushing)

Item	Part No.	Description
14	MK51.V3-14	Split Pin
15	MK51.V3-15	Cross Stand Tube
16	MK51.V3-16	Adjustable Angle Bracket
17	MK51.V3-17	Handle
18	MK51.V3-18	Wheel, Swivel Castor (w/ Brake)
19	MK51.V3-19	Base Support
20	SN8.SW	Wing Nut M8
21	FWM8.S	Flat Washer M8
22	SS825.S	Hex Head Set Screw M8 x 25mm
23	MK51.V3-23	Plastic Tube Cover
24	MK51.V3-24	Handle Grip
25	FWM16.S	Flat Washer M16
26	MK51.V3-26	Plastic Tube Cover
27	MK51.V3-27	Plastic Tube Cover

NOTE: It is our policy to continually improve products and as such we reserve the right to alter data, specifications and component parts without prior notice. There may be alternative versions of this product, please contact us should you require this information.

IMPORTANT: No liability is accepted for incorrect use of product. Spare parts must be fitted by a competent person

WARRANTY: Guarantee is 12 months from purchase date, proof of which will be required for any claim.